

Key: 8592

Town of BREWSTER - Fiscal Year 2025

9/17/2024 2:15 pm SEQ #: 8.821

LEGAL

LAND

DETACHED

BUILDING

CURRENT OWNER		PARCEL ID		LOCATION	
KEITH JOHN S & CAROLYN S 5 FISHER POINT ROAD BREWSTER, MA 02631		19-23-0		4 FISHER POINT ROAD	
TRANSFER HISTORY		DOS	T	SALE PRICE	BK-PG (Cert)
KEITH JOHN S & CAROLYN S		12/05/1997	N	50,000	11102-50
REED JANET S		03/13/1992	QS	7917-34	

CLASS	CLASS%	DESCRIPTION		BN ID	BN	CARD	
1010	100	SINGLE FAMILY			1	1 of 1	
PMT NO	PMT DT	TY	DESC	AMOUNT	INSP	BY	1st %
473	09/02/2008	3	OUT BUILDING	5,327	03/13/2009	JH	100 100
235	05/15/1995	5	OTHER	1,000			100 100
583	09/29/1994	1	NEW CONSTRUC	56,806	01/01/1995	RD	100 100

CD	T	AC/SF/UN	Nbhd	St Ind	Infl	ADJ BASE	SAF	Topo	Lpi	VC	CREDIT AMT	ADJ VALUE
100	S	15,055	12 1.00	A 1.00	A 1.00	230,160	2.81	A 1.00	PV1	1.05		223,200

TOTAL	15,055 SF	ZONING	RR	FRNT	0	ASSESSED	CURRENT	PREVIOUS
Nbhd	NBHD 12	NOTE POND VIEW	LAND	223,200	210,600			
St Ind	AVERAGE		BUILDING	226,000	216,200			
Infl	AVERAGE		DETACHED	2,300	2,300			
			OTHER	0	0			
			TOTAL	451,500	429,100			

TY	QUAL	COND	DIM/NOTE	YB	UNITS	ADJ PRICE	RCNLD
SHF	A	1.00	10 0.90 10 X 12	2008	120	21.39	2,300



BLDG COMMENTS
OUTDOOR SHOWER

BUILDING	CD	ADJ	DESC	MEASURE	11/30/2017	NF
MODEL	1		RESIDENTIAL	LIST	4/3/2008	JH
STYLE	5	1.05	COLONIAL [100%]	REVIEW	12/26/2017	TD
QUALITY	A	1.00	AVG [100%]			
FRAME	1	1.00	WD FRAME [100%]			

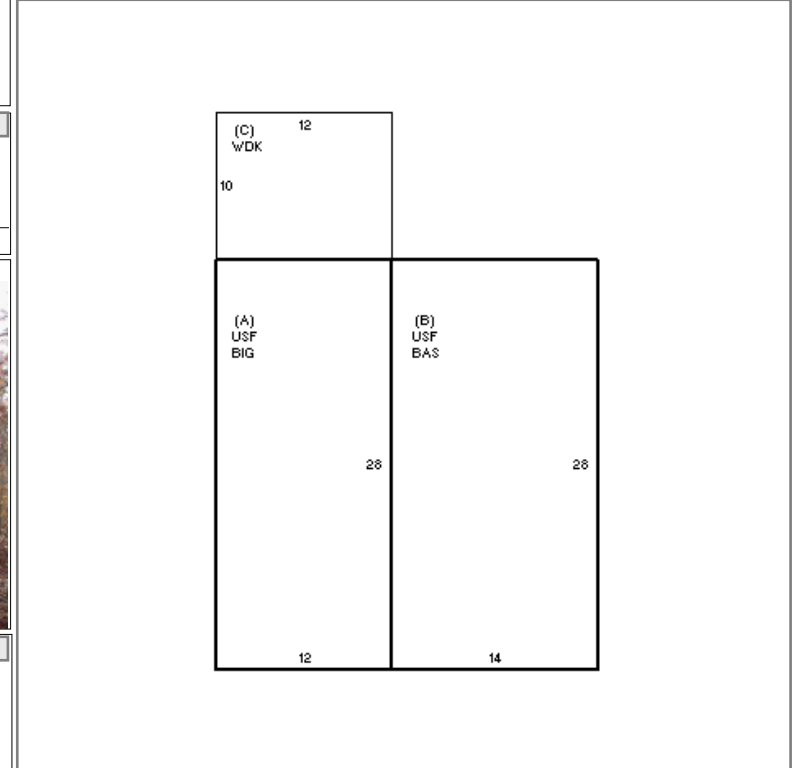

YEAR BLT	1994	SIZE ADJ	1.000
NET AREA	1,120	DETAIL ADJ	1.000
\$NLA(RCN)	\$252	OVERALL	1.000
CAPACITY		UNITS	ADJ
STORIES	2	1.00	
ROOMS	4	1.00	
BEDROOMS	2	1.00	
BATHROOMS	2	1.00	
FIXTURES	6	\$7,800	
GARAGE SPACES	1	1.00	
% BSMT FIN	0	1.00	
# 1/2 BATHS	0	1.00	
# OF UNITS	1	1.00	

ELEMENT	CD	DESCRIPTION	ADJ
FOUNDATION	2	SLAB	0.95
EXT COVER	1	WD SHINGLE	1.00
ROOF SHAPE	1	GABLE	1.00
ROOF COVER	1	ASPH/CMP SH	1.00
FLOOR COVER	3	W/W CARPET	1.00
INT FINISH	2	DRYWALL	1.00
HEATING/COOL	1	FORCED AIR	1.00
FUEL SOURCE	2	GAS	1.00

S	BAT	T	DESCRIPTION	UNITS	YB	ADJ PRICE	RCN
A	BIG	N	BUILT-IN GARAGE	336		54.19	18,209
+	USF	L	UPPER STORY FIN	728	1994	183.85	133,841
B	BAS	L	BASE AREA	392	1994	300.73	117,886
C	WDK	N	WOOD DECK	120		39.20	4,704

TOTAL RCN	282,440
CONDITION ELEM	CD
EXTERIOR	A
INTERIOR	A
KITCHEN	A
BATHS	A
HEAT/ELEC	A
EFF.YR/AGE	1994 / 29
COND	20 20 %
FUNC	0
ECON	0
DEPR	20 % GD 80
RCNLD	\$226,000