

Key: 1390

Town of CHATHAM - Fiscal Year 2024

9/7/2023 9:38 am SEQ #: 1.515

LEGAL

LAND

DETACHED

BUILDING

CURRENT OWNER				PARCEL ID				LOCATION			
MARK WILLIAM JOHNSON 2010 REALTY TRUST & JANE CLAYSON JOHNSON 2010 REALTY TRUST 36 KENMORE RD BELMONT, MA 02478-3305				12J-27-G6				23 ROVER RUN			
TRANSFER HISTORY				DOS	T	SALE PRICE	BK-PG (Cert)				
MARK WILLIAM JOHNSON 2010				03/27/2017	O	1,649,000	(212424)				
ELDREDGE LANDING LLC				10/30/2013	R	1	(201898)				
GENTILE KATHLEEN E & KARE				10/30/2013	A	1	(201897)				

CLASS	CLASS%	DESCRIPTION			BN ID	BN	CARD	
1010	100	SINGLE FAMILY				1	1 of 1	
PMT NO	PMT DT	TY	DESC	AMOUNT	INSP	BY	1st	%
18-847	04/09/2020	99	n/a		04/09/2021	NF	100	100
18-592	10/19/2018	3	Renovations	18,000	02/05/2019	TCK	100	100
18-253	07/26/2018	6	Pools etc	60,000	02/25/2020	NF	100	100
18-180	04/02/2018	1	New Construc	2,319,450	02/25/2020	NF	100	100
	03/08/2018	5	Demolitions	16,700	02/05/2019	TCK	100	100

CD	T	AC/SF/UN	Nbhd	Inf1	Inf2	ADJ BASE	SAF	Inf3	Lpi	VC	CREDIT AMT	ADJ VALUE
100	S	32,197	NC	1.00	100	1,374,375	1.19	100	1.00	CV3	3.75	1,212,830

TOTAL	32,197 SF	ZONING	R40	FRNT	0	ASSESSED	CURRENT	PREVIOUS
Nbhd	NORTH CHATHAM	NOTE Cove Wv - Not Waterfront	LAND	1,212,800	1,010,600			
Inf1	100		BUILDING	6,009,100	5,333,400			
Inf2	100		DETACHED	30,900	29,400			
			OTHER	0	0			
			TOTAL	7,252,800	6,373,400			

TY	QUAL	COND	DIM/NOTE	YB	UNITS	ADJ PRICE	RCNLD
SHF	A	1.00	20 0.80 12X10	1995	120	13.29	1,300
IPC	G	1.20	10 0.90 16X30	2018	480	55.39	23,900
PTD	A	1.00	10 0.90	2020	558	11.30	5,700



BLDG COMMENTS
LLF=FAM RM/EX RM/BEDRM/2 BATHS
INTERIOR ESTIMATED PER PLANS 7/1/2021

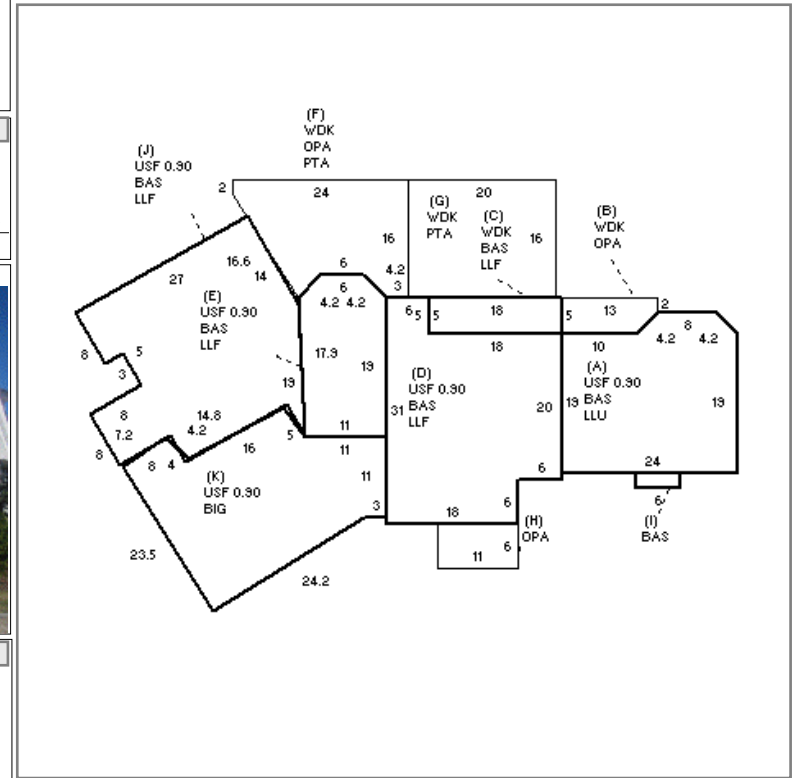

BUILDING	CD	ADJ	DESC	MEASURE	2/5/2019	TCK
MODEL	1		RESIDENTIAL	LIST	2/5/2019	EST
STYLE	19	1.30	NEW STYLE [100%]	REVIEW	6/16/2021	EMZ
QUALITY	E	3.50	EXCELLENT [100%]			
FRAME	1	1.00	WOOD FRAME [100%]			

YEAR BLT	2018	SIZE ADJ	1.000	ELEMENT	CD	DESCRIPTION	ADJ	S	BAT	T	DESCRIPTION	UNITS	YB	ADJ PRICE	RCN	TOTAL RCN	6,259,484														
NET AREA	4,438	DETAIL ADJ	1.352	FOUNDATION	4	FLR & WALL	1.00	A	LLU	N	LOWER LEVEL UN	489		572.90	280,147																
\$NLA(RCN)	\$1,410	OVERALL	1.000	EXT. COVER	1	WOOD SHINGLE	1.00	+	USF	L	UP-STRY FIN	2,319	2018	862.78	2,000,779																
				ROOF SHAPE	3	GAMBREL	1.00	+	OPA	N	OPEN PORCH	421		266.35	112,133																
				ROOF COVER	2	WOOD SHIN	1.01	+	WDK	N	WOOD DECK	765		204.40	156,366																
				FLOOR COVER	1	HARDWOOD	1.00	+	LLF	N	LOWER LEVEL FIN	1,618		748.28	1,210,713																
				INT. FINISH	2	DRYWALL	1.00	+	PTA	N	PATIO/STOOP	614		62.65	38,469																
				HEATING/COOL	9	WARM/COOL AIR	1.03	+	BAS	L	BAS AREA	2,119	2018	1,016.79	2,154,569																
				FUEL SOURCE	2	GAS	1.00	K	BIG	N	BUILT-IN GARAGE	560		270.70	151,592																
									GFP	O	GAS LOG/FP/E FP	2		21,775.25	43,551																
									ODS	O	OUT DOOR SHWR-A	1		5,169.50	5,170																
<table border="1"> <thead> <tr> <th>CONDITION ELEM</th> <th>CD</th> </tr> </thead> <tbody> <tr> <td>EXTERIOR</td> <td>A</td> </tr> <tr> <td>INTERIOR</td> <td>A</td> </tr> <tr> <td>KITCHEN</td> <td>A</td> </tr> <tr> <td>BATHS</td> <td>A</td> </tr> <tr> <td>HEAT</td> <td>A</td> </tr> <tr> <td>ELECT</td> <td>A</td> </tr> </tbody> </table>																	CONDITION ELEM	CD	EXTERIOR	A	INTERIOR	A	KITCHEN	A	BATHS	A	HEAT	A	ELECT	A	
CONDITION ELEM	CD																														
EXTERIOR	A																														
INTERIOR	A																														
KITCHEN	A																														
BATHS	A																														
HEAT	A																														
ELECT	A																														
<table border="1"> <thead> <tr> <th>EFF. YR/AGE</th> <td colspan="2">2018 / 4</td> </tr> </thead> <tbody> <tr> <td>COND</td> <td>4</td> <td>4 %</td> </tr> <tr> <td>FUNC</td> <td>0</td> <td></td> </tr> <tr> <td>ECON</td> <td>0</td> <td></td> </tr> <tr> <td>DEPR</td> <td>4</td> <td>% GD 96</td> </tr> </tbody> </table>																	EFF. YR/AGE	2018 / 4		COND	4	4 %	FUNC	0		ECON	0		DEPR	4	% GD 96
EFF. YR/AGE	2018 / 4																														
COND	4	4 %																													
FUNC	0																														
ECON	0																														
DEPR	4	% GD 96																													
RCNLD																\$6,009,100															