

Key: 2142

Town of CHATHAM - Fiscal Year 2024

9/7/2023 9:38 am SEQ #: 2.318

LEG
AL
LAND

CURRENT OWNER				PARCEL ID				LOCATION				
REVOCABLE TRUST AGRMT ROBERT WILSON III 2701 TREASURE LN NAPLES, FL 34102				14A1-8-D17				86 STAGE ISLAND RD				
TRANSFER HISTORY				DOS	T	SALE PRICE	BK-PG (Cert)					
REVOCABLE TRUST AGRMT ROB				12/16/2011	QS	3,600,000	(195897)					
MCKIM ALAN S				05/16/2007	QS	4,750,000	(183090)					
MCCALLUM ELKIN & DONNA JT				01/14/1998	B	10	(147199)					
CD	T	AC/SF/UN	Nbhd	Inf1	Inf2	ADJ BASE	SAF	Inf3	Lpi	VC	CREDIT AMT	ADJ VALUE
100	S	40,000	MOR 1.00	100	1.00	3,481,750	1.00	100	1.00	CF4	9.50	3,197,200
300	A	0.021	MOR 1.00	100	1.00	182,400	1.00	100	1.00	CF4	9.50	3,830

CLASS	CLASS%	DESCRIPTION			BN ID	BN	CARD	
1010	100	SINGLE FAMILY				1	1 of 1	
PMT NO	PMT DT	TY	DESC	AMOUNT	INSP	BY	1st	%
P2002489	05/12/2008	50	Meas & List			RRC	100	100
97-196	01/19/2003	50	Meas & List			JB	100	100
SP 97-22	10/11/2002	99	n/a				100	100
	05/01/1997	14	DECK	20,000			100	100
	04/02/1997	2	Additions				100	100

DE
T
A
C
H
E
D

TOTAL	40,909 SF	ZONING	R40	FRNT	0	ASSESSED	CURRENT	PREVIOUS
Nbhd	MORRIS ISLAND	N O T E				LAND	3,201,000	2,667,400
Inf1	100		BUILDING	2,382,700	2,030,700			
Inf2	100		DETACHED	185,600	183,700			
			OTHER	0	0			
						TOTAL	5,769,300	4,881,800

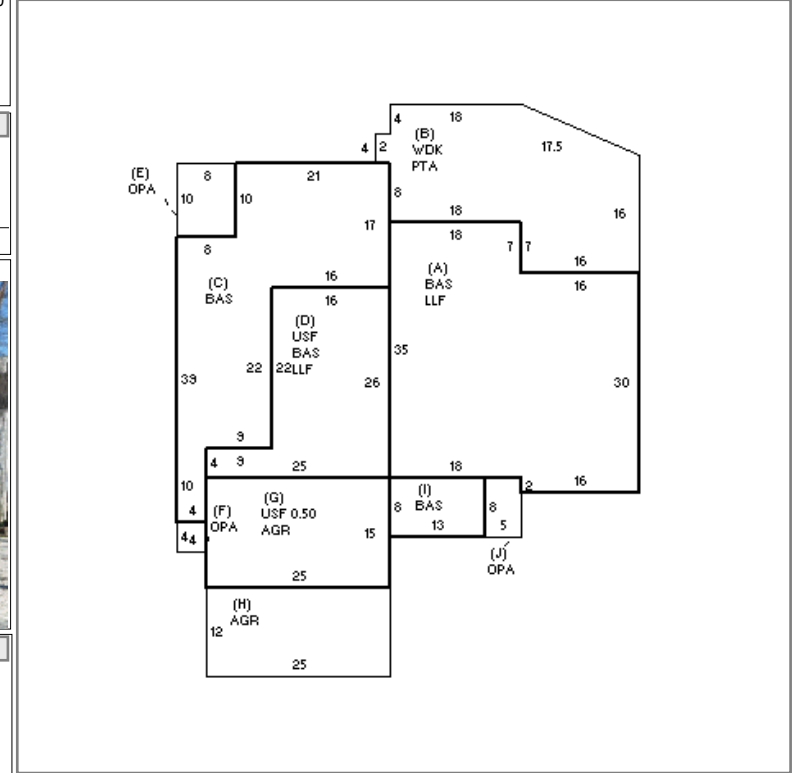

PHO
TO

TY	QUAL	COND	DIM/NOTE	YB	UNITS	ADJ PRICE	RCNLD
DCK	V	1.50	20 0.80	1981	936	231.19	173,100
STR	S	3.00	10 0.90		154	90.00	12,500



BLD
G
C
O
M
M
E
N
T
S

BUILDING	CD	ADJ	DESC	MEASURE		
MODEL	1		RESIDENTIAL	LIST		
STYLE	8	0.95	CONTEMPORARY [100%]	REVIEW	4/21/2016	APK
QUALITY	V	2.35	VERY GOOD [100%]			
FRAME	1	1.00	WOOD FRAME [100%]			

Y
E
A
R
B
L
T

YEAR BLT	1984	SIZE ADJ	1.000	ELEMENT	CD	DESCRIPTION	ADJ	S	BAT	T	DESCRIPTION	UNITS	YB	ADJ PRICE	RCN	TOTAL RCN	2,482,030																	
NET AREA	3,045	DETAIL ADJ	1.007	FOUNDATION	3	FOUND WALL	1.00	+	LLF	N	LOWER LEVEL FIN	1,562		383.87	599,610																			
\$NLA(RCN)	\$815	OVERALL	1.000	EXT. COVER	1	WOOD SHINGLE	1.00	B	PTA	N	PATIO/STOOP	608		42.06	25,575																			
				ROOF SHAPE	8	IRREG	1.00	B	WDK	N	WOOD DECK	608		137.24	83,442																			
				ROOF COVER	2	WOOD SHIN	1.01	+	BAS	L	BAS AREA	2,405	1984	521.62	1,254,496																			
				FLOOR COVER	16	HARDWD/OTHER	1.00	+	USF	L	UP-STRY FIN	640	1984	442.61	283,271																			
				INT. FINISH	2	DRYWALL	1.00	+	OPA	N	OPEN PORCH	136		178.84	24,323																			
				HEATING/COOL	11	HT-WT/COOL AIR	1.05	+	AGR	N	ATTACHED GARAGE	675		178.69	120,616																			
				FUEL SOURCE	1	OIL	1.00	F32	O		FPL 3S 2OP	1		56,620.90	56,621																			
<table border="1"> <thead> <tr> <th>CONDITION ELEM</th> <th>CD</th> </tr> </thead> <tbody> <tr> <td>EXTERIOR</td> <td>G</td> </tr> <tr> <td>INTERIOR</td> <td>V</td> </tr> <tr> <td>KITCHEN</td> <td>V</td> </tr> <tr> <td>BATHS</td> <td>V</td> </tr> <tr> <td>HEAT</td> <td>U</td> </tr> <tr> <td>ELECT</td> <td>U</td> </tr> </tbody> </table>																	CONDITION ELEM	CD	EXTERIOR	G	INTERIOR	V	KITCHEN	V	BATHS	V	HEAT	U	ELECT	U				
CONDITION ELEM	CD																																	
EXTERIOR	G																																	
INTERIOR	V																																	
KITCHEN	V																																	
BATHS	V																																	
HEAT	U																																	
ELECT	U																																	
<table border="1"> <thead> <tr> <th>EFF. YR/AGE</th> <td colspan="2">2018 / 4</td> </tr> </thead> <tbody> <tr> <td>COND</td> <td>4</td> <td>4 %</td> </tr> <tr> <td>FUNC</td> <td>0</td> <td></td> </tr> <tr> <td>ECON</td> <td>0</td> <td></td> </tr> <tr> <td>DEPR</td> <td>4</td> <td>% GD 96</td> </tr> <tr> <td>RCNLD</td> <td colspan="2">\$2,382,700</td> </tr> </tbody> </table>																	EFF. YR/AGE	2018 / 4		COND	4	4 %	FUNC	0		ECON	0		DEPR	4	% GD 96	RCNLD	\$2,382,700	
EFF. YR/AGE	2018 / 4																																	
COND	4	4 %																																
FUNC	0																																	
ECON	0																																	
DEPR	4	% GD 96																																
RCNLD	\$2,382,700																																	