

Key: 2537

Town of CHATHAM - Fiscal Year 2024

9/7/2023 9:38 am SEQ #: 2.744

LEGAL

CURRENT OWNER						PARCEL ID			LOCATION				
LEBLANC RICHARD J 400 STUART ST #24E BOSTON, MA 02116-5011						14F-90-X1			89-1 DEPOT RD				
						TRANSFER HISTORY			DOS	T	SALE PRICE	BK-PG (Cert)	
						LEBLANC RICHARD J			12/16/2016	QS	370,000	(C85-1)	
LINCOLN A & MONIQUE C PER			05/06/2008	A	99	(C85-1)							
PERRY MONIQUE C			07/26/2007	QS	425,000	(85-1)							

CLASS	CLASS%	DESCRIPTION			BN ID	BN	CARD	
1020	100	CONDOMINIUM				1	1 of 1	
PMT NO	PMT DT	TY	DESC	AMOUNT	INSP	BY	1st	%
20-358	12/17/2020	10	Reroof	153,240	04/29/2021	TCK	100	100
	07/19/2017	98	SALES QUESTI				100	100
	07/18/2017	98	SALES QUESTI				100	100
17-218	03/30/2017	3	Renovations	38,000	07/25/2018	WFF	100	100

LAND

CD	T	AC/SF/UN	Nbhd	Inf1	Inf2	ADJ BASE	SAF	Inf3	Lpi	VC	CREDIT AMT	ADJ VALUE

TOTAL	SF	ZONING	Gb2	FRNT	0	ASSESSED	CURRENT	PREVIOUS
Nbhd		NOTE				LAND	0	0
Inf1			BUILDING	465,900	416,700			
Inf2			DETACHED	0	0			
			OTHER	0	0			
						TOTAL	465,900	416,700

DETACHED

TY	QUAL	COND	DIM/NOTE	YB	UNITS	ADJ PRICE	RCNLD	PHOTO
								04/29/2021
								

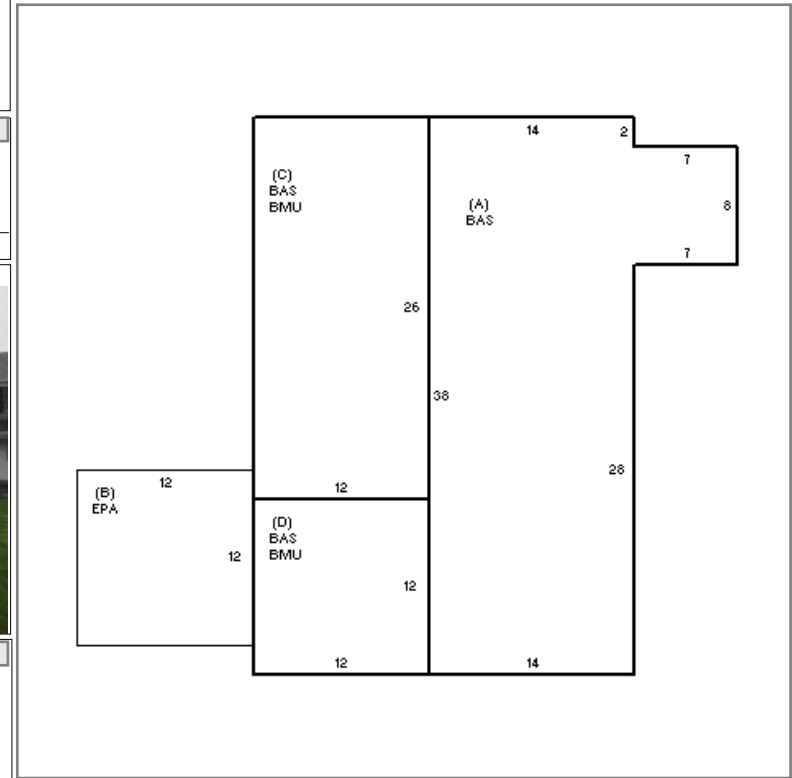

BUILDING

BUILDING	CD	ADJ	DESC	MEASURE	REVIEW	7/19/2022	CC
MODEL	10		CONDO				
STYLE	5	1.00	GARDEN END [100%]	LIST			
QUALITY	A	1.00	AVERAGE [100%]	REVIEW			
FRAME	99	1.00	N/A [100%]				

YEAR BLT	1980	SIZE ADJ	1.000	ELEMENT	CD	DESCRIPTION	ADJ	S	BAT	T	DESCRIPTION	UNITS	YB	ADJ PRICE	RCN	TOTAL RCN	511,960
NET AREA	1,044	DETAIL ADJ	1.600	COMPLEX	25	OYSTER HEIGHT	1.60	+	BAS	L	BAS AREA	1,044	1980	464.76	485,209		
\$NLA(RCN)	\$490	OVERALL	1.000	UNIT MODEL	99	N/A	1.00	B	EPA	N	ENCL PORCH	144		43.80	6,307		
				VIEW/LOC	1	NONE	1.00	+	BMU	N	BSMT UNFINISHED	456		23.00	10,488		
				HVAC	5	ELECTRIC BB	1.00		BMG	O	BSMT GARAGE	1		2,276.00	2,276		
				FUEL SOURCE	3	ELECTRIC	1.00										
				FLOOR LEVEL	2	FIRST FLOOR	1.00										
				NEIGHBORHOOD	2	CHATHAM	1.00										

CONDITION ELEM	CD
INTERIOR	G
KITCHEN	G
BATHS	A
EXTERIOR	A

EFF.YR/AGE	1993 / 29
COND	9 9 %
FUNC	0
ECON	0
DEPR	9 % GD 91
RCNLD	\$465,900