

Key: 2835

Town of CHATHAM - Fiscal Year 2024

9/7/2023 9:38 am SEQ #: 3.062

LEGAL

LAND

Table with columns: CURRENT OWNER, PARCEL ID, LOCATION, TRANSFER HISTORY, and various assessment metrics like ADJ BASE, SAF, and CREDIT AMT.

Table with columns: CLASS, CLASS%, DESCRIPTION, BN ID, BN, CARD, and a detailed payment history table with columns: PMT NO, PMT DT, TY, DESC, AMOUNT, INSP, BY, 1st, %.

Summary table with columns: TOTAL, ZONING, FRNT, ASSESSED, CURRENT, PREVIOUS, and a breakdown of assessed values for LAND, BUILDING, DETACHED, and OTHER.

Table with columns: TY, QUAL, COND, DIM/NOTE, YB, UNITS, ADJ PRICE, RCNLD, and a PHOTO placeholder.

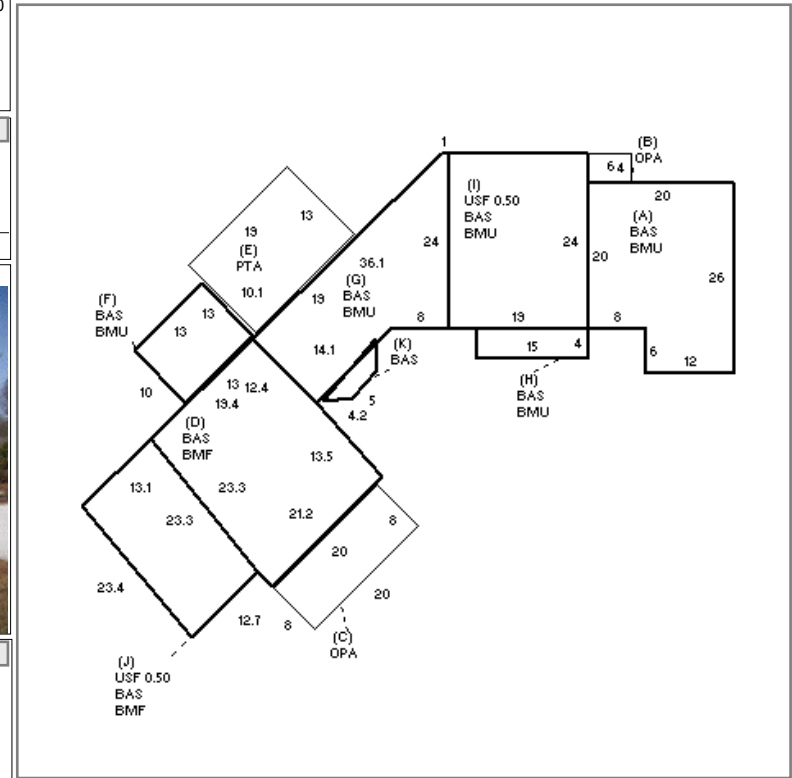

Table with columns: BUILDING, CD, ADJ, DESC, MEASURE, and BLDG COMMENTS (30 SOLAR PANELS, IN-LAW=2BDRMS VAULTED CEILINGS).

DETACHED

BUILDING

Large summary table with columns: YEAR BLT, NET AREA, \$NLA(RCN), CAPACITY, UNITS, ADJ, ELEMENT, CD, DESCRIPTION, ADJ, S, BAT, T, DESCRIPTION, UNITS, YB, ADJ PRICE, RCN, TOTAL RCN, CONDITION ELEM, CD, EFF. YR/AGE, COND, FUNC, ECON, DEPR, RCNLD.