

Key: 2968

Town of CHATHAM - Fiscal Year 2024

9/7/2023 9:38 am SEQ #: 3.204

LEGAL

CURRENT OWNER		PARCEL ID		LOCATION	
MCALPIN ASSOCIATES NOMINEE TRUST		15B-1-1		191 BRIDGE ST	
MCALPIN DAVID H JR TRUSTEE		TRANSFER HISTORY		DOS	T
607 W END AVE APT 14A		MCALPIN ASSOCIATES NOMINEE		01/03/1990	A
NEW YORK, NY 10024				SALE PRICE	BK-PG (Cert)
					1 (119480)

CLASS	CLASS%	DESCRIPTION		BN ID	BN	CARD	
1090	100	MULTIPLE HSES			1	1 of 3	
PMT NO	PMT DT	TY	DESC	AMOUNT	INSP	BY	1st %
14-205	04/22/2014	3	Renovations	65,000	06/24/2016	WFF	100 100
13-025	01/17/2013	10	Reroof	40,000	03/10/2014	MR	100 100
	01/29/2009	51	Meas			CE	100 100
08-347	08/08/2008	9	Foundation	20,000	01/29/2009		100 100
	02/17/2007	50	Meas & List			RRC	100 100

LAND

CD	T	AC/SF/UN	Nbhd	Inf1	Inf2	ADJ BASE	SAF	Inf3	Lpi	VC	CREDIT AMT	ADJ VALUE
100	S	40,000	CH	1.00	100	3,829,925	1.00	MDW	1.10	PF3	9.50	3,516,920
300	A	1.061	CH	1.00	100	182,400	1.00	100	1.00	PF3	9.50	193,530

TOTAL	1.979 Acres	ZONING	R40	FRNT	300	ASSESSED	CURRENT	PREVIOUS
Nbhd	CHATHAM	N O T E	WF	LAND		3,710,500	3,580,100	
Inf1	100		BUILDING		746,800	688,300		
Inf2	100		OTHER		0	0		
			TOTAL		630,300	574,100		
						5,087,600	4,842,500	

DETACHED

TY	QUAL	COND	DIM/NOTE	YB	UNITS	ADJ PRICE	RCNLD	PHOTO
								06/24/2016

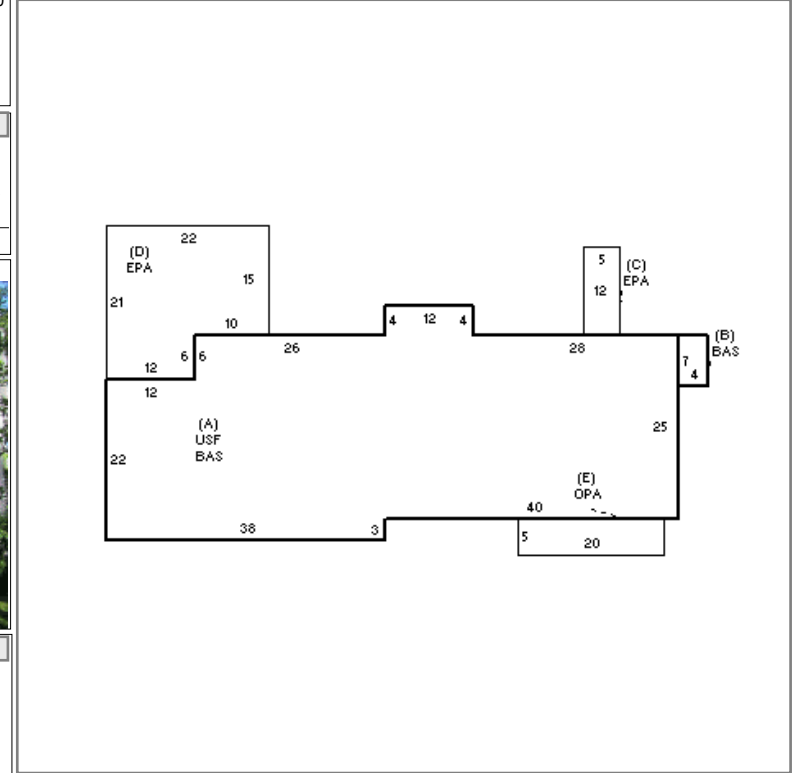
BUILDING

BUILDING	CD	ADJ	DESC	MEASURE	REVIEW	7/19/2016	TD
MODEL	1		RESIDENTIAL	LIST	REVIEW	7/19/2016	TD
STYLE	18	1.30	RENO'D ANTIQUE [100%]				
QUALITY	G	1.55	GOOD [100%]				
FRAME	1	1.00	WOOD FRAME [100%]				

YEAR BLT	1914	SIZE ADJ	1.000	ELEMENT	CD	DESCRIPTION	ADJ	S	BAT	T	DESCRIPTION	UNITS	YB	ADJ PRICE	RCN
NET AREA	4,108	DETAIL ADJ	1.300	FOUNDATION	3	FOUND WALL	1.00	+	BAS	L	BAS AREA	2,068	1914	448.73	927,965
\$NLA(RCN)	\$454	OVERALL	1.000	EXT. COVER	1	WOOD SHINGLE	1.00	A	USF	L	UP-STRY FIN	2,040	1914	380.76	776,747
				ROOF SHAPE	1	GABLE	1.00	+	EPA	N	ENCL PORCH	462		207.23	95,742
				ROOF COVER	1	ASPH/CMP SHIN	1.00	E	OPA	N	OPEN PORCH	100		117.96	11,796
				FLOOR COVER	2	SOFTWOOD	1.00		F21	O	FPL 2S 1OP	2		16,082.80	32,166
				INT. FINISH	2	DRYWALL	1.00								
				HEATING/COOL	1	FORCED AIR	1.00								
				FUEL SOURCE	1	OIL	1.00								

TOTAL RCN	1,866,983
CONDITION ELEM	CD
EXTERIOR	
INTERIOR	
KITCHEN	
BATHS	
HEAT	
ELECT	
EFF.YR/AGE	1954 / 68
COND	60 60 %
FUNC	0
ECON	0
DEPR	60 % GD 40
RCNLD	\$746,800

Key: 2968

Town of CHATHAM - Fiscal Year 2024

9/7/2023 9:38 am SEQ #: 3.205

LEGAL

CURRENT OWNER		PARCEL ID		LOCATION	
MCALPIN ASSOCIATES NOMINEE TRUST		15B-1-1		191 BRIDGE ST	
MCALPIN DAVID H JR TRUSTEE		TRANSFER HISTORY		DOS	T
607 W END AVE APT 14A				SALE PRICE	BK-PG (Cert)
NEW YORK, NY 10024					

CLASS	CLASS%	DESCRIPTION			BN ID	BN	CARD
1090	100	MULTIPLE HSES				2	2 of 3
PMT NO	PMT DT	TY	DESC	AMOUNT	INSP	BY	1st %

LAND

CD	T	AC/SF/UN	Nbhd	Inf1	Inf2	ADJ BASE	SAF	Inf3	Lpi	VC	CREDIT AMT	ADJ VALUE

TOTAL	ZONING	FRNT	ASSESSED	CURRENT	PREVIOUS
Nbhd	NOTE		LAND	523,500	
Inf1		BUILDING			
Inf2		DETACHED			
			OTHER		
			TOTAL		

DETACHED

TY	QUAL	COND	DIM/NOTE	YB	UNITS	ADJ PRICE	RCNLD



BLDG COMMENTS

BUILDING

BUILDING	CD	ADJ	DESC	MEASURE		
MODEL	1		RESIDENTIAL	LIST		
STYLE	5	1.00	COLONIAL [100%]	REVIEW	3/17/2014	DD
QUALITY	G	1.55	GOOD [100%]			
FRAME	1	1.00	WOOD FRAME [100%]			

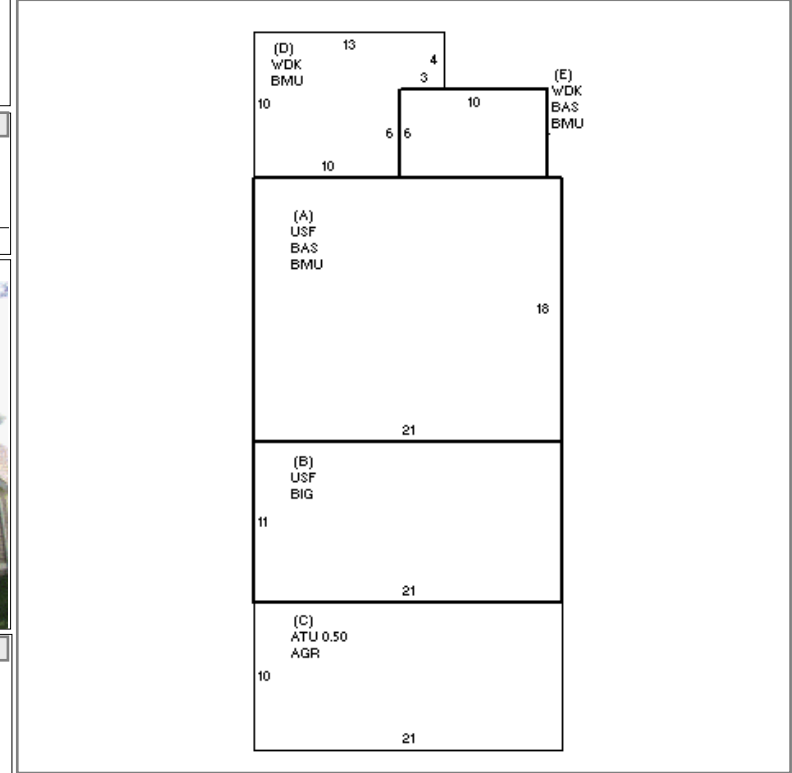

INDING

YEAR BLT	2008	SIZE ADJ	1.000	ELEMENT	CD	DESCRIPTION	ADJ	S	BAT	T	DESCRIPTION	UNITS	YB	ADJ PRICE	RCN	TOTAL RCN	594,839
NET AREA	1,047	DETAIL ADJ	1.030	FOUNDATION	4	FLR & WALL	1.00	+	BMU	N	BSMT UNFINISHED	550		133.34	73,337		
\$NLA(RCN)	\$568	OVERALL	1.000	EXT. COVER	1	WOOD SHINGLE	1.00	+	BAS	L	BAS AREA	438	2008	452.97	198,400		
				ROOF SHAPE	1	GABLE	1.00	+	USF	L	UP-STRY FIN	609	2008	384.36	234,073		
				ROOF COVER	2	WOOD SHIN	1.01	B	BIG	N	BUILT-IN GARAGE	231		123.12	28,441		
				FLOOR COVER	1	HARDWOOD	1.00	C	AGR	N	ATTACHED GARAGE	210		123.12	25,856		
				INT. FINISH	2	DRYWALL	1.00	C	ATU	N	UNFIN ATTIC	105		121.68	12,777		
				HEATING/COOL	3	RADIANT	1.02	+	WDK	N	WOOD DECK	172		90.52	15,570		
				FUEL SOURCE	2	GAS	1.00										
																CONDITION ELEM	CD
																EXTERIOR	
																INTERIOR	
																KITCHEN	
																BATHS	
																HEAT	
																ELECT	
																EFF.YR/AGE	2010 / 12
																COND	12 12 %
																FUNC	0
																ECON	0
																DEPR	12 % GD 88
																RCNLD	\$523,500

INDING

Key: 2968

Town of CHATHAM - Fiscal Year 2024

9/7/2023 9:38 am SEQ #: 3.206

LEGAL

CURRENT OWNER		PARCEL ID	LOCATION			
MCALPIN ASSOCIATES NOMINEE TRUST		15B-1-1	191 BRIDGE ST			
MCALPIN DAVID H JR TRUSTEE		TRANSFER HISTORY	DOS	T	SALE PRICE	BK-PG (Cert)
607 W END AVE APT 14A						
NEW YORK, NY 10024						

CLASS	CLASS%	DESCRIPTION			BN ID	BN	CARD	
1090	100	MULTIPLE HSES				3	3 of 3	
PMT NO	PMT DT	TY	DESC	AMOUNT	INSP	BY	1st	%

LAND

CD	T	AC/SF/UN	Nbhd	Inf1	Inf2	ADJ BASE	SAF	Inf3	Lpi	VC	CREDIT AMT	ADJ VALUE

TOTAL	ZONING	FRNT	ASSESSED	CURRENT	PREVIOUS
Nbhd	NOTE		LAND	106,800	
Inf1		BUILDING			
Inf2		DETACHED			
			OTHER		
			TOTAL		

DETACHED

TY	QUAL	COND	DIM/NOTE	YB	UNITS	ADJ PRICE	RCNLD	PHOTO
								06/24/2016

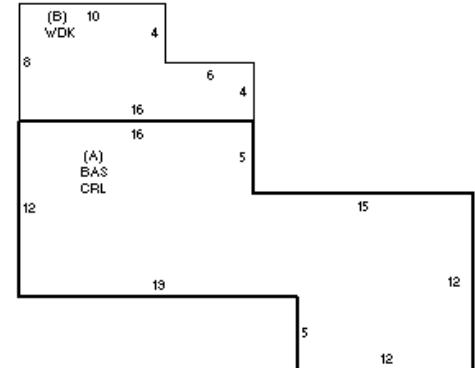
BUILDING

BUILDING	CD	ADJ	DESC	MEASURE	6/24/2016	WFF	BLDG COMMENTS
MODEL	1		RESIDENTIAL	LIST	6/24/2016	EST	NO KITCHEN
STYLE	6	0.85	COTTAGE [100%]	REVIEW	7/19/2016	TD	
QUALITY	A	1.00	AVERAGE [100%]				
FRAME	1	1.00	WOOD FRAME [100%]				

INDING

YEAR BLT	1981	SIZE ADJ	1.000	ELEMENT	CD	DESCRIPTION	ADJ	S	BAT	T	DESCRIPTION	UNITS	YB	ADJ PRICE	RCN	TOTAL RCN	125.660	
NET AREA	357	DETAIL ADJ	0.850	FOUNDATION	6	CRAWL	1.00	A	CRL	N	CRAWL SPACE	357		26.91	9,607	CONDITION ELEM	CD	
\$NLA(RCN)	\$352	OVERALL	1.000	EXT. COVER	1	WOOD SHINGLE	1.00	A	BAS	L	BAS AREA	357	1981	300.12	107,142	EXTERIOR	G	
				ROOF SHAPE	2	HIP	1.00	B	WDK	N	WOOD DECK	104		58.40	6,074	INTERIOR	G	
				ROOF COVER	1	ASPH/CMP SHIN	1.00		ODS	O	OUT DOOR SHWR-A	1		1,477.00	1,477	KITCHEN	G	
				FLOOR COVER	99	N/A	1.00									BATHS	G	
				INT. FINISH	99	N/A	1.00									HEAT	A	
				HEATING/COOL	0		1.00									ELECT	U	
				FUEL SOURCE	0		1.00											
																EFF.YR/AGE	2007 / 15	
																COND	15 15%	
																FUNC	0	
																ECON	0	
																DEPR	15	% GD 85
																RCNLD	\$106,800	