

Key: 3663

Town of CHATHAM - Fiscal Year 2024

9/7/2023 9:38 am SEQ #: 3.986

LEGAL LAND

Table with columns: CURRENT OWNER, PARCEL ID, LOCATION, TRANSFER HISTORY, DOS, T, SALE PRICE, BK-PG (Cert). Includes owner GIBBS ROBERT & ELIZABETH and parcel 16B-56-64A.

Table with columns: CLASS, CLASS%, DESCRIPTION, BN ID, BN, CARD. Includes payment history for 11-234, 98-331, SP 98-37, and 93-116.

Table with columns: CD, T, AC/SF/UN, Nbhd, Inff1, Inff2, ADJ BASE, SAF, Inff3, Lpi, VC, CREDIT AMT, ADJ VALUE. Includes lot area 6,403 SF and credit amount 950,200.

Table with columns: TOTAL, ZONING, R20, FRNT, 0, ASSESSED, CURRENT, PREVIOUS. Includes assessed value 1,811,800 and current value 1,551,600.

Table with columns: TY, QUAL, COND, DIM/NOTE, YB, UNITS, ADJ PRICE, RCNLD. Includes building types GUL and ASH with dimensions 20X14 and 6X12.

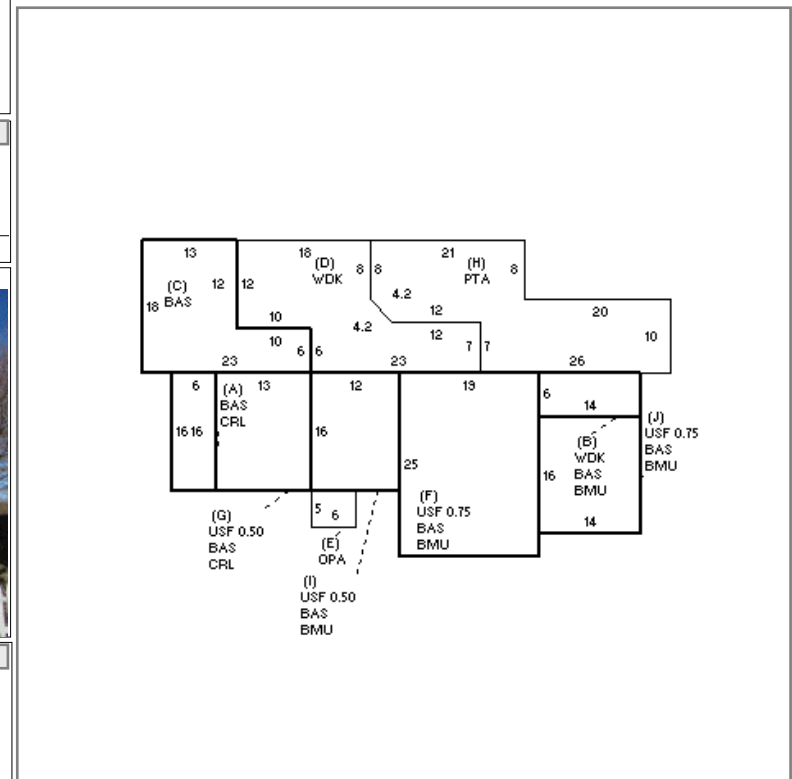

Table with columns: BUILDING, CD, ADJ, DESC, MEASURE, 2/21/2017, MR. Includes building model 18 and style RENO'D ANTIQUE [100%].

Table with columns: YEAR BLT, SIZE ADJ, UNITS, ADJ, ELEMENT, CD, DESCRIPTION, ADJ. Includes capacity for 1.75 stories and 4 bedrooms.

Table with columns: S, BAT, T, DESCRIPTION, UNITS, YB, ADJ PRICE, RCN. Includes foundation, roof, and interior finish details.

Table with columns: TOTAL RCN, CONDITION ELEM, CD, EFF. YR/AGE, COND, FUNC, ECON, DEPR, RCNLD. Includes total RCN 1,022,058 and RCNLD \$848,300.

DETACHED

BUILDING