

Key: 3700

Town of CHATHAM - Fiscal Year 2024

9/7/2023 9:38 am SEQ #: 4.029

LEGALS LAND

Table with columns: CURRENT OWNER, PARCEL ID, LOCATION, TRANSFER HISTORY, DOS, T, SALE PRICE, BK-PG (Cert). Includes owner info for Robert T & Winifred S Lear Liv Trusts and parcel details for 16C-1-59A at 296 Main St.

Table with columns: CLASS, CLASS%, DESCRIPTION, BN ID, BN, CARD. Includes payment history for 21-1084 and 11-253, detailing dates, descriptions like 'INSULATION' and 'Renovations', and amounts.

Table with columns: CD, T, AC/SF/UN, Nbhd, Inf1, Inf2, ADJ BASE, SAF, Inf3, Lpi, VC, CREDIT AMT, ADJ VALUE. Includes a summary row for TOTAL and assessed values for LAND, BUILDING, DETACHED, and OTHER.

Table with columns: TY, QUAL, COND, DIM/NOTE, YB, UNITS, ADJ PRICE, RCNLD. Includes a row for DGF with quality 'A' and condition '1.00 30 0.70 20X20'.

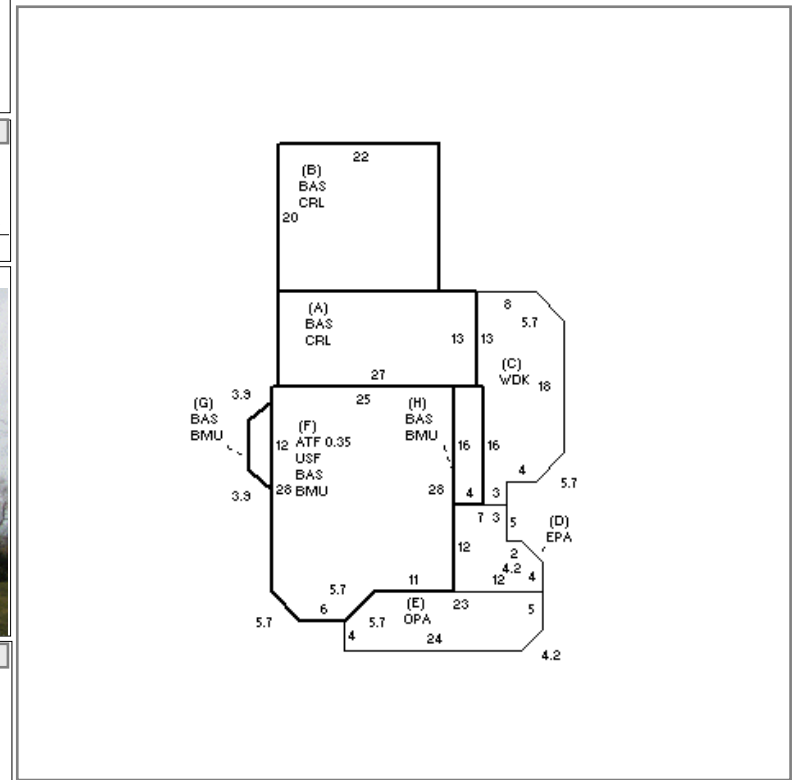

Table with columns: BUILDING, CD, ADJ, DESC, MEASURE, 2/28/2017, MR. Includes details for building model, style, quality, and frame.

BLDG COMMENTS: SELENA & ZENAS HAWES RESIDENCE c.1912 WALK-UP ATTIC=BR/HALF BATH

DETACHED

BUILDING

Large summary table with columns: YEAR BLT, NET AREA, \$NLA(RCN), CAPACITY, UNITS, ADJ, ELEMENT, CD, DESCRIPTION, ADJ, S, BAT, T, DESCRIPTION, UNITS, YB, ADJ PRICE, RCN, TOTAL RCN, 1,415,180. Includes a breakdown of building elements like 'FLR & WALL', 'WOOD SHINGLE', 'HIP', 'ASPH/CMP SHIN', etc., and a final summary row for RCNLD at \$1,188,800.