

Key: 3967

Town of CHATHAM - Fiscal Year 2024

9/7/2023 9:38 am SEQ #: 4.340

LEGAL

CURRENT OWNER				PARCEL ID				LOCATION			
HAROLD GERSHMAN TRUST KATHLEEN GERSHMAN TRUST 517 REEVES DRIVE GRAND FORKS, ND 58201-4915				16G-7-K3				51 THAYER LN			
TRANSFER HISTORY				DOS	T	SALE PRICE	BK-PG (Cert)				
HAROLD GERSHMAN TRUST				09/05/2017	A	1	30745-95				
GERSHMAN HAROLD A				01/16/1990	Q	640,665	7024-184				

CLASS	CLASS%	DESCRIPTION			BN ID	BN	CARD	
1090	100	MULTIPLE HSES				1	1 of 2	
PMT NO	PMT DT	TY	DESC	AMOUNT	INSP	BY	1st	%
20-347	11/19/2020	10	Reroof	21,000	04/02/2021	NF	100	100
19-242	04/10/2019	13	SH.MTL/FHAIR	10,677	02/19/2020	NF	100	100
18-868	10/24/2018	3	Renovations	600,000	02/19/2020	NF	100	100
18-774	09/27/2018	5	Demolitions	5,000	02/04/2019	TCK	100	100
	02/17/2010	50	Meas & List			CE	100	100

LAND

CD	T	AC/SF/UN	Nbhd	Inf1	Inf2	ADJ BASE	SAF	Inf3	Lpi	VC	CREDIT AMT	ADJ VALUE	
100	S	38,500	NC	1.00	1.00	1.00	1.00	4,434,650	1.03	MDW	1.10	OF6 11.00	4,042,190

TOTAL	38,500 SF	ZONING	R40	FRNT	0	ASSESSED	CURRENT	PREVIOUS
Nbhd	NORTH CHATHAM	NOTE	LAND	4,042,200	3,368,300			
Inf1	100		BUILDING	810,100	744,900			
Inf2	100		DETACHED	2,200	2,000			
			OTHER	333,800	286,100			
			TOTAL	5,188,300	4,401,300			

DETACHED

TY	QUAL	COND	DIM/NOTE	YB	UNITS	ADJ PRICE	RCNLD	PHOTO
SHF	V	1.50	10 0.90 10X12	1990	120	19.93	2,200	04/02/2020

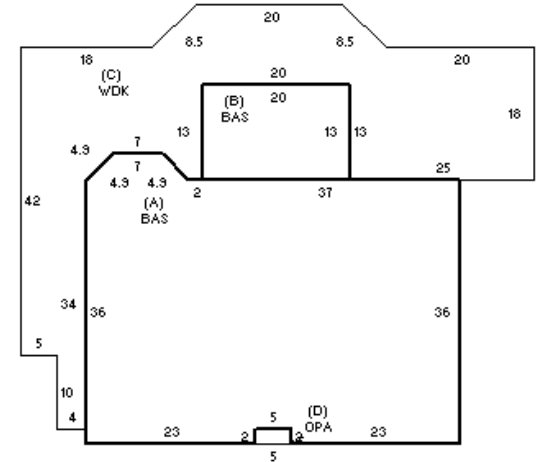

BUILDING

BUILDING	CD	ADJ	DESC	MEASURE	2/19/2020	NF
MODEL	1		RESIDENTIAL	LIST	2/19/2020	EST
STYLE	1	0.85	RANCH [100%]	REVIEW	6/9/2021	EMZ
QUALITY	G	1.55	GOOD [100%]			
FRAME	1	1.00	WOOD FRAME [100%]			

BLDG COMMENTS

BUILDING

YEAR BLT	1962	SIZE ADJ	1.000	ELEMENT	CD	DESCRIPTION	ADJ	S	BAT	T	DESCRIPTION	UNITS	YB	ADJ PRICE	RCN	TOTAL RCN	861,769		
NET AREA	2,123	DETAIL ADJ	0.901	FOUNDATION	1	PIER	1.00	A	BAS	L	BAS AREA	1,863	1962	338.12	629,920	CONDITION ELEM	CD		
\$NLA(RCN)	\$406	OVERALL	1.000	EXT. COVER	2	CLAPBOARD	1.00	B	BAS	L	BAS AREA	260	2018	338.12	87,911	EXTERIOR	V		
				ROOF SHAPE	2	HIP	1.00	C	WDK	N	WOOD DECK	1,375		90.52	124,465	INTERIOR	V		
				ROOF COVER	2	WOOD SHIN	1.01	D	OPA	N	OPEN PORCH	10		117.96	1,180	KITCHEN	V		
				FLOOR COVER	16	HARDWD/OTHER	1.00	F11	O	FPL 1S 1OP	1		11,589.40	11,589	BATHS	V			
				INT. FINISH	2	DRYWALL	1.00								HEAT	U			
				HEATING/COOL	11	HT-WT/COOL AIR	1.05								ELECT	U			
				FUEL SOURCE	2	GAS	1.00												
																		EFF.YR/AGE	2016 / 6
																		COND	6 6 %
																		FUNC	0
																		ECON	0
																		DEPR	6 % GD 94
																		RCNLD	\$810,100

Key: 3967

Town of CHATHAM - Fiscal Year 2024

9/7/2023 9:38 am SEQ #: 4.341

LEGALS

CURRENT OWNER				PARCEL ID				LOCATION			
HAROLD GERSHMAN TRUST KATHLEEN GERSHMAN TRUST 517 REEVES DRIVE GRAND FORKS, ND 58201-4915				16G-7-K3				51 THAYER LN			
TRANSFER HISTORY				DOS	T	SALE PRICE	BK-PG (Cert)				

CLASS	CLASS%	DESCRIPTION			BN ID	BN	CARD	
1090	100	MULTIPLE HSES				2	2 of 2	
PMT NO	PMT DT	TY	DESC	AMOUNT	INSP	BY	1st	%

LAND

CD	T	AC/SF/UN	Nbhd	Inf1	Inf2	ADJ BASE	SAF	Inf3	Lpi	VC	CREDIT AMT	ADJ VALUE
----	---	----------	------	------	------	----------	-----	------	-----	----	------------	-----------

TOTAL	ZONING	FRNT	ASSESSED	CURRENT	PREVIOUS
Nbhd	NOTE		LAND	333,800	
Inf1		BUILDING			
Inf2		DETACHED			
			OTHER		
			TOTAL		

DETACHED

TY	QUAL	COND	DIM/NOTE	YB	UNITS	ADJ PRICE	RCNLD
----	------	------	----------	----	-------	-----------	-------

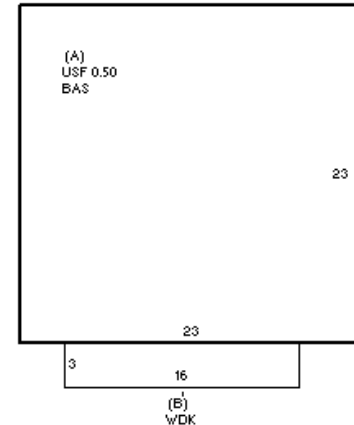

BLDG COMMENTS
FR/BR/BATH PER PERMIT

BUILDING

BUILDING	CD	ADJ	DESC	MEASURE	2/19/2020	NF
MODEL	1		RESIDENTIAL	LIST	2/19/2020	EST
STYLE	6	0.85	COTTAGE [100%]	REVIEW	3/10/2020	MR
QUALITY	G	1.55	GOOD [100%]			
FRAME	1	1.00	WOOD FRAME [100%]			

YEAR BLT	1995	SIZE ADJ	1.000	ELEMENT	CD	DESCRIPTION	ADJ	S	BAT	T	DESCRIPTION	UNITS	YB	ADJ PRICE	RCN	TOTAL RCN	333,752	
NET AREA	794	DETAIL ADJ	0.901	FOUNDATION	1	PIER	1.00	A	BAS	L	BAS AREA	529	1995	432.51	228,800	CONDITION ELEM	CD	
\$NLA(RCN)	\$420	OVERALL	1.000	EXT. COVER	1	WOOD SHINGLE	1.00	A	USF	L	UP-STRY FIN	265	1995	367.00	97,256	EXTERIOR	V	
				ROOF SHAPE	1	GABLE	1.00	B	WDK	N	WOOD DECK	48		90.51	4,345	INTERIOR	V	
				ROOF COVER	2	WOOD SHIN	1.01									KITCHEN	V	
				FLOOR COVER	16	HARDWD/OTHER	1.00									BATHS	V	
				INT. FINISH	22	DRYWLI/DRYWLI	1.00									HEAT	U	
				HEATING/COOL	11	HT-WT/COOL AIR	1.05									ELECT	U	
				FUEL SOURCE	2	GAS	1.00											
CAPACITY		UNITS	ADJ															
STORIES		1.5	1.00															
ROOMS		3	1.00															
BEDROOMS		1	1.00															
FULL BATHS		1	1.00															
1/2 BATHS		0	1.00															
FIXTURES		3	\$3,351															
UNITS		1	1.00															
																EFF.YR/AGE	2022 / 0	
																COND	0 0 %	
																FUNC	0	
																ECON	0	
																DEPR	0 % GD 100	
																RCNLD	\$333,800	