

Key: 427

Town of CHATHAM - Fiscal Year 2024

9/7/2023 9:38 am SEQ #: 487

LEGAL

LAND

DETACHED

BUILDING

CURRENT OWNER		PARCEL ID		LOCATION	
NICKERSON FAMILY ASSOC INC PO BOX 296 N CHATHAM, MA 02650-0296		10K-3-15		1107 ORLEANS RD	
TRANSFER HISTORY		DOS	T	SALE PRICE	BK-PG (Cert)
NICKERSON FAMILY ASSOC I GAHAN JOHN W III		09/02/1994 08/01/1987	K N	50,000	9350-310 5894-249

CLASS	CLASS%	DESCRIPTION		BN ID	BN	CARD	
9560	100	LIBRARIES, MUSEUMS			1	1 of 2	
PMT NO	PMT DT	TY	DESC	AMOUNT	INSP	BY	1st %
	02/28/2023	71	ABC				100 100
	02/14/2022	71	ABC				100 100
	03/02/2020	71	ABC				0 0
	01/31/2018	71	ABC				100 100
	02/15/2017	71	ABC				100 100

CD	T	AC/SF/UN	Nbhd	Inf1	Inf2	ADJ BASE	SAF	Inf3	Lpi	VC	CREDIT AMT	ADJ VALUE
100	S	32,197	MC	1.00	1.00	366,500	1.19	1.00	MR3	1.00		323,420

TOTAL	32,197 SF	ZONING	R60	FRNT	0	ASSESSED	CURRENT	PREVIOUS
Nbhd	MID CHATHAM	NOTE			LAND	323,400	242,600	
Inf1	100		BUILDING	423,200	389,800			
Inf2	100		DETACHED	2,300	2,500			
			OTHER	345,300	318,300			
					TOTAL	1,094,200	953,200	

TY	QUAL	COND	DIM/NOTE	YB	UNITS	ADJ PRICE	RCNLD
S/V	A	1.00	10 0.90 8' WINDMILL		2,500	1.00	2,300



BLDG COMMENTS

NICKERSON HOUSE

BUILDING	CD	ADJ	DESC	MEASURE		
MODEL	1		RESIDENTIAL	LIST REVIEW	7/3/2017	RJM
STYLE	4	1.00	CAPE [100%]			
QUALITY	+	1.20	PLUS AVE [100%]			
FRAME	1	1.00	WOOD FRAME [100%]			

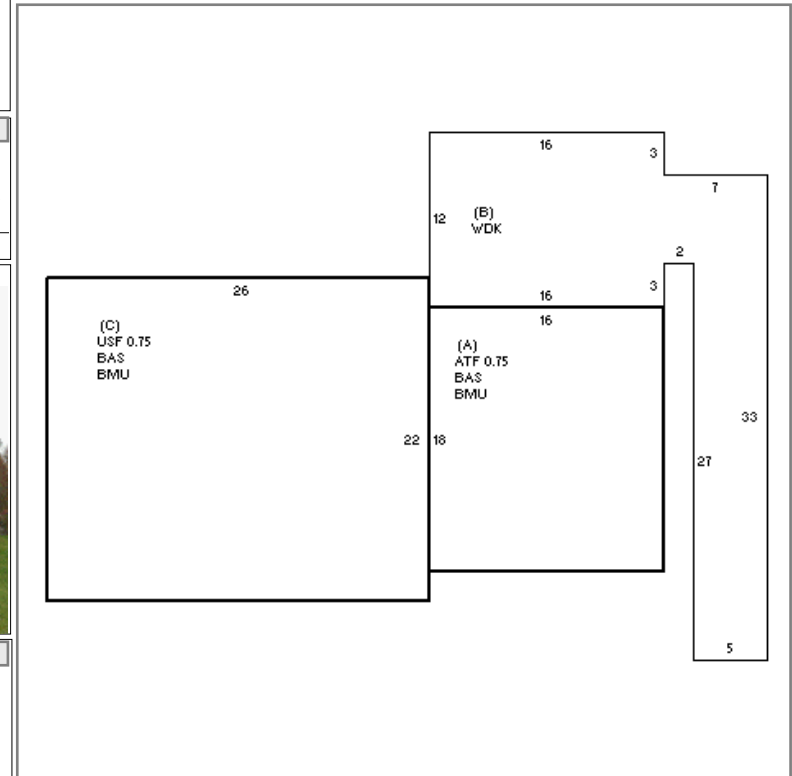

YEAR BLT	1995	SIZE ADJ	1.000
NET AREA	1,505	DETAIL ADJ	1.040
\$NLA(RCN)	\$361	OVERALL	1.000
CAPACITY		UNITS	ADJ
STORIES		1.5	1.00
ROOMS		0	1.00
BEDROOMS		0	1.00
FULL BATHS		0	1.00
1/2 BATHS		1	1.00
FIXTURES		2	\$1,997
UNITS		1	1.00

ELEMENT	CD	DESCRIPTION	ADJ
FOUNDATION	4	FLR & WALL	1.00
EXT. COVER	1	WOOD SHINGLE	1.00
ROOF SHAPE	10	BOW STRING	1.00
ROOF COVER	2	WOOD SHIN	1.01
FLOOR COVER	2	SOFTWOOD	1.00
INT. FINISH	2	DRYWALL	1.00
HEATING/COOL	9	WARM/COOL AIR	1.03
FUEL SOURCE	2	GAS	1.00

S	BAT	T	DESCRIPTION	UNITS	YB	ADJ PRICE	RCN
+	BMU	N	BSMT UNFINISHED	860		90.12	77,502
+	BAS	L	BAS AREA	860	1995	322.93	277,718
A	ATF	L	FINISHED ATTIC	216	1995	194.24	41,957
B	WDK	N	WOOD DECK	369		70.08	25,860
C	USF	L	UP-STRY FIN	429	1995	274.02	117,553

TOTAL RCN	542,587
CONDITION ELEM	CD
EXTERIOR	
INTERIOR	
KITCHEN	
BATHS	
HEAT	
ELECT	
EFF.YR/AGE	1999 / 23
COND	22 22 %
FUNC	0
ECON	0
DEPR	22 % GD 78
RCNLD	\$423,200

Key: 427

Town of CHATHAM - Fiscal Year 2024

9/7/2023 9:38 am SEQ #: 488

LEGAL

CURRENT OWNER				PARCEL ID				LOCATION			
NICKERSON FAMILY ASSOC INC				10K-3-15				1107 ORLEANS RD			
PO BOX 296				TRANSFER HISTORY				DOS	T	SALE PRICE	BK-PG (Cert)
N CHATHAM, MA 02650-0296											

CLASS	CLASS%	DESCRIPTION				BN ID	BN	CARD	
9560	100	LIBRARIES, MUSEUMS					2	2 of 2	
PMT NO	PMT DT	TY	DESC	AMOUNT	INSP	BY	1st	%	

LAND

CD	T	AC/SF/UN	Nbhd	Infl1	Infl2	ADJ BASE	SAF	Infl3	Lpi	VC	CREDIT AMT	ADJ VALUE

TOTAL	ZONING	FRNT	ASSESSED	CURRENT	PREVIOUS
Nbhd	NOTE		LAND	345,300	
Infl1		BUILDING			
Infl2		DETACHED			
			OTHER		
			TOTAL		

TY	QUAL	COND	DIM/NOTE	YB	UNITS	ADJ PRICE	RCNLD	PHOTO
								11/27/2012



BLDG COMMENTS  
 'PRISCILLA ELDREDGE & CALEB NICKERSON  
 MARINER CIRCA 1829

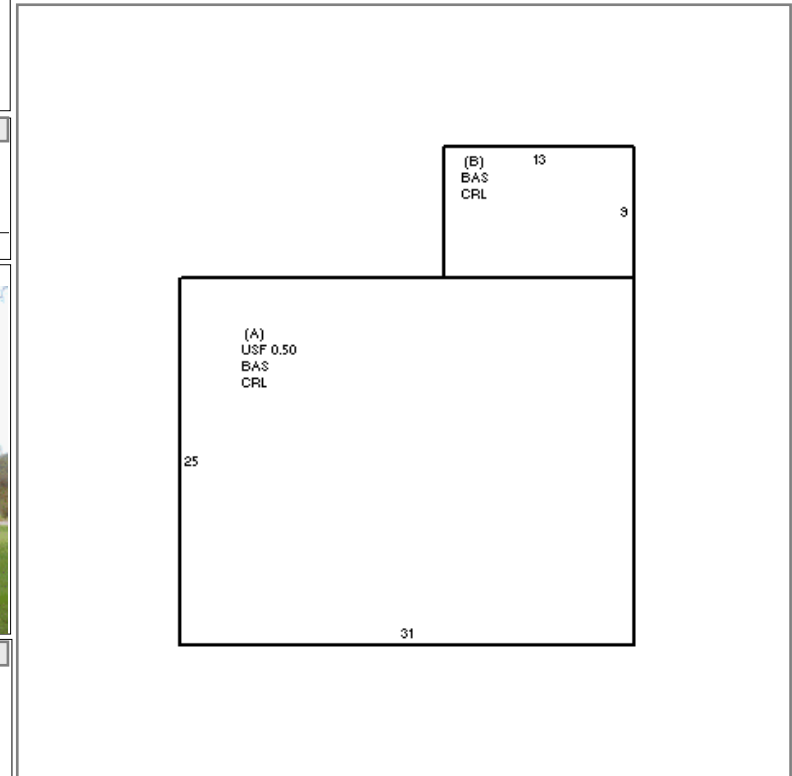

DETACHED

BUILDING	CD	ADJ	DESC	MEASURE		
MODEL	1		RESIDENTIAL	LIST		
STYLE	4	1.00	CAPE [100%]	REVIEW	7/12/2017	ER
QUALITY	+	1.20	PLUS AVE [100%]			
FRAME	1	1.00	WOOD FRAME [100%]			

BUILDING

YEAR BLT	1829	SIZE ADJ	1.000	ELEMENT	CD	DESCRIPTION	ADJ	S	BAT	T	DESCRIPTION	UNITS	YB	ADJ PRICE	RCN	TOTAL RCN	448,393		
NET AREA	1,280	DETAIL ADJ	1.040	FOUNDATION	3	FOUND WALL	1.00	+	CRL	N	CRAWL SPACE	892		26.55	23,686	CONDITION ELEM	CD		
\$NLA(RCN)	\$350	OVERALL	1.000	EXT. COVER	1	WOOD SHINGLE	1.00	+	BAS	L	BAS AREA	892	1829	335.52	299,282	EXTERIOR			
				ROOF SHAPE	1	GABLE	1.00	A	USF	L	UP-STRY FIN	388	1829	284.70	110,464	INTERIOR			
				ROOF COVER	2	WOOD SHIN	1.01		FPL	O	FPL, FIREPLACE	1		9,969.60	9,970	KITCHEN			
				FLOOR COVER	2	SOFTWOOD	1.00									BATHS			
				INT. FINISH	12	PLASTR/DRYWLI	1.00									HEAT			
				HEATING/COOL	9	WARM/COOL AIR	1.03									ELECT			
				FUEL SOURCE	2	GAS	1.00												
																		EFF.YR/AGE	1996 / 26
																		COND	23 23 %
																		FUNC	0
																		ECON	0
																		DEPR	23 % GD 77
																		RCNLD	\$345,300