

Key: 4378

Town of CHATHAM - Fiscal Year 2024

9/7/2023 9:38 am SEQ #: 4.793

LEGALS

CURRENT OWNER				PARCEL ID				LOCATION				
GENOVA FUMIYO 11 CRESCENT RD LEXINGTON, MA 02421				2B-22-C10				22 COUNTRY LN				
				TRANSFER HISTORY				DOS	T	SALE PRICE	BK-PG (Cert)	
				GENOVA FUMIYO				09/17/2019	QS	370,000	(220547)	
MARSTON KAREN				01/19/2007	A	225,470	(182171)					
ABATE CHARLES E & ERMELIA				01/31/2003	A	1	(168095)					

CLASS	CLASS%	DESCRIPTION			BN ID	BN	CARD	
1010	100	SINGLE FAMILY				1	1 of 1	
PMT NO	PMT DT	TY	DESC	AMOUNT	INSP	BY	1st	%
1992070	10/28/2019	98	SALES QUESTI				100	100
	03/11/2008	50	Meas & List			RRC	100	100
	04/27/1992	99	n/a				100	100

LAND

CD	T	AC/SF/UN	Nbhd	Inf1	Inf2	ADJ BASE	SAF	Inf3	Lpi	VC	CREDIT AMT	ADJ VALUE
100	S	10,435	SC	1.00	1.00	586,400	3.09	1.00	R05	1.60		433,840

TOTAL	10,435 SF	ZONING	R20	FRNT	130	ASSESSED	CURRENT	PREVIOUS
Nbhd	SOUTH CHATHAM	NOTE				LAND	433,800	361,500
Inf1	100		BUILDING	101,800	87,300			
Inf2	100		DETACHED	1,300	1,300			
			OTHER	0	0			
						TOTAL	536,900	450,100

DETACHED

TY	QUAL	COND	DIM/NOTE	YB	UNITS	ADJ PRICE	RCNLD
PTD	A	1.00	30 0.70 8X10		80	11.30	600
SHF	A	1.00	30 0.70 8X8		64	16.25	700

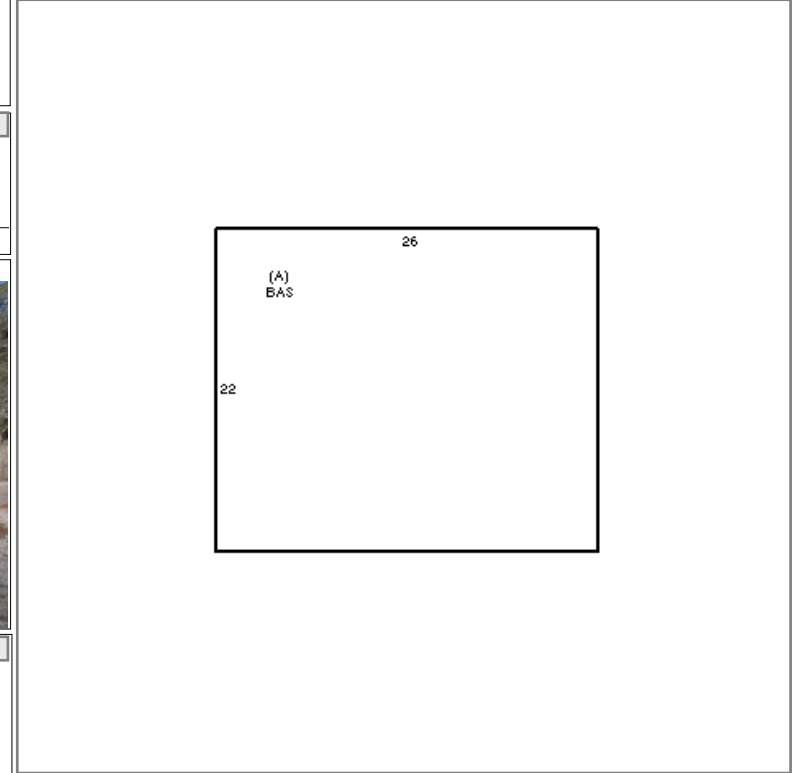

BUILDING

BUILDING	CD	ADJ	DESC	MEASURE	11/29/2021	TCK
MODEL	1		RESIDENTIAL	LIST	11/29/2021	EST
STYLE	6	0.85	COTTAGE [100%]	REVIEW	12/28/2021	MR
QUALITY	A	1.00	AVERAGE [100%]			
FRAME	1	1.00	WOOD FRAME [100%]			

BLDG COMMENTS

G

YEAR BLT	1961	SIZE ADJ	1.000	ELEMENT	CD	DESCRIPTION	ADJ	S	BAT	T	DESCRIPTION	UNITS	YB	ADJ PRICE	RCN	TOTAL RCN	164,222														
NET AREA	572	DETAIL ADJ	0.807	FOUNDATION	2	SLAB	0.95	A	BAS	L	BAS AREA	572	1961	283.72	162,285																
\$NLA(RCN)	\$287	OVERALL	1.000	EXT. COVER	1	WOOD SHINGLE	1.00																								
				ROOF SHAPE	1	GABLE	1.00																								
				ROOF COVER	1	ASPH/CMP SHIN	1.00																								
				FLOOR COVER	2	SOFTWOOD	1.00																								
				INT. FINISH	2	DRYWALL	1.00																								
				HEATING/COOL	1	FORCED AIR	1.00																								
				FUEL SOURCE	2	GAS	1.00																								
				<table border="1"> <thead> <tr> <th>CONDITION ELEM</th> <th>CD</th> </tr> </thead> <tbody> <tr> <td>EXTERIOR</td> <td>A</td> </tr> <tr> <td>INTERIOR</td> <td>F</td> </tr> <tr> <td>KITCHEN</td> <td>F</td> </tr> <tr> <td>BATHS</td> <td>F</td> </tr> <tr> <td>HEAT</td> <td>A</td> </tr> <tr> <td>ELECT</td> <td>U</td> </tr> </tbody> </table>														CONDITION ELEM	CD	EXTERIOR	A	INTERIOR	F	KITCHEN	F	BATHS	F	HEAT	A	ELECT	U
CONDITION ELEM	CD																														
EXTERIOR	A																														
INTERIOR	F																														
KITCHEN	F																														
BATHS	F																														
HEAT	A																														
ELECT	U																														
				<table border="1"> <thead> <tr> <th>EFF.YR/AGE</th> <td>1967 / 55</td> </tr> </thead> <tbody> <tr> <td>COND</td> <td>38 38 %</td> </tr> <tr> <td>FUNC</td> <td>0</td> </tr> <tr> <td>ECON</td> <td>0</td> </tr> <tr> <td>DEPR</td> <td>38 % GD 62</td> </tr> </tbody> </table>														EFF.YR/AGE	1967 / 55	COND	38 38 %	FUNC	0	ECON	0	DEPR	38 % GD 62				
EFF.YR/AGE	1967 / 55																														
COND	38 38 %																														
FUNC	0																														
ECON	0																														
DEPR	38 % GD 62																														
				<table border="1"> <thead> <tr> <th>RCNLD</th> <td>\$101,800</td> </tr> </thead> </table>														RCNLD	\$101,800												
RCNLD	\$101,800																														