

Key: 6094

Town of CHATHAM - Fiscal Year 2024

9/7/2023 9:38 am SEQ #: 6.549

LEGAL LAND

Table with columns: CURRENT OWNER, PARCEL ID, LOCATION, TRANSFER HISTORY, DOS, T, SALE PRICE, BK-PG (Cert). Includes owner info for Howard Evan B & Pamela A Ebeling and transfer history.

Table with columns: CLASS, CLASS%, DESCRIPTION, BN ID, BN, CARD. Includes payment history for items 23-265, 23-193, 23-162, and 22-961.

Table with columns: CD, T, AC/SF/UN, Nbhd, Inf1, Inf2, ADJ BASE, SAF, Inf3, Lpi, VC, CREDIT AMT, ADJ VALUE. Includes totals for assessed, current, and previous values.

Table with columns: TY, QUAL, COND, DIM/NOTE, YB, UNITS, ADJ PRICE, RCNLD. Includes details for DGF lot with dimensions 11x28 and area 308.

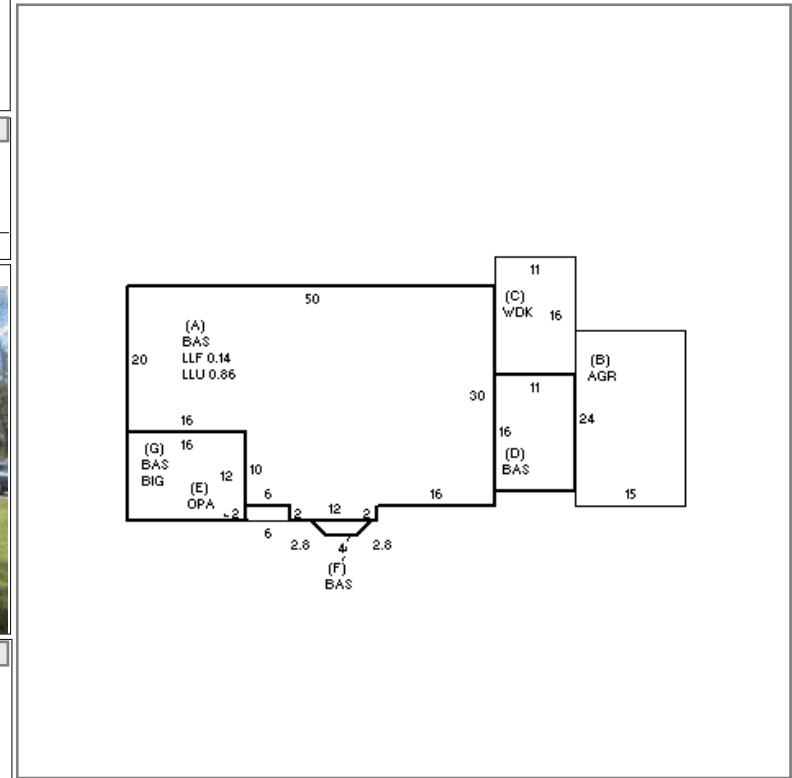

DETAILED

Table with columns: BUILDING, CD, ADJ, DESC, MEASURE, 11/6/2019, NF. Includes building details like RESIDENTIAL RANCH [100%].

BLDG COMMENTS section.

BUILDING

Main table with columns: YEAR BLT, NET AREA, \$NLA(RCN), CAPACITY, UNITS, ADJ, ELEMENT, CD, DESCRIPTION, ADJ, S, BAT, T, DESCRIPTION, UNITS, YB, ADJ PRICE, RCN, TOTAL RCN, 673.866, CONDITION ELEM, CD. Includes detailed room breakdown and capacity information.