

Key: **6095**

**Town of CHATHAM - Fiscal Year 2024**

9/7/2023 9:38 am SEQ #: 6.550

LEGAL

LAND

DETACHED

BUILDING

CURRENT OWNER				PARCEL ID				LOCATION			
RUDNICK ELIZABETH 65 CAPT KENDRICK DR CHATHAM, MA 02633				6H-8-14				65 CAPTAIN KENDRICK DR			
TRANSFER HISTORY				DOS	T	SALE PRICE	BK-PG (Cert)				
RUDNICK ELIZABETH				09/30/2011	H	280,000	25719-296				
LECLAIR WALTER W				01/25/1979	QS	72,000	2862-100				

CLASS	CLASS%	DESCRIPTION				BN ID	BN	CARD	
1010	100	SINGLE FAMILY					1	1 of 1	
PMT NO	PMT DT	TY	DESC	AMOUNT	INSP	BY	1st	%	
15-850	12/22/2015	99	n/a	18,000				100	100
	02/18/2009	50	Meas & List			RRC		100	100

CD	T	AC/SF/UN	Nbhd	Inf1	Inf2	ADJ BASE	SAF	Inf3	Lpi	VC	CREDIT AMT	ADJ VALUE
100	S	29,148	MC	1.00	100	1.00	100	1.00	1.00	R02	1.00	317,880

TOTAL	29,148 SF	ZONING	R60	FRNT	0	ASSESSED	CURRENT	PREVIOUS
Nbhd	MID CHATHAM	NOTE RIVERVIEW				LAND	317,900	264,900
Inf1	100		BUILDING	465,000	422,900			
Inf2	100		DETACHED	0	0			
			OTHER	0	0			
						TOTAL	782,900	687,800

TY	QUAL	COND	DIM/NOTE	YB	UNITS	ADJ PRICE	RCNLD



BLDG COMMENTS

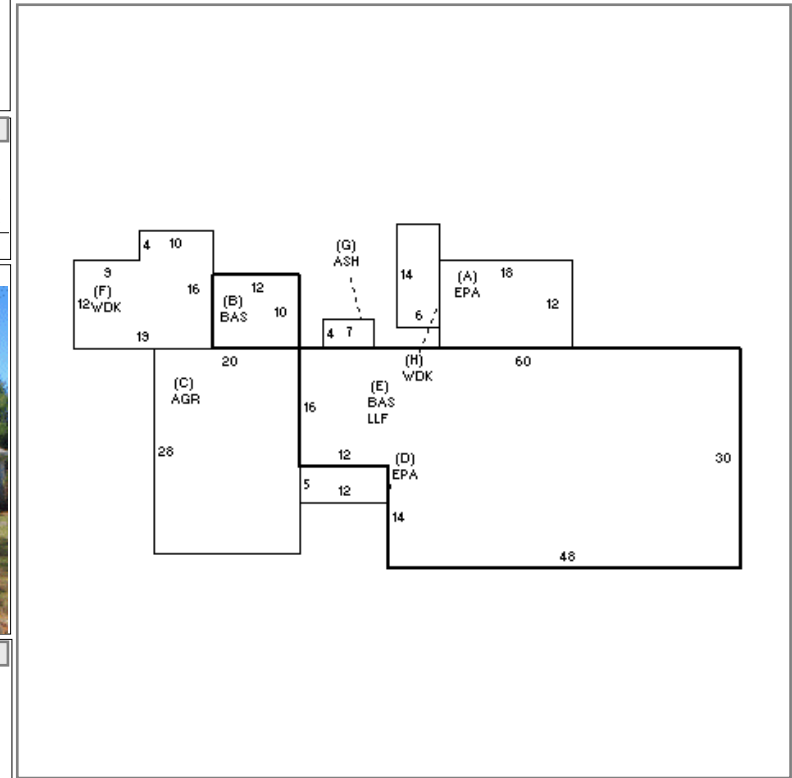

BUILDING	CD	ADJ	DESC	MEASURE	11/6/2019	NF
MODEL	1		RESIDENTIAL	LIST	11/6/2019	EST
STYLE	1	0.85	RANCH [100%]	REVIEW	11/13/2019	EMZ
QUALITY	A	1.00	AVERAGE [100%]			
FRAME	1	1.00	WOOD FRAME [100%]			

YEAR BLT	1968	SIZE ADJ	1.000	ELEMENT	CD	DESCRIPTION	ADJ	S	BAT	T	DESCRIPTION	UNITS	YB	ADJ PRICE	RCN	TOTAL RCN	683,761														
NET AREA	1,752	DETAIL ADJ	0.850	FOUNDATION	4	FLR & WALL	1.00	+	EPA	N	ENCL PORCH	276		133.70	36,901																
\$NLA(RCN)	\$390	OVERALL	1.000	EXT. COVER	1	WOOD SHINGLE	1.00	+	BAS	L	BAS AREA	1,752	1968	192.93	338,019																
				ROOF SHAPE	1	GABLE	1.00	C	AGR	N	ATTACHED GARAGE	560		77.34	43,312																
				ROOF COVER	1	ASPH/CMP SHIN	1.00	E	LLF	N	LOWER LEVEL FIN	1,632		141.98	231,718																
				FLOOR COVER	13	HARDWD/CARPET	1.00	+	WDK	N	WOOD DECK	352		58.40	20,557																
				INT. FINISH	2	DRYWALL	1.00	G	ASH	N	ATT SHED	28		60.61	1,697																
				HEATING/COOL	2	HOT WATER	1.00	F11	O		FPL 1S 1OP	1		7,477.00	7,477																
				FUEL SOURCE	2	GAS	1.00																								
<table border="1"> <tr> <td>CONDITION ELEM</td> <td>CD</td> </tr> <tr> <td>EXTERIOR</td> <td>A</td> </tr> <tr> <td>INTERIOR</td> <td>A</td> </tr> <tr> <td>KITCHEN</td> <td>A</td> </tr> <tr> <td>BATHS</td> <td>A</td> </tr> <tr> <td>HEAT</td> <td>A</td> </tr> <tr> <td>ELECT</td> <td>A</td> </tr> </table>																	CONDITION ELEM	CD	EXTERIOR	A	INTERIOR	A	KITCHEN	A	BATHS	A	HEAT	A	ELECT	A	
CONDITION ELEM	CD																														
EXTERIOR	A																														
INTERIOR	A																														
KITCHEN	A																														
BATHS	A																														
HEAT	A																														
ELECT	A																														
<table border="1"> <tr> <td>EFF.YR/AGE</td> <td colspan="2">1971 / 51</td> </tr> <tr> <td>COND</td> <td>32</td> <td>32 %</td> </tr> <tr> <td>FUNC</td> <td colspan="2">0</td> </tr> <tr> <td>ECON</td> <td colspan="2">0</td> </tr> <tr> <td>DEPR</td> <td>32</td> <td>% GD 68</td> </tr> </table>																	EFF.YR/AGE	1971 / 51		COND	32	32 %	FUNC	0		ECON	0		DEPR	32	% GD 68
EFF.YR/AGE	1971 / 51																														
COND	32	32 %																													
FUNC	0																														
ECON	0																														
DEPR	32	% GD 68																													
RCNLD																\$465,000															