

Key: 7007

Town of CHATHAM - Fiscal Year 2024

9/7/2023 9:38 am SEQ #: 7.489

LEGAL LAND

Table with columns: CURRENT OWNER, PARCEL ID, LOCATION, TRANSFER HISTORY, DOS, T, SALE PRICE, BK-PG (Cert). Includes owner HILBERT ERIC E & LISA P and parcel 8H-10-C395.

Table with columns: CLASS, CLASS%, DESCRIPTION, BN ID, BN, CARD. Includes PMT NO, PMT DT, TY, DESC, AMOUNT, INSP, BY, 1st, %.

Table with columns: CD, T, AC/SF/UN, Nbhd, Inf1, Inf2, ADJ BASE, SAF, Inf3, Lpi, VC, CREDIT AMT, ADJ VALUE. Includes totals for assessed, current, and previous values.

Table with columns: TY, QUAL, COND, DIM/NOTE, YB, UNITS, ADJ PRICE, RCNLD. Includes rows for IPV and PTD.

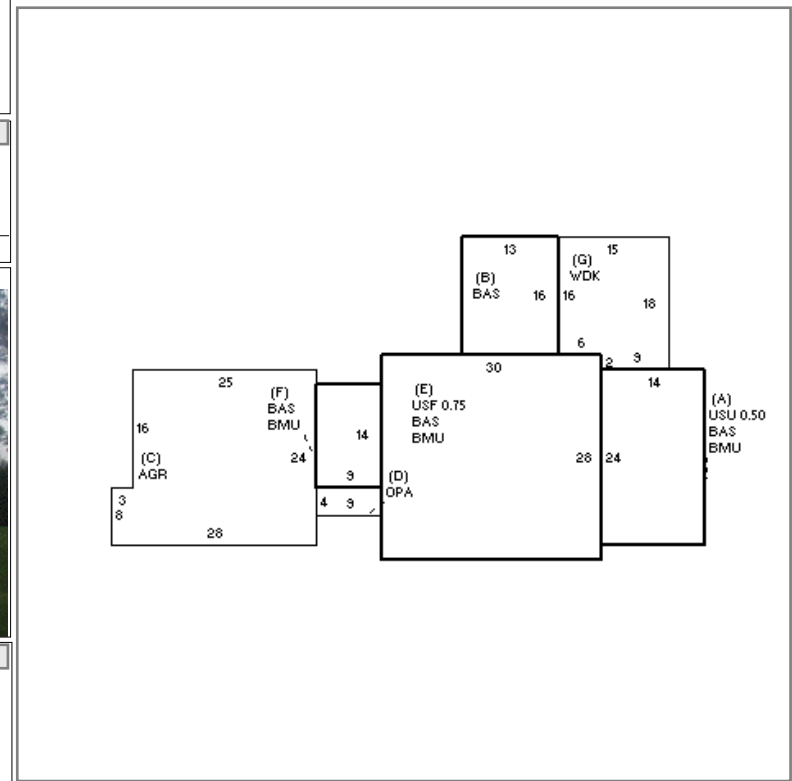

Table with columns: BUILDING, CD, ADJ, DESC, MEASURE, LIST, REVIEW. Includes details for residential building quality and frame.

Table with columns: BLDG COMMENTS. Includes text: HATCH TO ATTIC.

DETACHED

BUILDING

Large summary table with columns: YEAR BLT, NET AREA, \$NLA(RCN), CAPACITY, UNITS, ADJ, ELEMENT, CD, DESCRIPTION, ADJ, S, BAT, T, DESCRIPTION, UNITS, YB, ADJ PRICE, RCN, TOTAL RCN, CONDITION ELEM, CD, EFF.YR/AGE, COND, FUNC, ECON, DEPR, RCNLD. Includes detailed breakdown of building elements and costs.