

Key: 7097

Town of CHATHAM - Fiscal Year 2024

9/7/2023 9:38 am SEQ #: 7.580

LEGAL LAND

Table with columns: CURRENT OWNER, PARCEL ID, LOCATION, TRANSFER HISTORY, DOS, T, SALE PRICE, BK-PG (Cert). Includes owner info for Nelson Charles & Werner Gwen and transfer history from 2021 to 2025.

Table with columns: CLASS, CLASS%, DESCRIPTION, BN ID, BN, CARD. Includes details for Class 1010 (Single Family) with renovation and reroof entries.

Table with columns: CD, T, AC/SF/UN, Nbhd, Infl1, Infl2, ADJ BASE, SAF, Infl3, Lpi, VC, CREDIT AMT, ADJ VALUE. Includes summary rows for TOTAL, NBHD, and INFL.

Table with columns: TY, QUAL, COND, DIM/NOTE, YB, UNITS, ADJ PRICE, RCNLD. Includes rows for EPA and HTB with quality and condition metrics.

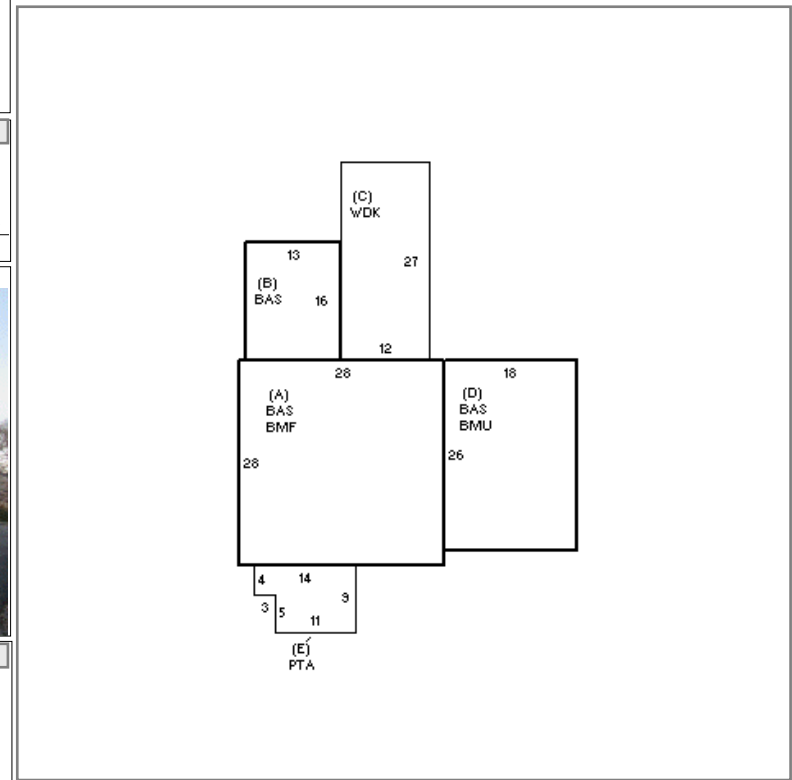

Table with columns: BUILDING, CD, ADJ, DESC, MEASURE, 11/25/2019, TCK. Includes details for building model, style, quality, and frame.

Table with columns: BLDG COMMENTS. Includes text: BMF=OFFICE/DEN,1FBTH.

DETACHED

BUILDING

Large table with columns: YEAR BLT, NET AREA, \$NLA(RCN), CAPACITY, UNITS, ADJ, ELEMENT, CD, DESCRIPTION, ADJ, S, BAT, T, DESCRIPTION, UNITS, YB, ADJ PRICE, RCN, TOTAL RCN, CONDITION ELEM, CD. Includes detailed building specifications and a summary of RCN values.