

Key: 7143

Town of CHATHAM - Fiscal Year 2024

9/7/2023 9:38 am SEQ #: 7.626

LEGAL LAND

Table with columns: CURRENT OWNER, PARCEL ID, LOCATION, TRANSFER HISTORY, DOS, T, SALE PRICE, BK-PG (Cert). Includes owner TIMMINS ANNE M and parcel 8J-40-C287.

Table with columns: CLASS, CLASS%, DESCRIPTION, BN ID, BN, CARD. Includes entries for 1010, 100, SINGLE FAMILY, 14-384, 10-094, 97-303.

Table with columns: TOTAL, 33,068 SF, ZONING, R60, FRNT, 0, ASSESSED, CURRENT, PREVIOUS. Includes sub-table for NBHD, INF1, INF2.

Table with columns: TY, QUAL, COND, DIM/NOTE, YB, UNITS, ADJ PRICE, RCNLD. Includes row for SHF A 1.00 30 0.70 8X12.

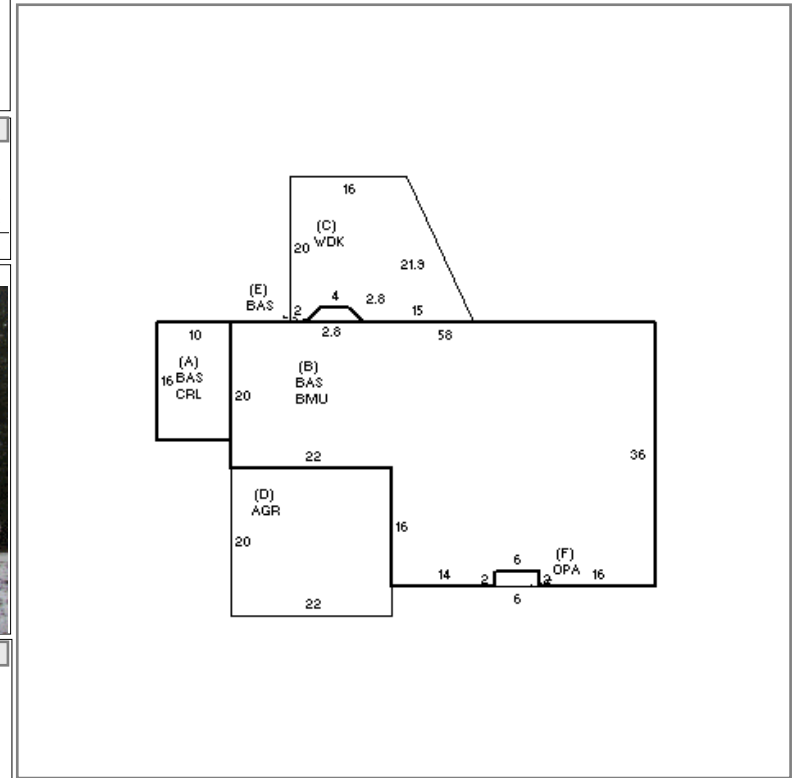

Table with columns: BUILDING, CD, ADJ, DESC, MEASURE, 12/13/2019, TCK. Includes rows for MODEL, STYLE, QUALITY, FRAME.

Table with columns: BLDG COMMENTS.

DETACHED

BUILDING

Large summary table with columns: YEAR BLT, NET AREA, \$NLA(RCN), CAPACITY, UNITS, ADJ, ELEMENT, CD, DESCRIPTION, ADJ, S, BAT, T, DESCRIPTION, UNITS, YB, ADJ PRICE, RCN, TOTAL RCN, 600,958, CONDITION ELEM, CD, EFF. YR/AGE, 1973 / 49, COND, FUNC, ECON, DEPR, 30 % GD, 70, RCNLD, \$420,700.