

Key: 7490

Town of CHATHAM - Fiscal Year 2024

9/7/2023 9:38 am SEQ #: 7.998

LEGAL

LAND

DETACHED

BUILDING

| CURRENT OWNER | | | | PARCEL ID | | | | LOCATION | | | |
|--|--|--|--|------------|----|------------|--------------|--------------------|--|--|--|
| JOSEPH RAYMOND F JR & DENNEEN M 10 THOMPSONS TRACE CHATHAM, MA 02633 | | | | 9G-11-T10 | | | | 10 THOMPSONS TRACE | | | |
| TRANSFER HISTORY | | | | DOS | T | SALE PRICE | BK-PG (Cert) | | | | |
| JOSEPH RAYMOND F JR & DEN THOMS CHARLES D | | | | 07/11/2012 | QS | 407,050 | 26492-39 | | | | |
| | | | | 02/11/1998 | A | 11219-298 | 1 | | | | |

| CLASS | CLASS% | DESCRIPTION | | | BN ID | BN | CARD | |
|--------|------------|---------------|--------------|--------|------------|-----|--------|-----|
| 1010 | 100 | SINGLE FAMILY | | | | 1 | 1 of 1 | |
| PMT NO | PMT DT | TY | DESC | AMOUNT | INSP | BY | 1st | % |
| 21-551 | 06/14/2021 | 3 | Renovations | 14,730 | 03/24/2022 | TCK | 100 | 100 |
| 21-321 | 03/30/2021 | 77 | SOLAR PANELS | 32,900 | 12/18/2019 | NF | 100 | 100 |
| 16-789 | 11/28/2016 | 3 | Cyc. Reinsp. | | 06/01/2017 | NF | 100 | 100 |
| 13-259 | 05/14/2013 | 11 | Window Rplc | 2,200 | 04/11/2014 | SF | 100 | 100 |

| CD | T | AC/SF/UN | Nbhd | Inf1 | Inf2 | ADJ BASE | SAF | Inf3 | Lpi | VC | CREDIT AMT | ADJ VALUE |
|-------|---|----------|------|------|------|-------------|------------|----------|----------|---------|------------|-----------|
| 100 | S | 40,000 | MC | 1.00 | 100 | 1.00 | 100 | 1.00 | R03 | 1.00 | | 336,550 |
| 300 | A | 0.011 | MC | 1.00 | 100 | 1.00 | 100 | 1.00 | R03 | 1.00 | | 210 |
| TOTAL | | | | | | 40,473 SF | ZONING R60 | FRNT 0 | ASSESSED | | CURRENT | PREVIOUS |
| Nbhd | | | | | | MID CHATHAM | NOTE | LAND | | 336,800 | 280,600 | |
| Inf1 | | | | | | 100 | | BUILDING | | 431,600 | 392,800 | |
| Inf2 | | | | | | 100 | | DETACHED | | 2,000 | 1,900 | |
| | | | | | | | | OTHER | | 0 | 0 | |
| TOTAL | | | | | | | | TOTAL | | 770,400 | 675,300 | |

| TY | QUAL | COND | DIM/NOTE | YB | UNITS | ADJ PRICE | RCNLD | PHOTO |
|-----|------|------|----------|------|-------|-----------|-------|------------|
| PTD | A | 1.00 | 30 0.70 | 1975 | 256 | 11.30 | 2,000 | 03/24/2022 |

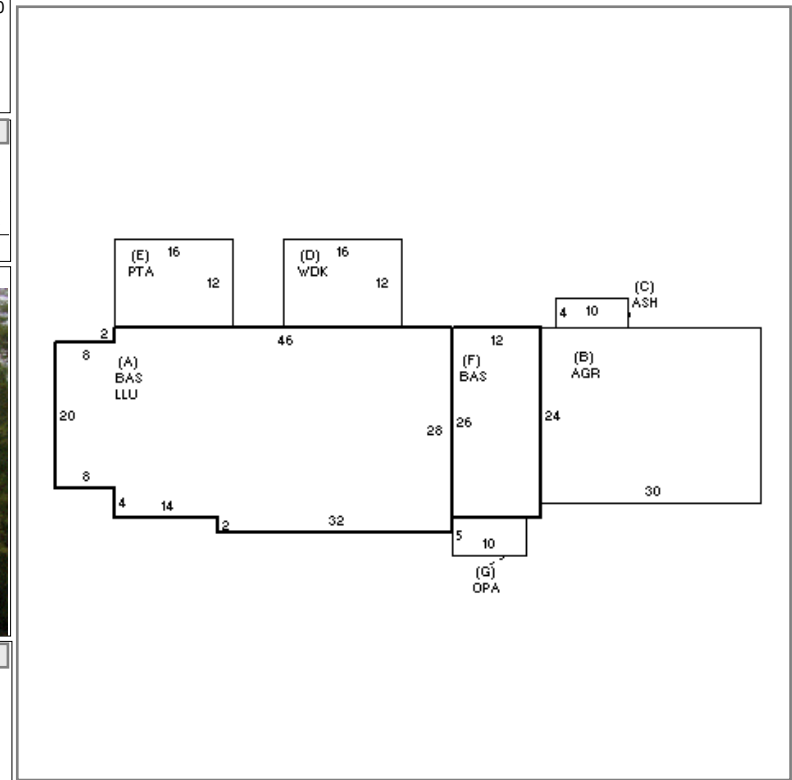

| BUILDING | CD | ADJ | DESC | MEASURE | 12/18/2019 | NF |
|----------|----|------|-------------------|-----------------|------------|-----|
| MODEL | 1 | | RESIDENTIAL | LIST | 12/18/2019 | EST |
| STYLE | 1 | 0.85 | RANCH [100%] | REVIEW | 4/4/2022 | EMZ |
| QUALITY | A | 1.00 | AVERAGE [100%] | BLDG COMMENTS | | |
| FRAME | 1 | 1.00 | WOOD FRAME [100%] | 51 SOLAR PANELS | | |

| YEAR BLT | 1985 | SIZE ADJ | 1.000 | ELEMENT | CD | DESCRIPTION | ADJ | S | BAT | T | DESCRIPTION | UNITS | YB | ADJ PRICE | RCN | TOTAL RCN | 583,252 |
|------------|-------|------------|-------|--------------|----|---------------|------|-----|-----|-----------------|-----------------|-------|----------|-----------|---------|----------------|-----------|
| NET AREA | 1,732 | DETAIL ADJ | 0.850 | FOUNDATION | 4 | FLR & WALL | 1.00 | A | LLU | N | LOWER LEVEL UN | 1,420 | | 109.67 | 155,735 | CONDITION ELEM | CD |
| \$NLA(RCN) | \$337 | OVERALL | 1.000 | EXT. COVER | 1 | WOOD SHINGLE | 1.00 | B | AGR | N | ATTACHED GARAGE | 720 | | 75.60 | 54,434 | EXTERIOR | A |
| CAPACITY | | | | ROOF SHAPE | 1 | GABLE | 1.00 | C | ASH | N | ATT SHED | 40 | | 60.60 | 2,424 | INTERIOR | A |
| STORIES | 7 | | 1.00 | ROOF COVER | 1 | ASPH/CMP SHIN | 1.00 | D | WDK | N | WOOD DECK | 192 | | 58.40 | 11,213 | KITCHEN | A |
| ROOMS | 7 | | 1.00 | FLOOR COVER | 31 | CARPET/HARDWD | 1.00 | E | PTA | N | PATIO/STOOP | 192 | | 17.90 | 3,437 | BATHS | A |
| BEDROOMS | 4 | | 1.00 | INT. FINISH | 2 | DRYWALL | 1.00 | + | BAS | L | BAS AREA | 1,732 | 1985 | 194.65 | 337,130 | BATHS | A |
| FULL BATHS | 3 | | 1.00 | HEATING/COOL | 1 | FORCED AIR | 1.00 | G | OPA | N | OPEN PORCH | 50 | | 76.10 | 3,805 | HEAT | A |
| 1/2 BATHS | 0 | | 1.00 | FUEL SOURCE | 1 | OIL | 1.00 | F11 | O | FPL 1S 1OP | 1 | | 7,477.00 | 7,477 | ELECT | A | |
| FIXTURES | 9 | \$6,120 | | | | | | ODS | O | OUT DOOR SHWR-A | 1 | | 1,477.00 | 1,477 | | | |
| UNITS | 1 | 1.00 | | | | | | | | | | | | | | EFF.YR/AGE | 1985 / 37 |
| COND | | | | | | | | | | | | | | | | 26 | 26 % |
| FUNC | | | | | | | | | | | | | | | | 0 | |
| ECON | | | | | | | | | | | | | | | | 0 | |
| DEPR | | | | | | | | | | | | | | | | 26 | % GD 74 |
| RCNLD | | | | | | | | | | | | | | | | \$431,600 | |