

Key: 8517

Town of CHATHAM - Fiscal Year 2024

9/7/2023 9:38 am SEQ #: 8.837

LEGAL

CURRENT OWNER						PARCEL ID			LOCATION		
DENISE L MEAGHER IRREV TR 2021 MEAGHER JR ANDREW & GOYETTE ELISE COTR 2096 MA 28 HEAD OF THE BAY HARWICH, MA 02645						15D-15-X18			593 MAIN ST		
TRANSFER HISTORY						DOS	T	SALE PRICE	BK-PG (Cert)		
DENISE L MEAGHER IRREV TR						05/17/2022	QS	575,000	35124-289		
OLSON CHRISTOPHER M &						09/20/2021	A	1	34485-240		
OLSON CHRISTOPHER M						12/17/2012	QS	312,500	26958-22		

CLASS	CLASS%	DESCRIPTION			BN ID	BN	CARD	
1020	100	CONDOMINIUM				1	1 of 1	
PMT NO	PMT DT	TY	DESC	AMOUNT	INSP	BY	1st	%
	02/16/2022	3	Renovations		02/16/2022	APK	100	100

LAND

CD	T	AC/SF/UN	Nbhd	Infl1	Infl2	ADJ BASE	SAF	Infl3	Lpi	VC	CREDIT AMT	ADJ VALUE

TOTAL	SF	ZONING	GB1	FRNT	0	ASSESSED	CURRENT	PREVIOUS
Nbhd		NOTE				LAND	0	0
Infl1			BUILDING	539,600	482,200			
Infl2			DETACHED	0	0			
			OTHER	0	0			
						TOTAL	539,600	482,200

DETACHED

TY	QUAL	COND	DIM/NOTE	YB	UNITS	ADJ PRICE	RCNLD

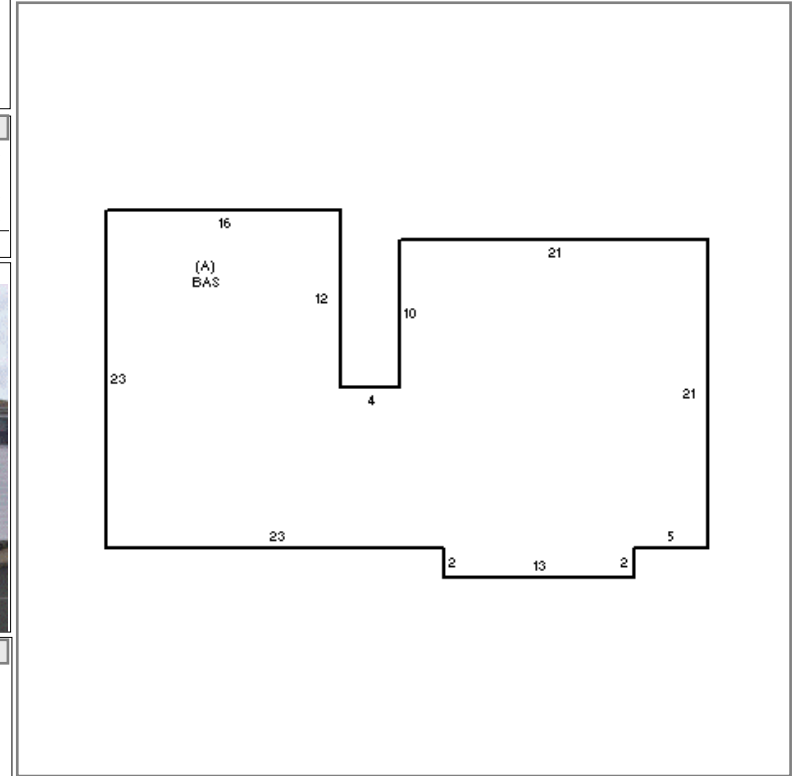

BUILDING

BUILDING	CD	ADJ	DESC	MEASURE	10/6/2016	APK
MODEL	10		CONDO	LIST		
STYLE	5	1.00	GARDEN END [100%]	REVIEW	2/16/2022	APK
QUALITY	G	1.20	GOOD [100%]			
FRAME	99	1.00	N/A [100%]			

BLDG COMMENTS

DSF=896 APARTMENT

BUILDING

YEAR BLT	1999	SIZE ADJ	1.000	ELEMENT	CD	DESCRIPTION	ADJ	S	BAT	T	DESCRIPTION	UNITS	YB	ADJ PRICE	RCN	TOTAL RCN	539,562		
NET AREA	879	DETAIL ADJ	1.617	COMPLEX	75	HIGHWHEELER SQ	2.00	A	BAS	L	BAS AREA	879	1999	607.67	534,146	CONDITION ELEM CD			
\$NLA(RCN)	\$614	OVERALL	1.000	UNIT MODEL	5	CMLPX 75 GARDEN	0.70		WDK	N	ATT WOOD DECK	40		19.00	760	INTERIOR	G		
CAPACITY			UNITS	ADJ		VIEW/LOC	1.10									KITCHEN	G		
ROOMS	4	1.00				HVAC	1.05									BATHS	G		
BEDROOMS	2	1.00				FUEL SOURCE	1.00									EXTERIOR	G		
FULL BATHS	1	1.00				FLOOR LEVEL	1.00									EFF.YR/AGE 2020 / 2			
1/2 BATHS	0	1.00				NEIGHBORHOOD	1.00									COND	0 0 %		
FIXTURES	3	\$4,656														FUNC	0		
																	ECON	0	
																	DEPR	0 % GD	100
																	RCNLD	\$539,600	