

| CURRENT OWNER | | TOPO | UTILITIES | STRT / ROAD | LOCATION | CURRENT ASSESSMENT | | | | 905 DUXBURY, MA VISION |
|-------------------|--|---|------------|-------------|---|--------------------|---------|-----------|----------|---|
| GRIFFIN RORY M | | | 0 Water | 0 Two-Way | 0 Average | Description | Code | Appraised | Assessed | |
| GRIFFIN SABRINA M | | | 0 No Sewer | 0 Paved | 0 Average | RESIDNTL | 1010 | 530,900 | 530,900 | |
| 21 CRANBERRY DR | | SUPPLEMENTAL DATA | | | RES LAND | 1010 | 360,800 | 360,800 | | |
| DUXBURY MA 02332 | | Alt Prcl ID Scnd Home Tax Class T Tot Fin Area 2720 Total Acres 1.227 Chapter Lan GIS ID F_855940_2840284 | | | Cyclical 1 Exemption W District Res Exem Assoc Pid# | RESIDNTL | 1010 | 4,500 | 4,500 | |
| | | | | | | Total | | 896,200 | 896,200 | |

| RECORD OF OWNERSHIP | | BK-VOL/PAGE | SALE DATE | Q/U | V/I | SALE PRICE | VC | PREVIOUS ASSESSMENTS (HISTORY) | | | | | |
|----------------------------------|-------|-------------|------------|-----|-----|------------|----|--------------------------------|------|----------|-------|------|----------|
| GRIFFIN RORY M | 51154 | 223 | 05-28-2019 | Q | I | 605,000 | 00 | Year | Code | Assessed | Year | Code | Assessed |
| MACKIN GREGORY J & LISA TRUSTEES | 41148 | 0001 | 03-27-2012 | U | I | 1 | 1A | 2023 | 1010 | 406,300 | 2022 | 1010 | 372,600 |
| MACKIN GREGORY J | 41147 | 0333 | 03-27-2012 | U | I | 1 | 1A | | 1010 | 375,200 | | 1010 | 309,300 |
| MACKIN GREGORY & LISA TT | 39644 | 0127 | 02-09-2011 | U | I | 1 | 1F | | 1010 | 3,000 | | 1010 | 3,000 |
| MACKIN GREGORY J | 14904 | 0328 | 01-10-1997 | Q | I | 146,500 | 00 | Total | | 784,500 | Total | | 684,900 |
| | | | | | | | | Total | | 591,300 | Total | | 591,300 |

| EXEMPTIONS | | | OTHER ASSESSMENTS | | | | This signature acknowledges a visit by a Data Collector or Assessor | | | | |
|------------|------|-------------|-------------------|------|-------------|--------|---|------|-----|--|--|
| Year | Code | Description | Amount | Code | Description | Number | Amount | Comm | Int | | |
| | | | | | | | | | | | |
| Total | | | 0.00 | | | | | | | | |

| ASSESSING NEIGHBORHOOD | | | | APPRAISED VALUE SUMMARY | | | |
|------------------------|-----------|---|---------|-------------------------|-------------------------------|---------|--|
| Nbhd | Nbhd Name | B | Tracing | Batch | Appraised Bldg. Value (Card) | 530,900 | |
| 0050 | | | | | Appraised Xf (B) Value (Bldg) | 0 | |
| | | | | | Appraised Ob (B) Value (Bldg) | 4,500 | |
| | | | | | Appraised Land Value (Bldg) | 360,800 | |
| | | | | | Special Land Value | 0 | |
| | | | | | Total Appraised Parcel Value | 896,200 | |
| | | | | | Valuation Method | C | |
| | | | | | Total Appraised Parcel Value | 896,200 | |

| NOTES | | | | | | | | | | VISIT / CHANGE HISTORY | | | | |
|-----------|------------|------|-------------|---------|------------|--------|-----------|----------------------|------------|------------------------|------|----|----|-----------------------|
| Permit Id | Issue Date | Type | Description | Amount | Insp Date | % Comp | Date Comp | Comments | Date | Id | Type | Is | Cd | Purpose/Result |
| 76 | 03-10-2004 | RM | Remodel | 150,000 | 06-30-2005 | 100 | | REFRB FIRE DAMAGE/AD | 03-09-2020 | SJD | 9 | 1 | 07 | Measure - Info @ Door |
| 395 | 07-31-2003 | DM | Demolish | 2,500 | 06-29-2004 | 100 | | DEMO FIRE DAMAGE SEC | 04-12-2013 | VGS | | | 20 | Field Review |
| 14794 | 01-21-1998 | AD | Addition | 13,000 | 05-12-1998 | 100 | | 15X18 3 SEASON ROOM | 03-26-2013 | AO | 6 | 6 | 30 | Quality Control |
| 14358 | 01-22-1997 | RM | Remodel | 12,000 | | 100 | | KITCHEN/CTHDLRCEILNG | 08-17-2005 | KP | | 1 | 00 | Measure & Listed |

| LAND LINE VALUATION SECTION | | | | | | | | | | | | | Notes | | | Location Adjustment | | Adj Unit P | | Land Value |
|-----------------------------|----------|---------------|------|-----------|------------|------------|------------------------|------------|-------|-------|-----------|-------|------------------|--|--------|---------------------|---------|------------|--|------------|
| B | Use Code | Description | Zone | Land Type | Land Units | Unit Price | Size Adj | Site Index | Cond. | Nbhd. | Nbhd. Adj | | | | | | | | | |
| 1 | 1010 | Single Family | RC | Primary | 40,000 | SF | 8.75 | 1.00000 | 5 | 1.00 | 0050 | 1.000 | | | 1.0000 | 8.75 | 350,000 | | | |
| 1 | 1010 | Single Family | WP | Residual | 0.309 | AC | 35,000.00 | 1.00000 | 5 | 1.00 | 0050 | 1.000 | | | 1.0000 | 0.80 | 10,800 | | | |
| Total Card Land Units | | | | | 1.23 | AC | Parcel Total Land Area | | | | | 1.23 | Total Land Value | | | 360,800 | | | | |

| CONSTRUCTION DETAIL | | | CONSTRUCTION DETAIL (CONTINUED) | | |
|---------------------|------|---------------|---------------------------------|------|-------------|
| Element | Cd | Description | Element | Cd | Description |
| Style | 03 | Colonial | Bsmt Area | 1428 | |
| Model | 01 | Residential | Bsmt Type | 04 | |
| Grade | 05 | Ave/Good | Unfin Area | 0.00 | Full |
| Stories | 2 | | | | |
| Occupancy | 1 | | CONDO DATA | | |
| Exterior Wall 1 | 25 | Vinyl Siding | Parcel Id | | C |
| Exterior Wall 2 | | | | | B |
| Roof Structure | 03 | Gable | Adjust Type | Code | Description |
| Roof Cover | 03 | Asphalt | Condo Flr | | Factor% |
| Interior Wall 1 | 05 | Drywall | Condo Unit | | |
| Interior Wall 2 | | | COST / MARKET VALUATION | | |
| Interior Floor 1 | 12 | Hardwood | | | 575,782 |
| Interior Floor 2 | | | Net Other Adj | | 41,600 |
| Heat Fuel | 03 | Gas | Replace Cost | | 617,382 |
| Heat Type | 05 | Hot Water | Year Built | | 1971 |
| AC Type | 03 | Central | Effective Year Built | | 2007 |
| Bedrooms | 3 | | Depreciation Code | | E |
| Full Baths | 3 | | Remodel Rating | | |
| Half Baths | 0 | | Year Remodeled | | |
| Extra Fixtures | 0 | | Depreciation % | | 14 |
| Total Rooms | 7 | | Functional Obsol | | |
| Bath Style | 03 | Modern | External Obsol | | |
| Kitchen Style | 03 | Modern | Trend Factor | | 1.000 |
| Extra Kitchens | 0 | | Condition | | |
| Fireplaces | | | Condition % | | |
| Extra Openings | 0 | | Percent Good | | 86 |
| Gas Fireplaces | 2 | | Cns Sect Rcnld | | 530,900 |
| Sq Ft Fin Bsmt | 600 | | Dep % Ovr | | |
| FBM Quality | 04 | Above Average | Dep Ovr Comment | | |
| Foundation | 06 | Poured Conc | Misc Imp Ovr | | |
| Bsmt Garage | 0 | | Misc Imp Ovr Comment | | |
| Bsmt Area | 1428 | | Cost to Cure Ovr | | |
| | | | Cost to Cure Ovr Comment | | |

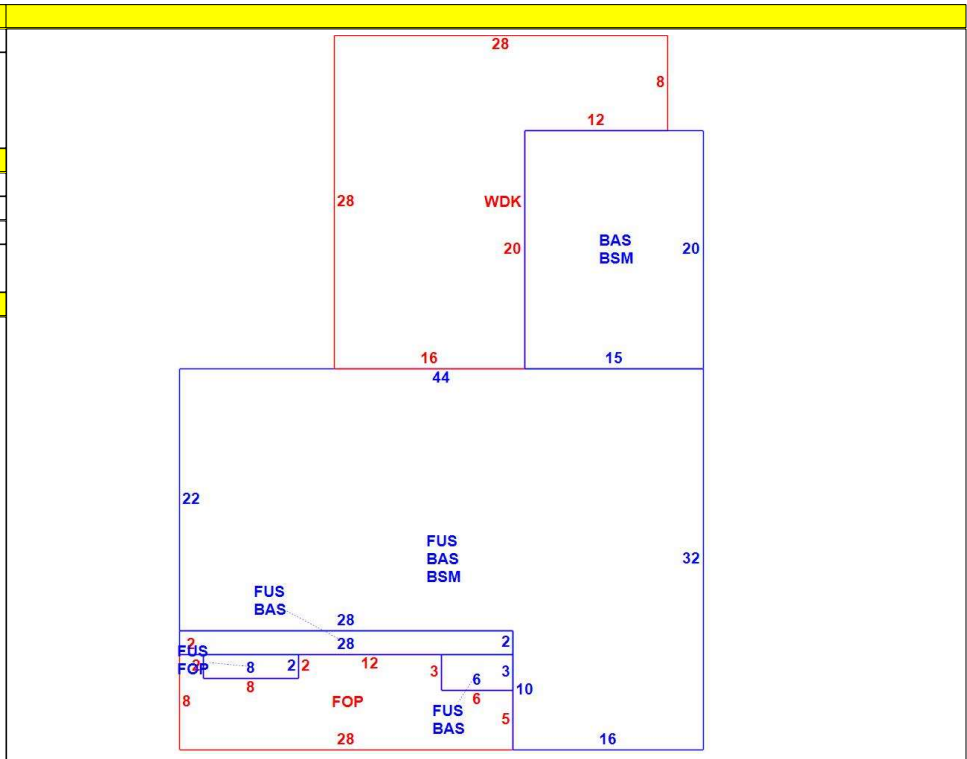

| OB - OUTBUILDING & YARD ITEMS(L) / XF - BUILDING EXTRA FEATURES(B) | | | | | | | | | | |
|--|-------------|-----|-------|------------|--------|----------|------|-------|------------|-------------|
| Code | Description | L/B | Units | Unit Price | Yr Blt | Cond. Cd | % Gd | Grade | Grade Adj. | Appr. Value |
| SHD1 | Shed | L | 160 | 21.00 | 1980 | A | 70 | C | 1.00 | 2,400 |
| SHD1 | Shed | L | 144 | 21.00 | 2000 | A | 70 | C | 1.00 | 2,100 |

| BUILDING SUB-AREA SUMMARY SECTION | | | | | | |
|-----------------------------------|----------------------|-------------|------------|----------|-----------|----------------|
| Code | Description | Living Area | Floor Area | Eff Area | Unit Cost | Undeprec Value |
| BAS | First Floor | 1,502 | 1,502 | 1,502 | 186.28 | 279,788 |
| BSM | Basement | 0 | 1,428 | 286 | 37.31 | 53,275 |
| FOP | Open Porch | 0 | 206 | 31 | 28.03 | 5,775 |
| FUS | Finished Upper Story | 1,218 | 1,218 | 1,218 | 186.28 | 226,885 |
| WDK | Deck | 0 | 544 | 54 | 18.49 | 10,059 |
| Ttl Gross Liv / Lease Area | | 2,720 | 4,898 | 3,091 | | 575,782 |

