

| CURRENT OWNER | | TOPO | | UTILITIES | | STRT / ROAD | | LOCATION | | CURRENT ASSESSMENT | | | | 905 DUXBURY, MA VISION | | | | | |
|---|------------|-------------------|-------------|--------------------|------------|-------------------------------|------------------------|---|---------|-------------------------------|------------|---|----------|---|------------------|--------------------|----------------|---------|----------|
| LAFOREST ELIZABETH 793 WEST ST DUXBURY MA 02332 | | 0 | Water | 0 | Arterial | 0 | Average | Description | Code | Appraised | Assessed | RESIDENTL RES LAND 1010 367,200 1010 297,700 | | | | 367,200 297,700 | | | |
| | | 0 | No Sewer | 0 | Paved | 0 | Average | | | | | | | | | | | | |
| | | | | 0 | Heavy | | | | | | | | | | | | | | |
| SUPPLEMENTAL DATA | | | | | | | | | | | | Total | | 664,900 | 664,900 | | | | |
| Alt Prcl ID | | Scnd Home | | Cyclical Exemption | | 3 | | | | | | | | | | | | | |
| Tax Class T | | Tot Fin Area 1787 | | District | | Res Exem | | | | | | | | | | | | | |
| Total Acres 1.00 | | Chapter Lan | | Assoc Pid# | | | | | | | | | | | | | | | |
| GIS ID F_866295_2849430 | | | | | | | | | | | | | | | | | | | |
| RECORD OF OWNERSHIP | | | | BK-VOL/PAGE | | SALE DATE | | Q/U V/I | | SALE PRICE | | VC | | PREVIOUS ASSESSMENTS (HISTORY) | | | | | |
| LAFOREST ELIZABETH | | | | 57052 | 214 | 07-21-2022 | U | I | 1 | 1A | Year | Code | Assessed | Year | Code | Assessed | Year | Code | Assessed |
| LAFOREST WILLIAM | | | | 16407 | 0075 | 07-16-1998 | Q | I | 250,500 | 00 | 2023 | 1010 | 273,800 | 2022 | 1010 | 228,300 | 2021 | 1010 | 227,800 |
| PETTINELLI JASON M | | | | 14578 | 0176 | 08-12-1996 | Q | I | 230,000 | 00 | | 1010 | 309,500 | | | 255,100 | | | 212,600 |
| | | | | Total | | | | | | Total | | 583,300 | Total | | 483,400 | Total | | 440,400 | |
| EXEMPTIONS | | | | OTHER ASSESSMENTS | | | | This signature acknowledges a visit by a Data Collector or Assessor | | | | | | | | | | | |
| Year | Code | Description | | Amount | | Code | Description | Number | Amount | Comm Int | | | | | | | | | |
| | | | | Total | | 0.00 | | | | | | | | | | | | | |
| ASSESSING NEIGHBORHOOD | | | | | | | | | | | | APPRAISED VALUE SUMMARY | | | | | | | |
| Nbhd | | Nbhd Name | | B | | Tracing | | Batch | | Appraised Bldg. Value (Card) | | | | | | 367,200 | | | |
| 0050 | | | | | | | | | | Appraised Xf (B) Value (Bldg) | | | | | | 0 | | | |
| | | | | | | Appraised Ob (B) Value (Bldg) | | | | | | 0 | | | | | | | |
| | | | | | | Appraised Land Value (Bldg) | | | | | | 297,700 | | | | | | | |
| | | | | | | Special Land Value | | | | | | 0 | | | | | | | |
| | | | | | | Total Appraised Parcel Value | | | | | | 664,900 | | | | | | | |
| | | | | | | Valuation Method | | | | | | C | | | | | | | |
| | | | | | | Total Appraised Parcel Value | | | | | | 664,900 | | | | | | | |
| BUILDING PERMIT RECORD | | | | | | | | | | | | VISIT / CHANGE HISTORY | | | | | | | |
| Permit Id | Issue Date | Type | Description | Amount | Insp Date | % Comp | Date Comp | Comments | | | | Date | Id | Type | Is | Cd | Purpose/Result | | |
| 2015-153 | 07-16-2015 | MN | Maintenance | 15,000 | | 100 | | STRIP & REROOF 30 SQUARE | | | | 04-12-2013 | VGS | | | 20 | Field Review | | |
| | | | | | | | | | | | 03-31-2006 | KP | | 1 | 00 | Measure & Listed | | | |
| LAND LINE VALUATION SECTION | | | | | | | | | | | | | | | | | | | |
| B | Use Code | Description | Zone | Land Type | Land Units | Unit Price | Size Adj | Site Index | Cond. | Nbhd. | Nbhd. Adj | Notes | | Location Adjustment | | Adj Unit P | Land Value | | |
| 1 | 1010 | Single Family | RC | Primary | 40,000 | SF 8.75 | 1.00000 | 5 | 1.00 | 0050 | 1.000 | SLIGHT EASEMENT AND RT 3 | | TN85 | 0.8500 | 8.75 | 297,500 | | |
| 1 | 1010 | Single Family | RC | Undevelop | 0.086 | AC 2,000.00 | 1.00000 | 0 | 1.00 | 0050 | 1.000 | ESMNT AREA | | | 1.0000 | 0.05 | 200 | | |
| Total Card Land Units | | | | | 1.00 | AC | Parcel Total Land Area | | | 1.00 | | | | | Total Land Value | | 297,700 | | |

| CONSTRUCTION DETAIL | | | CONSTRUCTION DETAIL (CONTINUED) | | |
|---------------------|------|--------------|---------------------------------|------|-------------|
| Element | Cd | Description | Element | Cd | Description |
| Style | 04 | Cape Cod | Bsmt Area | 1004 | |
| Model | 01 | Residential | Bsmt Type | 04 | |
| Grade | 05 | Ave/Good | Unfin Area | 0.00 | Full |
| Stories | 1.75 | | | | |
| Occupancy | 1 | | CONDO DATA | | |
| Exterior Wall 1 | 14 | Wood Shingle | Parcel Id | | C |
| Exterior Wall 2 | | | | | B |
| Roof Structure | 03 | Gable | Adjust Type | Code | Description |
| Roof Cover | 03 | Asphalt | Condo Flr | | |
| Interior Wall 1 | 05 | Drywall | Condo Unit | | |
| Interior Wall 2 | | | COST / MARKET VALUATION | | |
| Interior Floor 1 | 12 | Hardwood | Net Other Adj | | 496,967 |
| Interior Floor 2 | | | Replace Cost | | 20,150 |
| Heat Fuel | 02 | Oil | Year Built | | 1971 |
| Heat Type | 05 | Hot Water | Effective Year Built | | 1992 |
| AC Type | 03 | Central | Depreciation Code | | A |
| Bedrooms | 3 | | Remodel Rating | | |
| Full Baths | 2 | | Year Remodeled | | |
| Half Baths | 1 | | Depreciation % | | 29 |
| Extra Fixtures | 0 | | Functional Obsol | | |
| Total Rooms | 6 | | External Obsol | | |
| Bath Style | 02 | Average | Trend Factor | | 1.000 |
| Kitchen Style | 02 | Average | Condition | | |
| Extra Kitchens | 0 | | Condition % | | |
| Fireplaces | 1 | | Percent Good | | 71 |
| Extra Openings | 0 | | Cns Sect Rcnld | | 367,200 |
| Gas Fireplaces | 0 | | Dep % Ovr | | |
| Sq Ft Fin Bsmt | 0 | | Dep Ovr Comment | | |
| FBM Quality | | | Misc Imp Ovr | | |
| Foundation | 06 | Poured Conc | Misc Imp Ovr Comment | | |
| Bsmt Garage | 0 | | Cost to Cure Ovr | | |
| Bsmt Area | 1004 | | Cost to Cure Ovr Comment | | |

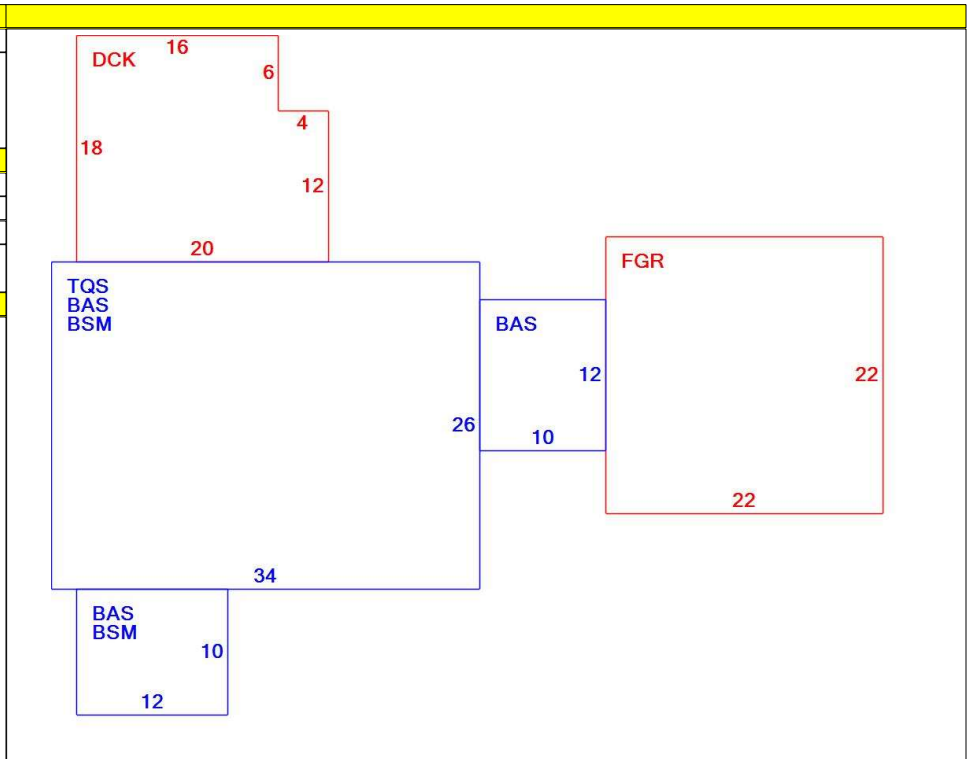

| OB - OUTBUILDING & YARD ITEMS(L) / XF - BUILDING EXTRA FEATURES(B) | | | | | | | | | | |
|--|-------------|-----|-------|------------|--------|----------|------|-------|------------|-------------|
| Code | Description | L/B | Units | Unit Price | Yr Blt | Cond. Cd | % Gd | Grade | Grade Adj. | Appr. Value |
| | | | | | | | | | | |

| BUILDING SUB-AREA SUMMARY SECTION | | | | | | |
|-----------------------------------|---------------------|-------------|------------|----------|-----------|----------------|
| Code | Description | Living Area | Floor Area | Eff Area | Unit Cost | Undeprec Value |
| BAS | First Floor | 1,124 | 1,124 | 1,124 | 224.26 | 252,072 |
| BSM | Basement | 0 | 1,004 | 201 | 44.90 | 45,077 |
| DCK | Deck | 0 | 336 | 34 | 22.69 | 7,625 |
| FGR | Garage | 0 | 484 | 194 | 89.89 | 43,507 |
| TQS | Three Quarter Story | 663 | 884 | 663 | 168.20 | 148,686 |
| Ttl Gross Liv / Lease Area | | 1,787 | 3,832 | 2,216 | | 496,967 |

