

| CURRENT OWNER | | TOPO | UTILITIES | STRT / ROAD | LOCATION | CURRENT ASSESSMENT | | | | 905 DUXBURY, MA | | | | | | |
|---|------------|---------------|-------------------|---|-------------|---|------------------------|--------------------|--------------------------------|--------------------|-----------|-----------|---------------------|--------------------|------------|---------|
| HOFFEND EMILY C GUNDERSON MICHAEL 505 FRANKLIN ST DUXBURY MA 02332 | | 0 | Water | 0 | Feeder | 0 | Average | Description | Code | | | Appraised | Assessed | | | |
| | | 0 | No Sewer | 0 | Paved | 0 | Average | RESIDENTL | 1010 | 529,200 | 529,200 | | | | | |
| | | | | 0 | Medium | | | RES LAND | 1010 | 395,400 | 395,400 | | | | | |
| SUPPLEMENTAL DATA | | | | | | | | | | | | | | | | |
| Alt Prcl ID Scnd Home Tax Class T Tot Fin Area 2291 Total Acres 3.921 Chapter Lan GIS ID F_864328_2849746 | | | | Cyclical 3 Exemption W District Res Exem Assoc Pid# | | | | Total | | 924,600 | 924,600 | | | | | |
| RECORD OF OWNERSHIP | | | BK-VOL/PAGE | SALE DATE | Q/U | V/I | SALE PRICE | VC | PREVIOUS ASSESSMENTS (HISTORY) | | | | | | | |
| HOFFEND EMILY C | | | 54960 48 | 05-12-2021 | U | I | 650,000 | 1A | Year | Code | Assessed | Year | Code | Assessed | | |
| GUNDERSON EILEEN M | | | 42546 0064 | 01-15-2013 | U | I | 1 | 1 | 2023 | 1010 | 392,400 | 2022 | 1010 | 342,000 | | |
| GUNDERSON EILEEN M | | | 34100 0326 | 02-12-2007 | U | I | 1 | 1A | | 1010 | 430,100 | | 1010 | 357,900 | | |
| GUNDERSON EILEEN | | | 21219 0262 | 12-26-2001 | U | I | 1 | 1F | | | | | | | | |
| GUNDERSON EDWARD | | | 18702 0332 | 07-17-2000 | U | I | 1 | 1F | | | | | | | | |
| | | Total | | | | | | | | 822,500 | Total | | 699,900 | Total | | 633,300 |
| EXEMPTIONS | | | OTHER ASSESSMENTS | | | This signature acknowledges a visit by a Data Collector or Assessor | | | | | | | | | | |
| Year | Code | Description | Amount | Code | Description | Number | Amount | Comm Int | | | | | | | | |
| Total | | | 0.00 | | | | | | | | | | | | | |
| ASSESSING NEIGHBORHOOD | | | | | | | | | | | | | | | | |
| Nbhd | | Nbhd Name | | B | | Tracing | | Batch | | | | | | | | |
| 0050 | | | | | | | | | | | | | | | | |
| NOTES | | | | | | | | | | | | | | | | |
| | | | | | | | | | | | | | | | | |
| BUILDING PERMIT RECORD | | | | | | | | | | | | | | | | |
| Permit Id | Issue Date | Type | Description | Amount | Insp Date | % Comp | Date Comp | Comments | Date | Id | Type | Is | Cd | Purpose/Result | | |
| 12616 | 11-23-1992 | NC | New Construct | 120,000 | 05-24-1996 | 100 | | 2 STY HSE W/GARAGE | 08-13-2014 | JLF | 10 | | 01 | Measure - No Entry | | |
| | | | | | | | | | 04-12-2013 | VGS | | | 20 | Field Review | | |
| | | | | | | | | | 10-16-2007 | BSB | | | 01 | Measure - No Entry | | |
| LAND LINE VALUATION SECTION | | | | | | | | | | | | | | | | |
| B | Use Code | Description | Zone | Land Type | Land Units | Unit Price | Size Adj | Site Index | Cond. | Nbhd. | Nbhd. Adj | Notes | Location Adjustment | Adj Unit P | Land Value | |
| 1 | 1010 | Single Family | RC | Primary | 40,000 SF | 8.75 | 1.00000 | 5 | 1.00 | 0050 | 1.000 | | 1.0000 | 8.75 | 350,000 | |
| 1 | 1010 | Single Family | RC | Residual | 2.215 AC | 35,000.00 | 0.56511 | 5 | 1.00 | 0050 | 1.000 | | 1.0000 | 0.45 | 43,800 | |
| 1 | 1010 | Single Family | RC | Undevelop | 0.789 AC | 2,000.00 | 1.00000 | 0 | 1.00 | 0050 | 1.000 | | 1.0000 | 0.05 | 1,600 | |
| Total Card Land Units | | | | | 3.92 | AC | Parcel Total Land Area | | | | | 3.92 | Total Land Value | | | 395,400 |

VISION

| CONSTRUCTION DETAIL | | | CONSTRUCTION DETAIL (CONTINUED) | | |
|---------------------|------|--------------|---------------------------------|--------|-------------|
| Element | Cd | Description | Element | Cd | Description |
| Style | 04 | Cape Cod | Bsmt Area | 1244 | |
| Model | 01 | Residential | Bsmt Type | 00 | |
| Grade | 06 | Good | Unfin Area | 432.00 | N/A |
| Stories | 1.75 | | | | |
| Occupancy | 1 | | | | |
| Exterior Wall 1 | 14 | Wood Shingle | | | |
| Exterior Wall 2 | | | | | |
| Roof Structure | 03 | Gable | | | |
| Roof Cover | 03 | Asphalt | | | |
| Interior Wall 1 | 05 | Drywall | | | |
| Interior Wall 2 | | | | | |
| Interior Floor 1 | 12 | Hardwood | | | |
| Interior Floor 2 | | | | | |
| Heat Fuel | 02 | Oil | | | |
| Heat Type | 05 | Hot Water | | | |
| AC Type | 01 | None | | | |
| Bedrooms | 3 | | | | |
| Full Baths | 1 | | | | |
| Half Baths | 1 | | | | |
| Extra Fixtures | 0 | | | | |
| Total Rooms | 8 | | | | |
| Bath Style | 02 | Average | | | |
| Kitchen Style | 02 | Average | | | |
| Extra Kitchens | 0 | | | | |
| Fireplaces | 1 | | | | |
| Extra Openings | 0 | | | | |
| Gas Fireplaces | 0 | | | | |
| Sq Ft Fin Bsmt | 0 | | | | |
| FBM Quality | | | | | |
| Foundation | 06 | Poured Conc | | | |
| Bsmt Garage | 0 | | | | |
| Bsmt Area | 1244 | | | | |

| CONDO DATA | | | |
|-------------|------|-------------|---------|
| Parcel Id | | C | Owne |
| | | | |
| | | B | S |
| Adjust Type | Code | Description | Factor% |
| Condo Flr | | | |
| Condo Unit | | | |

| COST / MARKET VALUATION | | |
|--------------------------|--|---------|
| Net Other Adj | | 646,254 |
| Replace Cost | | 15,225 |
| Year Built | | 661,478 |
| Effective Year Built | | 1993 |
| Depreciation Code | | 2001 |
| Remodel Rating | | A |
| Year Remodeled | | |
| Depreciation % | | 20 |
| Functional Obsol | | |
| External Obsol | | |
| Trend Factor | | 1.000 |
| Condition | | |
| Condition % | | |
| Percent Good | | 80 |
| Cns Sect Rcnd | | 529,200 |
| Dep % Ovr | | |
| Dep Ovr Comment | | |
| Misc Imp Ovr | | |
| Misc Imp Ovr Comment | | |
| Cost to Cure Ovr | | |
| Cost to Cure Ovr Comment | | |

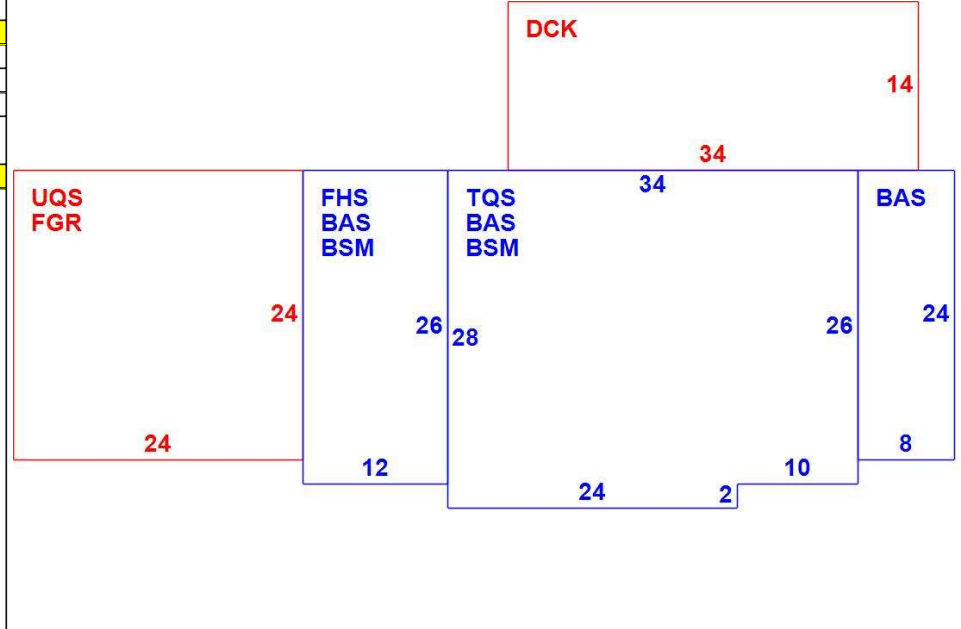

| OB - OUTBUILDING & YARD ITEMS(L) / XF - BUILDING EXTRA FEATURES(B) | | | | | | | | | | |
|--|-------------|-----|-------|------------|--------|----------|------|-------|------------|-------------|
| Code | Description | L/B | Units | Unit Price | Yr Blt | Cond. Cd | % Gd | Grade | Grade Adj. | Appr. Value |
| | | | | | | | | | | |

| BUILDING SUB-AREA SUMMARY SECTION | | | | | | |
|-----------------------------------|---------------------|-------------|------------|----------|-----------|----------------|
| Code | Description | Living Area | Floor Area | Eff Area | Unit Cost | Undeprec Value |
| BAS | First Floor | 1,436 | 1,436 | 1,436 | 213.99 | 307,291 |
| BSM | Basement | 0 | 1,244 | 249 | 42.83 | 53,284 |
| DCK | Deck | 0 | 476 | 48 | 21.58 | 10,272 |
| FGR | Garage | 0 | 576 | 230 | 85.45 | 49,218 |
| FHS | Finished Half Story | 156 | 312 | 156 | 107.00 | 33,383 |
| TQS | Three Quarter Story | 699 | 932 | 699 | 160.49 | 149,580 |
| UQS | Unfin 3/4 Story | 0 | 576 | 202 | 75.05 | 43,226 |
| Ttl Gross Liv / Lease Area | | 2,291 | 5,552 | 3,020 | | 646,254 |

