

CONSTRUCTION DETAIL			CONSTRUCTION DETAIL (CONTINUED)		
Element	Cd	Description	Element	Cd	Description
Style	06	Conventional	Bsmt Area	1020	
Model	01	Residential	Bsmt Type	04	
Grade	05	Ave/Good	Unfin Area	0.00	Full
Stories	1.65		CONDO DATA		
Occupancy	1		Parcel Id		C
Exterior Wall 1	11	Clapboard			B
Exterior Wall 2					S
Roof Structure	03	Gable	Adjust Type	Code	Description
Roof Cover	03	Asphalt	Condo Flr		Factor%
Interior Wall 1	05	Drywall	Condo Unit		
Interior Wall 2			COST / MARKET VALUATION		
Interior Floor 1	12	Hardwood	Net Other Adj		525,611
Interior Floor 2			Replace Cost		20,800
Heat Fuel	02	Oil	Year Built		546,410
Heat Type	05	Hot Water	Effective Year Built		1960
AC Type	01	None	Depreciation Code		1991
Bedrooms	4		Remodel Rating		A
Full Baths	2		Year Remodeled		
Half Baths	0		Depreciation %		30
Extra Fixtures	0		Functional Obsol		
Total Rooms	9		External Obsol		
Bath Style	02	Average	Trend Factor		1,000
Kitchen Style	02	Average	Condition		
Extra Kitchens	0		Condition %		
Fireplaces	2		Percent Good		70
Extra Openings	0		Cns Sect Rcnld		382,500
Gas Fireplaces	0		Dep % Ovr		
Sq Ft Fin Bsmt	0		Dep Ovr Comment		
FBM Quality			Misc Imp Ovr		
Foundation	06	Poured Conc	Misc Imp Ovr Comment		
Bsmt Garage	0		Cost to Cure Ovr		
Bsmt Area	1020		Cost to Cure Ovr Comment		

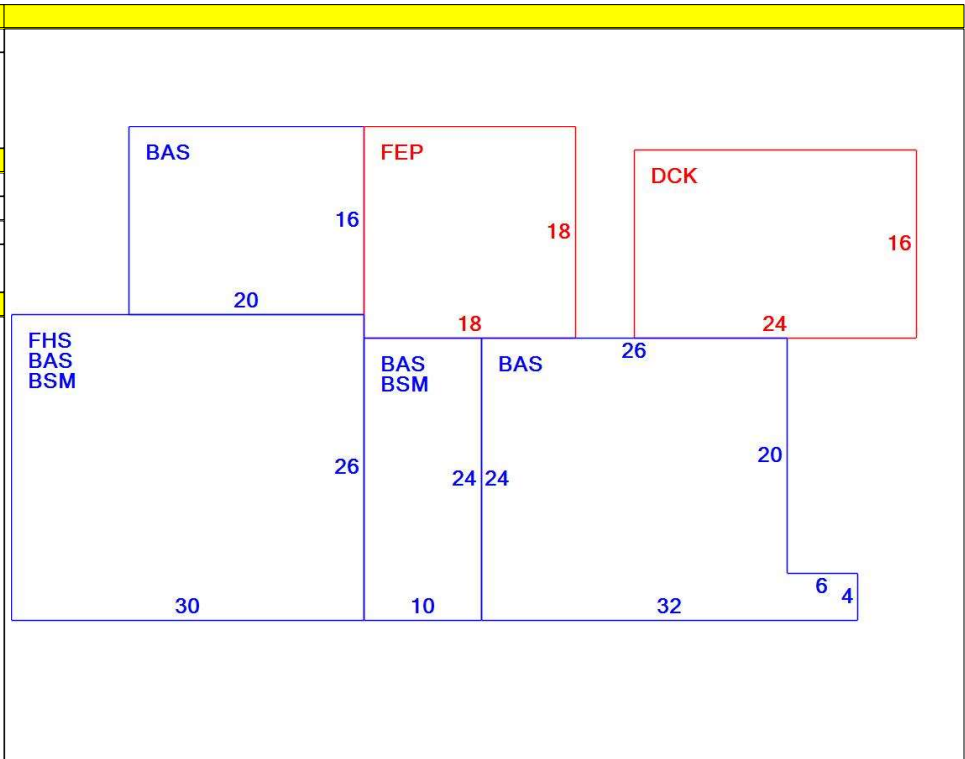

OB - OUTBUILDING & YARD ITEMS(L) / XF - BUILDING EXTRA FEATURES(B)

Code	Description	L/B	Units	Unit Price	Yr Blt	Cond. Cd	% Gd	Grade	Grade Adj.	Appr. Value
FGR1	Garage - 1 Sto	L	594	52.00	1980	A	70	C	1.00	21,600

BUILDING SUB-AREA SUMMARY SECTION

Code	Description	Living Area	Floor Area	Eff Area	Unit Cost	Undeprec Value
BAS	First Floor	1,988	1,988	1,988	186.78	371,327
BSM	Basement	0	1,020	204	37.36	38,104
DCK	Deck	0	384	38	18.48	7,098
FEP	Finished Enclosed Porch	0	324	194	111.84	36,236
FHS	Finished Half Story	390	780	390	93.39	72,846
Ttl Gross Liv / Lease Area		2,378	4,496	2,814		525,611



50 CARR RD

