

| CURRENT OWNER | | TOPO | | UTILITIES | | STRT / ROAD | | LOCATION | | CURRENT ASSESSMENT | | | | 905 DUXBURY, MA VISION | | | | | | |
|---|------------|-------------------------|-------------|-------------------|-------------|-------------|------------------------|---|----------|-------------------------------|-----------|-------------------------|------------------|---|---------|------------|------------------|---------|------|----------|
| HERNDON CALISTA M PO BOX 1219 BASALT CO 81621 | | 0 | Water | 0 | Subdivision | 0 | Average | Description | Code | Appraised | Assessed | | | | | | | | | |
| | | 0 | No Sewer | 0 | Paved | 0 | Average | RESIDNTL | 1010 | 90,200 | 90,200 | | | | | | | | | |
| | | | | 0 | Medium | | | RES LAND | 1010 | 490,000 | 490,000 | | | | | | | | | |
| SUPPLEMENTAL DATA | | | | | | | | | | RESIDNTL | 1010 | 6,300 | 6,300 | | | | | | | |
| Alt Prcl ID | | Scnd Home LEASED | | | Cyclical 5 | | | | | | | Total | | 586,500 | 586,500 | | | | | |
| Tax Class T | | Total Acres .998 | | | District W | | | | | | | | | | | | | | | |
| Chapter Lan | | GIS ID F_874106_2844628 | | | Res Exem | | | | | | | | | | | | | | | |
| Assoc Pid# | | | | | | | | | | | | | | | | | | | | |
| RECORD OF OWNERSHIP | | BK-VOL/PAGE | | SALE DATE | | Q/U | | VI | | SALE PRICE | | VC | | PREVIOUS ASSESSMENTS (HISTORY) | | | | | | |
| HERNDON CALISTA M | | 13347 | 0264 | 12-30-1994 | | U | I | | | 100 | 1F | Year | Code | Assessed | Year | Code | Assessed | Year | Code | Assessed |
| HERNDON NOAH T | | 0000 | 0000 | 09-06-1990 | | Q | I | | | 130,000 | 00 | 2023 | 1010 | 97,700 | 2022 | 1010 | 86,600 | 2021 | 1010 | 85,800 |
| | | | | | | | | | | | | | 1010 | 478,700 | | 1010 | 404,000 | | 1010 | 365,400 |
| | | | | | | | | | | | | | 1010 | 3,000 | | 1010 | 3,000 | | 1010 | 3,000 |
| | | Total | | | | | | | | | | Total | | 579,400 | Total | | 493,600 | Total | | 454,200 |
| EXEMPTIONS | | | | OTHER ASSESSMENTS | | | | This signature acknowledges a visit by a Data Collector or Assessor | | | | | | | | | | | | |
| Year | Code | Description | | Amount | Code | Description | Number | Amount | Comm Int | | | | | | | | | | | |
| | | | | Total | 0.00 | | | | | | | | | | | | | | | |
| ASSESSING NEIGHBORHOOD | | | | | | | | | | | | APPRAISED VALUE SUMMARY | | | | | | | | |
| Nbhd | | Nbhd Name | | B | | Tracing | | Batch | | Appraised Bldg. Value (Card) | | | | 90,200 | | | | | | |
| 0070 | | | | | | | | | | Appraised Xf (B) Value (Bldg) | | | | 0 | | | | | | |
| | | | | | | | | | | Appraised Ob (B) Value (Bldg) | | | | 6,300 | | | | | | |
| | | | | | | | | | | Appraised Land Value (Bldg) | | | | 490,000 | | | | | | |
| | | | | | | | | | | Special Land Value | | | | 0 | | | | | | |
| | | | | | | | | | | Total Appraised Parcel Value | | | | 586,500 | | | | | | |
| | | | | | | | | | | Valuation Method | | | | C | | | | | | |
| | | | | | | | | | | Total Appraised Parcel Value | | | | 586,500 | | | | | | |
| BUILDING PERMIT RECORD | | | | | | | | | | | | VISIT / CHANGE HISTORY | | | | | | | | |
| Permit Id | Issue Date | Type | Description | Amount | Insp Date | % Comp | Date Comp | Comments | | | | Date | Id | Type | Is | Cd | Purpose/Result | | | |
| | | | | | | | | | | | | 09-04-2019 | SJT | 10 | | 00 | Measure & Listed | | | |
| | | | | | | | | | | | | 10-30-2014 | JLF | 10 | 1 | 00 | Measure & Listed | | | |
| | | | | | | | | | | | | 04-12-2013 | VGS | | | 20 | Field Review | | | |
| | | | | | | | | | | | | 02-14-2008 | BSB | | 1 | 00 | Measure & Listed | | | |
| LAND LINE VALUATION SECTION | | | | | | | | | | | | | | | | | | | | |
| B | Use Code | Description | Zone | Land Type | Land Units | Unit Price | Size Adj | Site Index | Cond. | Nbhd. | Nbhd. Adj | Notes | | Location Adjustment | | Adj Unit P | Land Value | | | |
| 1 | 1010 | Single Family | RC | Primary | 40,000 SF | 8.75 | 1.00000 | 5 | 1.00 | 0070 | 1.389 | LACKS FRONTAGE ON ACCE | | | 1.0000 | 12.16 | 486,200 | | | |
| 1 | 1010 | Single Family | RC | Residual | 0.078 AC | 35,000.00 | 1.00000 | 5 | 1.00 | 0070 | 1.389 | | | | 1.0000 | 1.11 | 3,800 | | | |
| Total Card Land Units | | | | | 1.00 | AC | Parcel Total Land Area | | | | | 1.00 | Total Land Value | | | | | 490,000 | | |

| CONSTRUCTION DETAIL | | | CONSTRUCTION DETAIL (CONTINUED) | | |
|---------------------|-----|----------------|---------------------------------|------|-------------|
| Element | Cd | Description | Element | Cd | Description |
| Style | 01 | Ranch | Bsmt Area | 480 | |
| Model | 01 | Residential | Bsmt Type | 00 | |
| Grade | 04 | Above Ave | Unfin Area | 0.00 | N/A |
| Stories | 1 | | CONDO DATA | | |
| Occupancy | 1 | | Parcel Id | | C |
| Exterior Wall 1 | 17 | Stucco | | | B |
| Exterior Wall 2 | | | | | S |
| Roof Structure | 03 | Gable | Adjust Type | Code | Description |
| Roof Cover | 03 | Asphalt | Condo Flr | | Factor% |
| Interior Wall 1 | 03 | Plaster | Condo Unit | | |
| Interior Wall 2 | | | COST / MARKET VALUATION | | |
| Interior Floor 1 | 09 | Pine/Soft Wood | | | 112,502 |
| Interior Floor 2 | | | Net Other Adj | | 22,138 |
| Heat Fuel | 03 | Gas | Replace Cost | | 134,640 |
| Heat Type | 04 | Forced Air-Duc | Year Built | | 1934 |
| AC Type | 01 | None | Effective Year Built | | 1988 |
| Bedrooms | 1 | | Depreciation Code | | A |
| Full Baths | 1 | | Remodel Rating | | |
| Half Baths | 0 | | Year Remodeled | | |
| Extra Fixtures | 0 | | Depreciation % | | 33 |
| Total Rooms | 3 | | Functional Obsol | | |
| Bath Style | 02 | Average | External Obsol | | |
| Kitchen Style | 02 | Average | Trend Factor | | 1.000 |
| Extra Kitchens | 0 | | Condition | | |
| Fireplaces | 1 | | Condition % | | |
| Extra Openings | 0 | | Percent Good | | 67 |
| Gas Fireplaces | 0 | | Cns Sect Rcnld | | 90,200 |
| Sq Ft Fin Bsmt | 450 | | Dep % Ovr | | |
| FBM Quality | 03 | Average | Dep Ovr Comment | | |
| Foundation | 06 | Poured Conc | Misc Imp Ovr | | |
| Bsmt Garage | 0 | | Misc Imp Ovr Comment | | |
| Bsmt Area | 480 | | Cost to Cure Ovr | | |
| | | | Cost to Cure Ovr Comment | | |

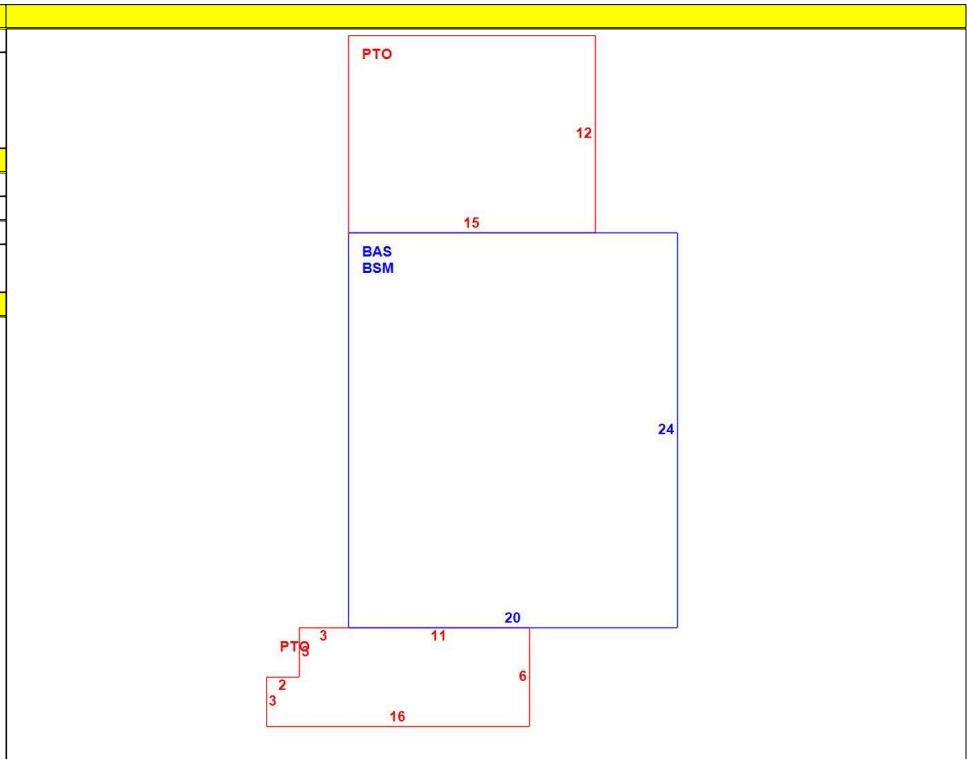

| OB - OUTBUILDING & YARD ITEMS(L) / XF - BUILDING EXTRA FEATURES(B) | | | | | | | | | | |
|--|-------------|-----|-------|------------|--------|----------|------|-------|------------|-------------|
| Code | Description | L/B | Units | Unit Price | Yr Blt | Cond. Cd | % Gd | Grade | Grade Adj. | Appr. Value |
| SHP | Work Shop | L | 420 | 54.00 | 1975 | F | 55 | D | 0.50 | 6,200 |
| SHD1 | Shed | L | 10 | 21.00 | 1980 | A | 70 | C | 1.00 | 100 |

| BUILDING SUB-AREA SUMMARY SECTION | | | | | | |
|-----------------------------------|-------------|-------------|------------|----------|-----------|----------------|
| Code | Description | Living Area | Floor Area | Eff Area | Unit Cost | Undeprec Value |
| BAS | First Floor | 480 | 480 | 480 | 190.68 | 91,527 |
| BSM | Basement | 0 | 480 | 96 | 38.14 | 18,305 |
| PTO | Patio | 0 | 270 | 14 | 9.89 | 2,670 |
| Ttl Gross Liv / Lease Area | | 480 | 1,230 | 590 | | 112,502 |

