

| CURRENT OWNER  |            | TOPO              |               | UTILITIES         |            | STRT / ROAD  |                        | LOCATION  |        | CURRENT ASSESSMENT |           |                               |                  | 905<br><br>DUXBURY, MA<br><br><b>VISION</b> |        |            |                    |       |      |           |
|--|------------|-------------------|---------------|-------------------|------------|--------------|------------------------|---|--------|--------------------|-----------|-------------------------------|------------------|---|--------|------------|--------------------|-------|------|-----------|
| HOLLYER LISA B TT<br>LISA B HOLLYER TRUST<br>42 ELM HILL LN<br><br>DUXBURY MA 02332<br><br>Alt Prcl ID<br>Scnd Home<br>Tax Class T<br>Tot Fin Area 4398<br>Total Acres 7.248<br>Chapter Lan<br><br>GIS ID F_869402_2829945 |            | 0                 | Water         | 0                 | Two-Way    | 0            | Average                | Description   |        | Code               | Appraised | Assessed                      |                  |   |        |            |                    |       |      |           |
|  |            | 0                 | No Sewer      | 0                 | Paved      | 0            | Average                | RESIDNTL  |        | 1010               | 1,100,000 | 1,100,000                     |                  |   |        |            |                    |       |      |           |
|  |            | SUPPLEMENTAL DATA |               | 0                 |            | Medium       |                        | RES LAND  |        | 1010               | 694,400   | 694,400                       |                  |   |        |            |                    |       |      |           |
|  |            |                   |               |                   |            |              |                        | RESIDNTL  |        | 1010               | 123,400   | 89,800                        |                  |   |        |            |                    |       |      |           |
|  |            |                   |               |                   |            |              |                        |   |        | Total              |           | 1,917,800                     | 1,884,200        |   |        |            |                    |       |      |           |
| RECORD OF OWNERSHIP  |            | BK-VOL/PAGE       |               | SALE DATE         |            | Q/U          |                        | V/I   |        | SALE PRICE         |           | VC                            |                  | PREVIOUS ASSESSMENTS (HISTORY)              |        |            |                    |       |      |           |
| HOLLYER LISA B TT  |            | 49771             | 0092          | 05-07-2018        |            | Q            | I                      |   |        | 1,812,500          | 00        | Year                          | Code             | Assessed                                    | Year   | Code       | Assessed           | Year  | Code | Assessed  |
| BOYD WILLIAM T JR TT   |            | 43618             | 0265          | 09-18-2013        |            | U            | I                      |   |        | 10                 | 1A        | 2023                          | 1010             | 1,092,300                                   | 2022   | 1010       | 984,900            | 2021  | 1010 | 898,100   |
| BOYD CHERILYN  |            | 43618             | 0261          | 09-18-2013        |            | U            | I                      |   |        | 10                 | 1A        |                               | 1010             | 694,400                                     |        | 1010       | 588,400            |       | 1010 | 551,900   |
| BOYD WILLIAM T JR  |            | 4353              | 0387          | 10-28-1977        |            | Q            | I                      |   |        | 130,000            | 00        |                               | 1010             | 65,300                                      |        | 1010       | 65,300             |       | 1010 | 63,200    |
|  |            | Total             |               |                   |            |              |                        |   |        |                    |           | Total                         |                  | 1,852,000                                   | Total  |            | 1,638,600          | Total |      | 1,513,200 |
| EXEMPTIONS   |            |                   |               | OTHER ASSESSMENTS |            |              |                        | This signature acknowledges a visit by a Data Collector or Assessor |        |                    |           |                               |                  |   |        |            |                    |       |      |           |
| Year   | Code       | Description       |               | Amount            |            | Code         | Description            | Number  | Amount | Comm Int           |           |                               |                  |   |        |            |                    |       |      |           |
| Total  |            |                   |               | 0.00              |            |              |                        |   |        |                    |           |                               |                  |   |        |            |                    |       |      |           |
| ASSESSING NEIGHBORHOOD   |            |                   |               |                   |            |              |                        |   |        |                    |           | APPRAISED VALUE SUMMARY       |                  |   |        |            |                    |       |      |           |
| Nbhd   |            | Nbhd Name         |               | B                 |            | Tracing      |                        | Batch   |        |                    |           |                               |                  |   |        |            |                    |       |      |           |
| 0070   |            |                   |               |                   |            |              |                        |   |        |                    |           |                               |                  |   |        |            |                    |       |      |           |
| NOTES  |            |                   |               |                   |            |              |                        |   |        |                    |           | Appraised Bldg. Value (Card)  |                  |   |        | 1,100,000  |                    |       |      |           |
|  |            |                   |               |                   |            |              |                        |   |        |                    |           | Appraised Xf (B) Value (Bldg) |                  |   |        | 0          |                    |       |      |           |
|  |            |                   |               |                   |            |              |                        |   |        |                    |           | Appraised Ob (B) Value (Bldg) |                  |   |        | 123,400    |                    |       |      |           |
|  |            |                   |               |                   |            |              |                        |   |        |                    |           | Appraised Land Value (Bldg)   |                  |   |        | 694,400    |                    |       |      |           |
|  |            |                   |               |                   |            |              |                        |   |        |                    |           | Special Land Value            |                  |   |        | 0          |                    |       |      |           |
|  |            |                   |               |                   |            |              |                        |   |        |                    |           | Total Appraised Parcel Value  |                  |   |        | 1,917,800  |                    |       |      |           |
|  |            |                   |               |                   |            |              |                        |   |        |                    |           | Valuation Method              |                  |   |        | C          |                    |       |      |           |
|  |            |                   |               |                   |            |              |                        |   |        |                    |           | Total Appraised Parcel Value  |                  |   |        | 1,917,800  |                    |       |      |           |
| BUILDING PERMIT RECORD   |            |                   |               |                   |            |              |                        |   |        |                    |           | VISIT / CHANGE HISTORY        |                  |   |        |            |                    |       |      |           |
| Permit Id  | Issue Date | Type              | Description   | Amount            | Insp Date  | % Comp       | Date Comp              | Comments  |        |                    |           | Date                          | Id               | Type  | Is     | Cd         | Purpose/Result     |       |      |           |
| 2018-135   | 07-10-2018 | MN                | Maintenance   | 21,170            |            | 100          |                        | STRIP & REROOF  |        |                    |           | 12-10-2019                    | SJT              | 10  |        | 01         | Measure - No Entry |       |      |           |
| 267  | 12-14-2010 | MS                | Miscellaneous | 46,259            |            | 100          |                        | SOLAR ELEC MODULES  |        |                    |           | 04-12-2013                    | VGS              |   |        | 20         | Field Review       |       |      |           |
| 448  | 08-26-2003 | AD                | Addition      | 62,000            | 07-29-2005 | 100          |                        | ONE STORY ADDITION  |        |                    |           | 10-01-2012                    | KP               | 6   |        | 30         | Quality Control    |       |      |           |
|  |            |                   |               |                   |            |              |                        |   |        |                    |           | 07-29-2005                    | KP               |   | 6      | 00         | Measure & Listed   |       |      |           |
| LAND LINE VALUATION SECTION  |            |                   |               |                   |            |              |                        |   |        |                    |           |                               |                  |   |        |            |                    |       |      |           |
| B  | Use Code   | Description       | Zone          | Land Type         | Land Units | Unit Price   | Size Adj               | Site Index  | Cond.  | Nbhd.              | Nbhd. Adj | Notes                         |                  | Location Adjustment                         |        | Adj Unit P | Land Value         |       |      |           |
| 1  | 1010       | Single Family     | RC            | Primary           | 40,000     | SF 8.75      | 1.00000                | 5   | 1.00   | 0070               | 1.389     |                               |                  | V125  | 1.2500 | 15.20      | 607,800            |       |      |           |
| 1  | 1010       | Single Family     | RC            | Residual          | 6.330      | AC 35,000.00 | 0.28138                | 5   | 1.00   | 0070               | 1.389     |                               |                  |   | 1.0000 | 0.31       | 86,600             |       |      |           |
| Total Card Land Units  |            |                   |               |                   | 7.25       | AC           | Parcel Total Land Area |   |        |                    |           | 7.25                          | Total Land Value |   |        | 694,400    |                    |       |      |           |

| CONSTRUCTION DETAIL |      |                | CONSTRUCTION DETAIL (CONTINUED) |      |             |
|---------------------|------|----------------|---------------------------------|------|-------------|
| Element             | Cd   | Description    | Element                         | Cd   | Description |
| Style               | 11   | Antique        | Bsmt Area                       | 2852 |             |
| Model               | 01   | Residential    | Bsmt Type                       | 04   |             |
| Grade               | 10   | Custom +       | Unfin Area                      | 0.00 | Full        |
| Stories             | 2    |                |                                 |      |             |
| Occupancy           | 1    |                |                                 |      |             |
| Exterior Wall 1     | 11   | Clapboard      |                                 |      |             |
| Exterior Wall 2     |      |                |                                 |      |             |
| Roof Structure      | 04   | Hip            |                                 |      |             |
| Roof Cover          | 03   | Asphalt        |                                 |      |             |
| Interior Wall 1     | 05   | Drywall        |                                 |      |             |
| Interior Wall 2     |      |                |                                 |      |             |
| Interior Floor 1    | 12   | Hardwood       |                                 |      |             |
| Interior Floor 2    | 09   | Pine/Soft Wood |                                 |      |             |
| Heat Fuel           | 03   | Gas            |                                 |      |             |
| Heat Type           | 05   | Hot Water      |                                 |      |             |
| AC Type             | 03   | Central        |                                 |      |             |
| Bedrooms            | 4    |                |                                 |      |             |
| Full Baths          | 4    |                |                                 |      |             |
| Half Baths          | 1    |                |                                 |      |             |
| Extra Fixtures      | 2    |                |                                 |      |             |
| Total Rooms         | 12   |                |                                 |      |             |
| Bath Style          | 03   | Modern         |                                 |      |             |
| Kitchen Style       | 03   | Modern         |                                 |      |             |
| Extra Kitchens      | 0    |                |                                 |      |             |
| Fireplaces          | 2    |                |                                 |      |             |
| Extra Openings      | 0    |                |                                 |      |             |
| Gas Fireplaces      | 0    |                |                                 |      |             |
| Sq Ft Fin Bsmt      | 400  |                |                                 |      |             |
| FBM Quality         | 03   | Average        |                                 |      |             |
| Foundation          | 03   | Stone          |                                 |      |             |
| Bsmt Garage         | 0    |                |                                 |      |             |
| Bsmt Area           | 2852 |                |                                 |      |             |

| CONDO DATA  |      |             |         |   |
|-------------|------|-------------|---------|---|
| Parcel Id   |      | C           | Owne    |   |
|             |      |             | B       | S |
| Adjust Type | Code | Description | Factor% |   |
| Condo Flr   |      |             |         |   |
| Condo Unit  |      |             |         |   |

| COST / MARKET VALUATION  |  |  |  |           |
|--------------------------|--|--|--|-----------|
| Net Other Adj            |  |  |  | 1,190,323 |
| Replace Cost             |  |  |  | 74,005    |
| Year Built               |  |  |  | 1,264,327 |
| Effective Year Built     |  |  |  | 1790      |
| Depreciation Code        |  |  |  | 2008      |
| Remodel Rating           |  |  |  | R         |
| Year Remodeled           |  |  |  |           |
| Depreciation %           |  |  |  | 13        |
| Functional Obsol         |  |  |  |           |
| External Obsol           |  |  |  |           |
| Trend Factor             |  |  |  | 1.000     |
| Condition                |  |  |  |           |
| Condition %              |  |  |  |           |
| Percent Good             |  |  |  | 87        |
| Cns Sect Rcnd            |  |  |  | 1,100,000 |
| Dep % Ovr                |  |  |  |           |
| Dep Ovr Comment          |  |  |  |           |
| Misc Imp Ovr             |  |  |  |           |
| Misc Imp Ovr Comment     |  |  |  |           |
| Cost to Cure Ovr         |  |  |  |           |
| Cost to Cure Ovr Comment |  |  |  |           |

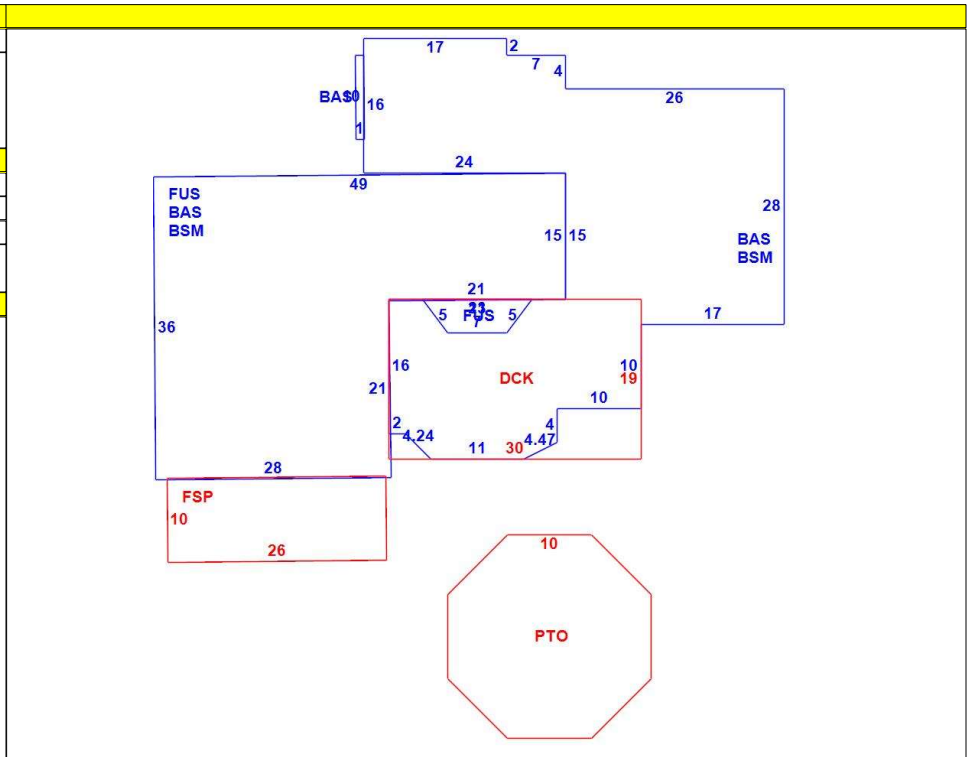

| OB - OUTBUILDING & YARD ITEMS(L) / XF - BUILDING EXTRA FEATURES(B) |                |     |       |            |        |          |      |       |            |             |
|--|----------------|-----|-------|------------|--------|----------|------|-------|------------|-------------|
| Code   | Description    | L/B | Units | Unit Price | Yr Blt | Cond. Cd | % Gd | Grade | Grade Adj. | Appr. Value |
| GRN1   | Greenhouse -   | L   | 273   | 52.00      | 1980   | A        | 70   | C     | 1.00       | 9,900       |
| BRN1   | Barn - 1 Story | L   | 1,505 | 39.00      | 1985   | A        | 70   | B     | 1.50       | 61,600      |
| SHD1   | Shed           | L   | 96    | 21.00      | 1980   | A        | 70   | C     | 1.00       | 1,400       |
| SLR  | Solar Panels   | L   | 32    | 1050.00    | 2019   | A        | 70   | C     | 1.00       | 33,600      |
| GNC  | GENERATOR      | L   | 1     | 24100.00   | 2018   | A        | 70   | C     | 1.00       | 16,900      |

| BUILDING SUB-AREA SUMMARY SECTION |                      |             |            |          |           |                |
|-----------------------------------|----------------------|-------------|------------|----------|-----------|----------------|
| Code                              | Description          | Living Area | Floor Area | Eff Area | Unit Cost | Undeprec Value |
| BAS                               | First Floor          | 2,898       | 2,898      | 2,898    | 239.50    | 694,075        |
| BSM                               | Basement             | 0           | 2,888      | 578      | 47.93     | 138,432        |
| DCK                               | Deck                 | 0           | 570        | 57       | 23.95     | 13,652         |
| FSP                               | Screened Porch       | 0           | 260        | 52       | 47.90     | 12,454         |
| FUS                               | Finished Upper Story | 1,361       | 1,361      | 1,361    | 239.50    | 325,962        |
| PTO                               | Patio                | 0           | 483        | 24       | 11.90     | 5,748          |
| Ttl Gross Liv / Lease Area        |                      | 4,259       | 8,460      | 4,970    |           | 1,190,323      |

