

| CURRENT OWNER | | TOPO | UTILITIES | STRT / ROAD | LOCATION | CURRENT ASSESSMENT | | | | 905 DUXBURY, MA VISION |
|---|--|--------------------------|------------------|-------------|-----------|--------------------|------|-----------|-----------|---|
| REED CYNTHIA TT CYNTHIA REED REVOCABLE TRS PO BOX 4547 NEW YORK NY 10163 | | 8 Sloping | 0 Water | 0 Two-Way | 0 Average | Description | Code | Appraised | Assessed | |
| | | | 0 No Sewer | 0 Paved | 0 Average | RESIDNTL | 1010 | 1,224,400 | 1,224,400 | |
| | | SUPPLEMENTAL DATA | | | | RES LAND | 1010 | 5,274,300 | 5,274,300 | |
| | | Alt Prcl ID | Scnd Home | Cyclical | 9 | RESIDNTL | 1010 | 20,500 | 20,500 | |
| | | Tax Class | T | Exemption | W | | | | | |
| | | Tot Fin Area | 3996 | District | Res Exem | | | | | |
| | | Total Acres | 3.018 | Assoc Pid# | | | | | | |
| | | Chapter Lan | | | | | | | | |
| | | GIS ID | F_880225_2828668 | | | | | | | |
| | | | | | | Total | | 6,519,200 | 6,519,200 | |

| RECORD OF OWNERSHIP | | BK-VOL/PAGE | SALE DATE | Q/U | V/I | SALE PRICE | VC | PREVIOUS ASSESSMENTS (HISTORY) | | | | | | | | |
|--|--|-------------|------------|-----|-----|------------|----|--------------------------------|--------|-----------|------|-----------|-----------|-------|--------|-----------|
| REED CYNTHIA TT DELPRETE DAVID M & JUNE E | | 41968 0167 | 09-19-2012 | U | I | 3,000,000 | 1 | Year | Code | Assessed | Year | Code | Assessed | Year | Code | Assessed |
| | | 8495 0120 | 06-03-1988 | U | I | 400,000 | 1 | 2023 | 1010 | 1,331,900 | 2022 | 1010 | 1,174,900 | 2021 | 1010 | 1,073,900 |
| | | | | | | | | | 1010 | 5,756,600 | | 1010 | 4,872,600 | | 1010 | 3,693,100 |
| | | | | | | | | 1010 | 15,300 | | 1010 | 15,300 | | 1010 | 12,800 | |
| | | | | | | Total | | 7,103,800 | | Total | | 6,062,800 | | Total | | 4,779,800 |

| EXEMPTIONS | | | | OTHER ASSESSMENTS | | | | APPRAISED VALUE SUMMARY | | | | |
|------------|------|-------------|--------|-------------------|-------------|--------|--------|---------------------------------|---|--|--|--|
| Year | Code | Description | Amount | Code | Description | Number | Amount | Comm Int | This signature acknowledges a visit by a Data Collector or Assessor | | | |
| | | | | | | | | | Appraised Bldg. Value (Card) 1,224,400 | | | |
| Total | | | 0.00 | | | | | Appraised Xf (B) Value (Bldg) 0 | | | | |

| ASSESSING NEIGHBORHOOD | | | |
|------------------------|-----------|---|---------|
| Nbhd | Nbhd Name | B | Tracing |
| 0090 | | | Batch |

| NOTES | | | | VISIT / CHANGE HISTORY | | | | | |
|--|--|--|--|------------------------------|-----|------|----|-----------|--------------------|
| OLD HOUSE DEMOLISHED 2013 NEW CONSTRUCTION 15% 8/1/13 | | | | Date | Id | Type | Is | Cd | Purpose/Result |
| | | | | 05-15-2014 | SJF | 5 | 6 | 00 | Measure & Listed |
| | | | | 08-01-2013 | GM | | | 01 | Measure - No Entry |
| | | | | 04-12-2013 | VGS | | | 20 | Field Review |
| | | | | 02-28-2007 | KPD | | 1 | 00 | Measure & Listed |
| | | | | Total Appraised Parcel Value | | | | 6,519,200 | |
| | | | | Valuation Method | | | | C | |
| | | | | Total Appraised Parcel Value | | | | 6,519,200 | |

| BUILDING PERMIT RECORD | | | | | | | | VISIT / CHANGE HISTORY | | | | | | | |
|------------------------|------------|------|---------------|-----------|------------|--------|-----------|---------------------------|------------|-----|------|----|----|--------------------|--|
| Permit Id | Issue Date | Type | Description | Amount | Insp Date | % Comp | Date Comp | Comments | Date | Id | Type | Is | Cd | Purpose/Result | |
| 2013-24 | 02-13-2013 | NC | New Construct | 1,000,000 | 08-01-2013 | 100 | | SINGLE FAM DWELLING 1ST F | 05-15-2014 | SJF | 5 | 6 | 00 | Measure & Listed | |
| 2013-11 | 01-14-2013 | DM | Demolish | 13,500 | | 100 | | DEMO EXISTING DWELLING | 08-01-2013 | GM | | | 01 | Measure - No Entry | |
| 148 | 05-02-2006 | MS | Miscellaneous | 30,356 | 02-28-2007 | 100 | | VINYL INGRD POOL | 04-12-2013 | VGS | | | 20 | Field Review | |
| 11825 | 03-04-1991 | DM | Demolish | 2,000 | | 100 | | 18X18GAR,10X8ELL | 02-28-2007 | KPD | | 1 | 00 | Measure & Listed | |
| 11730 | 10-16-1990 | NC | New Construct | | 01-01-1991 | 100 | | 2-STYW/EL & GAR&3 DK | | | | | | | |

| LAND LINE VALUATION SECTION | | | | | | | | | | | | | | | | |
|-----------------------------|----------|---------------|------|-----------|------------|--------------|------------------------|------------|-------|-------|-----------|-------|---------------------|------------|------------|-----------|
| B | Use Code | Description | Zone | Land Type | Land Units | Unit Price | Size Adj | Site Index | Cond. | Nbhd. | Nbhd. Adj | Notes | Location Adjustment | Adj Unit P | Land Value | |
| 1 | 1010 | Single Family | RC | Primary | 40,000 | SF 8.75 | 1.00000 | 5 | 1.00 | 0090 | 3.661 | | W 400 | 4.0000 | 128.14 | 5,125,600 |
| 1 | 1010 | Single Family | RC | Residual | 1.680 | AC 35,000.00 | 0.67619 | 5 | 1.00 | 0090 | 3.661 | | | 1.0000 | 1.99 | 145,600 |
| 1 | 1010 | Single Family | WP | Undevelop | 0.420 | AC 2,000.00 | 1.00000 | 0 | 1.00 | 0090 | 3.661 | | | 1.0000 | 0.17 | 3,100 |
| Total Card Land Units | | | | | 3.02 | AC | Parcel Total Land Area | | | | | 3.02 | Total Land Value | | | 5,274,300 |

| CONSTRUCTION DETAIL | | | CONSTRUCTION DETAIL (CONTINUED) | | |
|---------------------|------|----------------|---------------------------------|------|-------------|
| Element | Cd | Description | Element | Cd | Description |
| Style | 01 | Ranch | Bsmt Area | 3508 | |
| Model | 01 | Residential | Bsmt Type | 04 | |
| Grade | 11 | Prime | Unfin Area | 0.00 | Full |
| Stories | 1 | | | | |
| Occupancy | 1 | | | | |
| Exterior Wall 1 | 14 | Wood Shingle | | | |
| Exterior Wall 2 | | | | | |
| Roof Structure | 03 | Gable | | | |
| Roof Cover | 10 | Wood Shingle | | | |
| Interior Wall 1 | 03 | Plaster | | | |
| Interior Wall 2 | 06 | Cust Wd Panel | | | |
| Interior Floor 1 | 12 | Hardwood | | | |
| Interior Floor 2 | | | | | |
| Heat Fuel | 03 | Gas | | | |
| Heat Type | 04 | Forced Air-Duc | | | |
| AC Type | 03 | Central | | | |
| Bedrooms | 3 | | | | |
| Full Baths | 3 | | | | |
| Half Baths | 1 | | | | |
| Extra Fixtures | 6 | | | | |
| Total Rooms | 6 | | | | |
| Bath Style | 03 | Modern | | | |
| Kitchen Style | 03 | Modern | | | |
| Extra Kitchens | 0 | | | | |
| Fireplaces | 2 | | | | |
| Extra Openings | 0 | | | | |
| Gas Fireplaces | 0 | | | | |
| Sq Ft Fin Bsmt | 300 | | | | |
| FBM Quality | 05 | Living Area | | | |
| Foundation | 06 | Poured Conc | | | |
| Bsmt Garage | 0 | | | | |
| Bsmt Area | 3508 | | | | |

| CONDO DATA | | | | |
|-------------|------|-------------|---------|---|
| Parcel Id | | C | Owne | |
| | | | B | S |
| Adjust Type | Code | Description | Factor% | |
| Condo Flr | | | | |
| Condo Unit | | | | |

| COST / MARKET VALUATION | | | | |
|--------------------------|--|--|-------|-----------|
| Net Other Adj | | | | 1,254,822 |
| Replace Cost | | | | 76,050 |
| Year Built | | | | 2013 |
| Effective Year Built | | | | 2013 |
| Depreciation Code | | | | G |
| Remodel Rating | | | | |
| Year Remodeled | | | | |
| Depreciation % | | | 8 | |
| Functional Obsol | | | | |
| External Obsol | | | | |
| Trend Factor | | | 1.000 | |
| Condition | | | | |
| Condition % | | | | |
| Percent Good | | | 92 | |
| Cns Sect Rcnd | | | | 1,224,400 |
| Dep % Ovr | | | | |
| Dep Ovr Comment | | | | |
| Misc Imp Ovr | | | | |
| Misc Imp Ovr Comment | | | | |
| Cost to Cure Ovr | | | | |
| Cost to Cure Ovr Comment | | | | |

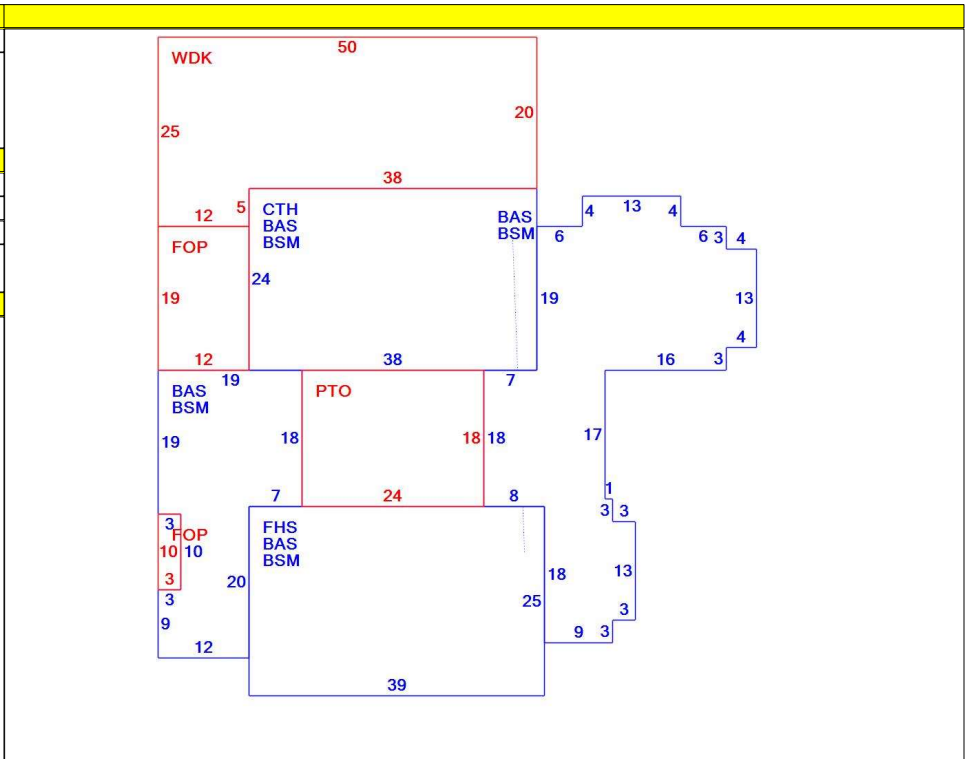

| OB - OUTBUILDING & YARD ITEMS(L) / XF - BUILDING EXTRA FEATURES(B) | | | | | | | | | | |
|--|-------------|-----|-------|------------|--------|----------|------|-------|------------|-------------|
| Code | Description | L/B | Units | Unit Price | Yr Blt | Cond. Cd | % Gd | Grade | Grade Adj. | Appr. Value |
| GNC | GENERATOR | L | 1 | 24100.00 | 2013 | G | 85 | C | 1.00 | 20,500 |

| BUILDING SUB-AREA SUMMARY SECTION | | | | | | |
|-----------------------------------|---------------------|-------------|------------|----------|-----------|----------------|
| Code | Description | Living Area | Floor Area | Eff Area | Unit Cost | Undeprec Value |
| BAS | First Floor | 3,508 | 3,508 | 3,508 | 253.19 | 888,199 |
| BSM | Basement | 0 | 3,508 | 702 | 50.67 | 177,741 |
| CTH | Cathedral Ceiling | 0 | 912 | 91 | 25.26 | 23,041 |
| FHS | Finished Half Story | 488 | 975 | 488 | 126.73 | 123,558 |
| FOP | Open Porch | 0 | 258 | 39 | 38.27 | 9,875 |
| PTO | Patio | 0 | 432 | 22 | 12.89 | 5,570 |
| WDK | Deck | 0 | 1,060 | 106 | 25.32 | 26,838 |
| Ttl Gross Liv / Lease Area | | 3,996 | 10,653 | 4,956 | | 1,254,822 |

