

Key: 2841

Town of E. BRIDGEWATER - Fiscal Year 2023

12/6/2022 6:38 pm SEQ #: 2.434

LEGAL

CURRENT OWNER				PARCEL ID				LOCATION				
ABATI STEPHEN D S/O DESOUZA JONATHAN P & STACE 110R PLEASANT ST E BRIDGEWATER, MA 02333				63-65-0				110-R PLEASANT ST				
TRANSFER HISTORY				DOS	T	SALE PRICE	BK-PG (Cert)					
DESOUZA JONATHAN P & STAC				08/02/2022	QS	425,000	57095-336					
ABATI STEPHEN D				04/27/1994	A	1	12834-072					
ABATI STEPHEN D				04/26/1994	A	1	12834-072					
CD	T	AC/SF/UN	Ngh	Inf1	Inf2	ADJ BASE	SAF	Inf3	Lpi	VC	CREDIT AMT	ADJ VALUE
100	S	43,560	3	1.00	100	188,000	1.00	100	1.00	3	188,000	
300	A	0.690	3	1.00	100	5,700	1.00	100	1.00	ELP	1.00	3,930

CLASS	CLASS%	DESCRIPTION			BN ID	BN	CARD	
1010	100	SINGLE FAMILY				1	1 of 1	
PMT NO	PMT DT	TY	DESC	AMOUNT	INSP	BY	1st	%
2070	06/18/2014	3	ALTERATIONS	26,000				0
		51	FIELD REVIEW		09/17/2013	LF		0

LAND

TOTAL	1.690 Acres	ZONING	FRNT	0	ASSESSED	CURRENT	PREVIOUS
Ngh	RES 3	N O T E C/W 63/63	LAND	191,900	174,600		
Inf1	FACTOR 100		BUILDING	173,000	171,000		
Inf2	PHY 100		DETACHED	40,800	38,700		
			OTHER	0	0		
		TOTAL		405,700	384,300		

DETACHED

TY	QUAL	COND	DIM/NOTE	YB	UNITS	ADJ PRICE	RCNLD
DGF	A	1.00	30 0.70		600	51.35	21,600
SHF	A	1.00	40 0.60		200	20.44	2,500
SHF	A	1.00	40 0.60		250	19.86	3,000
IPV	A	1.00	30 0.70	648	1,060	18.40	13,700

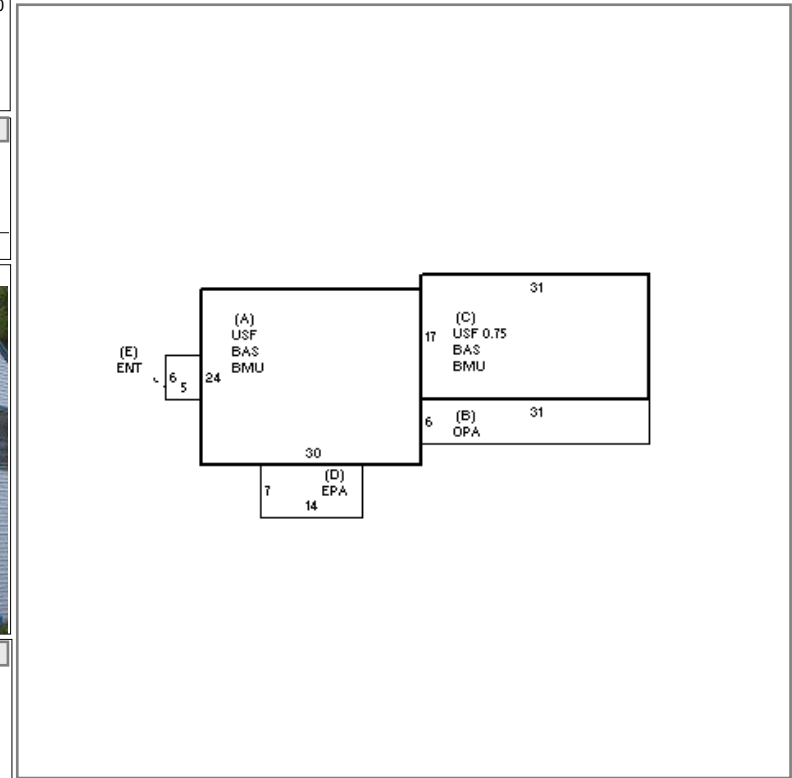

BUILDING

BUILDING	CD	ADJ	DESC	MEASURE	9/17/2013	LF
MODEL	1		RESIDENTIAL	LIST		
STYLE	7	0.90	CONVENTIONAL [100%]	REVIEW	4/4/2013	ER
QUALITY	A	1.00	AVERAGE [100%]			
FRAME	1	1.00	WOOD FRAME [100%]			

BLDG COMMENTS

G

YEAR BLT	1900	SIZE ADJ	1.000	ELEMENT	CD	DESCRIPTION	ADJ	S	BAT	T	DESCRIPTION	UNITS	YB	ADJ PRICE	RCN	TOTAL RCN	393,271																						
NET AREA	2,362	DETAIL ADJ	0.918	FOUNDATION	4	CONT BSMT WALL	1.00	+	BMU	N	BSMT UNFINISHED	1,247		36.68	45,737																								
\$NLA(RCN)	\$167	OVERALL	1.000	EXT COVER	4	VINYL	1.00	+	BAS	L	BASE AREA	1,247	1900	144.56	180,271																								
				ROOF SHAPE	1	GABLE	1.00	+	USF	L	UPPER STORY FIN	1,115	1900	131.37	146,476																								
				ROOF COVER	1	ASPH SHINGLES	1.00	B	OPA	N	OPEN PORCH	186		42.70	7,942																								
				FLOOR COVER	99	N/A	1.00	D	EPA	N	ENCLOSED PORCH	98		74.40	7,291																								
				INT FINISH	99	N/A	1.00	E	ENT	N	ENCLOSED ENTRY	30		81.10	2,433																								
				HEATING/COOLING	2	HOT WATER	1.02																																
				FUEL SOURCE	99	N/A	1.00																																
				ARPUD	0		1.00																																
				AFFORDABLE	0		1.00																																
<table border="1"> <thead> <tr> <th>CAPACITY</th> <th>UNITS</th> <th>ADJ</th> </tr> </thead> <tbody> <tr> <td>STORIES</td> <td>2</td> <td>1.00</td> </tr> <tr> <td>ROOMS</td> <td>8</td> <td>1.00</td> </tr> <tr> <td>BEDROOMS</td> <td>3</td> <td>1.00</td> </tr> <tr> <td>BATHROOMS</td> <td>1</td> <td>1.00</td> </tr> <tr> <td># 1/2 BATHS</td> <td>1</td> <td>1.00</td> </tr> <tr> <td>TOT FIXTURES</td> <td>5</td> <td>\$3,121</td> </tr> <tr> <td># UNITS</td> <td>1</td> <td>1.00</td> </tr> </tbody> </table>																CAPACITY	UNITS	ADJ	STORIES	2	1.00	ROOMS	8	1.00	BEDROOMS	3	1.00	BATHROOMS	1	1.00	# 1/2 BATHS	1	1.00	TOT FIXTURES	5	\$3,121	# UNITS	1	1.00
CAPACITY	UNITS	ADJ																																					
STORIES	2	1.00																																					
ROOMS	8	1.00																																					
BEDROOMS	3	1.00																																					
BATHROOMS	1	1.00																																					
# 1/2 BATHS	1	1.00																																					
TOT FIXTURES	5	\$3,121																																					
# UNITS	1	1.00																																					
<table border="1"> <thead> <tr> <th>CONDITION ELEM</th> <th>CD</th> </tr> </thead> <tbody> <tr> <td>EXTERIOR</td> <td></td> </tr> <tr> <td>INTERIOR</td> <td></td> </tr> <tr> <td>KITCHEN</td> <td></td> </tr> <tr> <td>BATHS</td> <td></td> </tr> <tr> <td>HEAT</td> <td></td> </tr> <tr> <td>ELECT</td> <td></td> </tr> </tbody> </table>																CONDITION ELEM	CD	EXTERIOR		INTERIOR		KITCHEN		BATHS		HEAT		ELECT											
CONDITION ELEM	CD																																						
EXTERIOR																																							
INTERIOR																																							
KITCHEN																																							
BATHS																																							
HEAT																																							
ELECT																																							
<table border="1"> <thead> <tr> <th>EFF.YR/AGE</th> <td>1955 / 66</td> </tr> </thead> <tbody> <tr> <td>COND</td> <td>56 56 %</td> </tr> <tr> <td>FUNC</td> <td>0</td> </tr> <tr> <td>ECON</td> <td>0</td> </tr> <tr> <td>DEPR</td> <td>56 % GD 44</td> </tr> </tbody> </table>																EFF.YR/AGE	1955 / 66	COND	56 56 %	FUNC	0	ECON	0	DEPR	56 % GD 44														
EFF.YR/AGE	1955 / 66																																						
COND	56 56 %																																						
FUNC	0																																						
ECON	0																																						
DEPR	56 % GD 44																																						
<table border="1"> <thead> <tr> <th>RCNLD</th> <td>\$173,000</td> </tr> </thead> </table>																RCNLD	\$173,000																						
RCNLD	\$173,000																																						