

Key: 4022

Town of E. BRIDGEWATER - Fiscal Year 2023

12/6/2022 6:38 pm SEQ #: 3479

LEGALS

CURRENT OWNER				PARCEL ID				LOCATION				
VANDEUSEN ROBERT & KERRY 330 BELMONT ST E. BRIDGEWATER, MA 02333				93-28-0				330 BELMONT ST				
TRANSFER HISTORY				DOS	T	SALE PRICE	BK-PG (Cert)					
VANDEUSEN ROBERT & KERRY				03/02/2005	A	1	30084-052					
VANDEUSEN ROBERT				02/26/2004	QS	221,000	27618-079					
FOUNTAIN BARBARA E				06/22/2000	QS	141,500	18628-200					
CD	T	AC/SF/UN	Ngh	Inf1	Inf2	ADJ BASE	SAF	Inf3	Lpi	VC	CREDIT AMT	ADJ VALUE
100	S	14,000 3	1.00	100	1.00	188,000	2.69	100	1.00	3	1.00	162,480

LAND

TOTAL	14,000 SF	ZONING	FRNT	0	ASSESSED	CURRENT	PREVIOUS
Ngh	RES 3	NOTE			LAND	162,500	147,800
Inf1	FACTOR 100		BUILDING	145,100	139,900		
Inf2	PHY 100		DETACHED	2,500	2,300		
			OTHER	0	0		
					TOTAL	310,100	290,000

DETACHED

TY	QUAL	COND	DIM/NOTE	YB	UNITS	ADJ PRICE	RCNLD
SHF	A	1.00	40 0.60		200	20.44	2,500



BUILDING

BUILDING	CD	ADJ	DESC	MEASURE	1/5/2017	JH
MODEL	1		RESIDENTIAL	LIST		
STYLE	6	1.05	COTT/BUNGALOW [100%]	REVIEW	4/15/2013	ER
QUALITY	A	1.00	AVERAGE [100%]			
FRAME	1	1.00	WOOD FRAME [100%]			

BLDG COMMENTS

CLASS	CLASS%	DESCRIPTION			BN ID	BN	CARD	
1010	100	SINGLE FAMILY				1	1 of 1	
PMT NO	PMT DT	TY	DESC	AMOUNT	INSP	BY	1st	%
		6	CYCL GROWTH		01/05/2017	JH	0	0
		6	CYCL GROWTH		11/14/2016	SD	0	0
		6	CYCL GROWTH		08/15/2013	LF	0	0

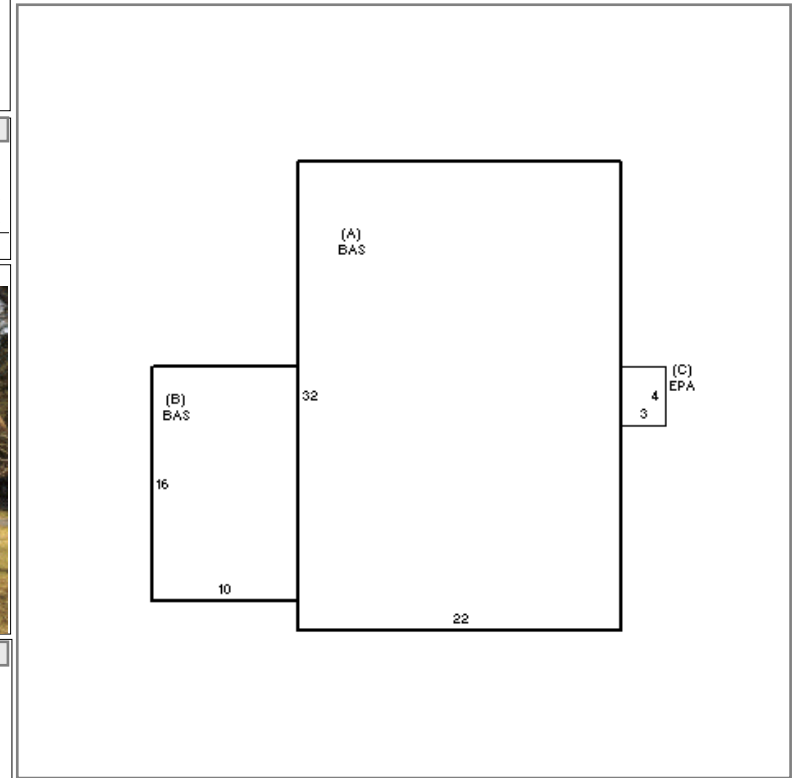

G

YEAR BLT	1958	SIZE ADJ	1.000	ELEMENT	CD	DESCRIPTION	ADJ	S	BAT	T	DESCRIPTION	UNITS	YB	ADJ PRICE	RCN	TOTAL RCN	213,309																								
NET AREA	864	DETAIL ADJ	1.026	FOUNDATION	2	SLAB	0.95	+	BAS	L	BASE AREA	864	1958	243.43	210,323																										
\$NLA(RCN)	\$247	OVERALL	1.000	EXT COVER	2	CLAPBOARD	1.00	C	EPA	N	ENCLOSED PORCH	12		74.42	893																										
				ROOF SHAPE	1	GABLE	1.00																																		
				ROOF COVER	1	ASPH SHINGLES	1.00																																		
				FLOOR COVER	99	N/A	1.00																																		
				INT FINISH	99	N/A	1.00																																		
				HEATING/COOLING	9	WARM/COOL AIR	1.03																																		
				FUEL SOURCE	2	GAS	1.00																																		
				ARPUD	0		1.00																																		
				AFFORDABLE	0		1.00																																		
				<table border="1"> <thead> <tr> <th>CAPACITY</th> <th>UNITS</th> <th>ADJ</th> </tr> </thead> <tbody> <tr> <td>STORIES</td> <td>1</td> <td>1.00</td> </tr> <tr> <td>ROOMS</td> <td>5</td> <td>1.00</td> </tr> <tr> <td>BEDROOMS</td> <td>2</td> <td>1.00</td> </tr> <tr> <td>BATHROOMS</td> <td>1</td> <td>1.00</td> </tr> <tr> <td># 1/2 BATHS</td> <td>0</td> <td>1.00</td> </tr> <tr> <td>TOT FIXTURES</td> <td>3</td> <td>\$2,093</td> </tr> <tr> <td># UNITS</td> <td>1</td> <td>1.00</td> </tr> </tbody> </table>														CAPACITY	UNITS	ADJ	STORIES	1	1.00	ROOMS	5	1.00	BEDROOMS	2	1.00	BATHROOMS	1	1.00	# 1/2 BATHS	0	1.00	TOT FIXTURES	3	\$2,093	# UNITS	1	1.00
CAPACITY	UNITS	ADJ																																							
STORIES	1	1.00																																							
ROOMS	5	1.00																																							
BEDROOMS	2	1.00																																							
BATHROOMS	1	1.00																																							
# 1/2 BATHS	0	1.00																																							
TOT FIXTURES	3	\$2,093																																							
# UNITS	1	1.00																																							
<table border="1"> <thead> <tr> <th>CONDITION ELEM</th> <th>CD</th> </tr> </thead> <tbody> <tr> <td>EXTERIOR</td> <td></td> </tr> <tr> <td>INTERIOR</td> <td></td> </tr> <tr> <td>KITCHEN</td> <td></td> </tr> <tr> <td>BATHS</td> <td></td> </tr> <tr> <td>HEAT</td> <td></td> </tr> <tr> <td>ELECT</td> <td>U</td> </tr> </tbody> </table>																CONDITION ELEM	CD	EXTERIOR		INTERIOR		KITCHEN		BATHS		HEAT		ELECT	U												
CONDITION ELEM	CD																																								
EXTERIOR																																									
INTERIOR																																									
KITCHEN																																									
BATHS																																									
HEAT																																									
ELECT	U																																								
<table border="1"> <thead> <tr> <th>EFF.YR/AGE</th> <td colspan="2">1970 / 51</td> </tr> </thead> <tbody> <tr> <td>COND</td> <td>32</td> <td>32 %</td> </tr> <tr> <td>FUNC</td> <td>0</td> <td></td> </tr> <tr> <td>ECON</td> <td>0</td> <td></td> </tr> <tr> <td>DEPR</td> <td>32</td> <td>% GD 68</td> </tr> </tbody> </table>																EFF.YR/AGE	1970 / 51		COND	32	32 %	FUNC	0		ECON	0		DEPR	32	% GD 68											
EFF.YR/AGE	1970 / 51																																								
COND	32	32 %																																							
FUNC	0																																								
ECON	0																																								
DEPR	32	% GD 68																																							
<table border="1"> <thead> <tr> <th>RCNLD</th> <td>\$145,100</td> </tr> </thead> </table>																RCNLD	\$145,100																								
RCNLD	\$145,100																																								