

Key: 4454

Town of E. BRIDGEWATER - Fiscal Year 2023

12/6/2022 6:38 pm SEQ #: 3.836

LEGAL

CURRENT OWNER				PARCEL ID				LOCATION			
LEONARD LAURA M 333 WASHINGTON ST E BRIDGEWATER, MA 02333				106-41-0				333 WASHINGTON ST			
TRANSFER HISTORY				DOS	T	SALE PRICE	BK-PG (Cert)				
LEONARD LAURA M				08/21/1984	QS		5755-244				
HANLEY JAMES E JR				09/23/1983	QS		5463-371				

CLASS	CLASS%	DESCRIPTION			BN ID	BN	CARD	
1010	100	SINGLE FAMILY				1	1 of 1	
PMT NO	PMT DT	TY	DESC	AMOUNT	INSP	BY	1st	%
BP-19-429	11/06/2019	3	ALTERATIONS	3,418				
		51	FIELD REVIEW		09/17/2013	LS	0	0
		6	CYCL GROWTH		09/09/2013	LF	0	0
		6	CYCL GROWTH		10/18/2010	SLB	0	0

LAND

CD	T	AC/SF/UN	Ngh	Inf1	Inf2	ADJ BASE	SAF	Inf3	Lpi	VC	CREDIT AMT	ADJ VALUE
100	S	36,488 3	1.00	100	1.00	188,000	1.16	100	1.00	3	1.00	181,900

TOTAL	36,488 SF	ZONING	FRNT	0	ASSESSED	CURRENT	PREVIOUS
Ngh	RES 3	NOTE LOT 1/ T 13768			LAND	181,900	165,500
Inf1	FACTOR 100		BUILDING	275,600	253,700		
Inf2	PHY 100		DETACHED	11,300	10,700		
			OTHER	0	0		
			TOTAL	468,800	429,900		

DETACHED

TY	QUAL	COND	DIM/NOTE	YB	UNITS	ADJ PRICE	RCNLD
SHF	A	1.00	40 0.60		200	20.44	2,500
IPV	A	1.00	30 0.70		648	19.48	8,800

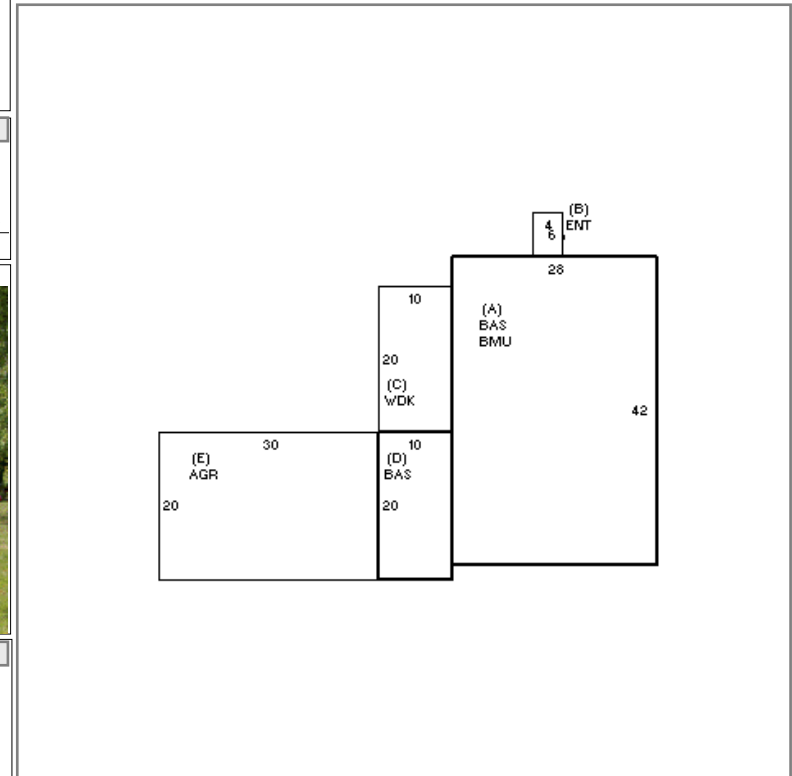

BUILDING

BUILDING	CD	ADJ	DESC	MEASURE	9/17/2013	LS
MODEL	1		RESIDENTIAL	LIST		
STYLE	1	1.00	RANCH [100%]	REVIEW	4/18/2013	ER
QUALITY	A	1.00	AVERAGE [100%]			
FRAME	1	1.00	WOOD FRAME [100%]			

BLDG COMMENTS

G

YEAR BLT	1983	SIZE ADJ	1.000	ELEMENT	CD	DESCRIPTION	ADJ	S	BAT	T	DESCRIPTION	UNITS	YB	ADJ PRICE	RCN	TOTAL RCN	372,432																			
NET AREA	1,376	DETAIL ADJ	1.030	FOUNDATION	4	CONT BSMT WALL	1.00	A	BMU	N	BSMT UNFINISHED	1,176		37.20	43,745																					
\$NLA(RCN)	\$271	OVERALL	1.000	EXT COVER	4	VINYL	1.00	B	ENT	N	ENCLOSED ENTRY	24		81.08	1,946																					
				ROOF SHAPE	1	GABLE	1.00	C	WDK	N	WOOD DECK	200		31.60	6,320																					
				ROOF COVER	1	ASPH SHINGLES	1.00	+	BAS	L	BASE AREA	1,376	1983	196.11	269,851																					
				FLOOR COVER	99	N/A	1.00	E	AGR	N	ATT GARAGE	600		67.25	40,351																					
				INT FINISH	99	N/A	1.00		F11	O	FPL 1S 10P	1		6,017.00	6,017																					
				HEATING/COOLING	9	WARM/COOL AIR	1.03																													
				FUEL SOURCE	99	N/A	1.00																													
				ARPUD	0		1.00																													
				AFFORDABLE	0		1.00																													
<table border="1"> <tr> <td>CONDITION ELEM</td> <td>CD</td> <td></td> </tr> <tr> <td>EXTERIOR</td> <td></td> <td></td> </tr> <tr> <td>INTERIOR</td> <td></td> <td></td> </tr> <tr> <td>KITCHEN</td> <td></td> <td></td> </tr> <tr> <td>BATHS</td> <td></td> <td></td> </tr> <tr> <td>HEAT</td> <td></td> <td></td> </tr> <tr> <td>ELECT</td> <td></td> <td></td> </tr> </table>																CONDITION ELEM	CD		EXTERIOR			INTERIOR			KITCHEN			BATHS			HEAT			ELECT		
CONDITION ELEM	CD																																			
EXTERIOR																																				
INTERIOR																																				
KITCHEN																																				
BATHS																																				
HEAT																																				
ELECT																																				
<table border="1"> <tr> <td>EFF.YR/AGE</td> <td colspan="2">1983 / 38</td> </tr> <tr> <td>COND</td> <td>26</td> <td>26 %</td> </tr> <tr> <td>FUNC</td> <td>0</td> <td></td> </tr> <tr> <td>ECON</td> <td>0</td> <td></td> </tr> <tr> <td>DEPR</td> <td>26</td> <td>% GD 74</td> </tr> <tr> <td>RCNLD</td> <td colspan="2">\$275,600</td> </tr> </table>																EFF.YR/AGE	1983 / 38		COND	26	26 %	FUNC	0		ECON	0		DEPR	26	% GD 74	RCNLD	\$275,600				
EFF.YR/AGE	1983 / 38																																			
COND	26	26 %																																		
FUNC	0																																			
ECON	0																																			
DEPR	26	% GD 74																																		
RCNLD	\$275,600																																			
CAPACITY		UNITS	ADJ																																	
STORIES	1	1.00																																		
ROOMS	5	1.00																																		
BEDROOMS	1	1.00																																		
BATHROOMS	2	1.00																																		
# 1/2 BATHS	0	1.00																																		
TOT FIXTURES	6	\$4,202																																		
# UNITS	1	1.00																																		