

Key: 4738

Town of E. BRIDGEWATER - Fiscal Year 2023

12/6/2022 6:38 pm SEQ #: 4.049

LEG
AL
LAND

CURRENT OWNER				PARCEL ID				LOCATION				
KAMINSKI PAUL & TERESE M 635 WINTER ST E BRIDGEWATER, MA 02333				120-28-0				635 WINTER ST				
TRANSFER HISTORY				DOS	T	SALE PRICE	BK-PG (Cert)					
KAMINSKI PAUL & TERESE M				11/30/2001	1	289,900	21028-189					
DOHERTY MICHAEL J &				06/01/1994	QS	156,000	12920-168					
BOURQUE GARY E & HEIDI J				12/28/1990	O	158,500	10093-142					
CD	T	AC/SF/UN	Ngh	Inf1	Inf2	ADJ BASE	SAF	Inf3	Lpi	VC	CREDIT AMT	ADJ VALUE
100	S	38,941	3	1.00	100	1.00	100	1.00	3	1.00		184,010

CLASS	CLASS%	DESCRIPTION			BN ID	BN	CARD	
1010	100	SINGLE FAMILY				1	1 of 1	
PMT NO	PMT DT	TY	DESC	AMOUNT	INSP	BY	1st	%
1732	09/25/2013	6	CYCL GROWTH		04/12/2021	SD	0	0
		3	ALTERATIONS	5,650			0	0
		6	CYCL GROWTH		08/29/2013		0	0

DET
ACHED

TOTAL	38,941 SF	ZONING	FRNT	0	ASSESSED	CURRENT	PREVIOUS
Ngh	RES 3	NOTE			LAND	184,000	167,400
Inf1	FACTOR 100		BUILDING	274,100	241,300		
Inf2	PHY 100		DETACHED	2,500	2,300		
			OTHER	0	0		
					TOTAL	460,600	411,000

TY	QUAL	COND	DIM/NOTE	YB	UNITS	ADJ PRICE	RCNLD
SHF	A	1.00	40 0.60	1991	200	20.44	2,500

PHOTO 04/28/2021

BLDG COMMENTS

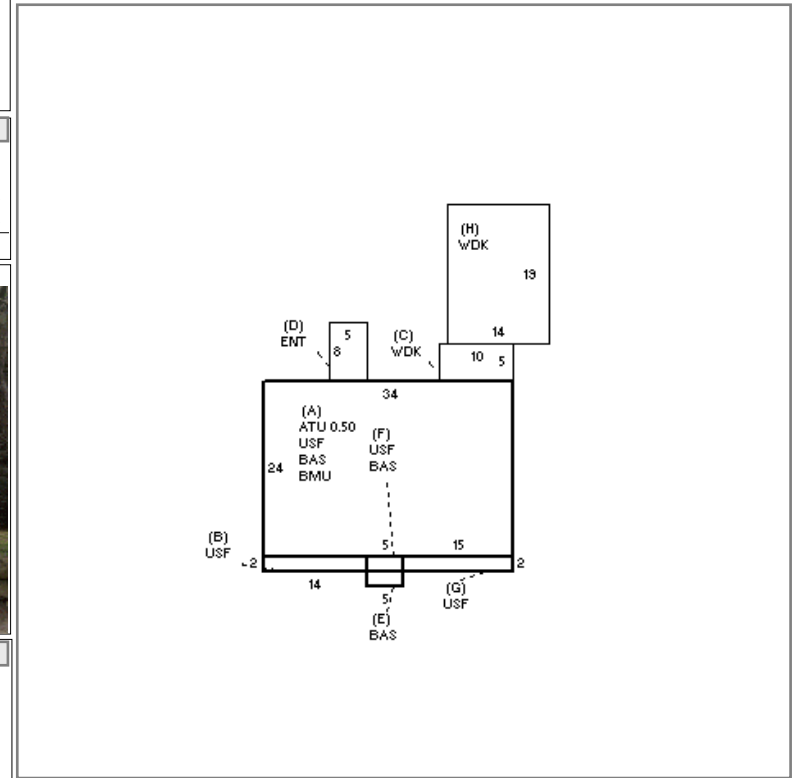

B
U
I
L
D
I
N
G

BUILDING	CD	ADJ	DESC	MEASURE	4/12/2021	SD
MODEL	1		RESIDENTIAL	LIST	4/12/2021	SD
STYLE	5	0.95	COLONIAL [100%]	REVIEW	4/19/2013	ER
QUALITY	+	1.05	AVG +/GOOD - [100%]			
FRAME	1	1.00	WOOD FRAME [100%]			

YEAR BLT	1990	SIZE ADJ	1.000	ELEMENT	CD	DESCRIPTION	ADJ
NET AREA	1,720	DETAIL ADJ	0.978	FOUNDATION	4	CONT BSMT WALL	1.00
\$NLA(RCN)	\$210	OVERALL	1.000	EXT COVER	2	CLAPBOARD	1.00
CAPACITY				ROOF SHAPE	1	GABLE	1.00
STORIES	2.5	ADJ	1.00	ROOF COVER	1	ASPH SHINGLES	1.00
ROOMS	6		1.00	FLOOR COVER	99	N/A	1.00
BEDROOMS	3		1.00	INT FINISH	99	N/A	1.00
BATHROOMS	2		1.00	HEATING/COOLING	9	WARM/COOL AIR	1.03
# 1/2 BATHS	0		1.00	FUEL SOURCE	2	GAS	1.00
TOT FIXTURES	6	\$4,190		ARPUD	0		1.00
# UNITS	1	1.00		AFFORDABLE	0		1.00

S	BAT	T	DESCRIPTION	UNITS	YB	ADJ PRICE	RCN
A	BMU	N	BSMT UNFINISHED	816		43.43	35,440
A	ATU	N	ATTIC UNF	408		31.81	12,980
+	USF	L	UPPER STORY FIN	884	1990	163.05	144,133
+	WDK	N	WOOD DECK	316		33.18	10,485
D	ENT	N	ENCLOSED ENTRY	40		85.16	3,406
+	BAS	L	BASE AREA	836	1990	179.42	149,998

TOTAL RCN	360,631
CONDITION ELEM	CD
EXTERIOR	
INTERIOR	
KITCHEN	
BATHS	
HEAT	
ELECT	
EFF.YR/AGE	1990 / 31
COND	24 24 %
FUNC	0
ECON	0
DEPR	24 % GD 76
RCNLD	\$274,100