

Key: 5225

Town of E. BRIDGEWATER - Fiscal Year 2023

12/6/2022 6:38 pm SEQ #: 4.475

LEGAL

LAND

DETACHED

BUILDING

| CURRENT OWNER | | | | PARCEL ID | | | | LOCATION | | | |
|--|--|--|--|------------|---|------------|--------------|--------------|--|--|--|
| CONDON NICOLE M & TIMOTHY E 14 MARLIN LN E BRIDGEWATER, MA 02333 | | | | 89-6-13-0 | | | | 14 MARLIN LN | | | |
| TRANSFER HISTORY | | | | DOS | T | SALE PRICE | BK-PG (Cert) | | | | |
| CONDON NICOLE M & TIMOTHY | | | | 05/12/2015 | A | 365,000 | 45536-095 | | | | |
| CONDON ROBERT J & HELEN M | | | | 09/03/2004 | P | 200,000 | 29006-173 | | | | |
| DIRENZO DANIEL O | | | | 06/15/2004 | P | 150,000 | 28437-002 | | | | |

| CLASS | CLASS% | DESCRIPTION | | | BN ID | BN | CARD | |
|----------|------------|---------------|--------------|---------|------------|-----|--------|-----|
| 1010 | 100 | SINGLE FAMILY | | | | 1 | 1 of 1 | |
| PMT NO | PMT DT | TY | DESC | AMOUNT | INSP | BY | 1st | % |
| BP-18-23 | 05/07/2018 | 8 | POOL | 30,000 | 04/24/2019 | SLB | 100 | 100 |
| 2939 | 05/23/2016 | 3 | ALTERATIONS | 4,682 | | | 0 | 0 |
| | | 6 | CYCL GROWTH | | 07/23/2013 | | 0 | 0 |
| 363 | 11/17/2005 | 7 | DETACHED BLD | 2,000 | 05/04/2006 | SLB | 100 | 100 |
| 732 | 09/15/2004 | 1 | NEW CONST | 290,000 | 04/04/2005 | KB | 0 | 100 |

| CD | T | AC/SF/UN | Ngh | Inf1 | Inf2 | ADJ BASE | SAF | Inf3 | Lpi | VC | CREDIT AMT | ADJ VALUE |
|-----|---|----------|------|------|------|----------|------|------|-----|------|------------|-----------|
| 100 | S | 35,000 4 | 1.00 | 100 | 1.00 | 100 | 1.00 | 1.00 | 4 | 1.20 | | 216,740 |

| TOTAL | 34,979 SF | ZONING | FRNT | 0 | ASSESSED | CURRENT | PREVIOUS |
|-------|------------|------------------|----------|---------|----------|---------|----------|
| Ngh | RES 4 | NOTE PAPER ST | LAND | 216,700 | 180,700 | | |
| Inf1 | FACTOR 100 | | BUILDING | 419,000 | 366,300 | | |
| Inf2 | PHY 100 | | DETACHED | 13,700 | 13,100 | | |
| | | | OTHER | 0 | 0 | | |
| | | | TOTAL | 649,400 | 560,100 | | |

| TY | QUAL | COND | DIM/NOTE | YB | UNITS | ADJ PRICE | RCNLD |
|-----|------|------|-----------------|------|-------|-----------|--------|
| SHF | A | 1.00 | 10 0.90 8X12 | 2005 | 96 | 20.44 | 1,800 |
| IPV | A | 1.00 | 10 0.90 18 X 39 | 2018 | 702 | 18.88 | 11,900 |



| BUILDING | CD | ADJ | DESC | MEASURE | 7/23/2013 | LF |
|----------|----|------|---------------------|---------|-----------|----|
| MODEL | 1 | | RESIDENTIAL | LIST | 4/4/2005 | KB |
| STYLE | 4 | 1.00 | CAPE [100%] | REVIEW | 4/23/2013 | ER |
| QUALITY | + | 1.05 | AVG +/GOOD - [100%] | | | |
| FRAME | 1 | 1.00 | WOOD FRAME [100%] | | | |

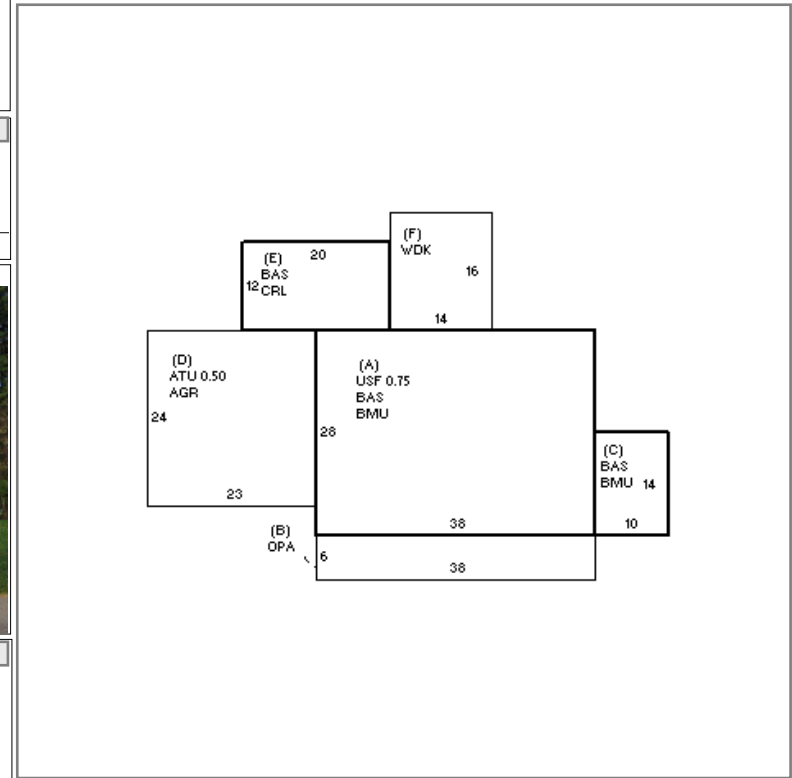

| YEAR BLT | 2004 | SIZE ADJ | 1.000 | ELEMENT | CD | DESCRIPTION | ADJ | S | BAT | T | DESCRIPTION | UNITS | YB | ADJ PRICE | RCN |
|------------|-------|------------|-------|-----------------|----|----------------|------|-----|-----|---|-----------------|-------|------|-----------|---------|
| NET AREA | 2,242 | DETAIL ADJ | 1.040 | FOUNDATION | 4 | CONT BSMT WALL | 1.00 | + | BMU | N | BSMT UNFINISHED | 1,204 | | 37.24 | 44,833 |
| \$NLA(RCN) | \$225 | OVERALL | 1.000 | EXT COVER | 4 | VINYL | 1.00 | + | BAS | L | BASE AREA | 1,444 | 2004 | 174.63 | 252,163 |
| | | | | ROOF SHAPE | 1 | GABLE | 1.00 | A | USF | L | UPPER STORY FIN | 798 | 2004 | 158.69 | 126,633 |
| | | | | ROOF COVER | 1 | ASPH SHINGLES | 1.00 | B | OPA | N | OPEN PORCH | 228 | | 44.84 | 10,223 |
| | | | | FLOOR COVER | 99 | N/A | 1.00 | D | AGR | N | ATT GARAGE | 552 | | 71.94 | 39,711 |
| | | | | INT FINISH | 99 | N/A | 1.00 | D | ATU | N | ATTIC UNF | 276 | | 31.82 | 8,781 |
| | | | | HEATING/COOLING | 11 | HW/COOL AIR | 1.04 | E | CRL | N | BSMT CRAWL | 240 | | 8.26 | 1,984 |
| | | | | FUEL SOURCE | 2 | GAS | 1.00 | F | WDK | N | WOOD DECK | 224 | | 33.18 | 7,432 |
| | | | | ARPUD | 0 | | 1.00 | F21 | O | | FPL 2S 1OP | 1 | | 7,160.00 | 7,160 |
| | | | | AFFORDABLE | 0 | | 1.00 | | | | | | | | |

| TOTAL RCN | 504,860 |
|-------------------|------------|
| CONDITION ELEM CD | |
| EXTERIOR | |
| INTERIOR | |
| KITCHEN | |
| BATHS | |
| HEAT | |
| ELECT | |
| EFF.YR/AGE | 2004 / 17 |
| COND | 17 17 % |
| FUNC | 0 |
| ECON | 0 |
| DEPR | 17 % GD 83 |
| RCNLD | \$419,000 |