

Key: 5295

Town of E. BRIDGEWATER - Fiscal Year 2023

12/6/2022 6:38 pm SEQ #: 4.523

LEGALS

| CURRENT OWNER | | | | PARCEL ID | | | | LOCATION | | | | |
|--|---|----------|------|-------------|------|------------|--------------|-------------------|------|----|------------|-----------|
| DEEB MICHAEL P S/O DEEB SARA JILL 139 WASHINGTON ST E BRIDGEWATER, MA 02333 | | | | 116-22-02-0 | | | | 139 WASHINGTON ST | | | | |
| TRANSFER HISTORY | | | | DOS | T | SALE PRICE | BK-PG (Cert) | | | | | |
| DEEB SARA JILL | | | | 08/03/2022 | A | 1 | 57100-082 | | | | | |
| DEEB MICHAEL P | | | | 12/23/2020 | QS | 565,000 | 54063-327 | | | | | |
| HOUSE 2 HOME REAL ESTATE | | | | 06/05/2020 | L | 229,900 | 52868-266 | | | | | |
| CD | T | AC/SF/UN | Ngh | Inf1 | Inf2 | ADJ BASE | SAF | Inf3 | Lpi | VC | CREDIT AMT | ADJ VALUE |
| 100 | S | 21,626 3 | 1.00 | 100 | 1.00 | 188,000 | 1.81 | 100 | 1.00 | 3 | 1.00 | 169,070 |

LAND

| TOTAL | 21,626 SF | ZONING | FRNT | 0 | ASSESSED | CURRENT | PREVIOUS |
|-------|------------|--------|------|-------|----------|---------|----------|
| Ngh | RES 3 | NOTE | | | LAND | 169,100 | 153,800 |
| Inf1 | FACTOR 100 | | | | BUILDING | 435,300 | 374,900 |
| Inf2 | PHY 100 | | | | DETACHED | 0 | 0 |
| | | | | | OTHER | 0 | 0 |
| | | | | TOTAL | 604,400 | 528,700 | |

DETACHED

| TY | QUAL | COND | DIM/NOTE | YB | UNITS | ADJ PRICE | RCNLD |
|----|------|------|----------|----|-------|-----------|-------|
| | | | | | | | |



BLDG COMMENTS

BUILDING

| BUILDING | CD | ADJ | DESC | MEASURE | 2/23/2021 | SLB |
|----------|----|------|-------------------|---------|-----------|-----|
| MODEL | 1 | | RESIDENTIAL | LIST | 2/23/2021 | SLB |
| STYLE | 4 | 1.00 | CAPE [100%] | REVIEW | 4/24/2013 | ER |
| QUALITY | A | 1.00 | AVERAGE [100%] | | | |
| FRAME | 1 | 1.00 | WOOD FRAME [100%] | | | |

G

| YEAR BLT | 1800 | SIZE ADJ | 1.000 | ELEMENT | CD | DESCRIPTION | ADJ |
|--------------|-------|------------|---------|-----------------|----|---------------|------|
| NET AREA | 2,961 | DETAIL ADJ | 1.020 | FOUNDATION | 5 | BRICK/STONE | 1.00 |
| \$NLA(RCN) | \$184 | OVERALL | 1.000 | EXT COVER | 1 | WD SHINGLES | 1.00 |
| CAPACITY | | | | ROOF SHAPE | 1 | GABLE | 1.00 |
| STORIES | 1.75 | UNITS | 1.00 | ROOF COVER | 1 | ASPH SHINGLES | 1.00 |
| ROOMS | 8 | ADJ | 1.00 | FLOOR COVER | 99 | N/A | 1.00 |
| BEDROOMS | 3 | | 1.00 | INT FINISH | 99 | N/A | 1.00 |
| BATHROOMS | 2 | | 1.00 | HEATING/COOLING | 2 | HOT WATER | 1.02 |
| # 1/2 BATHS | 1 | | 1.00 | FUEL SOURCE | 99 | N/A | 1.00 |
| TOT FIXTURES | 8 | | \$5,549 | ARPUD | 0 | | 1.00 |
| # UNITS | 1 | | 1.00 | AFFORDABLE | 0 | | 1.00 |

| CLASS | CLASS% | DESCRIPTION | | | BN ID | BN | CARD | |
|-----------|------------|---------------|--------------|--------|------------|-----|--------|-----|
| 1010 | 100 | SINGLE FAMILY | | | | 1 | 1 of 1 | |
| PMT NO | PMT DT | TY | DESC | AMOUNT | INSP | BY | 1st | % |
| BP-20-299 | 06/25/2020 | 99 | OTHER | | 08/18/2020 | SD | 0 | 0 |
| | | 3 | ALTERATIONS | 94,000 | 02/23/2021 | SLB | 100 | 100 |
| | | 51 | FIELD REVIEW | | 09/17/2013 | | 0 | 0 |
| | | 6 | CYCL GROWTH | | 10/18/2010 | SLB | 0 | 0 |

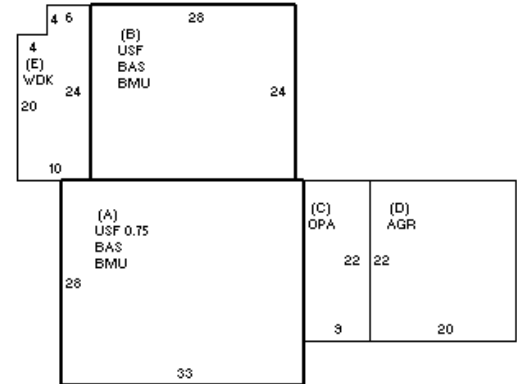

| TOTAL RCN | 544,167 |
|----------------------|------------|
| CONDITION ELEM CD | |
| EXTERIOR | G |
| INTERIOR | G |
| KITCHEN | G |
| BATHS | G |
| HEAT | U |
| ELECT | U |
| EFF.YR/AGE 2001 / 20 | |
| COND | 20 20 % |
| FUNC | 0 |
| ECON | 0 |
| DEPR | 20 % GD 80 |
| RCNLD | \$435,300 |