

Key: 5948

Town of E. BRIDGEWATER - Fiscal Year 2023

12/6/2022 6:38 pm SEQ #: 4.643

LEGALS

CURRENT OWNER				PARCEL ID				LOCATION			
HUNTER NICOLE & HALL KEVIN M 2 DOLPHIN DR E BRIDGEWATER, MA 02333				39-22-0				2 DOLPHIN DR			
TRANSFER HISTORY				DOS	T	SALE PRICE	BK-PG (Cert)				
HUNTER NICOLE & HALL KEVI				01/16/1998	A		1 15811-093				
SEXTON EDWARD J JR & SHAR				04/07/1993	A		1 11758-347				

CLASS	CLASS%	DESCRIPTION			BN ID	BN	CARD	
1010	100	SINGLE FAMILY				1	1 of 1	
PMT NO	PMT DT	TY	DESC	AMOUNT	INSP	BY	1st	%
		6	CYCL GROWTH		03/08/2013	PW	0	0

LAND

CD	T	AC/SF/UN	Ngh	Infl1	Infl2	ADJ BASE	SAF	Infl3	Lpi	VC	CREDIT AMT	ADJ VALUE
100	S	43,560 4	1.00	100	1.00	225,600	1.00	100	1.00	4	1.20	225,600
300	A	0.750 4	1.00	100	1.00	5,700	1.00	100	1.00	ELP	1.00	4,280

TOTAL	1.750 Acres	ZONING	NOTED	FRNT	0	ASSESSED	CURRENT	PREVIOUS
Ngh	RES 4	NOTED	LAND	229,900	192,000			
Infl1	FACTOR 100		BUILDING	421,600	377,800			
Infl2	PHY 100		DETACHED	0	0			
			OTHER	0	0			
TOTAL				651,500	569,800			

DETACHED

TY	QUAL	COND	DIM/NOTE	YB	UNITS	ADJ PRICE	RCNLD

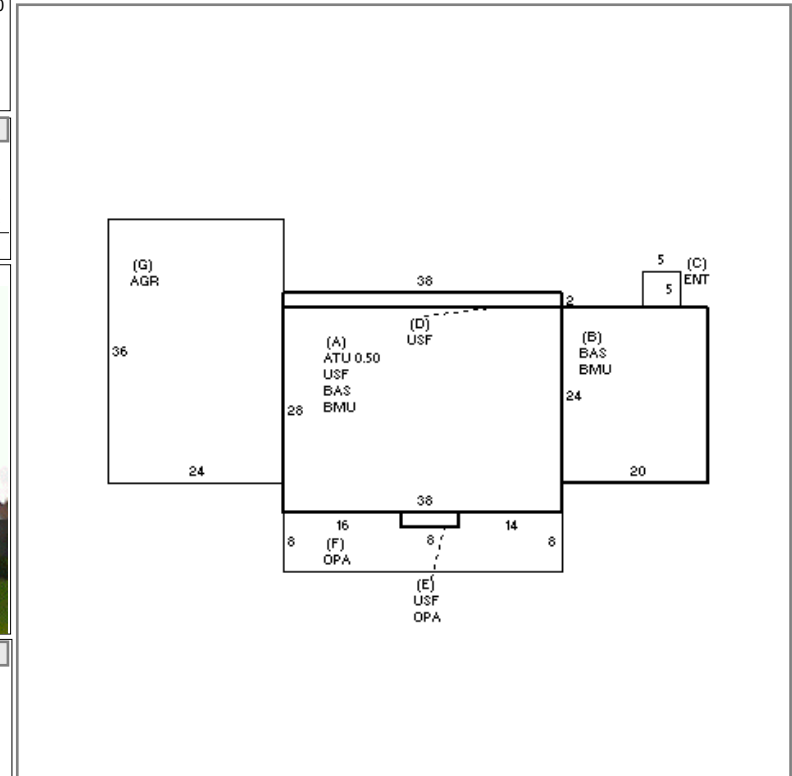

BUILDING

BUILDING	CD	ADJ	DESC	MEASURE	3/8/2013	PW
MODEL	1		RESIDENTIAL	LIST		
STYLE	5	0.95	COLONIAL [100%]	REVIEW	4/25/2013	ER
QUALITY	A	1.00	AVERAGE [100%]			
FRAME	1	1.00	WOOD FRAME [100%]			

BLDG COMMENTS
PRIVATE WELL

INDING

YEAR BLT	1998	SIZE ADJ	1.000	ELEMENT	CD	DESCRIPTION	ADJ	S	BAT	T	DESCRIPTION	UNITS	YB	ADJ PRICE	RCN	TOTAL RCN	540,492
NET AREA	2,700	DETAIL ADJ	0.988	FOUNDATION	4	CONT BSMT WALL	1.00	+	BMU	N	BSMT UNFINISHED	1,544		34.94	53,952	CONDITION ELEM	CD
\$NLA(RCN)	\$200	OVERALL	1.000	EXT COVER	4	VINYL	1.00	+	BAS	L	BASE AREA	1,544	1998	149.91	231,457	EXTERIOR	
CAPACITY			UNITS	ADJ	ROOF SHAPE	1	GABLE	1.00	A	ATU	N	ATTIC UNF		30.30	16,120	INTERIOR	
STORIES	2.5	1.00	ROOF COVER	1	ASPH SHINGLES	1.00	C	ENT	N	ENCLOSED ENTRY	25		81.12	2,028	KITCHEN		
ROOMS	7	1.00	FLOOR COVER	99	N/A	1.00	+	USF	L	UPPER STORY FIN	1,156	1998	136.22	157,476	BATHS		
BEDROOMS	3	1.00	INT FINISH	99	N/A	1.00	+	OPA	N	OPEN PORCH	304		42.70	12,981	HEAT		
BATHROOMS	2	1.00	HEATING/COOLING	11	HW/COOL AIR	1.04	G	AGR	N	ATT GARAGE	864		62.83	54,284	ELECT		
# 1/2 BATHS	1	1.00	FUEL SOURCE	2	GAS	1.00	F21	O	FPL 2S 1OP	1			6,819.00	6,819			
TOT FIXTURES	8	\$5,375	ARPUD	0		1.00											
# UNITS	1	1.00	AFFORDABLE	0		1.00											
																EFF.YR/AGE	1998 / 23
																COND	22 22 %
																FUNC	0
																ECON	0
																DEPR	22 % GD 78
																RCNLD	\$421,600