

Key: 6423

Town of E. BRIDGEWATER - Fiscal Year 2023

12/6/2022 6:38 pm SEQ #: 4.804

LEGAL LAND

CURRENT OWNER				PARCEL ID				LOCATION			
LIPINSKI JOSEPH S & LAURA A 498 CEDAR ST E BRIDGEWATER, MA 02333				65-5-01-0				498 CEDAR ST			
TRANSFER HISTORY				DOS	T	SALE PRICE	BK-PG (Cert)				
LIPINSKI JOSEPH S & LAURA				06/07/1996	A	40,000	14422-094				
LIPINSKI JOSEPH S & LAURA				06/06/1996	A	40,000	14422-094				
LIPINSKI STEPHEN				05/13/1988	QS		08482-213				

CLASS	CLASS%	DESCRIPTION			BN ID	BN	CARD	
1010	100	SINGLE FAMILY				1	1 of 1	
PMT NO	PMT DT	TY	DESC	AMOUNT	INSP	BY	1st	%
BP-20-606	11/27/2020	3	ALTERATIONS	6,990				0
		6	CYCL GROWTH		11/03/2020	SD		0
BP-18-273	10/10/2018	3	ALTERATIONS	9,397				0
		6	CYCL GROWTH		04/01/2014	PW		0

LEGAL LAND

CD	T	AC/SF/UN	Ngh	Inf1	Inf2	ADJ BASE	SAF	Inf3	Lpi	VC	CREDIT AMT	ADJ VALUE
100	S	35,000 3	1.00	100	1.00	188,000	1.20	100	1.00	3	1.00	180,620

TOTAL	34,979 SF	ZONING	FRNT	0	ASSESSED	CURRENT	PREVIOUS
Ngh	RES 3	NOTE			LAND	180,600	164,300
Inf1	FACTOR 100		BUILDING	319,000	284,100		
Inf2	PHY 100		DETACHED	0	0		
			OTHER	0	0		
					<b>TOTAL</b>	<b>499,600</b>	<b>448,400</b>

DETACHED

TY	QUAL	COND	DIM/NOTE	YB	UNITS	ADJ PRICE	RCNLD

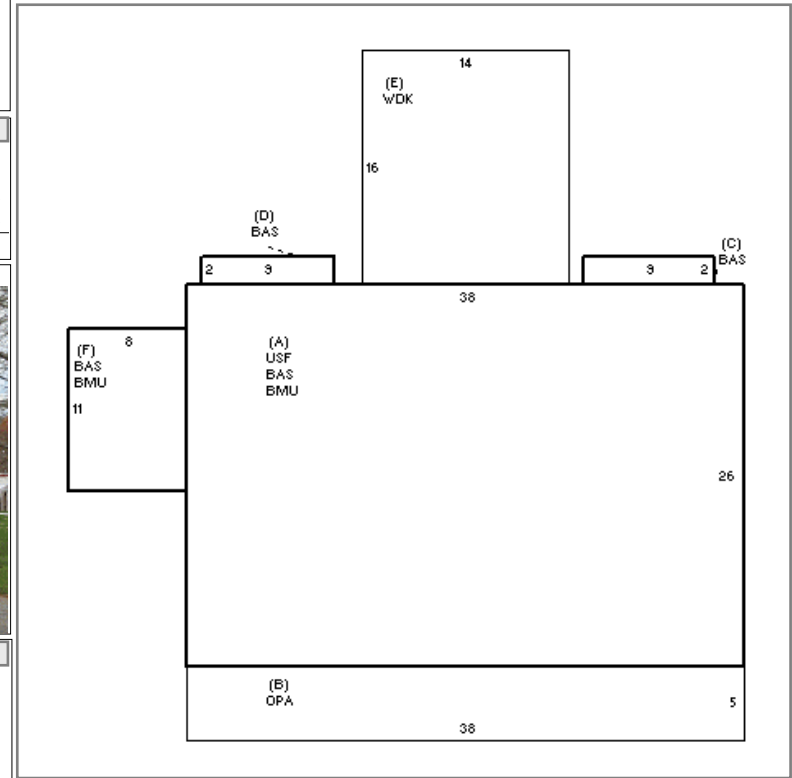

BUILDING

BUILDING	CD	ADJ	DESC	MEASURE	11/3/2020	SD
MODEL	1		RESIDENTIAL	LIST	11/3/2020	SD
STYLE	5	0.95	COLONIAL [100%]	REVIEW	5/2/2013	ER
QUALITY	A	1.00	AVERAGE [100%]			
FRAME	1	1.00	WOOD FRAME [100%]			

BLDG COMMENTS

BUILDING

YEAR BLT	1996	SIZE ADJ	1.000	ELEMENT	CD	DESCRIPTION	ADJ	S	BAT	T	DESCRIPTION	UNITS	YB	ADJ PRICE	RCN	TOTAL RCN	379,788
NET AREA	2,100	DETAIL ADJ	0.950	FOUNDATION	4	CONT BSMT WALL	1.00	+	BMU	N	BSMT UNFINISHED	1,076		38.07	40,959		
\$NLA(RCN)	\$181	OVERALL	1.000	EXT COVER	2	CLAPBOARD	1.00	A	USF	L	UPPER STORY FIN	988	1996	140.91	139,220		
				ROOF SHAPE	1	GABLE	1.00	B	OPA	N	OPEN PORCH	190		42.70	8,113		
				ROOF COVER	1	ASPH SHINGLES	1.00	+	BAS	L	BASE AREA	1,112	1996	155.06	172,431		
				FLOOR COVER	99	N/A	1.00	E	WDK	N	WOOD DECK	224		31.60	7,078		
				INT FINISH	99	N/A	1.00		F21	O	FPL 2S 1OP	1		6,819.00	6,819		
				HEATING/COOLING	1	FORCED AIR	1.00										
				FUEL SOURCE	2	GAS	1.00										
				ARPUD	0		1.00										
				AFFORDABLE	0		1.00										

CAPACITY	UNITS	ADJ
STORIES	2	1.00
ROOMS	7	1.00
BEDROOMS	3	1.00
BATHROOMS	2	1.00
# 1/2 BATHS	1	1.00
TOT FIXTURES	8	\$5,168
# UNITS	1	1.00

CONDITION ELEM	CD
EXTERIOR	
INTERIOR	
KITCHEN	
BATHS	
HEAT	
ELECT	

EFF.YR/AGE	2005 / 16	
COND	16	16 %
FUNC	0	
ECON	0	
DEPR	16	% GD 84

RCNLD	\$319,000
-------	-----------