

Key: 7296

Town of E. BRIDGEWATER - Fiscal Year 2023

12/6/2022 6:38 pm SEQ #: 5.361

LEGAL

LAND

DETACHED

BUILDING

INDING

CURRENT OWNER				PARCEL ID				LOCATION				
THE SALVATORE F FUSCO REV TR & THE JOAN F FUSCO REV TRUST				81-34-9-0				109 N FOLSOM AVE				
587 PLAZA DEL SOL				TRANSFER HISTORY				DOS	T	SALE PRICE	BK-PG (Cert)	
N FORT MYERS, FL 33917-2994				THE SALVATORE F FUSCO REV				11/02/2016	A	1	47693-189	
				WARD JOAN & FUSCO SALVATO				10/15/2010	S	140,000	39121-57	
				WEISHAUS ROBERT A				07/27/2010	S	107,625	38770-306	

CLASS	CLASS%	DESCRIPTION			BN ID	BN	CARD	
1010	100	SINGLE FAMILY			1	1	of 1	
PMT NO	PMT DT	TY	DESC	AMOUNT	INSP	BY	1st	%
BP-20-343	07/21/2020	6	CYCL GROWTH		09/14/2021	SD	0	0
2228	10/03/2014	3	ALTERATIONS	2,000			0	0
	06/26/2013	3	ALTERATIONS	600			0	0
		6	CYCL GROWTH		10/07/2013	SLB	0	0
		6	CYCL GROWTH		06/06/2009		0	0

CD	T	AC/SF/UN	Ngh	Infl1	Infl2	ADJ BASE	SAF	Infl3	Lpi	VC	CREDIT AMT	ADJ VALUE
100	S	7,254	1	1.00	100	1.00	100	1.00	8	0.65		101,830

TOTAL	7,254 SF	ZONING	FRNT	0	ASSESSED	CURRENT	PREVIOUS
Ngh	RES 1	NOTE			LAND	101,800	92,600
Infl1	FACTOR 100		BUILDING	242,700	225,900		
Infl2	PHY 100		DETACHED	0	0		
			OTHER	0	0		
					<b>TOTAL</b>	<b>344,500</b>	<b>318,500</b>

TY	QUAL	COND	DIM/NOTE	YB	UNITS	ADJ PRICE	RCNLD



BUILDING	CD	ADJ	DESC	MEASURE	9/10/2021	SD
MODEL	1		RESIDENTIAL	LIST	9/10/2021	SD
STYLE	1	1.00	RANCH [100%]	REVIEW	5/13/2013	ER
QUALITY	A	1.00	AVERAGE [100%]			
FRAME	1	1.00	WOOD FRAME [100%]			

YEAR BLT	2006	SIZE ADJ	1.000	ELEMENT	CD	DESCRIPTION	ADJ	S	BAT	T	DESCRIPTION	UNITS	YB	ADJ PRICE	RCN
NET AREA	1,004	DETAIL ADJ	1.030	FOUNDATION	4	CONT BSMT WALL	1.00	A	BMU	N	BSMT UNFINISHED	988		39.00	38,535
\$NLA(RCN)	\$284	OVERALL	1.000	EXT COVER	4	VINYL	1.00	+	BAS	L	BASE AREA	1,004	2006	226.44	227,341
				ROOF SHAPE	1	GABLE	1.00	D	OPA	N	OPEN PORCH	24		42.71	1,025
				ROOF COVER	1	ASPH SHINGLES	1.00	E	EPA	N	ENCLOSED PORCH	120		74.40	8,928
				FLOOR COVER	14	COMB	1.00	F	PTA	N	PATIO	238		12.50	2,975
				INT FINISH	2	DRYWALL	1.00		GFP	O	GAS FIREPLACE	1		4,584.00	4,584
				HEATING/COOLING	9	WARM/COOL AIR	1.03								
				FUEL SOURCE	2	GAS	1.00								
				ARPUD	0		1.00								
				AFFORDABLE	0		1.00								

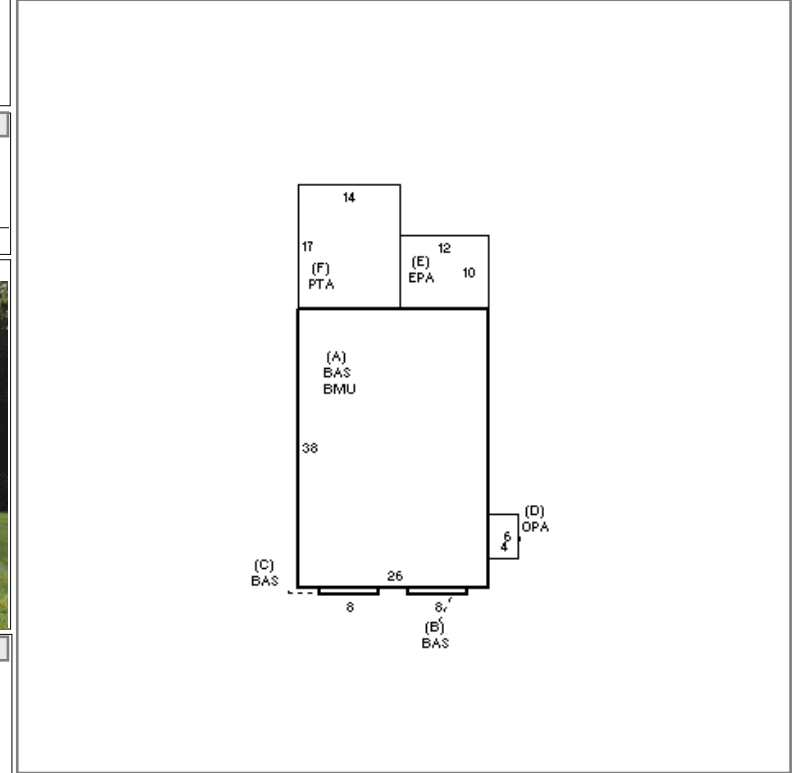

CAPACITY			UNITS	ADJ
STORIES	1		1	1.00
ROOMS	4		1	1.00
BEDROOMS	2		1	1.00
BATHROOMS	1		1	1.00
# 1/2 BATHS	0		1	1.00
TOT FIXTURES	3	\$2,101		
# UNITS	1		1	1.00

TOTAL RCN	285,489
CONDITION ELEM	CD
EXTERIOR	
INTERIOR	
KITCHEN	
BATHS	
HEAT	
ELECT	
EFF.YR/AGE	2006 / 15
COND	15 15%
FUNC	0
ECON	0
DEPR	15 % GD 85
RCNLD	\$242,700