

Key: 796

Town of E. BRIDGEWATER - Fiscal Year 2023

12/6/2022 6:38 pm SEQ #: 684

LEGAL

LAND

DETACHED

BUILDING

CURRENT OWNER				PARCEL ID				LOCATION			
REDDER JAMES M 10 JEAN TERRACE E BRIDGEWATER, MA 02333				17-50-0				10 JEAN TER			
TRANSFER HISTORY				DOS	T	SALE PRICE		BK-PG (Cert)			
REDDER JAMES M				01/25/2007	A	1 34018-315					
REDDER JEREMY J				04/01/2005	A	100 30278-290					
REDDER JAMES M				03/25/2005	A	100 30220-228					

CLASS	CLASS%	DESCRIPTION			BN ID	BN	CARD	
1010	100	SINGLE FAMILY				1	1 of 1	
PMT NO	PMT DT	TY	DESC	AMOUNT	INSP	BY	1st	%
		6	CYCL GROWTH		12/16/2014	LF	0	0
		51	FIELD REVIEW		06/25/2013	LF	0	0

CD	T	AC/SF/UN	Ngh	Inf1	Inf2	ADJ BASE	SAF	Inf3	Lpi	VC	CREDIT AMT	ADJ VALUE
100	S	35,866 4	1.00	100	1.00	100	1.00	1.00	4	1.20		217,630

TOTAL	35,850 SF	ZONING	FRNT 0	ASSESSED	217,600	CURRENT	741,800	PREVIOUS	671,900
Ngh	RES 4	LOT 9		LAND	217,600	BUILDING	512,900	DETACHED	11,300
Inf1	FACTOR 100	OTHER		OTHER	0	TOTAL	741,800	PREVIOUS	671,900
Inf2	PHY 100								

TY	QUAL	COND	DIM/NOTE	YB	UNITS	ADJ PRICE	RCNLD
SHF	A	1.00	40 0.60		200	20.44	2,500
IPV	A	1.00	30 0.70	1990	648	19.48	8,800



BUILDING	CD	ADJ	DESC	MEASURE	12/16/2014	LF
MODEL	1		RESIDENTIAL	LIST		
STYLE	8	0.98	CONTEMPORARY [100%]	REVIEW	3/20/2013	ER
QUALITY	A	1.00	AVERAGE [100%]			
FRAME	1	1.00	WOOD FRAME [100%]			

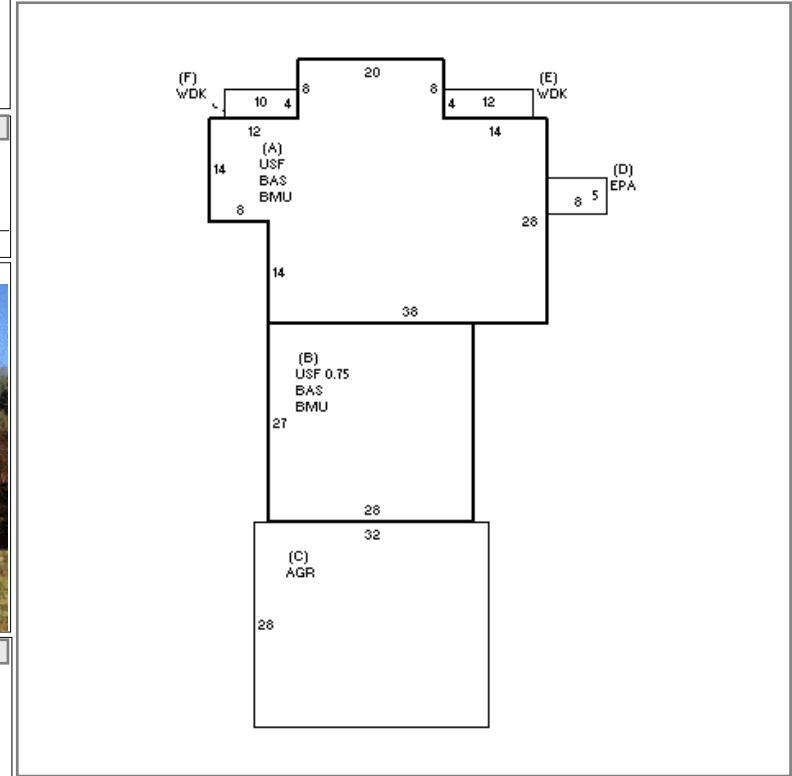

YEAR BLT	1987	SIZE ADJ	1.000	ELEMENT	CD	DESCRIPTION	ADJ	S	BAT	T	DESCRIPTION	UNITS	YB	ADJ PRICE	RCN	
NET AREA	3,995	DETAIL ADJ	1.019	FOUNDATION	4	CONT BSMT WALL	1.00	+	BMU	N	BSMT UNFINISHED	2,092		33.07	69,181	
\$NLA(RCN)	\$171	OVERALL	1.000	EXT COVER	2	CLAPBOARD	1.00	+	BAS	L	BASE AREA	2,092	1987	141.30	295,595	
CAPACITY			UNITS	ADJ	ROOF SHAPE	1	GABLE	1.00	+	USF	L	UPPER STORY FIN	1,903	1987	128.40	244,347
STORIES	2	1.00		ROOF COVER	1	ASPH SHINGLES	1.00	C	AGR	N	ATT GARAGE	896		62.48	55,980	
ROOMS	9	1.00		FLOOR COVER	99	N/A	1.00	D	EPA	N	ENCLOSED PORCH	40		74.40	2,976	
BEDROOMS	5	1.00		INT FINISH	99	N/A	1.00	+	WDK	N	WOOD DECK	88		31.60	2,781	
BATHROOMS	2	1.00		HEATING/COOLING	11	HW/COOL AIR	1.04	F21	O	O	FPL 2S 1OP	1		6,819.00	6,819	
# 1/2 BATHS	1	1.00		FUEL SOURCE	99	N/A	1.00									
TOT FIXTURES	9	\$6,236		ARPUD	0		1.00									
# UNITS	1	1.00		AFFORDABLE	0		1.00									

TOTAL RCN	683,915
CONDITION ELEM	CD
EXTERIOR	
INTERIOR	
KITCHEN	
BATHS	
HEAT	
ELECT	
EFF.YR/AGE	1987 / 34
COND	25 25%
FUNC	0
ECON	0
DEPR	25 % GD 75
RCNLD	\$512,900