

| CURRENT OWNER  |            | TOPO  | UTILITIES   | STRT / ROAD | LOCATION    | CURRENT ASSESSMENT                          |   |                                       |           |                               |            |       |                  |                     |      |                          |            |         |
|--|------------|---|---|-------------|-------------|---|---|---------------------------------------|-----------|-------------------------------|------------|-------|------------------|---------------------|------|--------------------------|------------|---------|
| HUJSAK JENNIE M &<br>CONWAY JAMES M<br>192 WESTFIELD ST  |            |   | 2 Public Water  |             |             | Description                                 | Code  | Appraised                             | Assessed  |                               |            |       |                  |                     |      |                          |            |         |
|  |            |   |   |             |             | RESIDENTL                                   | 1010  | 708,900                               | 708,900   |                               |            |       |                  |                     |      |                          |            |         |
| WESTWOOD MA 02090  |            | <b>SUPPLEMENTAL DATA</b>  |   |             |             | RES LND                                     | 1010  | 333,200                               | 333,200   |                               |            |       |                  |                     |      |                          |            |         |
|  |            | Alt Prcl ID<br>PLN#/Rec<br>Lot#<br>Plan Notes<br>Plan Notes<br>Plan Notes<br>GIS ID M_277230_796085 | Restriction<br>Hist Distrct<br>Other Note<br>UC-Misc 1<br>UC-Misc 2<br>Assoc Pid# |             |             | Total                                       |   | 1,042,100                             | 1,042,100 |                               |            |       |                  |                     |      |                          |            |         |
| <b>RECORD OF OWNERSHIP</b>   |            | <b>BK-VOL/PAGE</b>  | <b>SALE DATE</b>  | <b>Q/U</b>  | <b>V/I</b>  | <b>SALE PRICE</b>                           | <b>VC</b>   | <b>PREVIOUS ASSESSMENTS (HISTORY)</b> |           |                               |            |       |                  |                     |      |                          |            |         |
| HUJSAK JENNIE M &<br>LITOWINSKY OLGA J<br>MAYHEW HILDA R<br>SULLIVAN JOSEPH A<br>DODGERS HOLE CORP |            | 0061 0319<br>00038 0121<br>00035 0011<br>00025 0109<br>00023 0297                                   | 11-07-2003<br>05-15-1987<br>11-13-1985<br>06-26-1979<br>05-01-1978                | Q<br>Q<br>Q | I<br>I<br>V | 432,000<br>167,000<br>32,500<br>10,000<br>0 | 00<br>00<br>00  | Year                                  | Code      | Assessed                      | Year       | Code  | Assessed         | Year                | Code | Assessed                 |            |         |
|  |            |   |   |             |             |   |   | 2023                                  | 1010      | 706,700                       | 2022       | 1010  | 443,500          | 2021                | 1010 | 410,700                  |            |         |
|  |            |   |   |             |             |   |   |                                       | 1010      | 302,300                       |            | 1010  | 302,300          |                     | 1010 | 302,400                  |            |         |
|  |            | Total   |   |             |             |   |   | Total                                 |           | 1,009,000                     | Total      |       | 745,800          | Total               |      | 713,100                  |            |         |
| <b>EXEMPTIONS</b>  |            |   | <b>OTHER ASSESSMENTS</b>  |             |             |   | This signature acknowledges a visit by a Data Collector or Assessor |                                       |           |                               |            |       |                  |                     |      |                          |            |         |
| Year   | Code       | Description   | Amount  | Code        | Description | Number                                      | Amount  | Comm Int                              |           |                               |            |       |                  |                     |      |                          |            |         |
| Total  |            |   | 0.00  |             |             |   |   |                                       |           |                               |            |       |                  |                     |      |                          |            |         |
| <b>ASSESSING NEIGHBORHOOD</b>  |            |   |   |             |             |   |   |                                       |           |                               |            |       |                  |                     |      |                          |            |         |
| Nbhd   |            | Nbhd Name   |   | B           |             | Tracing                                     |   | Batch                                 |           |                               |            |       |                  |                     |      |                          |            |         |
| 0040   |            |   |   |             |             |   |   |                                       |           |                               |            |       |                  |                     |      |                          |            |         |
| <b>NOTES</b>   |            |   |   |             |             |   |   |                                       |           |                               |            |       |                  |                     |      |                          |            |         |
| LOT 433 LC 11405-G<br>FRD  |            |   |   |             |             |   |   |                                       |           |                               |            |       |                  |                     |      |                          |            |         |
| <b>BUILDING PERMIT RECORD</b>  |            |   |   |             |             |   |   |                                       |           | <b>VISIT / CHANGE HISTORY</b> |            |       |                  |                     |      |                          |            |         |
| Permit Id  | Issue Date | Type  | Description   | Amount      | Insp Date   | % Comp                                      | Date Comp   | Comments                              |           |                               | Date       | Id    | Type             | Is                  | Cd   | Purpost/Result           |            |         |
| 2005:205   | 02-22-2005 | RA  | Res Add/Alter   |             | 12-15-2005  | 0   |   | ? NO ONE HOME FINISH RO               |           |                               | 08-17-2022 | EH    |                  | 6                   | 01   | Cyclical Reinspection    |            |         |
|  |            |   |   |             |             |   |   |                                       |           |                               | 05-31-2022 | LS    |                  |                     | 11   | Field Review             |            |         |
|  |            |   |   |             |             |   |   |                                       |           |                               | 05-22-2017 | AU    |                  |                     | 11   | Field Review             |            |         |
|  |            |   |   |             |             |   |   |                                       |           |                               | 11-09-2011 | RK    |                  |                     | 11   | Field Review             |            |         |
|  |            |   |   |             |             |   |   |                                       |           |                               | 12-29-2006 | EP    |                  |                     | 12   | Bldg Permit/Measur/New C |            |         |
|  |            |   |   |             |             |   |   |                                       |           |                               | 06-23-2006 | EP    |                  |                     | 12   | Bldg Permit/Measur/New C |            |         |
|  |            |   |   |             |             |   |   |                                       |           |                               | 12-15-2005 | WP    |                  |                     | 50   | UC Status Inspection     |            |         |
| <b>LAND LINE VALUATION SECTION</b>   |            |   |   |             |             |   |   |                                       |           |                               |            |       |                  |                     |      |                          |            |         |
| B  | Use Code   | Description   | Zone  | Land Type   | Land Units  | Unit Price                                  | Size Adj  | Site Index                            | Cond.     | Nbhd.                         | Nbhd. Adj  | Notes |                  | Location Adjustment |      | Adj Unit P               | Land Value |         |
| 1  | 1010       | SINGL FAM M-0   | R60   |             | 21,780 SF   | 14.57                                       | 1.00000   | 4                                     | 1.00      | 0040                          | 1.050      |       |                  |                     |      | 15.3                     | 333,200    |         |
| Total Card Land Units  |            |   |   |             | 0.50        | AC  | Parcel Total Land Area  |                                       |           |                               |            | 0.50  | Total Land Value |                     |      |                          |            | 333,200 |

**VISION**

1302  
EDGARTOWN, MA

| CONSTRUCTION DETAIL |      |                | CONSTRUCTION DETAIL (CONTINUED) |    |             |
|---------------------|------|----------------|---------------------------------|----|-------------|
| Element             | Cd   | Description    | Element                         | Cd | Description |
| Style:              | 04   | Cape Cod       |                                 |    |             |
| Model:              | 01   | Residential    |                                 |    |             |
| Grade:              | 04   | Average +10    |                                 |    |             |
| Stories:            | 1.75 |                |                                 |    |             |
| Occupancy:          | 1    |                |                                 |    |             |
| Exterior Wall 1:    | 14   | Wood Shingle   |                                 |    |             |
| Exterior Wall 2:    |      |                |                                 |    |             |
| Roof Structure:     | 03   | Gable/Hip      |                                 |    |             |
| Roof Cover:         | 03   | Asph/F Gls/Cmp |                                 |    |             |
| Interior Wall 1:    | 05   | Drywall/Sheet  |                                 |    |             |
| Interior Wall 2:    |      |                |                                 |    |             |
| Interior Flr 1:     | 12   | Hardwood       |                                 |    |             |
| Interior Flr 2:     | 14   | Carpet         |                                 |    |             |
| Heat Fuel:          | 04   | Electric       |                                 |    |             |
| Heat Type:          | 05   | Hot Water      |                                 |    |             |
| AC Type:            | 01   | None           |                                 |    |             |
| Total Bedrooms:     | 03   | 3 Bedrooms     |                                 |    |             |
| Total Bthrms:       | 2    |                |                                 |    |             |
| Total Half Baths:   | 0    |                |                                 |    |             |
| Total Xtra Fixtrs:  |      |                |                                 |    |             |
| Total Rooms:        |      |                |                                 |    |             |
| Bath Style:         |      |                |                                 |    |             |
| Kitchen Style:      |      |                |                                 |    |             |

| CONDO DATA  |      |             |         |          |
|-------------|------|-------------|---------|----------|
| Parcel Id   |      | C           |         | Ownr 0.0 |
|             |      |             | B       | S        |
| Adjust Type | Code | Description | Factor% |          |
| Condo Flr   |      |             |         |          |
| Condo Unit  |      |             |         |          |

| COST / MARKET VALUATION  |         |
|--------------------------|---------|
| Building Value New       | 833,978 |
| Year Built               | 1986    |
| Effective Year Built     | 2007    |
| Depreciation Code        | G       |
| Remodel Rating           |         |
| Year Remodeled           |         |
| Depreciation %           | 15      |
| Functional Obsol         | 0       |
| External Obsol           | 0       |
| Trend Factor             | 1       |
| Condition                |         |
| Condition %              |         |
| Percent Good             | 85      |
| Cns Sect Rcnd            | 708,900 |
| Dep % Ovr                |         |
| Dep Ovr Comment          |         |
| Misc Imp Ovr             |         |
| Misc Imp Ovr Comment     |         |
| Cost to Cure Ovr         |         |
| Cost to Cure Ovr Comment |         |

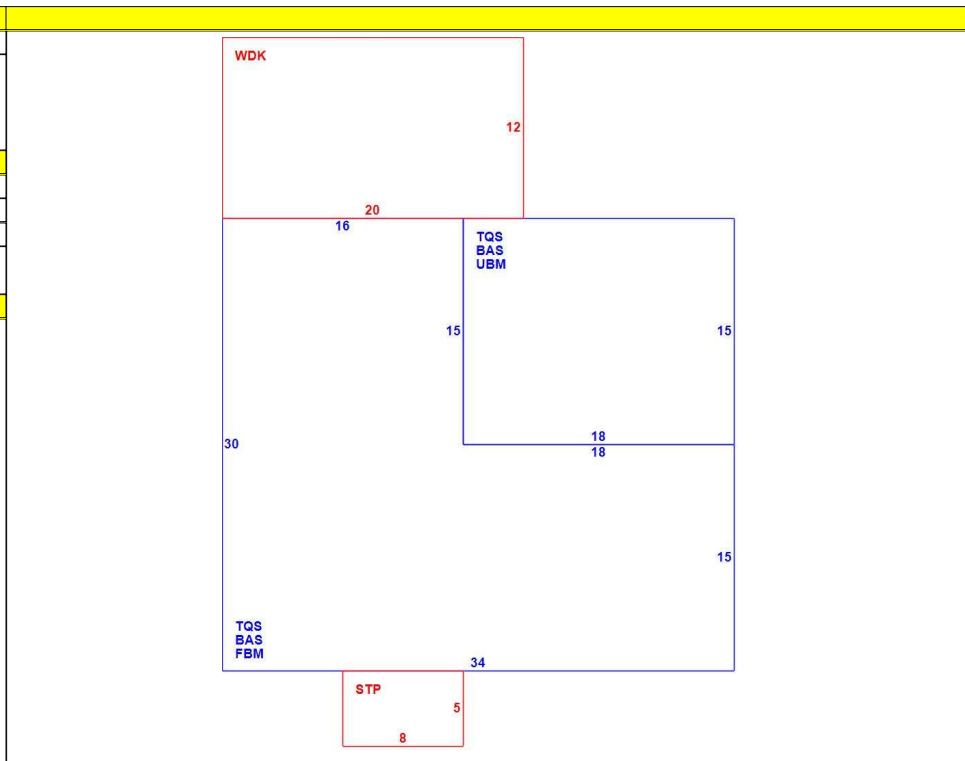

| OB - OUTBUILDING & YARD ITEMS(L) / XF - BUILDING EXTRA FEATURES(B) |             |     |       |            |        |          |      |       |            |             |
|--|-------------|-----|-------|------------|--------|----------|------|-------|------------|-------------|
| Code   | Description | L/B | Units | Unit Price | Yr Blt | Cond. Cd | % Gd | Grade | Grade Adj. | Appr. Value |
|  |             |     |       |            |        |          |      |       |            |             |

| BUILDING SUB-AREA SUMMARY SECTION |                      |             |            |          |           |                |  |
|-----------------------------------|----------------------|-------------|------------|----------|-----------|----------------|--|
| Code                              | Description          | Living Area | Floor Area | Eff Area | Unit Cost | Undeprec Value |  |
| BAS                               | First Floor          | 1,020       | 1,020      | 1,020    | 375.73    | 383,242        |  |
| FBM                               | Basement, Finished   | 0           | 750        | 338      | 169.33    | 126,996        |  |
| STP                               | Stoop                | 0           | 40         | 4        | 37.57     | 1,503          |  |
| TQS                               | Three Quarter Story  | 765         | 1,020      | 765      | 281.80    | 287,431        |  |
| UBM                               | Basement, Unfinished | 0           | 270        | 54       | 75.15     | 20,289         |  |
| WDK                               | Deck, Wood           | 0           | 240        | 24       | 37.57     | 9,017          |  |
| Ttl Gross Liv / Lease Area        |                      | 1,785       | 3,340      | 2,205    |           | 828,478        |  |

