

| CURRENT OWNER | | TOPO | UTILITIES | STRT / ROAD | LOCATION | CURRENT ASSESSMENT | | | | 1302 EDGARTOWN, MA VISION | | | | | | |
|---|------------|---|--------------|-------------------|-------------|----------------------|------------------------|---|--------------------------------|--|-----------|-------------------------------|---------------------|-----------------------|------------|-----------|
| HARGY MOLLY J --TRS 15 THE BOULEVARD EDGARTOWN MA 02539 | | | | | | Description | Code | Appraised | Assessed | | | | | | | |
| | | | | | | RESIDENTL RES LND | 1010 1010 | 565,800 1,983,200 | 565,800 1,983,200 | | | | | | | |
| SUPPLEMENTAL DATA | | | | | | Total | | 2,549,000 | 2,549,000 | | | | | | | |
| Alt Prcl ID PLN#/Rec Lot# Plan Notes Plan Notes Plan Notes GIS ID M_279813_795235 | | Restriction Hist Distrct Other Note UC-Misc 1 UC-Misc 2 Assoc Pid# | | | | | | | | | | | | | | |
| RECORD OF OWNERSHIP | | | BK-VOL/PAGE | SALE DATE | Q/U | V/I | SALE PRICE | VC | PREVIOUS ASSESSMENTS (HISTORY) | | | | | | | |
| HARGY MOLLY J --TRS | | | 1361 0262 | 11-06-2014 | U | I | 1 | 1A | Year | Code | Assessed | Year | Code | Assessed | | |
| HATHAWAY PETER J TRS | | | 1325 1061 | 08-08-2013 | U | I | 1 | 1A | 2023 | 1010 | 578,900 | 2022 | 1010 | 431,500 | | |
| HATHAWAY PETER J | | | 00D8 4697 | 10-01-1973 | | | 0 | | | 1010 | 1,714,100 | | 1010 | 1,609,170 | | |
| | | | Total | | | | | | Total | | 2,293,000 | Total | | 2,040,670 | | |
| | | | | | | | | | Total | | 1,830,555 | | | | | |
| EXEMPTIONS | | | | OTHER ASSESSMENTS | | | | This signature acknowledges a visit by a Data Collector or Assessor | | | | | | | | |
| Year | Code | Description | Amount | Code | Description | Number | Amount | Comm Int | | | | | | | | |
| | | | Total | 0.00 | | | | | | | | | | | | |
| ASSESSING NEIGHBORHOOD | | | | | | | | APPRAISED VALUE SUMMARY | | | | | | | | |
| Nbhd | Nbhd Name | B | Tracing | Batch | | | | | | | | | | | | |
| 0060 | | | | | | | | | | | | | | | | |
| NOTES | | | | | | | | | | | | Appraised Bldg. Value (Card) | | 563,300 | | |
| WOODSTOVE | | | | | | | | | | | | Appraised Xf (B) Value (Bldg) | | 1,800 | | |
| | | | | | | | | | | | | Appraised Ob (B) Value (Bldg) | | 700 | | |
| | | | | | | | | | | | | Appraised Land Value (Bldg) | | 1,983,200 | | |
| | | | | | | | | | | | | Special Land Value | | 0 | | |
| | | | | | | | | | | | | Total Appraised Parcel Value | | 2,549,000 | | |
| | | | | | | | | | | | | Valuation Method | | C | | |
| | | | | | | | | | | | | Total Appraised Parcel Value | | 2,549,000 | | |
| BUILDING PERMIT RECORD | | | | | | | | VISIT / CHANGE HISTORY | | | | | | | | |
| Permit Id | Issue Date | Type | Description | Amount | Insp Date | % Comp | Date Comp | Comments | Date | Id | Type | Is | Cd | Purpost/Result | | |
| 2018-190 | 10-24-2017 | SOLR | Solar Panels | 12,122 | | 0 | | SOLAR PANELS | 05-19-2022 | DM | | | 11 | Field Review | | |
| | | | | | | | | | 09-26-2018 | EP | | | 01 | Cyclical Reinspection | | |
| | | | | | | | | | 05-25-2017 | AU | | | 11 | Field Review | | |
| | | | | | | | | | 09-27-2013 | EP | | | 01 | Cyclical Reinspection | | |
| | | | | | | | | | 11-30-2011 | RK | | | 11 | Field Review | | |
| | | | | | | | | | 04-29-2004 | CR | | | 01 | Cyclical Reinspection | | |
| | | | | | | | | | 01-01-1998 | RL | | | 00 | Measur+Listed | | |
| LAND LINE VALUATION SECTION | | | | | | | | | | | | | | | | |
| B | Use Code | Description | Zone | Land Type | Land Units | Unit Price | Size Adj | Site Index | Cond. | Nbhd. | Nbhd. Adj | Notes | Location Adjustment | Adj Unit P | Land Value | |
| 1 | 1010 | SINGL FAM M-0 | R20 | | 9,300 SF | 31.59 | 1.00000 | 6 | 1.00 | 0053 | 2.700 | | W25 | 213.25 | 1,983,200 | |
| 1 | 1010 | SINGL FAM M-0 | R20 | | 40 FF | 0.01 | 1.00000 | 0 | 1.00 | | 1.000 | | | 0.01 | 0 | |
| Total Card Land Units | | | | | 0.21 | AC | Parcel Total Land Area | | | | | 0.21 | Total Land Value | | | 1,983,200 |

| CONSTRUCTION DETAIL | | | CONSTRUCTION DETAIL (CONTINUED) | | |
|--------------------------------|------|----------------|---------------------------------|-----|-------------|
| Element | Cd | Description | Element | Cd | Description |
| Style: | 03 | Colonial | | | |
| Model | 01 | Residential | | | |
| Grade: | 04 | Average +10 | | | |
| Stories: | 2 | 2 Stories | | | |
| Occupancy | 1 | | | | |
| Exterior Wall 1 | 14 | Wood Shingle | | | |
| Exterior Wall 2 | | | | | |
| Roof Structure: | 03 | Gable/Hip | | | |
| Roof Cover | 03 | Asph/F Gls/Cmp | | | |
| Interior Wall 1 | 05 | Drywall/Sheet | | | |
| Interior Wall 2 | | | | | |
| Interior Flr 1 | 12 | Hardwood | | | |
| Interior Flr 2 | 11 | Ceram Clay Til | | | |
| Heat Fuel | 03 | Gas | | | |
| Heat Type: | 05 | Hot Water | | | |
| AC Type: | 01 | None | | | |
| Total Bedrooms | 02 | 2 Bedrooms | | | |
| Total Bthrms: | 2 | | | | |
| Total Half Baths | 0 | | | | |
| Total Xtra Fixtrs | | | | | |
| Total Rooms: | 4 | 4 Rooms | | | |
| Bath Style: | 02 | Average | | | |
| Kitchen Style: | 02 | Modern | | | |
| CONDO DATA | | | | | |
| Parcel Id | | C | Owne | 0.0 | |
| | | | B | S | |
| Adjust Type | Code | Description | Factor% | | |
| Condo Flr | | | | | |
| Condo Unit | | | | | |
| COST / MARKET VALUATION | | | | | |
| Building Value New | | | 625,915 | | |
| Year Built | | | 1997 | | |
| Effective Year Built | | | 2012 | | |
| Depreciation Code | | | A | | |
| Remodel Rating | | | | | |
| Year Remodeled | | | | | |
| Depreciation % | | | 10 | | |
| Functional Obsol | | | 0 | | |
| External Obsol | | | 0 | | |
| Trend Factor | | | 1 | | |
| Condition | | | | | |
| Condition % | | | | | |
| Percent Good | | | 90 | | |
| Cns Sect Rcnd | | | 563,300 | | |
| Dep % Ovr | | | | | |
| Dep Ovr Comment | | | | | |
| Misc Imp Ovr | | | | | |
| Misc Imp Ovr Comment | | | | | |
| Cost to Cure Ovr | | | | | |
| Cost to Cure Ovr Comment | | | | | |

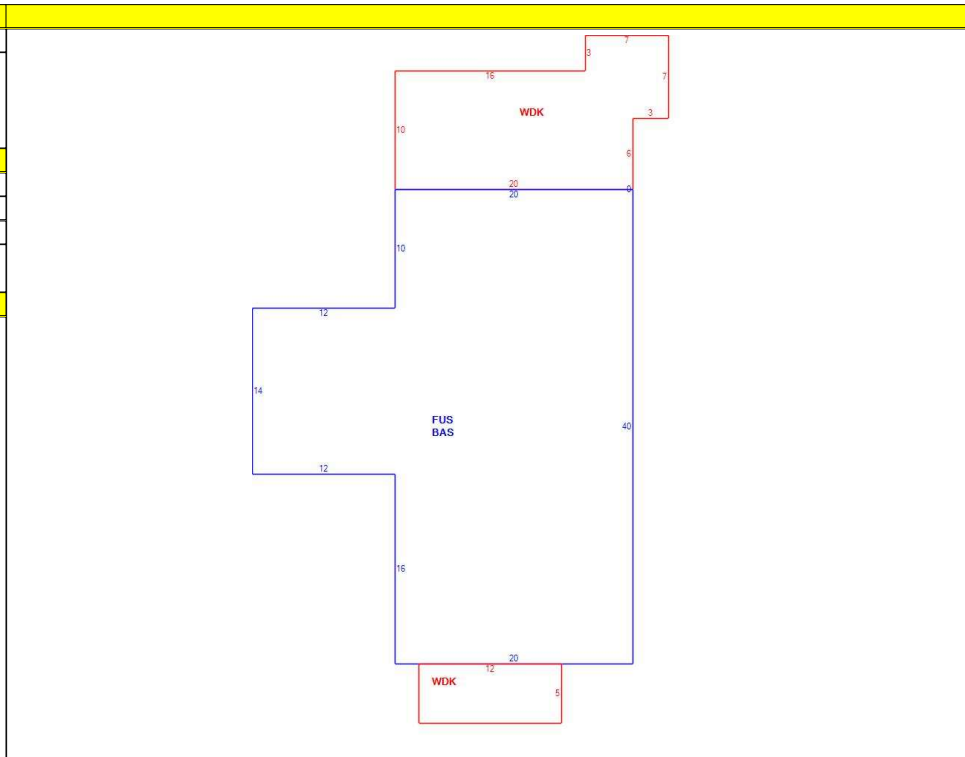

| OB - OUTBUILDING & YARD ITEMS(L) / XF - BUILDING EXTRA FEATURES(B) | | | | | | | | | | |
|--|-------------|-----|-------|------------|--------|----------|------|-------|------------|-------------|
| Code | Description | L/B | Units | Unit Price | Yr Blt | Cond. Cd | % Gd | Grade | Grade Adj. | Appr. Value |
| FPL | MTL-WD C/PI | B | 1 | 2000.00 | 2006 | | 90 | | 0.00 | 1,800 |
| ODS | OUTDOOR S | L | 1 | 700.00 | | | 100 | | 0.00 | 700 |

| BUILDING SUB-AREA SUMMARY SECTION | | | | | | | |
|-----------------------------------|-----------------------|-------------|------------|----------|-----------|----------------|--|
| Code | Description | Living Area | Floor Area | Eff Area | Unit Cost | Undeprec Value | |
| BAS | First Floor | 968 | 968 | 968 | 315.73 | 305,630 | |
| FUS | Upper Story, Finished | 968 | 968 | 968 | 315.73 | 305,630 | |
| WDK | Deck, Wood | 0 | 293 | 29 | 31.25 | 9,156 | |
| Ttl Gross Liv / Lease Area | | 1,936 | 2,229 | 1,965 | | 620,416 | |

