

| CURRENT OWNER                           |            | TOPO          | UTILITIES         | STRT / ROAD  | LOCATION    | CURRENT ASSESSMENT      |            |                        |   | 1302<br>EDGARTOWN, MA<br><b>VISION</b> |           |  |                     |                       |            |         |  |
|---|------------|---------------|-------------------|--------------|-------------|-------------------------|------------|------------------------|---|--|-----------|--|---------------------|-----------------------|------------|---------|--|
| RUSSILLO KAREN A                        |            |               | 2 Public Water    |              |             | Description             | Code       | Appraised              | Assessed  |  |           |  |                     |                       |            |         |  |
| BOX 4286                                |            |               |                   |              |             | RESIDENTL               | 1010       | 877,400                | 877,400   |  |           |  |                     |                       |            |         |  |
| VINEYARD HAVEN MA 02568                 |            |               |                   |              |             | RES LND                 | 1010       | 337,800                | 337,800   |  |           |  |                     |                       |            |         |  |
| SUPPLEMENTAL DATA                       |            |               |                   |              |             |                         |            |                        |   |  |           |  |                     |                       |            |         |  |
| Alt Prcl ID                             |            | Restriction   |                   | Hist Distrct |             | Other Note              |            |                        |   |  |           |  |                     |                       |            |         |  |
| PLN#/Rec CF 707 LAWRY                   |            |               |                   |              |             |                         |            |                        |   |  |           |  |                     |                       |            |         |  |
| Lot# 3A                                 |            |               |                   |              |             |                         |            |                        |   |  |           |  |                     |                       |            |         |  |
| Plan Notes                              |            | UC-Misc 1     |                   | UC-Misc 2    |             |                         |            |                        |   |  |           |  |                     |                       |            |         |  |
| Plan Notes                              |            |               |                   |              |             |                         |            |                        |   |  |           |  |                     |                       |            |         |  |
| Plan Notes                              |            |               |                   |              |             |                         |            |                        |   |  |           |  |                     |                       |            |         |  |
| GIS ID M_279714_794914                  |            | Assoc Pid#    |                   |              |             |                         |            |                        |   |  |           |  |                     |                       |            |         |  |
|   |            |               |                   |              |             | Total                   |            | 1,215,200              | 1,215,200   |  |           |  |                     |                       |            |         |  |
| RECORD OF OWNERSHIP                     |            |               | BK-VOL/PAGE       | SALE DATE    | Q/U         | V/I                     | SALE PRICE | VC                     | PREVIOUS ASSESSMENTS (HISTORY)                                      |  |           |  |                     |                       |            |         |  |
| RUSSILLO KAREN A                        |            |               | 1114 0133         | 03-15-2007   | U           | I                       | 444,000    | 1L                     | Year  | Code                                   | Assessed  | Year                                   | Code                | Assessed              |            |         |  |
| FREMONT INVESTMENT & LOAN               |            |               | 1112 0197         | 02-27-2007   | U           | I                       | 509,000    | 1L                     | 2023  | 1010                                   | 703,900   | 2022                                   | 1010                | 416,100               |            |         |  |
| DENNIS HENRY L & LAWRY ELIZABETH F      |            |               | 0775 0433         | 09-02-1999   | Q           | I                       | 289,000    | 00                     |   | 1010                                   | 306,700   |  | 1010                | 305,600               |            |         |  |
|   |            |               | 0318 0508         | 07-16-1974   |             |                         | 0          |                        |   |  |           |  | 1010                | 306,000               |            |         |  |
|   |            |               |                   |              |             | Total                   |            | 1,010,600              | Total   |  | 721,700   | Total                                  |                     | 762,900               |            |         |  |
| EXEMPTIONS                              |            |               | OTHER ASSESSMENTS |              |             |                         |            |                        | This signature acknowledges a visit by a Data Collector or Assessor |  |           |  |                     |                       |            |         |  |
| Year                                    | Code       | Description   | Amount            | Code         | Description | Number                  | Amount     | Comm Int               |   |  |           |  |                     |                       |            |         |  |
|   |            |               |                   |              |             |                         |            |                        |   |  |           |  |                     |                       |            |         |  |
| Total                                   |            |               | 0.00              |              |             |                         |            |                        |   |  |           |  |                     |                       |            |         |  |
| ASSESSING NEIGHBORHOOD                  |            |               |                   |              |             | APPRAISED VALUE SUMMARY |            |                        |   |  |           |  |                     |                       |            |         |  |
| Nbhd                                    | Nbhd Name  | B             | Tracing           | Batch        |             |                         |            |                        |   |  |           |  |                     |                       |            |         |  |
| 0040                                    |            |               |                   |              |             |                         |            |                        |   |  |           |  |                     |                       |            |         |  |
| NOTES                                   |            |               |                   |              |             | VISIT / CHANGE HISTORY  |            |                        |   |  |           |  |                     |                       |            |         |  |
| SD 12B-125 1999                         |            |               |                   |              |             |                         |            |                        |   |  |           |  |                     |                       |            |         |  |
| LOT 3A LAWRY CF707                      |            |               |                   |              |             |                         |            |                        |   |  |           |  |                     |                       |            |         |  |
| '07 NEW SHINGLES, PAINT, CARPET         |            |               |                   |              |             |                         |            |                        |   |  |           |  |                     |                       |            |         |  |
| METAL FRAME & FIBERGLASS ENCLOSURE OVER |            |               |                   |              |             |                         |            |                        |   |  |           |  |                     |                       |            |         |  |
| INGRD POOL                              |            |               |                   |              |             |                         |            |                        |   |  |           |  |                     |                       |            |         |  |
|   |            |               |                   |              |             |                         |            |                        |   |  |           | Total Appraised Parcel Value 1,215,200 |                     |                       |            |         |  |
| Permit Id                               | Issue Date | Type          | Description       | Amount       | Insp Date   | % Comp                  | Date Comp  | Comments               | Date  | Id                                     | Type      | Is                                     | Cd                  | Purpost/Result        |            |         |  |
| 2021-528                                | 02-04-2021 | RA            | Res Add/Alter     | 26,000       |             |                         |            | REPLACE EXT DOOR/WIND  | 05-31-2022  | EH                                     |           |  | 01                  | Cyclical Reinspection |            |         |  |
| 2018-536                                | 05-01-2018 | RA            | Res Add/Alter     | 50,000       |             | 0                       |            | DECK WINDOW ROOF       | 05-23-2022  | DM                                     |           |  | 11                  | Field Review          |            |         |  |
| 2018-69                                 | 08-24-2017 | RA            | Res Add/Alter     | 6,000        |             | 0                       |            | MOVE 2 BLDGS TO FORM 1 | 03-28-2019  | EP                                     |           |  | 01                  | Cyclical Reinspection |            |         |  |
|   |            |               |                   |              |             |                         |            |                        | 05-27-2017  | AU                                     |           |  | 11                  | Field Review          |            |         |  |
|   |            |               |                   |              |             |                         |            |                        | 12-02-2011  | DM                                     |           |  | 11                  | Field Review          |            |         |  |
|   |            |               |                   |              |             |                         |            |                        | 11-30-2011  | EP                                     |           |  | 01                  | Cyclical Reinspection |            |         |  |
|   |            |               |                   |              |             |                         |            |                        | 11-30-2011  | RK                                     |           |  | 11                  | Field Review          |            |         |  |
| LAND LINE VALUATION SECTION             |            |               |                   |              |             |                         |            |                        |   |  |           |  |                     |                       |            |         |  |
| B                                       | Use Code   | Description   | Zone              | Land Type    | Land Units  | Unit Price              | Size Adj   | Site Index             | Cond.   | Nbhd.                                  | Nbhd. Adj | Notes                                  | Location Adjustment | Adj Unit P            | Land Value |         |  |
| 1                                       | 1010       | SINGL FAM M-0 | R20               |              | 21,780 SF   | 14.57                   | 1.00000    | 4                      | 1.00  | 0040                                   | 1.050     |  |                     | 15.3                  | 333,200    |         |  |
| 1                                       | 1010       | SINGL FAM M-0 | R20               |              | 0.130 AC    | 34,000.00               | 1.00000    | 0                      | 1.00  | 0040                                   | 1.050     |  |                     | 35,700                | 4,600      |         |  |
| Total Card Land Units                   |            |               |                   |              | 0.63 AC     | Parcel Total Land Area  |            |                        |   |  | 0.63      | Total Land Value                       |                     |                       |            | 337,800 |  |

| CONSTRUCTION DETAIL |    |                | CONSTRUCTION DETAIL (CONTINUED) |      |             |
|---------------------|----|----------------|---------------------------------|------|-------------|
| Element             | Cd | Description    | Element                         | Cd   | Description |
| Style:              | 01 | Ranch          |                                 |      |             |
| Model               | 01 | Residential    |                                 |      |             |
| Grade:              | 04 | Above Ave      |                                 |      |             |
| Stories:            | 1  | 1 Story        |                                 |      |             |
| Occupancy           | 1  |                |                                 |      |             |
| Exterior Wall 1     | 14 | Wood Shingle   |                                 |      |             |
| Exterior Wall 2     |    |                |                                 |      |             |
| Roof Structure:     | 03 | Gable/Hip      |                                 |      |             |
| Roof Cover          | 03 | Asph/F Gls/Cmp |                                 |      |             |
| Interior Wall 1     | 05 | Drywall/Sheet  |                                 |      |             |
| Interior Wall 2     |    |                |                                 |      |             |
| Interior Flr 1      | 12 | Hardwood       |                                 |      |             |
| Interior Flr 2      | 14 | Carpet         |                                 |      |             |
| Heat Fuel           | 02 | Oil            |                                 |      |             |
| Heat Type:          | 05 | Hot Water      |                                 |      |             |
| AC Type:            | 01 | None           |                                 |      |             |
| Total Bedrooms      | 03 | 3 Bedrooms     |                                 |      |             |
| Total Bthrms:       | 2  |                |                                 |      |             |
| Total Half Baths    | 0  |                |                                 |      |             |
| Total Xtra Fixtrs   |    |                |                                 |      |             |
| Total Rooms:        | 5  |                |                                 |      |             |
| Bath Style:         | 02 | Average        |                                 |      |             |
| Kitchen Style:      | 02 | Modern         |                                 |      |             |
|                     |    |                | <b>CONDO DATA</b>               |      |             |
|                     |    |                | Parcel Id                       | C    | Ownr 0.0    |
|                     |    |                |                                 | B    | S           |
|                     |    |                | Adjust Type                     | Code | Description |
|                     |    |                | Condo Flr                       |      |             |
|                     |    |                | Condo Unit                      |      |             |
|                     |    |                | <b>COST / MARKET VALUATION</b>  |      |             |
|                     |    |                | Building Value New              |      | 1,103,879   |
|                     |    |                | Year Built                      |      | 1973        |
|                     |    |                | Effective Year Built            |      | 1997        |
|                     |    |                | Depreciation Code               |      | A           |
|                     |    |                | Remodel Rating                  |      |             |
|                     |    |                | Year Remodeled                  |      |             |
|                     |    |                | Depreciation %                  |      | 25          |
|                     |    |                | Functional Obsol                |      | 0           |
|                     |    |                | External Obsol                  |      | 0           |
|                     |    |                | Trend Factor                    |      | 1           |
|                     |    |                | Condition                       |      |             |
|                     |    |                | Condition %                     |      |             |
|                     |    |                | Percent Good                    |      | 75          |
|                     |    |                | Cns Sect Rcnd                   |      | 827,900     |
|                     |    |                | Dep % Ovr                       |      |             |
|                     |    |                | Dep Ovr Comment                 |      |             |
|                     |    |                | Misc Imp Ovr                    |      |             |
|                     |    |                | Misc Imp Ovr Comment            |      |             |
|                     |    |                | Cost to Cure Ovr                |      |             |
|                     |    |                | Cost to Cure Ovr Comment        |      |             |

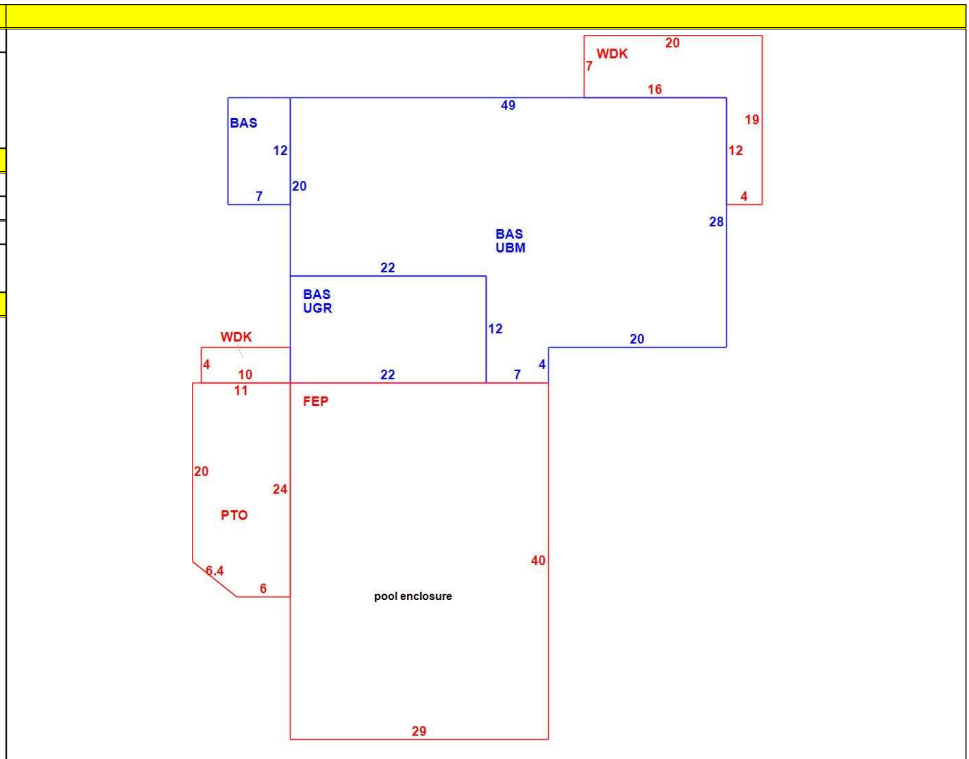

| OB - OUTBUILDING & YARD ITEMS(L) / XF - BUILDING EXTRA FEATURES(B) |             |     |       |            |        |          |      |       |            |             |
|--|-------------|-----|-------|------------|--------|----------|------|-------|------------|-------------|
| Code   | Description | L/B | Units | Unit Price | Yr Blt | Cond. Cd | % Gd | Grade | Grade Adj. | Appr. Value |
| FPL  | MTL-WD C/PI | B   | 1     | 2000.00    | 1991   |          | 75   |       | 0.00       | 1,500       |
| SPL1   | POOL-INGR C | L   | 800   | 80.00      | 1980   |          | 75   |       | 0.00       | 48,000      |

| BUILDING SUB-AREA SUMMARY SECTION |                           |             |            |          |           |                |
|-----------------------------------|---------------------------|-------------|------------|----------|-----------|----------------|
| Code                              | Description               | Living Area | Floor Area | Eff Area | Unit Cost | Undeprec Value |
| BAS                               | First Floor               | 1,572       | 1,572      | 1,572    | 398.54    | 626,506        |
| FEP                               | Porch, Enclosed, Finished | 0           | 1,160      | 812      | 278.98    | 323,615        |
| PTO                               | Patio                     | 0           | 254        | 25       | 39.23     | 9,964          |
| UBM                               | Basement, Unfinished      | 0           | 1,224      | 245      | 79.77     | 97,643         |
| UGR                               | Garage, Unfinished        | 0           | 264        | 79       | 119.26    | 31,485         |
| WDK                               | Deck, Wood                | 0           | 228        | 23       | 40.20     | 9,166          |
| Ttl Gross Liv / Lease Area        |                           | 1,572       | 4,702      | 2,756    |           | 1,098,379      |

