

| CURRENT OWNER   |            | TOPO                         | UTILITIES                     | STRT / ROAD  | LOCATION    | CURRENT ASSESSMENT |                        |   |            | 1302<br>EDGARTOWN, MA |                  |                  |                     |                       |            |
|---|------------|------------------------------|-------------------------------|--------------|-------------|--------------------|------------------------|---|------------|-----------------------|------------------|------------------|---------------------|-----------------------|------------|
| PLAINE DANIEL J &<br>GRANDISON W GEORGE TRS<br>C/O DANIEL PLAINE<br>8710 BELLWOOD RD<br>BETHESDA MD 20817 |            |                              |                               |              |             | Description        | Code                   | Appraised   | Assessed   |                       |                  |                  |                     |                       |            |
|   |            |                              |                               |              |             | RESIDENTL          | 1090                   | 4,997,200   | 4,997,200  | <b>VISION</b>         |                  |                  |                     |                       |            |
|   |            |                              |                               |              |             | RES LND            | 1090                   | 3,239,400   | 3,239,400  |                       |                  |                  |                     |                       |            |
| SUPPLEMENTAL DATA   |            |                              |                               |              |             |                    |                        |   |            |                       |                  |                  |                     |                       |            |
| Alt Prcl ID   |            | PLN#/Rec B174 P568 5/31/1973 |                               | Restriction  |             |                    |                        |   |            |                       |                  |                  |                     |                       |            |
| Lot#  |            | 2, 3, 4                      |                               | Hist Distrct |             |                    |                        |   |            |                       |                  |                  |                     |                       |            |
| Plan Notes  |            |                              |                               | Other Note   |             |                    |                        |   |            |                       |                  |                  |                     |                       |            |
| Plan Notes  |            |                              |                               | UC-Misc 1    |             |                    |                        |   |            |                       |                  |                  |                     |                       |            |
| Plan Notes  |            |                              |                               | UC-Misc 2    |             |                    |                        |   |            |                       |                  |                  |                     |                       |            |
| GIS ID  |            | M_285485_793768              |                               | Assoc Pid#   |             |                    |                        |   |            |                       |                  |                  |                     |                       |            |
|   |            |                              |                               |              |             | Total              |                        | 8,236,600   | 8,236,600  |                       |                  |                  |                     |                       |            |
| RECORD OF OWNERSHIP   |            | BK-VOL/PAGE                  | SALE DATE                     | Q/U          | V/I         | SALE PRICE         | VC                     | PREVIOUS ASSESSMENTS (HISTORY)                                      |            |                       |                  |                  |                     |                       |            |
| PLAINE DANIEL J &<br>PLAINE SUSAN A   |            | 1297 0516                    | 11-13-2012                    | U            | I           |                    | 1A                     | Year  | Code       | Assessed              | Year             | Code             | Assessed            |                       |            |
| PLAINE DANIEL J & SUSAN A   |            | 1297 0513                    | 11-13-2012                    | U            | I           |                    | 1A                     | 2023  | 1090       | 4,671,300             | 2022             | 1090             | 3,047,800           |                       |            |
| KNOLL DAVID H &<br>DINSMORE WILEY TRS   |            | 1267 0988                    | 01-19-2012                    | U            | I           | 2,000,000          | 1                      |   | 1090       | 3,077,400             |                  | 1090             | 2,679,786           |                       |            |
|   |            | 1063 0384                    | 11-17-2005                    | U            | I           |                    | 1A                     |   |            |                       | 2021             | 1090             | 3,377,000           |                       |            |
|   |            | 0548 0237                    | 11-06-1990                    | U            | I           |                    | 1A                     |   |            |                       |                  | 1090             | 2,049,248           |                       |            |
|   |            |                              |                               |              |             | Total              |                        | 7,748,700   | Total      | 5,727,586             | Total            |                  | 5,426,248           |                       |            |
| EXEMPTIONS  |            |                              | OTHER ASSESSMENTS             |              |             |                    |                        | This signature acknowledges a visit by a Data Collector or Assessor |            |                       |                  |                  |                     |                       |            |
| Year  | Code       | Description                  | Amount                        | Code         | Description | Number             | Amount                 | Comm Int  |            |                       |                  |                  |                     |                       |            |
|   |            |                              |                               |              |             |                    |                        |   |            |                       |                  |                  |                     |                       |            |
|   |            |                              |                               |              |             |                    |                        |   |            |                       |                  |                  |                     |                       |            |
|   |            |                              |                               |              |             |                    |                        |   |            |                       |                  |                  |                     |                       |            |
|   |            |                              | 0.00                          |              |             |                    |                        |   |            |                       |                  |                  |                     |                       |            |
| ASSESSING NEIGHBORHOOD  |            |                              |                               |              |             |                    |                        |   |            |                       |                  |                  |                     |                       |            |
| Nbhd  | Nbhd Name  | B                            | Tracing                       | Batch        |             |                    |                        |   |            |                       |                  |                  |                     |                       |            |
| CPY5  |            |                              |                               |              |             |                    |                        |   |            |                       |                  |                  |                     |                       |            |
| NOTES   |            |                              |                               |              |             |                    |                        |   |            |                       |                  |                  |                     |                       |            |
| TITLE TO L4 OF B568 P174 IN 9/1982  |            |                              |                               |              |             |                    |                        |   |            |                       |                  |                  |                     |                       |            |
| TITLE TO L3 OF B568 P174 IN 1973  |            |                              | MAJOR RENOV 2012-2013         |              |             |                    |                        |   |            |                       |                  |                  |                     |                       |            |
| CORR SKETCH 7/12: ADD UBM AREAS   |            |                              | ALSO START 2ND SFR NEAR WATER |              |             |                    |                        |   |            |                       |                  |                  |                     |                       |            |
| PLUMBING IN UBM (TOILET & LAUNDRY SINK)   |            |                              |                               |              |             |                    |                        |   |            |                       |                  |                  |                     |                       |            |
| HOUSE SOME DISTANCE FROM WATERFRONT<br>(ACROSS ROAD)  |            |                              |                               |              |             |                    |                        |   |            |                       |                  |                  |                     |                       |            |
| BUILDING PERMIT RECORD  |            |                              |                               |              |             |                    | VISIT / CHANGE HISTORY |   |            |                       |                  |                  |                     |                       |            |
| Permit Id   | Issue Date | Type                         | Description                   | Amount       | Insp Date   | % Comp             | Date Comp              | Comments  | Date       | Id                    | Type             | Is               | Cd                  | Purpost/Result        |            |
| 2024-125  | 08-17-2023 | RN                           | Res New Cons                  |              |             | 0                  |                        | BUILD 8X18 POOL   | 05-26-2022 | LS                    |                  |                  | 11                  | Field Review          |            |
| 55-2013   | 12-27-2013 | CO                           | CO ISSUED                     |              |             |                    |                        | SFR   | 05-18-2017 | DM                    |                  |                  | 11                  | Field Review          |            |
| 2013-57   | 09-18-2012 | RN                           | Res New Cons                  |              |             |                    |                        | DETACHED BR 400 SF  | 10-06-2015 | EP                    |                  |                  | 01                  | Cyclical Reinspection |            |
| 2013-56   | 09-18-2012 | RA                           | Res Add/Alter                 |              |             |                    |                        | CONVERT SFR TO GH 900 S   | 01-16-2015 | EP                    |                  |                  | 50                  | UC Status Inspection  |            |
| 2013-55   | 09-18-2012 | RN                           | Res New Cons                  |              |             |                    |                        | SFR 4539 SF   | 08-21-2014 | EP                    |                  |                  | 01                  | Cyclical Reinspection |            |
|   |            |                              |                               |              |             |                    |                        |   | 02-22-2013 | EP                    |                  |                  | 00                  | Measur+Listed         |            |
|   |            |                              |                               |              |             |                    |                        |   | 07-31-2012 | EP                    |                  |                  | 11                  | Field Review          |            |
| LAND LINE VALUATION SECTION   |            |                              |                               |              |             |                    |                        |   |            |                       |                  |                  |                     |                       |            |
| B   | Use Code   | Description                  | Zone                          | Land Type    | Land Units  | Unit Price         | Size Adj               | Site Index  | Cond.      | Nbhd.                 | Nbhd. Adj        | Notes            | Location Adjustment | Adj Unit P            | Land Value |
| 1   | 1090       | MULTI HSES                   | R12                           |              | 130,680 SF  | 2.04               | 1.00000                | 6   | 0.85       | CPY5                  | 2.000            | WF - TOPO/ACCESS | W60                 | 20.81                 | 2,719,200  |
| 1   | 1090       | MULTI HSES                   | R12                           |              | 1.700 AC    | 30,000.00          | 1.00000                | 0   | 0.85       | CPY5                  | 2.000            | TOPO             | W60                 | 306,000               | 520,200    |
| 1   | 1090       | MULTI HSES                   | R12                           |              | 180.000 FF  | 0.00               | 1.00000                | 0   | 1.00       |                       | 1.000            |                  |                     | 0                     | 0          |
| Total Card Land Units   |            |                              |                               |              | 4.70        | AC                 | Parcel Total Land Area |   |            | 4.70                  | Total Land Value |                  |                     | 3,239,400             |            |

| CONSTRUCTION DETAIL            |      |                | CONSTRUCTION DETAIL (CONTINUED) |     |             |
|--------------------------------|------|----------------|---------------------------------|-----|-------------|
| Element                        | Cd   | Description    | Element                         | Cd  | Description |
| Style:                         | 01   | Ranch          |                                 |     |             |
| Model                          | 01   | Residential    |                                 |     |             |
| Grade:                         | 05   | Average +20    |                                 |     |             |
| Stories:                       | 1    | 1 Story        |                                 |     |             |
| Occupancy                      | 1    |                |                                 |     |             |
| Exterior Wall 1                | 14   | Wood Shingle   |                                 |     |             |
| Exterior Wall 2                |      |                |                                 |     |             |
| Roof Structure:                | 03   | Gable/Hip      |                                 |     |             |
| Roof Cover                     | 03   | Asph/F Gls/Cmp |                                 |     |             |
| Interior Wall 1                | 05   | Drywall/Sheet  |                                 |     |             |
| Interior Wall 2                | 06   | Cust Wd Panel  |                                 |     |             |
| Interior Flr 1                 | 12   | Hardwood       |                                 |     |             |
| Interior Flr 2                 | 05   | Vinyl/Asph/Lam |                                 |     |             |
| Heat Fuel                      | 02   | Oil            |                                 |     |             |
| Heat Type:                     | 04   | Forced Air-Duc |                                 |     |             |
| AC Type:                       | 02   | Heat Pump      |                                 |     |             |
| Total Bedrooms                 | 03   | 3 Bedrooms     |                                 |     |             |
| Total Bthrms:                  | 2    |                |                                 |     |             |
| Total Half Baths               | 0    |                |                                 |     |             |
| Total Xtra Fixtrs              |      |                |                                 |     |             |
| Total Rooms:                   | 5    |                |                                 |     |             |
| Bath Style:                    | 02   | Average        |                                 |     |             |
| Kitchen Style:                 | 02   | Modern         |                                 |     |             |
| <b>CONDO DATA</b>              |      |                |                                 |     |             |
| Parcel Id                      |      | C              | Owne                            | 0.0 |             |
| Adjust Type                    | Code | Description    | Factor%                         |     |             |
| Condo Flr                      |      |                |                                 |     |             |
| Condo Unit                     |      |                |                                 |     |             |
| <b>COST / MARKET VALUATION</b> |      |                |                                 |     |             |
| Building Value New             |      | 945,215        |                                 |     |             |
| Year Built                     |      | 1972           |                                 |     |             |
| Effective Year Built           |      | 2017           |                                 |     |             |
| Depreciation Code              |      | R              |                                 |     |             |
| Remodel Rating                 |      |                |                                 |     |             |
| Year Remodeled                 |      | 2012           |                                 |     |             |
| Depreciation %                 |      | 5              |                                 |     |             |
| Functional Obsol               |      | 0              |                                 |     |             |
| External Obsol                 |      | 0              |                                 |     |             |
| Trend Factor                   |      | 1              |                                 |     |             |
| Condition                      |      |                |                                 |     |             |
| Condition %                    |      |                |                                 |     |             |
| Percent Good                   |      | 95             |                                 |     |             |
| Cns Sect Rcnd                  |      | 898,000        |                                 |     |             |
| Dep % Ovr                      |      |                |                                 |     |             |
| Dep Ovr Comment                |      |                |                                 |     |             |
| Misc Imp Ovr                   |      |                |                                 |     |             |
| Misc Imp Ovr Comment           |      |                |                                 |     |             |
| Cost to Cure Ovr               |      |                |                                 |     |             |
| Cost to Cure Ovr Comment       |      |                |                                 |     |             |

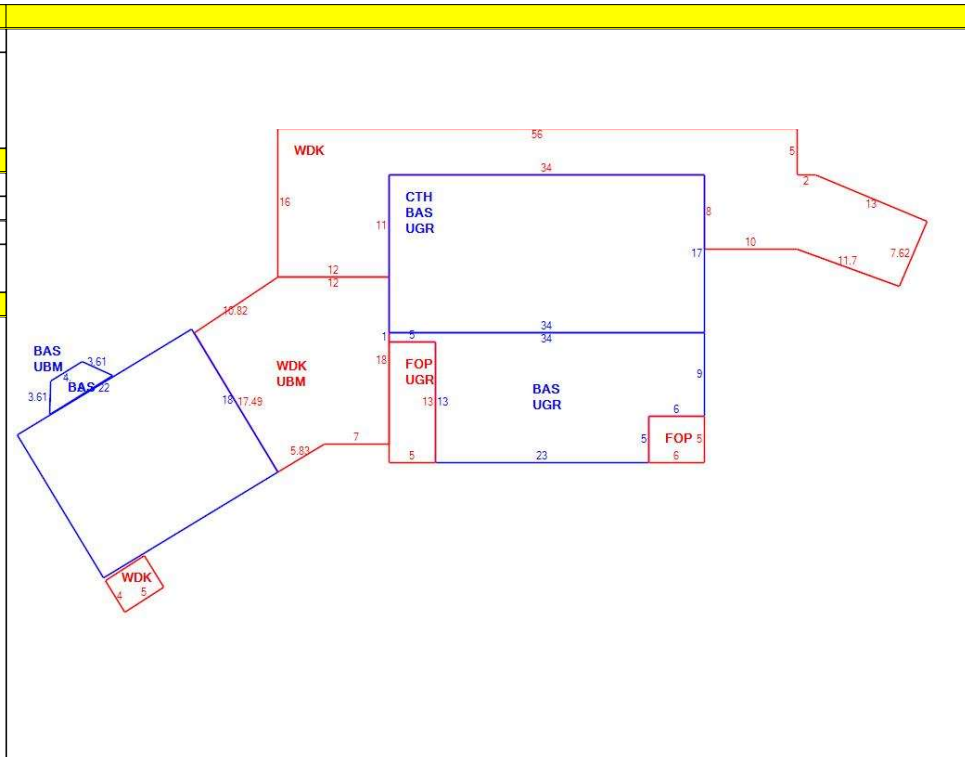

**OB - OUTBUILDING & YARD ITEMS(L) / XF - BUILDING EXTRA FEATURES(B)**

| Code | Description | L/B | Units | Unit Price | Yr Blt | Cond. Cd | % Gd | Grade | Grade Adj. | Appr. Value |
|------|-------------|-----|-------|------------|--------|----------|------|-------|------------|-------------|
| FPL1 | FPL MSNRY 1 | B   | 2     | 3000.00    | 2011   |          | 95   |       | 0.00       | 5,700       |
| ODS  | OUTDOOR S   | L   | 1     | 700.00     | 2013   |          | 100  |       | 0.00       | 700         |

**BUILDING SUB-AREA SUMMARY SECTION**

| Code                       | Description           | Living Area | Floor Area | Eff Area | Unit Cost | Undeprec Value |
|----------------------------|-----------------------|-------------|------------|----------|-----------|----------------|
| BAS                        | First Floor           | 1,373       | 1,373      | 1,373    | 477.97    | 656,256        |
| CTH                        | Cath Clng             | 0           | 578        | 29       | 23.98     | 13,861         |
| FOP                        | Porch, Open, Finished | 0           | 95         | 19       | 95.59     | 9,081          |
| UBM                        | Basement, Unfinished  | 0           | 714        | 143      | 95.73     | 68,350         |
| UGR                        | Garage, Unfinished    | 0           | 1,024      | 307      | 143.30    | 146,737        |
| WDK                        | Deck, Wood            | 0           | 936        | 94       | 48.00     | 44,929         |
| Ttl Gross Liv / Lease Area |                       | 1,373       | 4,720      | 1,965    |           | 939,214        |



| CURRENT OWNER   |            | TOPO                         | UTILITIES         | STRT / ROAD  | LOCATION    | CURRENT ASSESSMENT |   |                                |           | 1302<br>EDGARTOWN, MA          |                  |         |           |                     |                |            |
|---|------------|------------------------------|-------------------|--------------|-------------|--------------------|---|--------------------------------|-----------|--------------------------------|------------------|---------|-----------|---------------------|----------------|------------|
| PLAINE DANIEL J &<br>GRANDISON W GEORGE TRS<br>C/O DANIEL PLAINE<br>8710 BELLWOOD RD<br>BETHESDA MD 20817 |            |                              |                   |              |             | Description        | Code  | Appraised                      | Assessed  |                                |                  |         |           |                     |                |            |
|   |            |                              |                   |              |             | RESIDENTL          | 1090  | 4,997,200                      | 4,997,200 | <b>VISION</b>                  |                  |         |           |                     |                |            |
|   |            |                              |                   |              |             | RES LND            | 1090  | 3,239,400                      | 3,239,400 |                                |                  |         |           |                     |                |            |
| SUPPLEMENTAL DATA   |            |                              |                   |              |             |                    |   |                                |           |                                |                  |         |           |                     |                |            |
| Alt Prcl ID   |            | PLN#/Rec B174 P568 5/31/1973 |                   | Restriction  |             |                    |   |                                |           |                                |                  |         |           |                     |                |            |
| Lot#  |            | 2, 3, 4                      |                   | Hist Distrct |             |                    |   |                                |           |                                |                  |         |           |                     |                |            |
| Plan Notes  |            |                              |                   | Other Note   |             |                    |   |                                |           |                                |                  |         |           |                     |                |            |
| Plan Notes  |            |                              |                   | UC-Misc 1    |             |                    |   |                                |           |                                |                  |         |           |                     |                |            |
| Plan Notes  |            |                              |                   | UC-Misc 2    |             |                    |   |                                |           |                                |                  |         |           |                     |                |            |
| GIS ID  |            | M_285485_793768              |                   | Assoc Pid#   |             |                    |   |                                |           |                                |                  |         |           |                     |                |            |
|   |            |                              |                   |              |             | Total              |   | 8,236,600                      | 8,236,600 |                                |                  |         |           |                     |                |            |
| RECORD OF OWNERSHIP   |            | BK-VOL/PAGE                  | SALE DATE         | Q/U          | V/I         | SALE PRICE         | VC  | PREVIOUS ASSESSMENTS (HISTORY) |           |                                |                  |         |           |                     |                |            |
| PLAINE DANIEL J &   |            | 1297 0516                    | 11-13-2012        | U            | I           | 1                  | 1A  | Year                           | Code      | Assessed                       | Year             | Code    | Assessed  | Year                | Code           | Assessed   |
| PLAINE SUSAN A  |            | 1297 0513                    | 11-13-2012        | U            | I           | 1                  | 1A  | 2023                           | 1090      | 4,671,300                      | 2022             | 1090    | 3,047,800 | 2021                | 1090           | 3,377,000  |
| PLAINE DANIEL J & SUSAN A   |            | 1267 0988                    | 01-19-2012        | U            | I           | 2,000,000          | 1   |                                | 1090      | 3,077,400                      |                  | 1090    | 2,679,786 |                     | 1090           | 2,049,248  |
| KNOLL DAVID H &   |            | 1063 0384                    | 11-17-2005        | U            | I           | 1                  | 1A  |                                |           |                                |                  |         |           |                     |                |            |
| DINSMORE WILEY TRS  |            | 0548 0237                    | 11-06-1990        | U            | I           | 1                  | 1A  |                                |           |                                |                  |         |           |                     |                |            |
|   |            |                              |                   |              |             | Total              |   | 7,748,700                      | Total     | 5,727,586                      | Total            |         | 5,426,248 |                     |                |            |
| EXEMPTIONS  |            |                              | OTHER ASSESSMENTS |              |             |                    | This signature acknowledges a visit by a Data Collector or Assessor |                                |           |                                |                  |         |           |                     |                |            |
| Year  | Code       | Description                  | Amount            | Code         | Description | Number             | Amount  | Comm Int                       |           |                                |                  |         |           |                     |                |            |
|   |            |                              |                   |              |             |                    |   |                                |           |                                |                  |         |           |                     |                |            |
|   |            |                              |                   |              |             |                    |   |                                |           |                                |                  |         |           |                     |                |            |
|   |            |                              |                   |              |             |                    |   |                                |           |                                |                  |         |           |                     |                |            |
|   |            |                              | 0.00              |              |             |                    |   |                                |           |                                |                  |         |           |                     |                |            |
| ASSESSING NEIGHBORHOOD  |            |                              |                   |              |             |                    |   |                                |           | <b>APPRAISED VALUE SUMMARY</b> |                  |         |           |                     |                |            |
| Nbhd  |            | Nbhd Name                    |                   | B            |             | Tracing            |   | Batch                          |           | Appraised Bldg. Value (Card)   |                  |         |           |                     |                | 4,986,300  |
| CPY5  |            |                              |                   |              |             |                    |   |                                |           | Appraised Xf (B) Value (Bldg)  |                  |         |           |                     |                | 9,500      |
|   |            |                              |                   |              |             |                    |   |                                |           | Appraised Ob (B) Value (Bldg)  |                  |         |           |                     |                | 1,400      |
|   |            |                              |                   |              |             |                    |   |                                |           | Appraised Land Value (Bldg)    |                  |         |           |                     |                | 3,239,400  |
|   |            |                              |                   |              |             |                    |   |                                |           | Special Land Value             |                  |         |           |                     |                | 0          |
|   |            |                              |                   |              |             |                    |   |                                |           | Total Appraised Parcel Value   |                  |         |           |                     |                | 8,236,600  |
|   |            |                              |                   |              |             |                    |   |                                |           | Valuation Method               |                  |         |           |                     |                | C          |
|   |            |                              |                   |              |             |                    |   |                                |           | Total Appraised Parcel Value   |                  |         |           |                     |                | 8,236,600  |
| BUILDING PERMIT RECORD  |            |                              |                   |              |             |                    |   |                                |           | VISIT / CHANGE HISTORY         |                  |         |           |                     |                |            |
| Permit Id   | Issue Date | Type                         | Description       | Amount       | Insp Date   | % Comp             | Date Comp   | Comments                       |           | Date                           | Id               | Type    | Is        | Cd                  | Purpost/Result |            |
|   |            |                              |                   |              |             |                    |   |                                |           |                                |                  |         |           |                     |                |            |
| LAND LINE VALUATION SECTION   |            |                              |                   |              |             |                    |   |                                |           |                                |                  |         |           |                     |                |            |
| B   | Use Code   | Description                  | Zone              | Land Type    | Land Units  | Unit Price         | Size Adj  | Site Index                     | Cond.     | Nbhd.                          | Nbhd. Adj        | Notes   |           | Location Adjustment | Adj Unit P     | Land Value |
| 2   | 1090       | MULTI HSES                   |                   |              | SF          | 0.00               | 1.00000   |                                | 1.00      |                                | 1.000            | new 2/2 |           |                     | 0              | 0          |
| Total Card Land Units   |            |                              |                   |              | 0.00        | AC                 | Parcel Total Land Area  |                                |           | 4.70                           | Total Land Value |         |           |                     |                | 0          |



| CONSTRUCTION DETAIL            |    |                | CONSTRUCTION DETAIL (CONTINUED) |         |             |
|--------------------------------|----|----------------|---------------------------------|---------|-------------|
| Element                        | Cd | Description    | Element                         | Cd      | Description |
| Style:                         | 06 | Custom         |                                 |         |             |
| Model                          | 01 | Residential    |                                 |         |             |
| Grade:                         | 08 | Good +20       |                                 |         |             |
| Stories:                       | 2  |                |                                 |         |             |
| Occupancy                      | 1  |                |                                 |         |             |
| Exterior Wall 1                | 14 | Wood Shingle   |                                 |         |             |
| Exterior Wall 2                |    |                |                                 |         |             |
| Roof Structure:                | 07 | Gambrel        |                                 |         |             |
| Roof Cover                     | 03 | Asph/F Gls/Cmp |                                 |         |             |
| Interior Wall 1                | 05 | Drywall/Sheet  |                                 |         |             |
| Interior Wall 2                | 06 | Cust Wd Panel  |                                 |         |             |
| Interior Flr 1                 | 12 | Hardwood       |                                 |         |             |
| Interior Flr 2                 |    |                |                                 |         |             |
| Heat Fuel                      | 03 | Gas            |                                 |         |             |
| Heat Type:                     | 04 | Forced Air-Duc |                                 |         |             |
| AC Type:                       | 03 | Central        |                                 |         |             |
| Total Bedrooms                 | 06 | 6 Bedrooms     |                                 |         |             |
| Total Bthrms:                  | 6  |                |                                 |         |             |
| Total Half Baths               | 1  |                |                                 |         |             |
| Total Xtra Fixtrs              | 1  |                |                                 |         |             |
| Total Rooms:                   | 10 |                |                                 |         |             |
| Bath Style:                    | 03 | Modern         |                                 |         |             |
| Kitchen Style:                 | 03 | Luxurious      |                                 |         |             |
|                                |    |                | <b>CONDO DATA</b>               |         |             |
| Parcel Id                      |    |                | C                               | Owne    | 0.0         |
| Adjust Type                    |    | Code           | Description                     | Factor% |             |
| Condo Flr                      |    |                |                                 | B       | S           |
| Condo Unit                     |    |                |                                 |         |             |
| <b>COST / MARKET VALUATION</b> |    |                |                                 |         |             |
| Building Value New             |    |                | 4,303,465                       |         |             |
| Year Built                     |    |                | 2012                            |         |             |
| Effective Year Built           |    |                | 2017                            |         |             |
| Depreciation Code              |    |                | A                               |         |             |
| Remodel Rating                 |    |                |                                 |         |             |
| Year Remodeled                 |    |                |                                 |         |             |
| Depreciation %                 |    |                | 5                               |         |             |
| Functional Obsol               |    |                |                                 |         |             |
| External Obsol                 |    |                |                                 |         |             |
| Trend Factor                   |    |                | 1                               |         |             |
| Condition                      |    |                |                                 |         |             |
| Condition %                    |    |                |                                 |         |             |
| Percent Good                   |    |                | 95                              |         |             |
| Cns Sect Rcnd                  |    |                | 4,088,300                       |         |             |
| Dep % Ovr                      |    |                |                                 |         |             |
| Dep Ovr Comment                |    |                |                                 |         |             |
| Misc Imp Ovr                   |    |                |                                 |         |             |
| Misc Imp Ovr Comment           |    |                |                                 |         |             |
| Cost to Cure Ovr               |    |                |                                 |         |             |
| Cost to Cure Ovr Comment       |    |                |                                 |         |             |

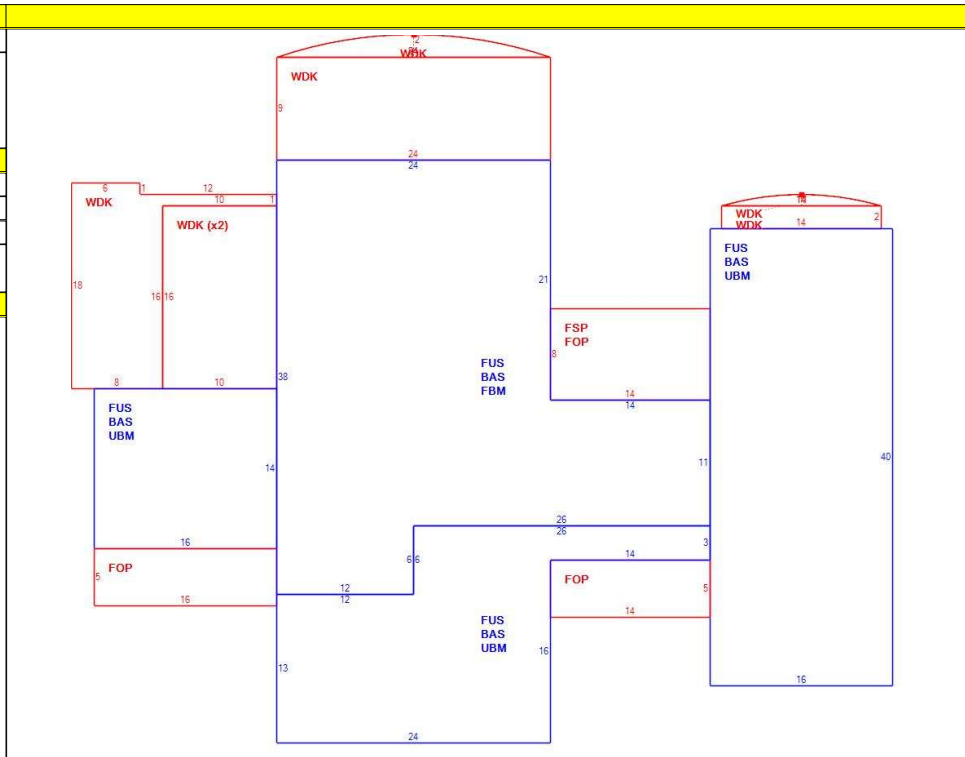

**OB - OUTBUILDING & YARD ITEMS(L) / XF - BUILDING EXTRA FEATURES(B)**

| Code | Description | L/B | Units | Unit Price | Yr Blt | Cond. Cd | % Gd | Grade | Grade Adj. | Appr. Value |
|------|-------------|-----|-------|------------|--------|----------|------|-------|------------|-------------|
| FPL3 | FPL MSNRY 2 | B   | 1     | 4000.00    | 2013   |          | 95   |       | 0.00       | 3,800       |
| ODS  | OUTDOOR S   | L   | 1     | 700.00     | 2012   |          | 100  |       | 0.00       | 700         |

| BUILDING SUB-AREA SUMMARY SECTION |                         |             |            |          |           |                |
|-----------------------------------|-------------------------|-------------|------------|----------|-----------|----------------|
| Code                              | Description             | Living Area | Floor Area | Eff Area | Unit Cost | Undeprec Value |
| BAS                               | First Floor             | 2,284       | 2,284      | 2,284    | 784.08    | 1,790,839      |
| FBM                               | Basement, Finished      | 0           | 994        | 447      | 352.60    | 350,484        |
| FOP                               | Porch, Open, Finished   | 0           | 262        | 52       | 155.62    | 40,772         |
| FSP                               | Porch, Screen, Finished | 0           | 112        | 28       | 196.02    | 21,954         |
| FUS                               | Upper Story, Finished   | 2,284       | 2,284      | 2,284    | 784.08    | 1,790,839      |
| UBM                               | Basement, Unfinished    | 0           | 1,290      | 258      | 156.82    | 202,293        |
| WDK                               | Deck, Wood              | 0           | 757        | 76       | 78.72     | 59,590         |
| Ttl Gross Liv / Lease Area        |                         | 4,568       | 7,983      | 5,429    |           | 4,256,771      |

