

| CURRENT OWNER   |            | TOPO   | UTILITIES         | STRT / ROAD | LOCATION    | CURRENT ASSESSMENT     |           |   |            | 1302<br>EDGARTOWN, MA |           |                  |                     |                       |            |
|---|------------|--|-------------------|-------------|-------------|------------------------|-----------|---|------------|-----------------------|-----------|------------------|---------------------|-----------------------|------------|
| BARTHELEMY CLAIRE<br>PROTI MARCOS<br>8948 WONDERLAND AVE  |            | 2  | Public Water      |             |             | Description            | Code      | Appraised   | Assessed   |                       |           |                  |                     |                       |            |
| LOS ANGELES CA 90046  |            | <b>SUPPLEMENTAL DATA</b>   |                   |             |             | RESIDENTL              | 1010      | 467,400   | 467,400    | <b>VISION</b>         |           |                  |                     |                       |            |
| Alt Prcl ID<br>PLN#/Rec<br>Lot#<br>Plan Notes<br>Plan Notes<br>Plan Notes<br>GIS ID M_281577_794305 |            | Restriction<br>Hist District<br>Other Note<br>UC-Misc 1<br>UC-Misc 2<br>Assoc Pid# |                   | RES LND     | 1010        | 639,900                | 639,900   |   |            |                       |           |                  |                     |                       |            |
|   |            |  |                   |             |             | Total                  |           | 1,107,300   | 1,107,300  |                       |           |                  |                     |                       |            |
| RECORD OF OWNERSHIP   |            | BK-VOL/PAGE  | SALE DATE         | Q/U         | V/I         | SALE PRICE             | VC        | PREVIOUS ASSESSMENTS (HISTORY)                                      |            |                       |           |                  |                     |                       |            |
| THE MV HOUSE CYPRIEN LLC  |            | 1654 0333  | 05-03-2023        | U           | I           | 100                    | 1A        | Year  | Code       | Assessed              | Year      | Code             | Assessed            |                       |            |
| BARTHELEMY CLAIRE   |            | 1547 568   | 10-19-2020        | Q           | I           | 615,000                | 00        | 2023  | 1010       | 370,100               | 2022      | 1010             | 230,700             |                       |            |
| PATTON ROBERT L &   |            | 0893 0601  | 08-01-2002        | Q           | I           | 325,000                | 00        |   | 1010       | 649,200               |           | 1010             | 516,700             |                       |            |
| LARAMIE RICHARD L & BARBARA A   |            | 0649 0449  | 02-03-1995        | Q           | I           | 146,000                | 00        |   |            |                       |           | 2021             | 1010                | 270,200               |            |
| DICAPUA RICHARD A & BRAINERD  |            | 00504 0423   | 07-27-1988        | Q           | I           | 134,250                | 00        |   |            |                       |           |                  | 1010                | 445,600               |            |
|   |            |  |                   |             |             | Total                  |           | 1,019,300   | Total      |                       | 747,400   | Total            |                     | 715,800               |            |
| EXEMPTIONS  |            |  | OTHER ASSESSMENTS |             |             |                        |           | This signature acknowledges a visit by a Data Collector or Assessor |            |                       |           |                  |                     |                       |            |
| Year  | Code       | Description  | Amount            | Code        | Description | Number                 | Amount    | Comm  | Int        |                       |           |                  |                     |                       |            |
|   |            | Total  | 0.00              |             |             |                        |           |   |            |                       |           |                  |                     |                       |            |
| ASSESSING NEIGHBORHOOD  |            |  |                   |             |             |                        |           |   |            |                       |           |                  |                     |                       |            |
| Nbhd  | Nbhd Name  | B  | Tracing           | Batch       |             |                        |           |   |            |                       |           |                  |                     |                       |            |
| 0050  |            |  |                   |             |             |                        |           |   |            |                       |           |                  |                     |                       |            |
| NOTES   |            |  |                   |             |             |                        |           |   |            |                       |           |                  |                     |                       |            |
| LOT 8 DUBE CF 79<br>EST WOODSTOVE   |            |  |                   |             |             |                        |           |   |            |                       |           |                  |                     |                       |            |
| BUILDING PERMIT RECORD  |            |  |                   |             |             |                        |           | VISIT / CHANGE HISTORY  |            |                       |           |                  |                     |                       |            |
| Permit Id   | Issue Date | Type   | Description       | Amount      | Insp Date   | % Comp                 | Date Comp | Comments  | Date       | Id                    | Type      | Is               | Cd                  | Purpost/Result        |            |
|   |            |  |                   |             |             |                        |           |   | 09-06-2022 | EH                    |           | 6                | 01                  | Cyclical Reinspection |            |
|   |            |  |                   |             |             |                        |           |   | 05-19-2022 | DM                    |           |                  | 11                  | Field Review          |            |
|   |            |  |                   |             |             |                        |           |   | 05-23-2017 | MM                    |           |                  | 11                  | Field Review          |            |
|   |            |  |                   |             |             |                        |           |   | 11-14-2011 | JD                    |           |                  | 11                  | Field Review          |            |
|   |            |  |                   |             |             |                        |           |   | 12-30-2010 | EP                    |           |                  | 01                  | Cyclical Reinspection |            |
|   |            |  |                   |             |             |                        |           |   | 05-06-2003 | WP                    |           |                  | 11                  | Field Review          |            |
|   |            |  |                   |             |             |                        |           |   | 10-13-2000 | WP                    |           |                  | 43                  | Cyclical Reinspection |            |
| LAND LINE VALUATION SECTION   |            |  |                   |             |             |                        |           |   |            |                       |           |                  |                     |                       |            |
| B   | Use Code   | Description  | Zone              | Land Type   | Land Units  | Unit Price             | Size Adj  | Site Index  | Cond.      | Nbhd.                 | Nbhd. Adj | Notes            | Location Adjustment | Adj Unit P            | Land Value |
| 1   | 1010       | SINGL FAM M-0  | R5                |             | 7,610 SF    | 36.56                  | 1.00000   | 4   | 1.00       | 0055                  | 2.300     |                  |                     | 84.09                 | 639,900    |
| Total Card Land Units   |            |  |                   |             | 0.17 AC     | Parcel Total Land Area |           |   |            |                       | 0.17      | Total Land Value |                     |                       | 639,900    |

| CONSTRUCTION DETAIL            |      |                | CONSTRUCTION DETAIL (CONTINUED) |     |             |
|--------------------------------|------|----------------|---------------------------------|-----|-------------|
| Element                        | Cd   | Description    | Element                         | Cd  | Description |
| Style:                         | 01   | Ranch          |                                 |     |             |
| Model                          | 01   | Residential    |                                 |     |             |
| Grade:                         | 03   | Average        |                                 |     |             |
| Stories:                       | 1    | 1 Story        |                                 |     |             |
| Occupancy                      | 1    |                |                                 |     |             |
| Exterior Wall 1                | 14   | Wood Shingle   |                                 |     |             |
| Exterior Wall 2                | 13   | Pre-Fab Wood   |                                 |     |             |
| Roof Structure:                | 03   | Gable/Hip      |                                 |     |             |
| Roof Cover                     | 03   | Asph/F Gls/Cmp |                                 |     |             |
| Interior Wall 1                | 05   | Drywall/Sheet  |                                 |     |             |
| Interior Wall 2                |      |                |                                 |     |             |
| Interior Flr 1                 | 14   | Carpet         |                                 |     |             |
| Interior Flr 2                 | 15   | Quarry Tile    |                                 |     |             |
| Heat Fuel                      | 04   | Electric       |                                 |     |             |
| Heat Type:                     | 07   | Electr Basebrd |                                 |     |             |
| AC Type:                       | 02   | Heat Pump      |                                 |     |             |
| Total Bedrooms                 | 02   | 2 Bedrooms     |                                 |     |             |
| Total Bthrms:                  | 2    |                |                                 |     |             |
| Total Half Baths               | 0    |                |                                 |     |             |
| Total Xtra Fixtrs              |      |                |                                 |     |             |
| Total Rooms:                   | 4    |                |                                 |     |             |
| Bath Style:                    | 02   | Average        |                                 |     |             |
| Kitchen Style:                 | 02   | Modern         |                                 |     |             |
| <b>CONDO DATA</b>              |      |                |                                 |     |             |
| Parcel Id                      |      | C              | Owne                            | 0.0 |             |
| Adjust Type                    | Code | Description    | Factor%                         |     |             |
| Condo Flr                      |      |                |                                 |     |             |
| Condo Unit                     |      |                |                                 |     |             |
| <b>COST / MARKET VALUATION</b> |      |                |                                 |     |             |
| Building Value New             |      | 581,940        |                                 |     |             |
| Year Built                     |      | 1979           |                                 |     |             |
| Effective Year Built           |      | 2002           |                                 |     |             |
| Depreciation Code              |      | F              |                                 |     |             |
| Remodel Rating                 |      |                |                                 |     |             |
| Year Remodeled                 |      |                |                                 |     |             |
| Depreciation %                 |      | 20             |                                 |     |             |
| Functional Obsol               |      | 0              |                                 |     |             |
| External Obsol                 |      | 0              |                                 |     |             |
| Trend Factor                   |      | 1              |                                 |     |             |
| Condition                      |      |                |                                 |     |             |
| Condition %                    |      |                |                                 |     |             |
| Percent Good                   |      | 80             |                                 |     |             |
| Cns Sect Rcnd                  |      | 465,600        |                                 |     |             |
| Dep % Ovr                      |      |                |                                 |     |             |
| Dep Ovr Comment                |      |                |                                 |     |             |
| Misc Imp Ovr                   |      |                |                                 |     |             |
| Misc Imp Ovr Comment           |      |                |                                 |     |             |
| Cost to Cure Ovr               |      |                |                                 |     |             |
| Cost to Cure Ovr Comment       |      |                |                                 |     |             |

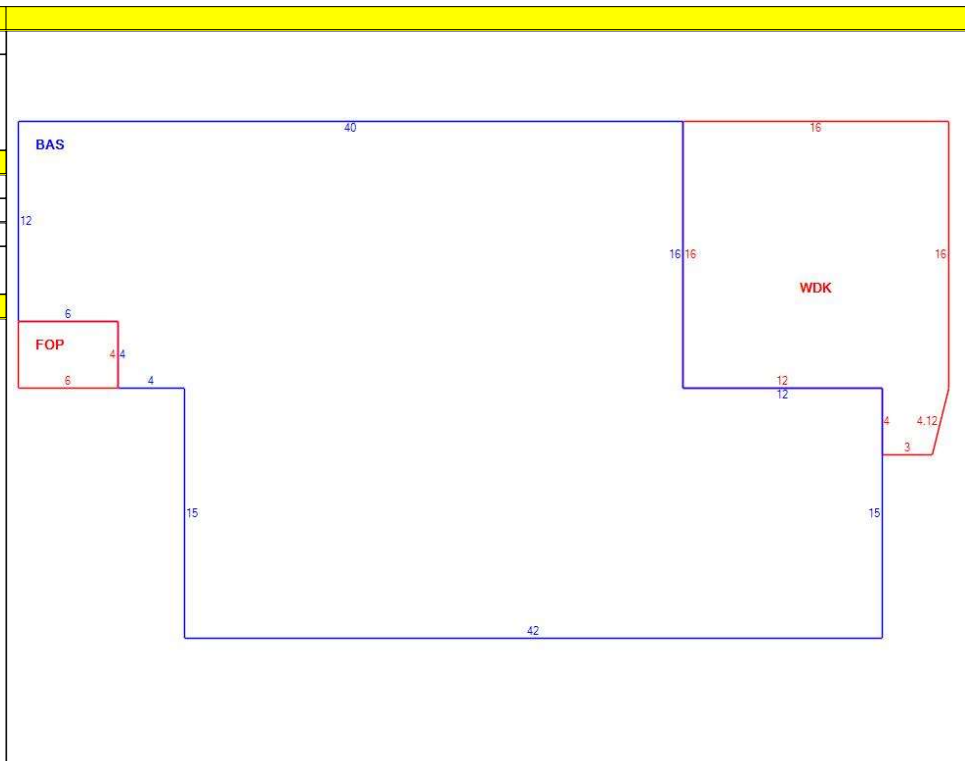

| OB - OUTBUILDING & YARD ITEMS(L) / XF - BUILDING EXTRA FEATURES(B) |             |     |       |            |        |          |      |       |            |             |
|--|-------------|-----|-------|------------|--------|----------|------|-------|------------|-------------|
| Code   | Description | L/B | Units | Unit Price | Yr Blt | Cond. Cd | % Gd | Grade | Grade Adj. | Appr. Value |
| SHD1   | SHED FRAME  | L   | 96    | 16.00      | 1980   |          | 70   |       | 0.00       | 1,100       |
| ODP  | OUTDOOR PL  | L   | 1     | 700.00     |        |          | 100  |       | 0.00       | 700         |

| BUILDING SUB-AREA SUMMARY SECTION |                       |             |            |          |           |                |
|-----------------------------------|-----------------------|-------------|------------|----------|-----------|----------------|
| Code                              | Description           | Living Area | Floor Area | Eff Area | Unit Cost | Undeprec Value |
| BAS                               | First Floor           | 1,246       | 1,246      | 1,246    | 451.44    | 562,494        |
| FOP                               | Porch, Open, Finished | 0           | 24         | 5        | 94.05     | 2,257          |
| WDK                               | Deck, Wood            | 0           | 270        | 27       | 45.14     | 12,189         |
| Ttl Gross Liv / Lease Area        |                       | 1,246       | 1,540      | 1,278    |           | 576,940        |

