

| CURRENT OWNER  |            | TOPO                                 | UTILITIES   | STRT / ROAD  | LOCATION              | CURRENT ASSESSMENT    |   |                                |                               | 1302<br>EDGARTOWN, MA |           |               |                     |                       |              |                    |          |
|--|------------|--------------------------------------|---|--|-----------------------|-----------------------|---|--------------------------------|-------------------------------|-----------------------|-----------|---------------|---------------------|-----------------------|--------------|--------------------|----------|
| HULL JOE D &<br>ROSE ELIZABETH A<br>90 POND ST<br><br>GEORGETOWN MA 01833                                |            |                                      | 2 Public Water  | 9 Town Street<br>1 Paved   |                       | Description           | Code  | Appraised                      | Assessed                      |                       |           | <b>VISION</b> |                     |                       |              |                    |          |
|  |            |                                      |   |  |                       | RESIDENTL             | 1010  | 837,100                        | 837,100                       |                       |           |               |                     |                       |              |                    |          |
|  |            |                                      |   |  |                       | RES LND               | 1010  | 675,800                        | 675,800                       |                       |           |               |                     |                       |              |                    |          |
| <b>SUPPLEMENTAL DATA</b>   |            |                                      |   |  |                       |                       |   |                                |                               |                       |           |               |                     |                       |              |                    |          |
| Alt Prcl ID<br>PLN#/Rec<br>Lot#<br>Plan Notes<br>Plan Notes<br>Plan Notes<br>GIS ID M_281850_794241      |            |                                      | Restriction<br>Hist Distrct<br>Other Note<br>UC-Misc 1<br>UC-Misc 2<br><br>Assoc Pid# |  |                       |                       |   |                                |                               |                       |           |               |                     |                       |              |                    |          |
|  |            |                                      |   |  |                       | Total                 |   | 1,512,900                      | 1,512,900                     |                       |           |               |                     |                       |              |                    |          |
| RECORD OF OWNERSHIP  |            | BK-VOL/PAGE                          | SALE DATE   | Q/U  | V/I                   | SALE PRICE            | VC  | PREVIOUS ASSESSMENTS (HISTORY) |                               |                       |           |               |                     |                       |              |                    |          |
| HULL JOE D &<br>LANDER DELOS W JR &<br>DONOVAN KEVIN J<br>DONOVAN KEVIN J & SHANNON B<br>BAPTISTE MARY E |            | 1050<br>1026<br>0798<br>0675<br>0248 | 0717<br>0605<br>0047<br>0232<br>0081  | 08-04-2005<br>12-30-2004<br>05-16-2000<br>04-23-1996<br>03-20-1963 | Q<br>U<br>U<br>U<br>U | I<br>I<br>I<br>I<br>I | 924,490<br>515,000<br>1<br>45,000<br>0                              | 00<br>1<br>1A<br>1A<br>0       | Year                          | Code                  | Assessed  | Year          | Code                | Assessed              | Year         | Code               | Assessed |
|  |            |                                      |   |  |                       |                       |   | 2023                           | 1010<br>1010                  | 852,700<br>685,600    | 2022      | 1010<br>1010  | 634,300<br>545,700  | 2021                  | 1010<br>1010 | 634,300<br>470,600 |          |
|  |            | Total                                |   |  |                       |                       |   | Total                          |                               | 1,538,300             | Total     |               | 1,180,000           | Total                 |              | 1,104,900          |          |
| EXEMPTIONS   |            |                                      | OTHER ASSESSMENTS   |  |                       |                       | This signature acknowledges a visit by a Data Collector or Assessor |                                |                               |                       |           |               |                     |                       |              |                    |          |
| Year   | Code       | Description                          | Amount  | Code   | Description           | Number                | Amount  | Comm Int                       |                               |                       |           |               |                     |                       |              |                    |          |
|  |            | Total                                |   |  |                       | 0.00                  |   |                                |                               |                       |           |               |                     |                       |              |                    |          |
| ASSESSING NEIGHBORHOOD   |            |                                      |   |  |                       |                       |   | <b>APPRAISED VALUE SUMMARY</b> |                               |                       |           |               |                     |                       |              |                    |          |
| Nbhd   | Nbhd Name  |                                      | B   |  | Tracing               |                       | Batch   |                                | Appraised Bldg. Value (Card)  |                       |           |               | 835,300             |                       |              |                    |          |
| 0050   |            |                                      |   |  |                       |                       |   |                                | Appraised Xf (B) Value (Bldg) |                       |           |               | 0                   |                       |              |                    |          |
|  |            |                                      |   |  |                       |                       |   | Appraised Ob (B) Value (Bldg)  |                               |                       |           | 1,800         |                     |                       |              |                    |          |
|  |            |                                      |   |  |                       |                       |   | Appraised Land Value (Bldg)    |                               |                       |           | 675,800       |                     |                       |              |                    |          |
|  |            |                                      |   |  |                       |                       |   | Special Land Value             |                               |                       |           | 0             |                     |                       |              |                    |          |
|  |            |                                      |   |  |                       |                       |   | Total Appraised Parcel Value   |                               |                       |           | 1,512,900     |                     |                       |              |                    |          |
|  |            |                                      |   |  |                       |                       |   | Valuation Method               |                               |                       |           | C             |                     |                       |              |                    |          |
|  |            |                                      |   |  |                       |                       |   | Total Appraised Parcel Value   |                               |                       |           | 1,512,900     |                     |                       |              |                    |          |
| BUILDING PERMIT RECORD   |            |                                      |   |  |                       |                       |   | VISIT / CHANGE HISTORY         |                               |                       |           |               |                     |                       |              |                    |          |
| Permit Id  | Issue Date | Type                                 | Description   | Amount   | Insp Date             | % Comp                | Date Comp   | Comments                       | Date                          | Id                    | Type      | Is            | Cd                  | Purpost/Result        |              |                    |          |
| 23-483   | 03-27-2023 | RA                                   | Res Add/Alter   | 1,775  |                       | 0                     |   | INSULATION                     | 05-15-2023                    | EH                    |           |               | 01                  | Cyclical Reinspection |              |                    |          |
| 2022-737   | 05-16-2022 | SOLR                                 | Solar Panels  |  |                       | 0                     |   |                                | 05-01-2022                    | DM                    |           |               | 11                  | Field Review          |              |                    |          |
| 2013-431   | 06-07-2013 | RA                                   | Res Add/Alter   |  |                       |                       |   | DOOR TO WINDOW                 | 05-22-2017                    | MM                    |           |               | 11                  | Field Review          |              |                    |          |
|  |            |                                      |   |  |                       |                       |   |                                | 04-09-2014                    | EP                    |           |               | 01                  | Cyclical Reinspection |              |                    |          |
|  |            |                                      |   |  |                       |                       |   |                                | 11-14-2011                    | JD                    |           |               | 11                  | Field Review          |              |                    |          |
|  |            |                                      |   |  |                       |                       |   |                                | 09-13-2006                    | WP                    |           |               | 11                  | Field Review          |              |                    |          |
|  |            |                                      |   |  |                       |                       |   |                                | 08-18-2005                    | EP                    |           |               | 11                  | Field Review          |              |                    |          |
| LAND LINE VALUATION SECTION  |            |                                      |   |  |                       |                       |   |                                |                               |                       |           |               |                     |                       |              |                    |          |
| B  | Use Code   | Description                          | Zone  | Land Type  | Land Units            | Unit Price            | Size Adj  | Site Index                     | Cond.                         | Nbhd.                 | Nbhd. Adj | Notes         | Location Adjustment | Adj Unit P            | Land Value   |                    |          |
| 1  | 1010       | SINGL FAM M-0                        | R5  |  | 9,300 SF              | 31.59                 | 1.00000   | 4                              | 1.00                          | 0055                  | 2.300     |               |                     | 72.67                 | 675,800      |                    |          |
| Total Card Land Units  |            |                                      |   |  | 0.21                  | AC                    | Parcel Total Land Area  |                                |                               |                       |           | 0.21          | Total Land Value    |                       |              | 675,800            |          |

| CONSTRUCTION DETAIL            |      |                | CONSTRUCTION DETAIL (CONTINUED) |     |             |
|--------------------------------|------|----------------|---------------------------------|-----|-------------|
| Element                        | Cd   | Description    | Element                         | Cd  | Description |
| Style:                         | 03   | Colonial       |                                 |     |             |
| Model                          | 01   | Residential    |                                 |     |             |
| Grade:                         | 05   | Ave/Good       |                                 |     |             |
| Stories:                       | 2    | 2 Stories      |                                 |     |             |
| Occupancy                      | 1    |                |                                 |     |             |
| Exterior Wall 1                | 14   | Wood Shingle   |                                 |     |             |
| Exterior Wall 2                |      |                |                                 |     |             |
| Roof Structure:                | 03   | Gable/Hip      |                                 |     |             |
| Roof Cover                     | 03   | Asph/F Gls/Cmp |                                 |     |             |
| Interior Wall 1                | 05   | Drywall/Sheet  |                                 |     |             |
| Interior Wall 2                |      |                |                                 |     |             |
| Interior Flr 1                 | 12   | Hardwood       |                                 |     |             |
| Interior Flr 2                 | 15   | Quarry Tile    |                                 |     |             |
| Heat Fuel                      | 03   | Gas            |                                 |     |             |
| Heat Type:                     | 04   | Forced Air-Duc |                                 |     |             |
| AC Type:                       | 03   | Central        |                                 |     |             |
| Total Bedrooms                 | 03   | 3 Bedrooms     |                                 |     |             |
| Total Bthrms:                  | 2    |                |                                 |     |             |
| Total Half Baths               | 1    |                |                                 |     |             |
| Total Xtra Fixtrs              |      |                |                                 |     |             |
| Total Rooms:                   | 5    |                |                                 |     |             |
| Bath Style:                    | 02   | Average        |                                 |     |             |
| Kitchen Style:                 | 02   | Modern         |                                 |     |             |
| <b>CONDO DATA</b>              |      |                |                                 |     |             |
| Parcel Id                      |      | C              | Owne                            | 0.0 |             |
|                                |      |                | B                               | S   |             |
| Adjust Type                    | Code | Description    | Factor%                         |     |             |
| Condo Flr                      |      |                |                                 |     |             |
| Condo Unit                     |      |                |                                 |     |             |
| <b>COST / MARKET VALUATION</b> |      |                |                                 |     |             |
| Building Value New             |      |                | 879,271                         |     |             |
| Year Built                     |      |                | 1930                            |     |             |
| Effective Year Built           |      |                | 2017                            |     |             |
| Depreciation Code              |      |                | R                               |     |             |
| Remodel Rating                 |      |                |                                 |     |             |
| Year Remodeled                 |      |                |                                 |     |             |
| Depreciation %                 |      |                | 5                               |     |             |
| Functional Obsol               |      |                | 0                               |     |             |
| External Obsol                 |      |                | 0                               |     |             |
| Trend Factor                   |      |                | 1                               |     |             |
| Condition                      |      |                |                                 |     |             |
| Condition %                    |      |                |                                 |     |             |
| Percent Good                   |      |                | 95                              |     |             |
| Cns Sect Rcnd                  |      |                | 835,300                         |     |             |
| Dep % Ovr                      |      |                |                                 |     |             |
| Dep Ovr Comment                |      |                |                                 |     |             |
| Misc Imp Ovr                   |      |                |                                 |     |             |
| Misc Imp Ovr Comment           |      |                |                                 |     |             |
| Cost to Cure Ovr               |      |                |                                 |     |             |
| Cost to Cure Ovr Comment       |      |                |                                 |     |             |

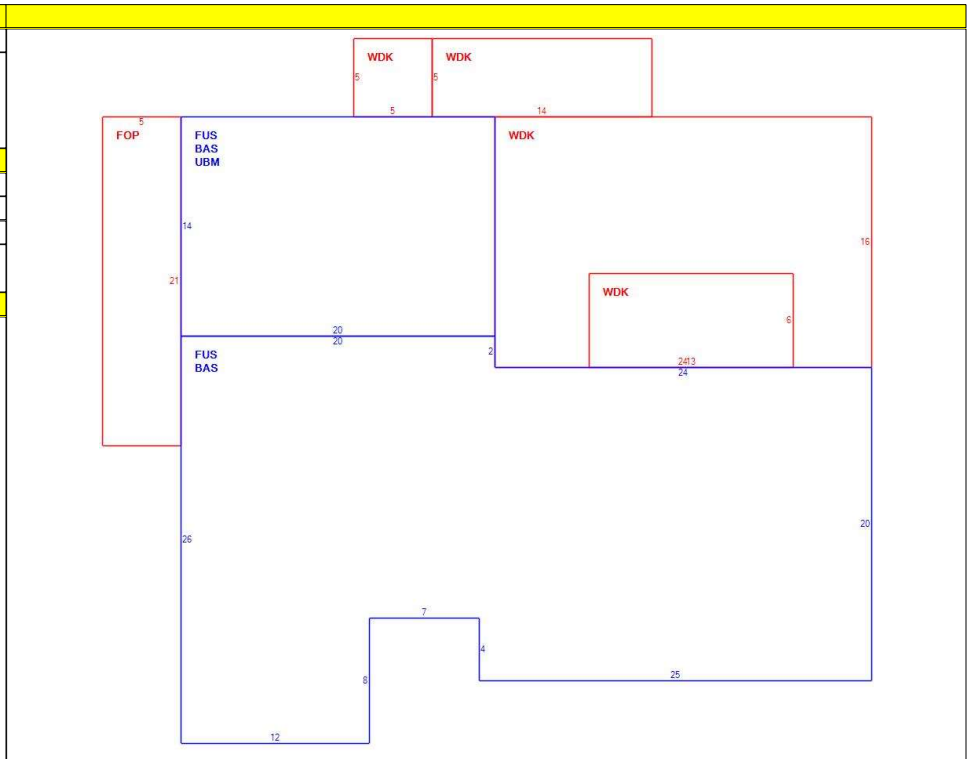

**OB - OUTBUILDING & YARD ITEMS(L) / XF - BUILDING EXTRA FEATURES(B)**

| Code | Description | L/B | Units | Unit Price | Yr Blt | Cond. Cd | % Gd | Grade | Grade Adj. | Appr. Value |
|------|-------------|-----|-------|------------|--------|----------|------|-------|------------|-------------|
| SHD1 | SHED FRAME  | L   | 90    | 16.00      | 1980   |          | 100  |       | 0.00       | 1,400       |
| ODS  | OUTDOOR S   | L   | 1     | 700.00     | 2011   |          | 50   |       | 0.00       | 400         |

**BUILDING SUB-AREA SUMMARY SECTION**

| Code                       | Description           | Living Area | Floor Area | Eff Area | Unit Cost | Undeprec Value |
|----------------------------|-----------------------|-------------|------------|----------|-----------|----------------|
| BAS                        | First Floor           | 1,220       | 1,220      | 1,220    | 338.23    | 412,643        |
| FOP                        | Porch, Open, Finished | 0           | 105        | 21       | 67.65     | 7,103          |
| FUS                        | Upper Story, Finished | 1,220       | 1,220      | 1,220    | 338.23    | 412,643        |
| UBM                        | Basement, Unfinished  | 0           | 280        | 56       | 67.65     | 18,941         |
| WDK                        | Deck, Wood            | 0           | 557        | 56       | 34.01     | 18,941         |
| Ttl Gross Liv / Lease Area |                       | 2,440       | 3,382      | 2,573    |           | 870,271        |

