

| CURRENT OWNER | | TOPO | UTILITIES | STRT / ROAD | LOCATION | CURRENT ASSESSMENT | | | | 1302 EDGARTOWN, MA | | | | | |
|--------------------------------|------------|---|----------------------------------|--------------------------|-------------|------------------------|---|--------------------------------|------------|-----------------------|-----------|------------------|---------------------|-----------------------|------------|
| RODGERS NORMA E | | | 2 Public Water 3 Public Sewer | 9 Town Street 1 Paved | | Description | Code | Appraised | Assessed | | | VISION | | | |
| BOX 43 | | SUPPLEMENTAL DATA | | | | RESIDENTL | 1010 | 858,900 | 858,900 | | | | | | |
| EDGARTOWN MA 02539 | | Alt Prcl ID PLN#/Rec Lot# Plan Notes Plan Notes Plan Notes GIS ID M_282057_794017 | | | | RES LND | 1010 | 544,300 | 544,300 | | | | | | |
| | | | | | | Total | | 1,403,200 | 1,403,200 | | | | | | |
| RECORD OF OWNERSHIP | | BK-VOL/PAGE | SALE DATE | Q/U | V/I | SALE PRICE | VC | PREVIOUS ASSESSMENTS (HISTORY) | | | | | | | |
| RODGERS NORMA E | | 0709 0159 | 09-26-1997 | U | I | 127,500 | 1A | Year | Code | Assessed | Year | Code | Assessed | | |
| BARIL ARLENE & RODGERS NORMA E | | 0709 0157 | 09-26-1997 | U | I | 1 | 1A | 2023 | 1010 | 829,800 | 2022 | 1010 | 529,000 | | |
| NORTON CYRUS S TRS | | 0569 0064 | 12-03-1991 | U | I | 1 | 1A | | 1010 | 561,500 | 2021 | 1010 | 561,500 | | |
| NORTON CYRUS S | | 00188 0444 | 03-19-1935 | | | 0 | | Total | | 1,391,300 | Total | | 1,090,500 | | |
| | | Total | | | | | | Total | | 1,071,500 | | | | | |
| EXEMPTIONS | | | OTHER ASSESSMENTS | | | | This signature acknowledges a visit by a Data Collector or Assessor | | | | | | | | |
| Year | Code | Description | Amount | Code | Description | Number | Amount | Comm Int | | | | | | | |
| Total | | | 0.00 | | | | | | | | | | | | |
| ASSESSING NEIGHBORHOOD | | | | | | | | | | | | | | | |
| Nbhd | | Nbhd Name | | B | | Tracing | | Batch | | | | | | | |
| 0050 | | | | | | | | | | | | | | | |
| NOTES | | | | | | | | | | | | | | | |
| LOT 1 NORTON CF 462 | | | | | | | | | | | | | | | |
| BUILDING PERMIT RECORD | | | | | | | | | | | | | | | |
| Permit Id | Issue Date | Type | Description | Amount | Insp Date | % Comp | Date Comp | Comments | Date | Id | Type | Is | Cd | Purpost/Result | |
| 2022-716 | 05-11-2022 | RA | Res Add/Alter | | | 0 | | RENO WINDOWS/SIDING | 09-07-2022 | EH | | 6 | 01 | Cyclical Reinspection | |
| 2016-550 | 05-16-2016 | RA | Res Add/Alter | | | 0 | | REPLACE ROOF | 05-20-2022 | DM | | | 11 | Field Review | |
| | | | | | | | | | 05-22-2017 | MM | | | 11 | Field Review | |
| | | | | | | | | | 11-29-2011 | MM | | | 11 | Field Review | |
| | | | | | | | | | 10-24-2006 | EP | | | 51 | Cyclical Reinspection | |
| | | | | | | | | | 12-01-2000 | WP | | | 43 | Cyclical Reinspection | |
| | | | | | | | | | 06-01-1989 | | | | | | |
| LAND LINE VALUATION SECTION | | | | | | | | | | | | | | | |
| B | Use Code | Description | Zone | Land Type | Land Units | Unit Price | Size Adj | Site Index | Cond. | Nbhd. | Nbhd. Adj | Notes | Location Adjustment | Adj Unit P | Land Value |
| 1 | 1010 | SINGL FAM M-0 | R5 | | 10,894 SF | 27.76 | 1.00000 | 5 | 1.00 | 0050 | 1.800 | | | 49.96 | 544,300 |
| Total Card Land Units | | | | | 0.25 AC | Parcel Total Land Area | | | | | 0.25 | Total Land Value | | | 544,300 |

| CONSTRUCTION DETAIL | | | CONSTRUCTION DETAIL (CONTINUED) | | |
|--------------------------------|------|----------------|---------------------------------|-----|-------------|
| Element | Cd | Description | Element | Cd | Description |
| Style: | 06 | Custom | | | |
| Model: | 01 | Residential | | | |
| Grade: | 05 | Ave/Good | | | |
| Stories: | 1.5 | 1 1/2 Stories | | | |
| Occupancy | 1 | | | | |
| Exterior Wall 1 | 25 | Vinyl Siding | | | |
| Exterior Wall 2 | | | | | |
| Roof Structure: | 03 | Gable/Hip | | | |
| Roof Cover | 03 | Asph/F Gls/Cmp | | | |
| Interior Wall 1 | 03 | Plastered | | | |
| Interior Wall 2 | | | | | |
| Interior Flr 1 | 12 | Hardwood | | | |
| Interior Flr 2 | 14 | Carpet | | | |
| Heat Fuel | 02 | Oil | | | |
| Heat Type: | 05 | Hot Water | | | |
| AC Type: | 01 | None | | | |
| Total Bedrooms | 05 | 5 Bedrooms | | | |
| Total Bthrms: | 2 | | | | |
| Total Half Baths | 0 | | | | |
| Total Xtra Fixtrs | | | | | |
| Total Rooms: | 7 | | | | |
| Bath Style: | 02 | Average | | | |
| Kitchen Style: | 02 | Modern | | | |
| CONDO DATA | | | | | |
| Parcel Id | | C | Owne | 0.0 | |
| | | | B | S | |
| Adjust Type | Code | Description | Factor% | | |
| Condo Flr | | | | | |
| Condo Unit | | | | | |
| COST / MARKET VALUATION | | | | | |
| Building Value New | | 1,226,057 | | | |
| Year Built | | 1830 | | | |
| Effective Year Built | | 1992 | | | |
| Depreciation Code | | A | | | |
| Remodel Rating | | | | | |
| Year Remodeled | | | | | |
| Depreciation % | | 30 | | | |
| Functional Obsol | | 0 | | | |
| External Obsol | | 0 | | | |
| Trend Factor | | 1 | | | |
| Condition | | | | | |
| Condition % | | | | | |
| Percent Good | | 70 | | | |
| Cns Sect Rcnd | | 858,200 | | | |
| Dep % Ovr | | | | | |
| Dep Ovr Comment | | | | | |
| Misc Imp Ovr | | | | | |
| Misc Imp Ovr Comment | | | | | |
| Cost to Cure Ovr | | | | | |
| Cost to Cure Ovr Comment | | | | | |

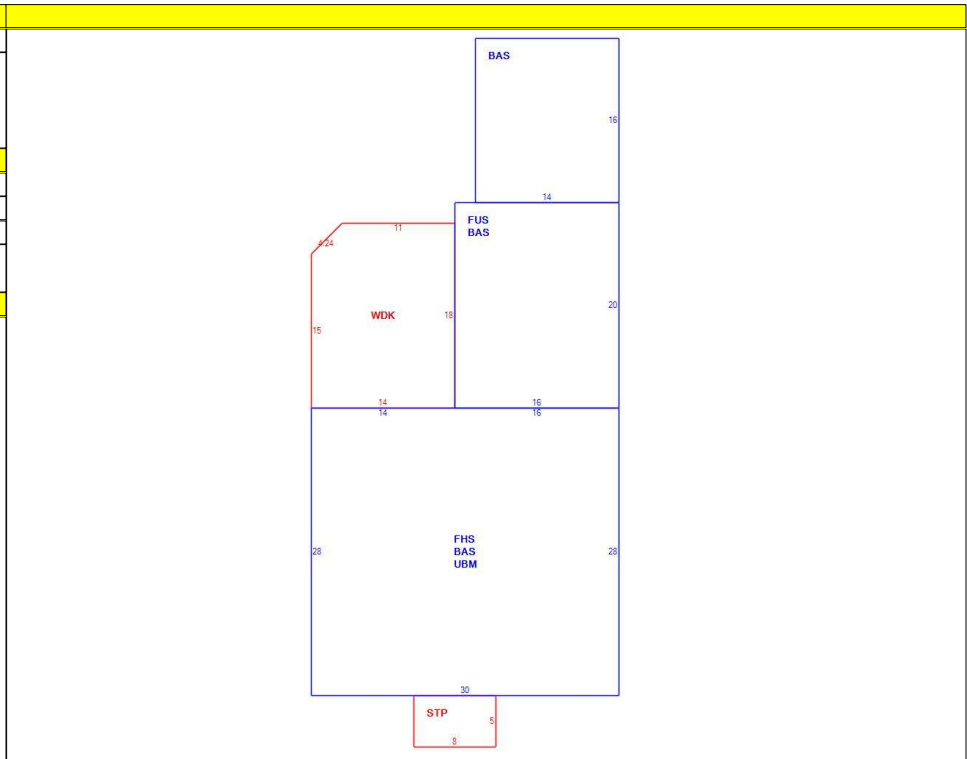

| OB - OUTBUILDING & YARD ITEMS(L) / XF - BUILDING EXTRA FEATURES(B) | | | | | | | | | | |
|--|-------------|-----|-------|------------|--------|----------|------|-------|------------|-------------|
| Code | Description | L/B | Units | Unit Price | Yr Blt | Cond. Cd | % Gd | Grade | Grade Adj. | Appr. Value |
| ODP | OUTDOOR PL | L | 1 | 700.00 | 2016 | | 100 | | 0.00 | 700 |

| BUILDING SUB-AREA SUMMARY SECTION | | | | | | | |
|-----------------------------------|-----------------------|-------------|------------|----------|-----------|----------------|--|
| Code | Description | Living Area | Floor Area | Eff Area | Unit Cost | Undeprec Value | |
| BAS | First Floor | 1,384 | 1,384 | 1,384 | 525.66 | 727,513 | |
| FHS | Half Story, Finished | 420 | 840 | 420 | 262.83 | 220,777 | |
| FUS | Upper Story, Finished | 320 | 320 | 320 | 525.66 | 168,211 | |
| STP | Stoop | 0 | 40 | 4 | 52.57 | 2,103 | |
| UBM | Basement, Unfinished | 0 | 840 | 168 | 105.13 | 88,311 | |
| WDK | Deck, Wood | 0 | 248 | 25 | 52.99 | 13,142 | |
| Ttl Gross Liv / Lease Area | | 2,124 | 3,672 | 2,321 | | 1,220,057 | |

