

| CURRENT OWNER | | TOPO | UTILITIES | STRT / ROAD | LOCATION | CURRENT ASSESSMENT | | | | 1302 EDGARTOWN, MA | | | | | |
|---|------------|-------------|--|--------------|-------------|------------------------|---|--------------------------------|------------|-----------------------|-----------|------------------|---------------------|-----------------------|------------|
| PISTORINO PETER CORCORAN A T EDRY R J WRIGHT M ETAL TRS PO BOX 67 | | | 2 Public Water 3 Public Sewer | | | Description | Code | Appraised | Assessed | | | | | | |
| EDGARTOWN MA 02539 | | | | | | RESIDENTL | 1230 | 633,700 | 633,700 | VISION | | | | | |
| | | | | | | RES LND | 1230 | 525,700 | 525,700 | | | | | | |
| SUPPLEMENTAL DATA | | | | | | Total | | 1,159,400 | 1,159,400 | | | | | | |
| Alt Prcl ID | | Restriction | | Hist Distrct | | Other Note | | | | | | | | | |
| PLN#/Rec 338/208 1976 ENOS PLAN | | UC-Misc 1 | | SEE NOTES | | UC-Misc 2 | | | | | | | | | |
| Lot# 1 | | Assoc Pid# | | | | | | | | | | | | | |
| Plan Notes | | | | | | | | | | | | | | | |
| Plan Notes | | | | | | | | | | | | | | | |
| Plan Notes | | | | | | | | | | | | | | | |
| GIS ID M_281675_794000 | | | | | | | | | | | | | | | |
| RECORD OF OWNERSHIP | | BK-VOL/PAGE | SALE DATE | Q/U | V/I | SALE PRICE | VC | PREVIOUS ASSESSMENTS (HISTORY) | | | | | | | |
| PISTORINO PETER CORCORAN A T | | 0797 0176 | 05-04-2000 | Q | I | 620,000 | 00 | Year | Code | Assessed | Year | Code | Assessed | | |
| BOLDT BENJAMIN J BETTY J | | 00427 0712 | 04-25-1985 | U | I | 1 | 1A | 2023 | 1230 | 633,700 | 2022 | 1230 | 473,800 | | |
| BOLDT BENJAMIN J & BETTY | | 0355 0478 | 04-21-1978 | Q | I | 50,000 | 00 | | 1230 | 542,400 | 2021 | 1230 | 430,800 | | |
| ENOS RICHARD | | 0338 0207 | 09-23-1976 | | | 0 | | | | | | | 467,800 | | |
| ENOS JOHN F JR | | 00D8 5074 | 06-16-1975 | | | 0 | | | | | | | | | |
| | | | | | | Total | | 1,176,100 | Total | 1,016,200 | Total | | 898,600 | | |
| EXEMPTIONS | | | OTHER ASSESSMENTS | | | | This signature acknowledges a visit by a Data Collector or Assessor | | | | | | | | |
| Year | Code | Description | Amount | Code | Description | Number | Amount | Comm Int | | | | | | | |
| Total | | 0.00 | | | | | | | | | | | | | |
| ASSESSING NEIGHBORHOOD | | | | | | | | | | | | | | | |
| Nbhd | | Nbhd Name | | B | | Tracing | | Batch | | | | | | | |
| 0050 | | | | | | | | | | | | | | | |
| NOTES | | | | | | | | | | | | | | | |
| FUS=10 RENTALS(ROOMS) | | | **NEED INT INFO--#APTS #RENTAL RMS #BTHS | | | | | | | | | | | | |
| PIZZA SHOP CONV TO APT--2BR 1 BTH 2013 | | | | | | | | | | | | | | | |
| MINI-SPLIT AC IN 2013 APT ONLY | | | | | | | | | | | | | | | |
| FY15 EST #BR #BTH | | | | | | | | | | | | | | | |
| 5 ELECTRIC METERS | | | ROW TO RES CONDOS @ REAR | | | | | | | | | | | | |
| BUILDING PERMIT RECORD | | | | | | | | | | | | | | | |
| Permit Id | Issue Date | Type | Description | Amount | Insp Date | % Comp | Date Comp | Comments | Date | Id | Type | Is | Cd | Purpost/Result | |
| 2015-121 | 10-21-2014 | RA | Res Add/Alter | | | 100 | | MINOR ALTS REPLACE SIDI | 05-20-2022 | DM | | | 11 | Field Review | |
| 357-2013 | 12-10-2013 | CO | CO ISSUED | | | 100 | | MULTI FAMILY ALTER | 07-28-2021 | EH | | | 01 | Cyclical Reinspection | |
| 2013-357 | 04-26-2013 | RA | Res Add/Alter | | | 100 | | CONVERT 1ST TO APT | 04-27-2017 | DT | | | 11 | Field Review | |
| | | | | | | | | | 06-23-2014 | DT | | | 11 | Field Review | |
| | | | | | | | | | 04-23-2014 | EP | | | 01 | Cyclical Reinspection | |
| | | | | | | | | | 03-21-2011 | DT | | | 11 | Field Review | |
| | | | | | | | | | 12-03-2008 | EP | | | 11 | Field Review | |
| LAND LINE VALUATION SECTION | | | | | | | | | | | | | | | |
| B | Use Code | Description | Zone | Land Type | Land Units | Unit Price | Size Adj | Site Index | Cond. | Nbhd. | Nbhd. Adj | Notes | Location Adjustment | Adj Unit P | Land Value |
| 1 | 1230 | EMPLOYEE HS | BII | | 13,080 SF | 23.50 | 1.00000 | 5 | 0.95 | 0050 | 1.800 | X 95% ROW | | 40.19 | 525,700 |
| Total Card Land Units | | | | | 0.30 AC | Parcel Total Land Area | | | | | 0.30 | Total Land Value | | | 525,700 |

| CONSTRUCTION DETAIL | | | CONSTRUCTION DETAIL (CONTINUED) | | |
|---------------------|------|-----------------|---------------------------------|----|-------------|
| Element | Cd | Description | Element | Cd | Description |
| Style: | 81 | Employee Housng | | | |
| Model | 01 | Residential | | | |
| Grade: | 04 | Above Ave | | | |
| Stories: | 2.75 | | | | |
| Occupancy | 11 | | | | |
| Exterior Wall 1 | 14 | Wood Shingle | | | |
| Exterior Wall 2 | | | | | |
| Roof Structure: | 03 | Gable/Hip | | | |
| Roof Cover | 03 | Asph/F Gls/Cmp | | | |
| Interior Wall 1 | 05 | Drywall/Sheet | | | |
| Interior Wall 2 | | | | | |
| Interior Flr 1 | 14 | Carpet | | | |
| Interior Flr 2 | | | | | |
| Heat Fuel | 03 | Gas | | | |
| Heat Type: | 05 | Hot Water | | | |
| AC Type: | 02 | Heat Pump | | | |
| Total Bedrooms | 08 | 8 Bedrooms | | | |
| Total Bthrms: | 7 | | | | |
| Total Half Baths | 0 | | | | |
| Total Xtra Fixtrs | | | | | |
| Total Rooms: | 14 | | | | |
| Bath Style: | 02 | Average | | | |
| Kitchen Style: | 02 | Modern | | | |

| CONDO DATA | | | | |
|-------------|------|-------------|---------|-----|
| Parcel Id | | C | Owne | 0.0 |
| | | | B | S |
| Adjust Type | Code | Description | Factor% | |
| Condo Flr | | | | |
| Condo Unit | | | | |

| COST / MARKET VALUATION | | |
|--------------------------|--|---------|
| Building Value New | | 666,223 |
| Year Built | | 1985 |
| Effective Year Built | | 2017 |
| Depreciation Code | | VG |
| Remodel Rating | | |
| Year Remodeled | | 2013 |
| Depreciation % | | 5 |
| Functional Obsol | | 0 |
| External Obsol | | 0 |
| Trend Factor | | 1 |
| Condition | | |
| Condition % | | |
| Percent Good | | 95 |
| Cns Sect Rcnd | | 632,900 |
| Dep % Ovr | | |
| Dep Ovr Comment | | |
| Misc Imp Ovr | | |
| Misc Imp Ovr Comment | | |
| Cost to Cure Ovr | | |
| Cost to Cure Ovr Comment | | |

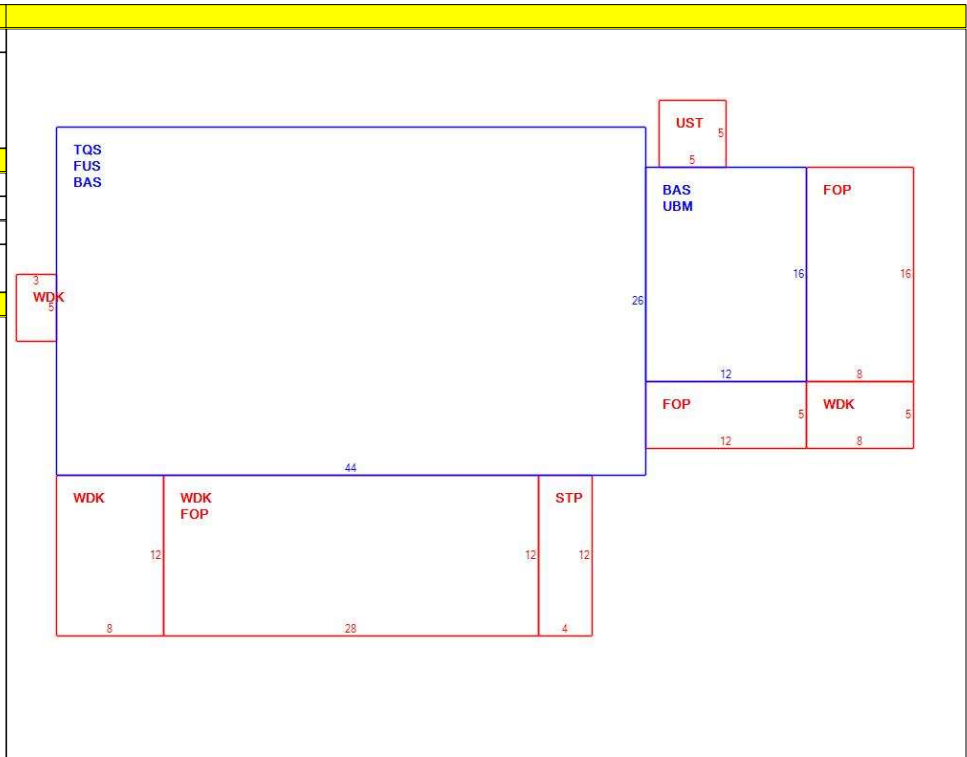

| OB - OUTBUILDING & YARD ITEMS(L) / XF - BUILDING EXTRA FEATURES(B) | | | | | | | | | | |
|--|-------------|-----|-------|------------|--------|----------|------|-------|------------|-------------|
| Code | Description | L/B | Units | Unit Price | Yr Blt | Cond. Cd | % Gd | Grade | Grade Adj. | Appr. Value |
| SHD1 | SHED FRAME | L | 48 | 16.00 | | | 100 | | 0.00 | 800 |

| BUILDING SUB-AREA SUMMARY SECTION | | | | | | |
|-----------------------------------|------------------------------|-------------|------------|----------|-----------|----------------|
| Code | Description | Living Area | Floor Area | Eff Area | Unit Cost | Undeprec Value |
| BAS | First Floor | 1,336 | 1,336 | 1,336 | 178.57 | 238,575 |
| FOP | Porch, Open, Finished | 0 | 524 | 105 | 35.78 | 18,750 |
| FUS | Upper Story, Finished | 1,144 | 1,144 | 1,144 | 178.57 | 204,289 |
| STP | Stoop | 0 | 48 | 5 | 18.60 | 893 |
| TQS | Three Quarter Story | 858 | 1,144 | 858 | 133.93 | 153,216 |
| UBM | Basement, Unfinished | 0 | 192 | 38 | 35.34 | 6,786 |
| UST | Utility, Storage, Unfinished | 0 | 25 | 11 | 78.57 | 1,964 |
| WDK | Deck, Wood | 0 | 487 | 49 | 17.97 | 8,750 |
| Ttl Gross Liv / Lease Area | | 3,338 | 4,900 | 3,546 | | 633,223 |

