

| CURRENT OWNER | | TOPO | UTILITIES | STRT / ROAD | LOCATION | CURRENT ASSESSMENT | | | | 1302 EDGARTOWN, MA | | | | | | |
|-----------------------------|------------|---|----------------------------------|--|-------------|------------------------|---|--------------------------------|------------|-----------------------|-----------|-------------------------------|---------------------|-----------------------|------------|----------|
| LAWCEWICZ MARIA H & TADEUSZ | | | 2 Public Water 3 Public Sewer | | | Description | Code | Appraised | Assessed | | | | | | | |
| 49 OAKLAND AVENUE | | SUPPLEMENTAL DATA | | | | RESIDENTL | 1010 | 646,300 | 646,300 | VISION | | | | | | |
| ARLINGTON MA 02174 | | Alt Prcl ID PLN#/Rec Lot# Plan Notes Plan Notes Plan Notes GIS ID M_281684_793962 | | Restriction Hist Distrct Other Note UC-Misc 1 NEED CYC '19 UC-Misc 2 & CK ADDIT NS Assoc Pid# | | RES LND | 1010 | 460,600 | 460,600 | | | | | | | |
| | | | | | | Total | | 1,106,900 | 1,106,900 | | | | | | | |
| RECORD OF OWNERSHIP | | BK-VOL/PAGE | SALE DATE | Q/U | V/I | SALE PRICE | VC | PREVIOUS ASSESSMENTS (HISTORY) | | | | | | | | |
| LAWCEWICZ MARIA H & TADEUSZ | | 0727 0373 | 04-21-1998 | Q | I | 100,000 | 00 | Year | Code | Assessed | Year | Code | Assessed | Year | Code | Assessed |
| DUNN JOSEPH P JR & LEWIS | | 0630 0354 | 03-31-1994 | U | I | 1 | 1A | 2023 | 1010 | 658,500 | 2022 | 1010 | 243,600 | 2021 | 1010 | 223,700 |
| DUNN JOSEPH P JR & LEWIS | | 0613 0314 | 08-27-1993 | U | I | 1 | 1B | | 1010 | 475,300 | | 1010 | 475,300 | | 1010 | 409,900 |
| DUNN JOSEPH P JR | | 00412 0156 | 03-08-1984 | Q | I | 60,000 | 00 | | | | | | | | | |
| CHAMBERLAIN CATHERINE M | | 00358 0370 | 07-01-1978 | | | 0 | | | | | | | | | | |
| | | | | | | Total | | 1,133,800 | Total | | 718,900 | Total | | 633,600 | | |
| EXEMPTIONS | | | OTHER ASSESSMENTS | | | | This signature acknowledges a visit by a Data Collector or Assessor | | | | | | | | | |
| Year | Code | Description | Amount | Code | Description | Number | Amount | Comm Int | | | | | | | | |
| Total | | | 0.00 | | | | | | | | | | | | | |
| ASSESSING NEIGHBORHOOD | | | | | | | | | | | | APPRAISED VALUE SUMMARY | | | | |
| Nbhd | Nbhd Name | B | Tracing | Batch | | | | | | | | Appraised Bldg. Value (Card) | 644,800 | | | |
| 0050 | | | | | | | | | | | | Appraised Xf (B) Value (Bldg) | 0 | | | |
| | | | | | | | | | | | | Appraised Ob (B) Value (Bldg) | 1,500 | | | |
| | | | | | | | | | | | | Appraised Land Value (Bldg) | 460,600 | | | |
| | | | | | | | | | | | | Special Land Value | 0 | | | |
| | | | | | | | | | | | | Total Appraised Parcel Value | 1,106,900 | | | |
| | | | | | | | | | | | | Valuation Method | C | | | |
| | | | | | | | | | | | | Total Appraised Parcel Value | 1,106,900 | | | |
| BUILDING PERMIT RECORD | | | | | | | | | | | | VISIT / CHANGE HISTORY | | | | |
| Permit Id | Issue Date | Type | Description | Amount | Insp Date | % Comp | Date Comp | Comments | Date | Id | Type | Is | Cd | Purpost/Result | | |
| 2016-512 | 04-15-2016 | RA | Res Add/Alter | 50,000 | | 0 | | ADDIT 1170 SF--2ND FL | 05-20-2022 | DM | | | 11 | Field Review | | |
| | | | | | | | | | 02-17-2022 | EH | | | 01 | Cyclical Reinspection | | |
| | | | | | | | | | 05-19-2021 | EP | | | 01 | Cyclical Reinspection | | |
| | | | | | | | | | 06-16-2020 | EP | | | 01 | Cyclical Reinspection | | |
| | | | | | | | | | 11-26-2019 | EP | | | 01 | Cyclical Reinspection | | |
| | | | | | | | | | 05-23-2017 | MM | | | 11 | Field Review | | |
| | | | | | | | | | 11-29-2011 | MM | | | 11 | Field Review | | |
| LAND LINE VALUATION SECTION | | | | | | | | | | | | | | | | |
| B | Use Code | Description | Zone | Land Type | Land Units | Unit Price | Size Adj | Site Index | Cond. | Nbhd. | Nbhd. Adj | Notes | Location Adjustment | Adj Unit P | Land Value | |
| 1 | 1010 | SINGL FAM M-0 | BII | | 6,653 SF | 40.49 | 1.00000 | 4 | 0.95 | 0050 | 1.800 | SHAPE/ACCESS | | 69.24 | 460,600 | |
| Total Card Land Units | | | | | 0.15 AC | Parcel Total Land Area | | | | | 0.15 | Total Land Value | | | 460,600 | |

| CONSTRUCTION DETAIL | | | CONSTRUCTION DETAIL (CONTINUED) | | |
|--------------------------------|------|----------------|---------------------------------|-----|-------------|
| Element | Cd | Description | Element | Cd | Description |
| Style: | 03 | Colonial | | | |
| Model | 01 | Residential | | | |
| Grade: | 04 | Above Ave | | | |
| Stories: | 2 | 1 Story | | | |
| Occupancy | 1 | | | | |
| Exterior Wall 1 | 14 | Wood Shingle | | | |
| Exterior Wall 2 | | | | | |
| RooF Structure: | 03 | Gable/Hip | | | |
| RooF Cover | 03 | Asph/F Gls/Cmp | | | |
| Interior Wall 1 | 05 | Drywall/Sheet | | | |
| Interior Wall 2 | | | | | |
| Interior Flr 1 | 14 | Carpet | | | |
| Interior Flr 2 | 12 | Hardwood | | | |
| Heat Fuel | 02 | Oil | | | |
| Heat Type: | 05 | Hot Water | | | |
| AC Type: | 01 | None | | | |
| Total Bedrooms | 02 | 2 Bedrooms | | | |
| Total Bthrms: | 1 | | | | |
| Total Half Baths | 0 | | | | |
| Total Xtra Fixtrs | | | | | |
| Total Rooms: | 5 | | | | |
| Bath Style: | 03 | Modern | | | |
| Kitchen Style: | 03 | Luxurious | | | |
| CONDO DATA | | | | | |
| Parcel Id | | C | Owne | 0.0 | |
| Adjust Type | Code | Description | Factor% | | |
| Condo Flr | | | | | |
| Condo Unit | | | | | |
| COST / MARKET VALUATION | | | | | |
| Building Value New | | 678,784 | | | |
| Year Built | | 1970 | | | |
| Effective Year Built | | 2017 | | | |
| Depreciation Code | | R | | | |
| Remodel Rating | | | | | |
| Year Remodeled | | | | | |
| Depreciation % | | 5 | | | |
| Functional Obsol | | 0 | | | |
| External Obsol | | 0 | | | |
| Trend Factor | | 1 | | | |
| Condition | | | | | |
| Condition % | | | | | |
| Percent Good | | 95 | | | |
| Cns Sect Rcnd | | 644,800 | | | |
| Dep % Ovr | | | | | |
| Dep Ovr Comment | | | | | |
| Misc Imp Ovr | | | | | |
| Misc Imp Ovr Comment | | | | | |
| Cost to Cure Ovr | | | | | |
| Cost to Cure Ovr Comment | | | | | |

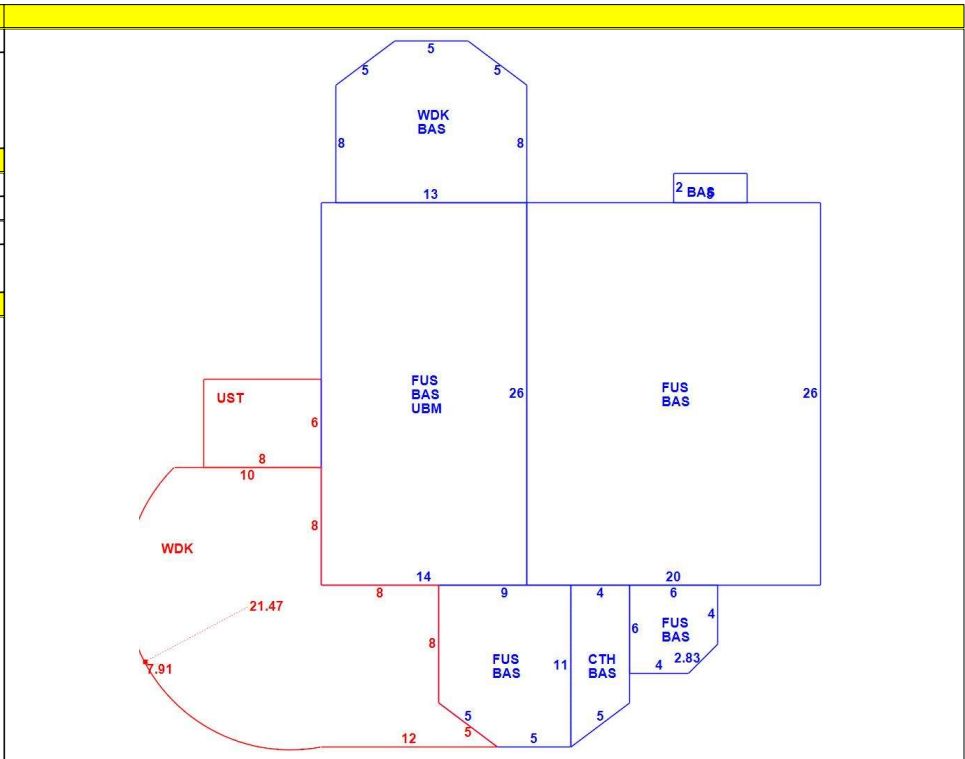

| OB - OUTBUILDING & YARD ITEMS(L) / XF - BUILDING EXTRA FEATURES(B) | | | | | | | | | | |
|--|-------------|-----|-------|------------|--------|----------|------|-------|------------|-------------|
| Code | Description | L/B | Units | Unit Price | Yr Blt | Cond. Cd | % Gd | Grade | Grade Adj. | Appr. Value |
| SHD1 | SHED FRAME | L | 120 | 16.00 | 2020 | | 80 | | 0.00 | 1,500 |

| BUILDING SUB-AREA SUMMARY SECTION | | | | | | |
|-----------------------------------|------------------------------|-------------|------------|----------|-----------|----------------|
| Code | Description | Living Area | Floor Area | Eff Area | Unit Cost | Undeprec Value |
| BAS | First Floor | 1,190 | 1,190 | 1,190 | 289.71 | 344,751 |
| CTH | Cath Cing | 0 | 38 | 2 | 15.25 | 579 |
| FUS | Upper Story, Finished | 1,011 | 1,011 | 1,011 | 289.71 | 292,894 |
| UBM | Basement, Unfinished | 0 | 364 | 73 | 58.10 | 21,149 |
| UST | Utility, Storage, Unfinished | 0 | 48 | 22 | 132.78 | 6,374 |
| WDK | Deck, Wood | 0 | 445 | 45 | 29.30 | 13,037 |
| Ttl Gross Liv / Lease Area | | 2,201 | 3,096 | 2,343 | | 678,784 |

