

| CURRENT OWNER | | TOPO | UTILITIES | STRT / ROAD | LOCATION | CURRENT ASSESSMENT | | | | 1302 EDGARTOWN, MA | | | | | | |
|---|------------|---|----------------------------------|--------------------------|-------------|--------------------|---|--------------------------------|------------|-----------------------|-----------|-------|---------------------|-----------------------|------------|-----------|
| SOUTHWORTH EDWARD B III & SOU SOROTA LAURA S--TRS & SOROTA B PO BOX 484 | | | 2 Public Water 3 Public Sewer | 9 Town Street 1 Paved | | Description | Code | Appraised | Assessed | | | | | | | |
| EDGARTOWN MA 02539 | | SUPPLEMENTAL DATA | | | | RESIDENTL | 1010 | 1,290,000 | 1,290,000 | VISION | | | | | | |
| Alt Prcl ID PLN#/Rec Lot# Plan Notes Plan Notes Plan Notes GIS ID M_282888_794024 | | Restriction Hist Distrct X Other Note UC-Misc 1 UC-Misc 2 Assoc Pid# | | | | RES LND | 1010 | 1,761,300 | 1,761,300 | | | | | | | |
| | | | | | | Total | | 3,051,300 | 3,051,300 | | | | | | | |
| RECORD OF OWNERSHIP | | BK-VOL/PAGE | SALE DATE | Q/U | V/I | SALE PRICE | VC | PREVIOUS ASSESSMENTS (HISTORY) | | | | | | | | |
| SOUTHWORTH EDWARD B III & SOUTHWO | | 1590 647 | 08-11-2021 | U | I | 10 | 1J | Year | Code | Assessed | Year | Code | Assessed | | | |
| SOUTHWORTH DOROTHEA P EDWARD B III | | 1057 0273 | 09-26-2005 | U | I | 1 | 1A | 2023 | 1010 | 1,334,000 | 2022 | 1010 | 1,304,200 | | | |
| SOUTHWORTH DOROTHEA P | | 000D 5737 | 03-05-1980 | | | 0 | | | 1010 | 1,789,300 | 2021 | 1010 | 1,601,200 | | | |
| | | Total | | | | | | Total | | 3,123,300 | Total | | 3,219,300 | | | |
| | | | | | | | | Total | | 2,700,400 | | | | | | |
| EXEMPTIONS | | | OTHER ASSESSMENTS | | | | This signature acknowledges a visit by a Data Collector or Assessor | | | | | | | | | |
| Year | Code | Description | Amount | Code | Description | Number | Amount | Comm Int | | | | | | | | |
| | | | 0.00 | | | | | | | | | | | | | |
| | | Total | 0.00 | | | | | | | | | | | | | |
| ASSESSING NEIGHBORHOOD | | | | | | | | | | | | | | | | |
| Nbhd | | Nbhd Name | | B | | Tracing | | Batch | | | | | | | | |
| DTN9 | | | | | | | | | | | | | | | | |
| NOTES | | | | | | | | | | | | | | | | |
| COTTAGE ST | | | | | | | | | | | | | | | | |
| BUILDING PERMIT RECORD | | | | | | | | | | | | | | | | |
| Permit Id | Issue Date | Type | Description | Amount | Insp Date | % Comp | Date Comp | Comments | Date | Id | Type | Is | Cd | Purpost/Result | | |
| | | | | | | | | | 09-15-2022 | EH | | 6 | 01 | Cyclical Reinspection | | |
| | | | | | | | | | 05-17-2022 | DM | | | 11 | Field Review | | |
| | | | | | | | | | 05-18-2017 | MM | | | 11 | Field Review | | |
| | | | | | | | | | 06-17-2014 | MM | | | 11 | Field Review | | |
| | | | | | | | | | 11-17-2011 | MM | | | 11 | Field Review | | |
| | | | | | | | | | 12-07-2006 | EP | | | 51 | Cyclical Reinspection | | |
| | | | | | | | | | 10-26-2000 | WP | | | 43 | Cyclical Reinspection | | |
| LAND LINE VALUATION SECTION | | | | | | | | | | | | | | | | |
| B | Use Code | Description | Zone | Land Type | Land Units | Unit Price | Size Adj | Site Index | Cond. | Nbhd. | Nbhd. Adj | Notes | Location Adjustment | Adj Unit P | Land Value | |
| 1 | 1010 | SINGL FAM M-0 | R5 | | 9,270 SF | 31.67 | 1.00000 | 9 | 1.00 | 0100 | 6.000 | | | 190 | 1,761,300 | |
| Total Card Land Units | | | | | 0.21 | AC | Parcel Total Land Area | | | | | 0.21 | Total Land Value | | | 1,761,300 |

| CONSTRUCTION DETAIL | | | CONSTRUCTION DETAIL (CONTINUED) | | |
|--------------------------------|------|-------------------|---------------------------------|-----------|-------------|
| Element | Cd | Description | Element | Cd | Description |
| Style: | 09 | Historical Custom | | | |
| Model | 01 | Residential | | | |
| Grade: | 07 | Very Good | | | |
| Stories: | 2 | 2 Stories | | | |
| Occupancy | 1 | | | | |
| Exterior Wall 1 | 14 | Wood Shingle | | | |
| Exterior Wall 2 | | | | | |
| Roof Structure: | 03 | Gable/Hip | | | |
| Roof Cover | 03 | Asph/F Gls/Cmp | | | |
| Interior Wall 1 | 03 | Plastered | | | |
| Interior Wall 2 | | | | | |
| Interior Flr 1 | 12 | Hardwood | | | |
| Interior Flr 2 | 09 | Pine/Soft Wood | | | |
| Heat Fuel | 02 | Oil | | | |
| Heat Type: | 05 | Hot Water | | | |
| AC Type: | 01 | None | | | |
| Total Bedrooms | 04 | 4 Bedrooms | | | |
| Total Bthrms: | 2 | | | | |
| Total Half Baths | 1 | | | | |
| Total Xtra Fixtrs | | | | | |
| Total Rooms: | 9 | | | | |
| Bath Style: | 02 | Average | | | |
| Kitchen Style: | 02 | Modern | | | |
| CONDO DATA | | | | | |
| Parcel Id | | C | | Owne | 0.0 |
| | | | | B | S |
| Adjust Type | Code | Description | Factor% | | |
| Condo Flr | | | | | |
| Condo Unit | | | | | |
| COST / MARKET VALUATION | | | | | |
| Building Value New | | | | 1,709,628 | |
| Year Built | | | | 1890 | |
| Effective Year Built | | | | 1997 | |
| Depreciation Code | | | | G | |
| Remodel Rating | | | | | |
| Year Remodeled | | | | | |
| Depreciation % | | | | 25 | |
| Functional Obsol | | | | 0 | |
| External Obsol | | | | 0 | |
| Trend Factor | | | | 1 | |
| Condition | | | | | |
| Condition % | | | | | |
| Percent Good | | | | 75 | |
| Cns Sect Rcnd | | | | 1,282,200 | |
| Dep % Ovr | | | | | |
| Dep Ovr Comment | | | | | |
| Misc Imp Ovr | | | | | |
| Misc Imp Ovr Comment | | | | | |
| Cost to Cure Ovr | | | | | |
| Cost to Cure Ovr Comment | | | | | |

UBM
(343 sf)

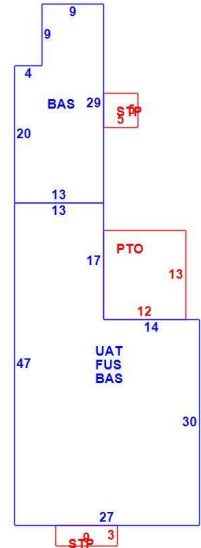

| OB - OUTBUILDING & YARD ITEMS(L) / XF - BUILDING EXTRA FEATURES(B) | | | | | | | | | | |
|--|-------------|-----|-------|------------|--------|----------|------|-------|------------|-------------|
| Code | Description | L/B | Units | Unit Price | Yr Blt | Cond. Cd | % Gd | Grade | Grade Adj. | Appr. Value |
| FPL1 | FPL MSNRY 1 | B | 1 | 3000.00 | 1991 | | 75 | | 0.00 | 2,300 |
| FPL3 | FPL MSNRY 2 | B | 1 | 4000.00 | 1991 | | 75 | | 0.00 | 3,000 |
| FGR1 | GAR 1ST-AVE | L | 200 | 25.00 | 1960 | | 50 | | 0.00 | 2,500 |

| BUILDING SUB-AREA SUMMARY SECTION | | | | | | | |
|-----------------------------------|-----------------------|-------------|------------|----------|-----------|----------------|--|
| Code | Description | Living Area | Floor Area | Eff Area | Unit Cost | Undeprec Value | |
| BAS | First Floor | 1,372 | 1,372 | 1,372 | 654.08 | 897,404 | |
| FUS | Upper Story, Finished | 1,031 | 1,031 | 1,031 | 654.08 | 674,361 | |
| PTO | Patio | 0 | 156 | 16 | 67.09 | 10,465 | |
| STP | Stoop | 0 | 52 | 5 | 62.89 | 3,270 | |
| UAT | Attic, Unfinished | 0 | 1,031 | 103 | 65.35 | 67,371 | |
| UBM | Basement, Unfinished | 0 | 343 | 69 | 131.58 | 45,132 | |
| Ttl Gross Liv / Lease Area | | 2,403 | 3,985 | 2,596 | | 1,698,003 | |

