

| CURRENT OWNER               |            | TOPO            | UTILITIES         | STRT / ROAD  | LOCATION    | CURRENT ASSESSMENT  |            |                               |                                | 1302<br>EDGARTOWN, MA |           |                  |                     |                       |            |
|-----------------------------|------------|-----------------|-------------------|--------------|-------------|---|------------|-------------------------------|--------------------------------|-----------------------|-----------|------------------|---------------------|-----------------------|------------|
| BREWER PAUL C & DEBORAH     |            | 3               | Public Sewer      |              |             | Description   | Code       | Appraised                     | Assessed                       |                       |           |                  |                     |                       |            |
| PO BOX 1893                 |            |                 |                   |              |             | RESIDENTL   | 1090       | 1,094,000                     | 1,094,000                      | VISION                |           |                  |                     |                       |            |
| EDGARTOWN MA 02539          |            |                 |                   |              |             | RES LND   | 1090       | 245,000                       | 245,000                        |                       |           |                  |                     |                       |            |
| SUPPLEMENTAL DATA           |            |                 |                   |              |             | Total   |            | 1,339,000                     | 1,339,000                      |                       |           |                  |                     |                       |            |
| Alt Prcl ID                 |            | Restriction     |                   | Hist Distrct |             |   |            |                               |                                |                       |           |                  |                     |                       |            |
| PLN#/Rec                    |            | Other Note      |                   | UC-Misc 1    |             |   |            |                               |                                |                       |           |                  |                     |                       |            |
| Lot#                        |            | UC-Misc 2       |                   | Assoc Pid#   |             |   |            |                               |                                |                       |           |                  |                     |                       |            |
| Plan Notes                  |            |                 |                   |              |             |   |            |                               |                                |                       |           |                  |                     |                       |            |
| Plan Notes                  |            |                 |                   |              |             |   |            |                               |                                |                       |           |                  |                     |                       |            |
| Plan Notes                  |            |                 |                   |              |             |   |            |                               |                                |                       |           |                  |                     |                       |            |
| GIS ID                      |            | M_279100_793683 |                   |              |             |   |            |                               |                                |                       |           |                  |                     |                       |            |
| RECORD OF OWNERSHIP         |            |                 | BK-VOL/PAGE       | SALE DATE    | Q/U         | V/I   | SALE PRICE | VC                            | PREVIOUS ASSESSMENTS (HISTORY) |                       |           |                  |                     |                       |            |
| BREWER PAUL C & DEBORAH     |            |                 | 00411 0742        | 02-22-1984   | Q           | V   | 17,500     | 00                            | Year                           | Code                  | Assessed  | Year             | Code                | Assessed              |            |
| LAMOUREUX DONALD P          |            |                 | 0332 0480         | 04-09-1976   |             |   | 0          |                               | 2023                           | 1090                  | 1,106,200 | 2022             | 1090                | 720,400               |            |
| WALTERS STEPHEN R           |            |                 | 0324 2560         | 03-20-1975   |             |   | 13,900     |                               |                                | 1090                  | 300,100   | 2021             | 1090                | 288,000               |            |
|                             |            | Total           |                   |              |             |   |            |                               |                                | 1,406,300             | Total     | 1,037,100        | Total               | 1,008,400             |            |
| EXEMPTIONS                  |            |                 | OTHER ASSESSMENTS |              |             | This signature acknowledges a visit by a Data Collector or Assessor |            |                               |                                |                       |           |                  |                     |                       |            |
| Year                        | Code       | Description     | Amount            | Code         | Description | Number  | Amount     | Comm Int                      |                                |                       |           |                  |                     |                       |            |
| Total                       |            |                 | 0.00              |              |             |   |            |                               |                                |                       |           |                  |                     |                       |            |
| ASSESSING NEIGHBORHOOD      |            |                 |                   |              |             | APPRAISED VALUE SUMMARY   |            |                               |                                |                       |           |                  |                     |                       |            |
| Nbhd                        | Nbhd Name  | B               | Tracing           | Batch        |             |   |            |                               | Appraised Bldg. Value (Card)   |                       | 1,090,900 |                  |                     |                       |            |
| 0030                        |            |                 |                   |              |             |   |            |                               | Appraised Xf (B) Value (Bldg)  |                       | 1,700     |                  |                     |                       |            |
|                             |            |                 |                   |              |             |   |            | Appraised Ob (B) Value (Bldg) |                                | 1,400                 |           |                  |                     |                       |            |
|                             |            |                 |                   |              |             |   |            | Appraised Land Value (Bldg)   |                                | 245,000               |           |                  |                     |                       |            |
|                             |            |                 |                   |              |             |   |            | Special Land Value            |                                | 0                     |           |                  |                     |                       |            |
|                             |            |                 |                   |              |             |   |            | Total Appraised Parcel Value  |                                | 1,339,000             |           |                  |                     |                       |            |
|                             |            |                 |                   |              |             |   |            | Valuation Method              |                                | C                     |           |                  |                     |                       |            |
|                             |            |                 |                   |              |             |   |            | Total Appraised Parcel Value  |                                | 1,339,000             |           |                  |                     |                       |            |
| BUILDING PERMIT RECORD      |            |                 |                   |              |             | VISIT / CHANGE HISTORY  |            |                               |                                |                       |           |                  |                     |                       |            |
| Permit Id                   | Issue Date | Type            | Description       | Amount       | Insp Date   | % Comp  | Date Comp  | Comments                      | Date                           | Id                    | Type      | Is               | Cd                  | Purpost/Result        |            |
| 669-2021                    | 07-06-2021 | CO              | CO ISSUED         |              |             |   |            |                               | 11-01-2022                     | EH                    |           | 6                | 01                  | Cyclical Reinspection |            |
| 2021-669                    | 03-19-2021 | RA              | Res Add/Alter     | 30,000       |             |   |            | ADD BED/BATH TO BSMNT         | 06-02-2022                     | DM                    |           |                  | 11                  | Field Review          |            |
| 2006:280                    | 05-01-2006 | RN              | Res New Cons      |              |             |   |            | GARAGE APARTMENT              | 05-18-2017                     | AU                    |           |                  | 11                  | Field Review          |            |
|                             |            |                 |                   |              |             |   |            |                               | 11-16-2011                     | RK                    |           |                  | 11                  | Field Review          |            |
|                             |            |                 |                   |              |             |   |            |                               | 04-29-2004                     | JB                    |           |                  | 01                  | Cyclical Reinspection |            |
|                             |            |                 |                   |              |             |   |            |                               | 09-18-1978                     |                       |           |                  |                     |                       |            |
| LAND LINE VALUATION SECTION |            |                 |                   |              |             |   |            |                               |                                |                       |           |                  |                     |                       |            |
| B                           | Use Code   | Description     | Zone              | Land Type    | Land Units  | Unit Price  | Size Adj   | Site Index                    | Cond.                          | Nbhd.                 | Nbhd. Adj | Notes            | Location Adjustment | Adj Unit P            | Land Value |
| 1                           | 1090       | MULTI HSES      | R60               |              | 30,010 SF   | 11.66   | 1.00000    | 3                             | 1.00                           | 0030                  | 0.700     |                  |                     | 8.16                  | 245,000    |
| Total Card Land Units       |            |                 |                   |              | 0.69 AC     | Parcel Total Land Area  |            |                               |                                |                       | 0.69      | Total Land Value |                     |                       | 245,000    |

| CONSTRUCTION DETAIL |      |                | CONSTRUCTION DETAIL (CONTINUED) |      |             |
|---------------------|------|----------------|---------------------------------|------|-------------|
| Element             | Cd   | Description    | Element                         | Cd   | Description |
| Style:              | 03   | Colonial       |                                 |      |             |
| Model               | 01   | Residential    |                                 |      |             |
| Grade:              | 04   | Above Ave      |                                 |      |             |
| Stories:            | 1.75 |                |                                 |      |             |
| Occupancy           | 1    |                |                                 |      |             |
| Exterior Wall 1     | 11   | Clapboard      |                                 |      |             |
| Exterior Wall 2     |      |                |                                 |      |             |
| Roof Structure:     | 03   | Gable/Hip      |                                 |      |             |
| Roof Cover          | 03   | Asph/F Gls/Cmp |                                 |      |             |
| Interior Wall 1     | 05   | Drywall/Sheet  |                                 |      |             |
| Interior Wall 2     | 06   | Cust Wd Panel  |                                 |      |             |
| Interior Flr 1      | 14   | Carpet         |                                 |      |             |
| Interior Flr 2      |      |                |                                 |      |             |
| Heat Fuel           | 03   | Gas            |                                 |      |             |
| Heat Type:          | 05   | Hot Water      |                                 |      |             |
| AC Type:            | 02   | Heat Pump      |                                 |      |             |
| Total Bedrooms      | 03   | 3 Bedrooms     |                                 |      |             |
| Total Bthrms:       | 1    |                |                                 |      |             |
| Total Half Baths    | 1    |                |                                 |      |             |
| Total Xtra Fixtrs   |      |                |                                 |      |             |
| Total Rooms:        | 5    |                |                                 |      |             |
| Bath Style:         | 02   | Average        |                                 |      |             |
| Kitchen Style:      | 02   | Modern         |                                 |      |             |
|                     |      |                | <b>CONDO DATA</b>               |      |             |
|                     |      |                | Parcel Id                       | C    | Ownr 0.0    |
|                     |      |                |                                 | B    | S           |
|                     |      |                | Adjust Type                     | Code | Description |
|                     |      |                | Condo Flr                       |      |             |
|                     |      |                | Condo Unit                      |      |             |
|                     |      |                | <b>COST / MARKET VALUATION</b>  |      |             |
|                     |      |                | Building Value New              |      | 722,315     |
|                     |      |                | Year Built                      |      | 1984        |
|                     |      |                | Effective Year Built            |      | 2007        |
|                     |      |                | Depreciation Code               |      | A           |
|                     |      |                | Remodel Rating                  |      |             |
|                     |      |                | Year Remodeled                  |      |             |
|                     |      |                | Depreciation %                  |      | 15          |
|                     |      |                | Functional Obsol                |      | 0           |
|                     |      |                | External Obsol                  |      | 0           |
|                     |      |                | Trend Factor                    |      | 1           |
|                     |      |                | Condition                       |      |             |
|                     |      |                | Condition %                     |      |             |
|                     |      |                | Percent Good                    |      | 85          |
|                     |      |                | Cns Sect Rcnd                   |      | 614,000     |
|                     |      |                | Dep % Ovr                       |      |             |
|                     |      |                | Dep Ovr Comment                 |      |             |
|                     |      |                | Misc Imp Ovr                    |      |             |
|                     |      |                | Misc Imp Ovr Comment            |      |             |
|                     |      |                | Cost to Cure Ovr                |      |             |
|                     |      |                | Cost to Cure Ovr Comment        |      |             |

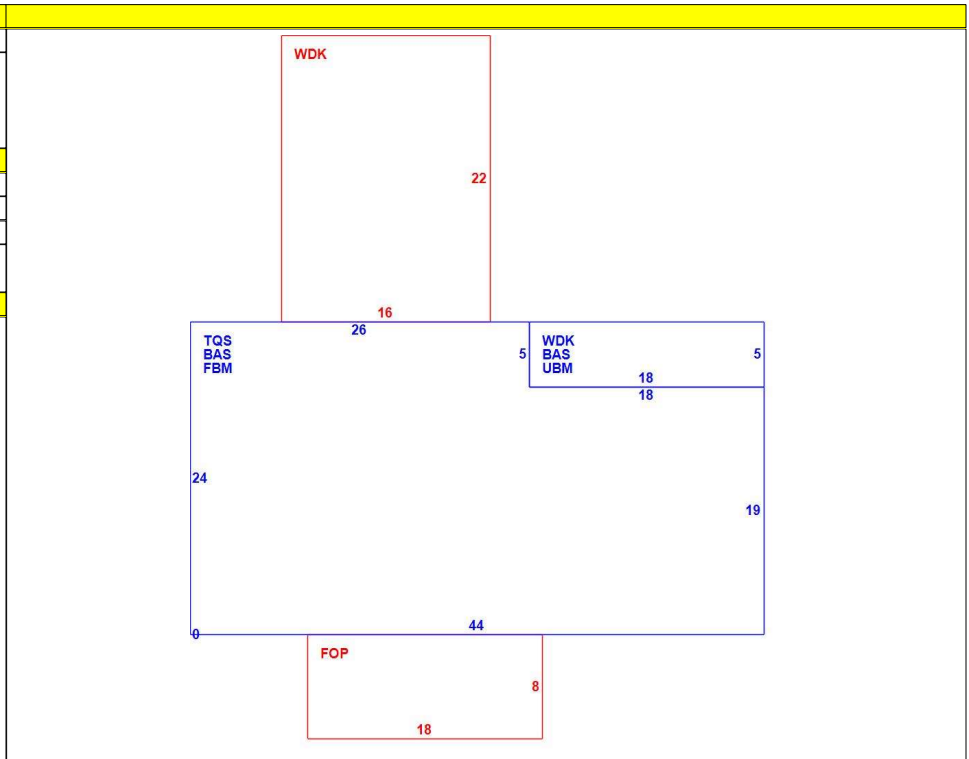

**OB - OUTBUILDING & YARD ITEMS(L) / XF - BUILDING EXTRA FEATURES(B)**

| Code | Description | L/B | Units | Unit Price | Yr Blt | Cond. Cd | % Gd | Grade | Grade Adj. | Appr. Value |
|------|-------------|-----|-------|------------|--------|----------|------|-------|------------|-------------|
| SHED | SHED FRAME  | L   | 1     | 1000.00    | 1999   |          | 70   |       | 0.00       | 700         |
| SHED | SHED FRAME  | L   | 1     | 1000.00    | 1999   |          | 70   |       | 0.00       | 700         |
| FPL5 | GAS VENTED  | B   | 1     | 2000.00    |        |          | 85   |       | 0.00       | 1,700       |

**BUILDING SUB-AREA SUMMARY SECTION**

| Code                       | Description           | Living Area | Floor Area | Eff Area | Unit Cost | Undeprec Value |
|----------------------------|-----------------------|-------------|------------|----------|-----------|----------------|
| BAS                        | First Floor           | 1,056       | 1,056      | 1,056    | 311.91    | 329,372        |
| FBM                        | Basement, Finished    | 0           | 966        | 435      | 140.45    | 135,679        |
| FOP                        | Porch, Open, Finished | 0           | 144        | 29       | 62.81     | 9,045          |
| TQS                        | Three Quarter Story   | 725         | 966        | 725      | 234.09    | 226,131        |
| UBM                        | Basement, Unfinished  | 0           | 90         | 18       | 62.38     | 5,614          |
| WDK                        | Deck, Wood            | 0           | 442        | 44       | 31.05     | 13,724         |
| Ttl Gross Liv / Lease Area |                       | 1,781       | 3,664      | 2,307    |           | 719,565        |





