

| CURRENT OWNER  |            | TOPO                                | UTILITIES                              | STRT / ROAD | LOCATION    | CURRENT ASSESSMENT  |   |                                |              | 1302<br>EDGARTOWN, MA |           |              |                      |                       |            |         |
|--|------------|-------------------------------------|--|-------------|-------------|---|---|--------------------------------|--------------|-----------------------|-----------|--------------|----------------------|-----------------------|------------|---------|
| BOUCHARD SARAH E<br>FESNAK FRANK C<br>242 RIVER ROAD<br>GLADWYNE PA 19035  |            |                                     | 2 Public Water<br>3 Public Sewer       |             |             | Description   | Code  | Appraised                      | Assessed     |                       |           |              |                      |                       |            |         |
|  |            |                                     |  |             |             | RESIDENTL   | 1090  | 2,535,500                      | 2,535,500    | <b>VISION</b>         |           |              |                      |                       |            |         |
|  |            |                                     |  |             |             | RES LND   | 1090  | 573,600                        | 573,600      |                       |           |              |                      |                       |            |         |
| <b>SUPPLEMENTAL DATA</b>   |            |                                     |  |             |             |   |   |                                |              |                       |           |              |                      |                       |            |         |
| Alt Prcl ID<br>PLN#/Rec CF 388 MONTRACHET<br>Lot# 11<br>Plan Notes<br>Plan Notes<br>Plan Notes<br>GIS ID M_280415_792926 |            |                                     |  |             |             | Restriction<br>Hist Distrct<br>Other Note<br>UC-Misc 1<br>UC-Misc 2<br>Assoc Pid# |   |                                |              |                       |           |              |                      |                       |            |         |
|  |            |                                     |  |             |             | Total   |   | 3,109,100                      | 3,109,100    |                       |           |              |                      |                       |            |         |
| RECORD OF OWNERSHIP  |            | BK-VOL/PAGE                         | SALE DATE                              | Q/U         | V/I         | SALE PRICE  | VC  | PREVIOUS ASSESSMENTS (HISTORY) |              |                       |           |              |                      |                       |            |         |
| BOUCHARD SARAH E   |            | 1606 766                            | 12-10-2021                             | Q           | I           | 3,250,000   | 00  | Year                           | Code         | Assessed              | Year      | Code         | Assessed             |                       |            |         |
| JONES BRIAN DANIEL &<br>FEEKS JOSEPH B & SUSANNE J<br>DZMURA ANDREW P & THERESA K  |            | 1374 0624<br>0683 0820<br>0458 0492 | 04-28-2015<br>08-23-1996<br>10-21-1986 | Q<br>Q<br>Q | I<br>I<br>I | 1,110,000<br>188,500<br>176,000   | 00<br>00<br>00  | 2023                           | 1090<br>1090 | 2,442,700<br>592,200  | 2022      | 1090<br>1090 | 1,414,800<br>303,300 |                       |            |         |
|  |            | Total                               |  |             |             |   |   | 3,034,900                      |              | Total                 |           | 1,718,100    |                      |                       |            |         |
|  |            |                                     |  |             |             |   |   | Total                          |              | Total                 |           | 1,704,100    |                      |                       |            |         |
| EXEMPTIONS   |            |                                     | OTHER ASSESSMENTS                      |             |             |   | This signature acknowledges a visit by a Data Collector or Assessor |                                |              |                       |           |              |                      |                       |            |         |
| Year   | Code       | Description                         | Amount                                 | Code        | Description | Number  | Amount  | Comm Int                       |              |                       |           |              |                      |                       |            |         |
|  |            |                                     | Total                                  |             |             |   |   | 0.00                           |              |                       |           |              |                      |                       |            |         |
| ASSESSING NEIGHBORHOOD   |            |                                     |  |             |             |   |   | APPRAISED VALUE SUMMARY        |              |                       |           |              |                      |                       |            |         |
| Nbhd   | Nbhd Name  | B                                   | Tracing                                | Batch       |             |   |   |                                |              |                       |           |              |                      |                       |            |         |
| 0050   |            |                                     |  |             |             |   |   |                                |              |                       |           |              |                      |                       |            |         |
| NOTES  |            |                                     |  |             |             |   |   |                                |              |                       |           |              |                      |                       |            |         |
| KIT (POSSIBLY MORE) RENO 2014  |            |                                     |  |             |             |   |   |                                |              |                       |           |              |                      |                       |            |         |
| BUILDING PERMIT RECORD   |            |                                     |  |             |             |   |   | VISIT / CHANGE HISTORY         |              |                       |           |              |                      |                       |            |         |
| Permit Id  | Issue Date | Type                                | Description                            | Amount      | Insp Date   | % Comp  | Date Comp   | Comments                       | Date         | Id                    | Type      | Is           | Cd                   | Purpost/Result        |            |         |
| 207-2018   | 12-20-2019 | CO                                  |  |             |             | 0   |   | RENO 570SF ADD 606SF           | 05-17-2022   | LS                    |           |              | 11                   | Field Review          |            |         |
| 2018-207   | 10-27-2017 | RA                                  | Res Add/Alter                          | 550,000     |             | 0   |   | RENO 570SF ADD 606SF           | 05-16-2022   | SF                    |           |              | 11                   | Field Review          |            |         |
| 2012-392   | 05-25-2012 | RA                                  | Res Add/Alter                          |             |             |   |   | INSULATION                     | 05-16-2017   | DM                    |           |              | 11                   | Field Review          |            |         |
| 2005:288   | 06-06-2005 | RA                                  | Res Add/Alter                          |             | 01-12-2006  | 95  |   | ADDITION TO SFR                | 12-16-2014   | EP                    |           |              | 01                   | Cyclical Reinspection |            |         |
| 2005:219   | 03-09-2005 | RA                                  | Res Add/Alter                          |             | 01-12-2006  | 100   |   | MINOR ALTERATION TO SFR        | 11-18-2011   | MM                    |           |              | 11                   | Field Review          |            |         |
|  |            |                                     |  |             |             |   |   |                                | 03-07-2006   | EP                    |           |              | 11                   | Field Review          |            |         |
|  |            |                                     |  |             |             |   |   |                                | 01-12-2006   | WP                    |           |              | 50                   | UC Status Inspection  |            |         |
| LAND LINE VALUATION SECTION  |            |                                     |  |             |             |   |   |                                |              |                       |           |              |                      |                       |            |         |
| B  | Use Code   | Description                         | Zone                                   | Land Type   | Land Units  | Unit Price  | Size Adj  | Site Index                     | Cond.        | Nbhd.                 | Nbhd. Adj | Notes        | Location Adjustment  | Adj Unit P            | Land Value |         |
| 1  | 1090       | MULTI HSES                          | R20                                    |             | 21,780      | SF 14.57  | 1.00000   | 4                              | 1.00         | 0050                  | 1.800     |              |                      | 26.23                 | 571,200    |         |
| 1  | 1090       | MULTI HSES                          | R20                                    |             | 0.040       | AC 34,000.00  | 1.00000   | 0                              | 1.00         | 0050                  | 1.800     |              |                      | 61,200                | 2,400      |         |
| Total Card Land Units  |            |                                     |  |             | 0.54        | AC  | Parcel Total Land Area  |                                |              |                       |           | 0.54         | Total Land Value     |                       |            | 573,600 |

| CONSTRUCTION DETAIL |     |                | CONSTRUCTION DETAIL (CONTINUED)      |    |             |
|---------------------|-----|----------------|--------------------------------------|----|-------------|
| Element             | Cd  | Description    | Element                              | Cd | Description |
| Style:              | 06  | Custom         |                                      |    |             |
| Model:              | 01  | Residential    |                                      |    |             |
| Grade:              | 07  | Good +10       |                                      |    |             |
| Stories:            | 1.5 | 1 1/2 Stories  |                                      |    |             |
| Occupancy:          | 1   |                |                                      |    |             |
| Exterior Wall 1:    | 14  | Wood Shingle   |                                      |    |             |
| Exterior Wall 2:    |     |                |                                      |    |             |
| Roof Structure:     | 03  | Gable/Hip      |                                      |    |             |
| Roof Cover:         | 03  | Asph/F Gls/Cmp |                                      |    |             |
| Interior Wall 1:    | 05  | Drywall/Sheet  |                                      |    |             |
| Interior Wall 2:    |     |                |                                      |    |             |
| Interior Flr 1:     | 12  | Hardwood       |                                      |    |             |
| Interior Flr 2:     | 14  | Carpet         |                                      |    |             |
| Heat Fuel:          | 03  | Gas            |                                      |    |             |
| Heat Type:          | 04  | Forced Air-Duc |                                      |    |             |
| AC Type:            | 02  | Heat Pump      |                                      |    |             |
| Total Bedrooms:     | 04  | 4 Bedrooms     |                                      |    |             |
| Total Bthrms:       | 4   |                |                                      |    |             |
| Total Half Baths:   | 1   |                |                                      |    |             |
| Total Xtra Fixtrs:  | 1   |                |                                      |    |             |
| Total Rooms:        | 6   |                |                                      |    |             |
| Bath Style:         | 02  | Average        |                                      |    |             |
| Kitchen Style:      | 02  | Modern         |                                      |    |             |
|                     |     |                | <b>CONDO DATA</b>                    |    |             |
|                     |     |                | Parcel Id                            | C  | Owne 0.0    |
|                     |     |                | Adjust Type Code Description Factor% |    |             |
|                     |     |                | Condo Flr                            | B  | S           |
|                     |     |                | Condo Unit                           |    |             |
|                     |     |                | <b>COST / MARKET VALUATION</b>       |    |             |
|                     |     |                | Building Value New                   |    | 2,343,182   |
|                     |     |                | Year Built                           |    | 1986        |
|                     |     |                | Effective Year Built                 |    | 2017        |
|                     |     |                | Depreciation Code                    |    | VG          |
|                     |     |                | Remodel Rating                       |    |             |
|                     |     |                | Year Remodeled                       |    | 2005        |
|                     |     |                | Depreciation %                       |    | 5           |
|                     |     |                | Functional Obsol                     |    | 0           |
|                     |     |                | External Obsol                       |    | 0           |
|                     |     |                | Trend Factor                         |    | 1           |
|                     |     |                | Condition                            |    |             |
|                     |     |                | Condition %                          |    |             |
|                     |     |                | Percent Good                         |    | 95          |
|                     |     |                | Cns Sect Rcnd                        |    | 2,226,000   |
|                     |     |                | Dep % Ovr                            |    |             |
|                     |     |                | Dep Ovr Comment                      |    |             |
|                     |     |                | Misc Imp Ovr                         |    |             |
|                     |     |                | Misc Imp Ovr Comment                 |    |             |
|                     |     |                | Cost to Cure Ovr                     |    |             |
|                     |     |                | Cost to Cure Ovr Comment             |    |             |

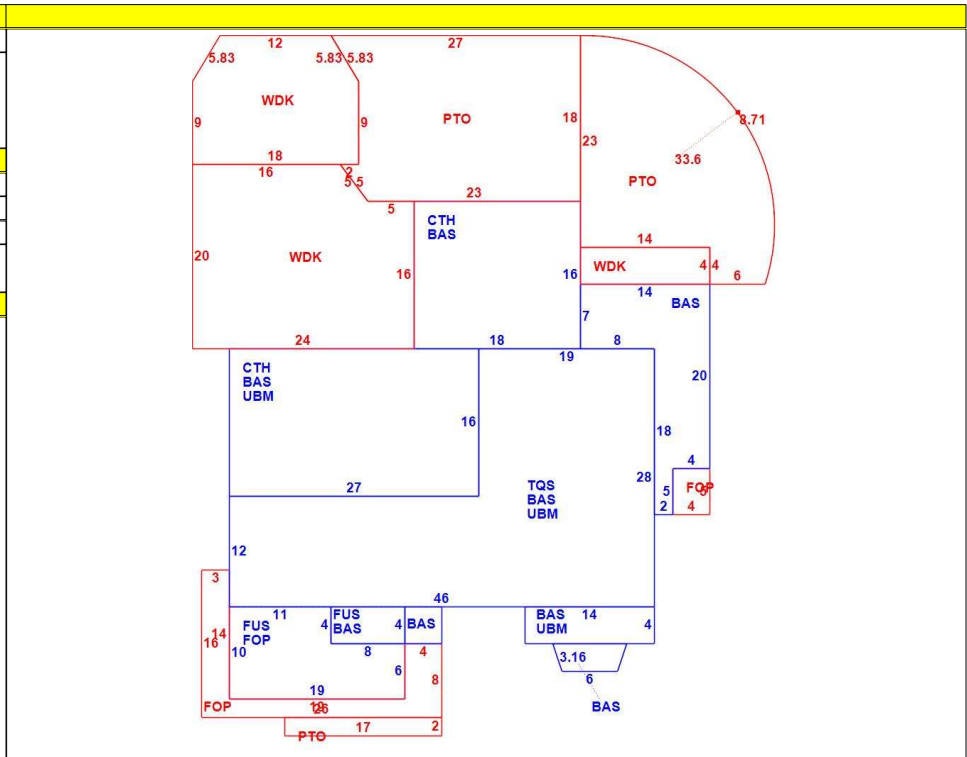

| OB - OUTBUILDING & YARD ITEMS(L) / XF - BUILDING EXTRA FEATURES(B) |             |     |       |            |        |          |      |       |            |             |
|--|-------------|-----|-------|------------|--------|----------|------|-------|------------|-------------|
| Code   | Description | L/B | Units | Unit Price | Yr Blt | Cond. Cd | % Gd | Grade | Grade Adj. | Appr. Value |
| ODS  | OUTDOOR S   | L   | 1     | 700.00     |        |          | 100  |       | 0.00       | 700         |
| FPL5   | GAS VENTED  | B   | 1     | 2000.00    | 2011   |          | 95   |       | 0.00       | 1,900       |

| BUILDING SUB-AREA SUMMARY SECTION |                       |             |            |          |           |                |
|-----------------------------------|-----------------------|-------------|------------|----------|-----------|----------------|
| Code                              | Description           | Living Area | Floor Area | Eff Area | Unit Cost | Undeprec Value |
| BAS                               | First Floor           | 1,887       | 1,887      | 1,887    | 712.69    | 1,344,846      |
| CTH                               | Cath Clng             | 0           | 720        | 36       | 35.63     | 25,657         |
| FOP                               | Porch, Open, Finished | 0           | 296        | 59       | 142.06    | 42,049         |
| FUS                               | Upper Story, Finished | 190         | 190        | 190      | 712.69    | 135,411        |
| PTO                               | Patio                 | 0           | 895        | 90       | 71.67     | 64,142         |
| TQS                               | Three Quarter Story   | 642         | 856        | 642      | 534.52    | 457,547        |
| UBM                               | Basement, Unfinished  | 0           | 1,344      | 269      | 142.64    | 191,714        |
| WDK                               | Deck, Wood            | 0           | 747        | 75       | 71.56     | 53,452         |
| Ttl Gross Liv / Lease Area        |                       | 2,719       | 6,935      | 3,248    |           | 2,314,818      |



| CURRENT OWNER   |            | TOPO                       | UTILITIES                        | STRT / ROAD  | LOCATION    | CURRENT ASSESSMENT  |                        |            |                                | 1302<br>EDGARTOWN, MA |           |                      |                     |                       |            |   |
|---|------------|----------------------------|----------------------------------|--------------|-------------|---|------------------------|------------|--------------------------------|-----------------------|-----------|----------------------|---------------------|-----------------------|------------|---|
| BOUCHARD SARAH E<br>FESNAK FRANK C<br>242 RIVER ROAD<br><br>GLADWYNE PA 19035 |            |                            | 2 Public Water<br>3 Public Sewer |              |             | Description   | Code                   | Appraised  | Assessed                       |                       |           |                      |                     |                       |            |   |
|   |            |                            |                                  |              |             | RESIDENTL   | 1090                   | 2,535,500  | 2,535,500                      | <b>VISION</b>         |           |                      |                     |                       |            |   |
|   |            |                            |                                  |              |             | RES LND   | 1090                   | 573,600    | 573,600                        |                       |           |                      |                     |                       |            |   |
| SUPPLEMENTAL DATA   |            |                            |                                  |              |             | Total   |                        | 3,109,100  | 3,109,100                      |                       |           |                      |                     |                       |            |   |
| Alt Prcl ID   |            | PLN#/Rec CF 388 MONTRACHET |                                  | Restriction  |             |   |                        |            |                                |                       |           |                      |                     |                       |            |   |
| Lot# 11   |            | Plan Notes                 |                                  | Hist Distrct |             |   |                        |            |                                |                       |           |                      |                     |                       |            |   |
| Plan Notes  |            | Plan Notes                 |                                  | Other Note   |             |   |                        |            |                                |                       |           |                      |                     |                       |            |   |
| Plan Notes  |            | GIS ID M_280415_792926     |                                  | UC-Misc 1    |             |   |                        |            |                                |                       |           |                      |                     |                       |            |   |
| Plan Notes  |            |                            |                                  | UC-Misc 2    |             |   |                        |            |                                |                       |           |                      |                     |                       |            |   |
|   |            |                            |                                  | Assoc Pid#   |             |   |                        |            |                                |                       |           |                      |                     |                       |            |   |
| RECORD OF OWNERSHIP   |            |                            | BK-VOL/PAGE                      | SALE DATE    | Q/U         | V/I   | SALE PRICE             | VC         | PREVIOUS ASSESSMENTS (HISTORY) |                       |           |                      |                     |                       |            |   |
| BOUCHARD SARAH E  |            |                            | 1606 766                         | 12-10-2021   | Q           | I   | 3,250,000              | 00         | Year                           | Code                  | Assessed  | Year                 | Code                | Assessed              |            |   |
| JONES BRIAN DANIEL &  |            |                            | 1374 0624                        | 04-28-2015   | Q           | I   | 1,110,000              | 00         | 2023                           | 1090                  | 2,442,700 | 2022                 | 1090                | 1,414,800             |            |   |
| FEEKS JOSEPH B & SUSANNE J  |            |                            | 0683 0820                        | 08-23-1996   | Q           | I   | 188,500                | 00         |                                | 1090                  | 592,200   |                      | 1090                | 303,300               |            |   |
| DZMURA ANDREW P & THERESA K   |            |                            | 0458 0492                        | 10-21-1986   | Q           | I   | 176,000                | 00         | Total                          |                       | 3,034,900 | Total                |                     | 1,718,100             |            |   |
|   |            |                            |                                  |              |             |   |                        |            |                                | Total                 |           | Total                |                     | 1,704,100             |            |   |
| EXEMPTIONS  |            |                            | OTHER ASSESSMENTS                |              |             | This signature acknowledges a visit by a Data Collector or Assessor |                        |            |                                |                       |           |                      |                     |                       |            |   |
| Year  | Code       | Description                | Amount                           | Code         | Description | Number  | Amount                 | Comm Int   |                                |                       |           |                      |                     |                       |            |   |
|   |            |                            |                                  |              |             |   |                        |            |                                |                       |           |                      |                     |                       |            |   |
| Total   |            |                            | 0.00                             |              |             |   |                        |            |                                |                       |           |                      |                     |                       |            |   |
| ASSESSING NEIGHBORHOOD  |            |                            |                                  |              |             | APPRAISED VALUE SUMMARY   |                        |            |                                |                       |           |                      |                     |                       |            |   |
| Nbhd  | Nbhd Name  | B                          | Tracing                          | Batch        |             |   |                        |            |                                |                       |           |                      |                     |                       |            |   |
| 0050  |            |                            |                                  |              |             |   |                        |            |                                |                       |           |                      |                     |                       |            |   |
| NOTES   |            |                            |                                  |              |             | Appraised Bldg. Value (Card) 2,530,400                              |                        |            |                                |                       |           |                      |                     |                       |            |   |
|   |            |                            |                                  |              |             | Appraised Xf (B) Value (Bldg) 3,700                                 |                        |            |                                |                       |           |                      |                     |                       |            |   |
|   |            |                            |                                  |              |             | Appraised Ob (B) Value (Bldg) 1,400                                 |                        |            |                                |                       |           |                      |                     |                       |            |   |
|   |            |                            |                                  |              |             | Appraised Land Value (Bldg) 573,600                                 |                        |            |                                |                       |           |                      |                     |                       |            |   |
|   |            |                            |                                  |              |             | Special Land Value 0  |                        |            |                                |                       |           |                      |                     |                       |            |   |
|   |            |                            |                                  |              |             | Total Appraised Parcel Value 3,109,100                              |                        |            |                                |                       |           |                      |                     |                       |            |   |
|   |            |                            |                                  |              |             | Valuation Method C  |                        |            |                                |                       |           |                      |                     |                       |            |   |
|   |            |                            |                                  |              |             | Total Appraised Parcel Value 3,109,100                              |                        |            |                                |                       |           |                      |                     |                       |            |   |
| BUILDING PERMIT RECORD  |            |                            |                                  |              |             | VISIT / CHANGE HISTORY  |                        |            |                                |                       |           |                      |                     |                       |            |   |
| Permit Id   | Issue Date | Type                       | Description                      | Amount       | Insp Date   | % Comp  | Date Comp              | Comments   | Date                           | Id                    | Type      | Is                   | Cd                  | Purpost/Result        |            |   |
|   |            |                            |                                  |              |             |   |                        |            | 09-10-2019                     | EP                    |           |                      | 01                  | Cyclical Reinspection |            |   |
| LAND LINE VALUATION SECTION   |            |                            |                                  |              |             |   |                        |            |                                |                       |           |                      |                     |                       |            |   |
| B   | Use Code   | Description                | Zone                             | Land Type    | Land Units  | Unit Price  | Size Adj               | Site Index | Cond.                          | Nbhd.                 | Nbhd. Adj | Notes                | Location Adjustment | Adj Unit P            | Land Value |   |
| 2   | 1090       | MULTI HSES                 |                                  |              | 0 SF        | 0.00  | 1.00000                | 0          | 1.00                           | 0050                  | 1.800     | FGR WITH LIVING SPC. |                     | 0                     | 0          |   |
| Total Card Land Units   |            |                            |                                  |              | 0.00        | AC  | Parcel Total Land Area |            |                                |                       |           | 0.54                 | Total Land Value    |                       |            | 0 |

| CONSTRUCTION DETAIL            |      |                | CONSTRUCTION DETAIL (CONTINUED) |     |             |
|--------------------------------|------|----------------|---------------------------------|-----|-------------|
| Element                        | Cd   | Description    | Element                         | Cd  | Description |
| Style:                         | 04   | Cape Cod       |                                 |     |             |
| Model                          | 01   | Residential    |                                 |     |             |
| Grade:                         | 03   | Average        |                                 |     |             |
| Stories:                       | 1.75 |                |                                 |     |             |
| Occupancy                      | 1    |                |                                 |     |             |
| Exterior Wall 1                | 14   | Wood Shingle   |                                 |     |             |
| Exterior Wall 2                |      |                |                                 |     |             |
| Roof Structure:                | 03   | Gable/Hip      |                                 |     |             |
| Roof Cover                     | 03   | Asph/F Gls/Cmp |                                 |     |             |
| Interior Wall 1                | 05   | Drywall/Sheet  |                                 |     |             |
| Interior Wall 2                |      |                |                                 |     |             |
| Interior Flr 1                 | 12   | Hardwood       |                                 |     |             |
| Interior Flr 2                 |      |                |                                 |     |             |
| Heat Fuel                      | 03   | Gas            |                                 |     |             |
| Heat Type:                     | 04   | Forced Air-Duc |                                 |     |             |
| AC Type:                       | 02   | Heat Pump      |                                 |     |             |
| Total Bedrooms                 | 01   | 1 Bedroom      |                                 |     |             |
| Total Bthrms:                  | 1    |                |                                 |     |             |
| Total Half Baths               | 0    |                |                                 |     |             |
| Total Xtra Fixtrs              |      |                |                                 |     |             |
| Total Rooms:                   | 1    |                |                                 |     |             |
| Bath Style:                    | 02   | Average        |                                 |     |             |
| Kitchen Style:                 | 02   | Modern         |                                 |     |             |
| <b>CONDO DATA</b>              |      |                |                                 |     |             |
| Parcel Id                      |      | C              | Owne                            | 0.0 |             |
|                                |      |                | B                               | S   |             |
| Adjust Type                    | Code | Description    | Factor%                         |     |             |
| Condo Flr                      |      |                |                                 |     |             |
| Condo Unit                     |      |                |                                 |     |             |
| <b>COST / MARKET VALUATION</b> |      |                |                                 |     |             |
| Building Value New             |      | 338,239        |                                 |     |             |
| Year Built                     |      | 2005           |                                 |     |             |
| Effective Year Built           |      | 2012           |                                 |     |             |
| Depreciation Code              |      | A              |                                 |     |             |
| Remodel Rating                 |      |                |                                 |     |             |
| Year Remodeled                 |      | 10             |                                 |     |             |
| Depreciation %                 |      |                |                                 |     |             |
| Functional Obsol               |      |                |                                 |     |             |
| External Obsol                 |      |                |                                 |     |             |
| Trend Factor                   |      | 1              |                                 |     |             |
| Condition                      |      |                |                                 |     |             |
| Condition %                    |      | 90             |                                 |     |             |
| Percent Good                   |      | 304,400        |                                 |     |             |
| Cns Sect Rcnd                  |      |                |                                 |     |             |
| Dep % Ovr                      |      |                |                                 |     |             |
| Dep Ovr Comment                |      |                |                                 |     |             |
| Misc Imp Ovr                   |      |                |                                 |     |             |
| Misc Imp Ovr Comment           |      |                |                                 |     |             |
| Cost to Cure Ovr               |      |                |                                 |     |             |
| Cost to Cure Ovr Comment       |      |                |                                 |     |             |

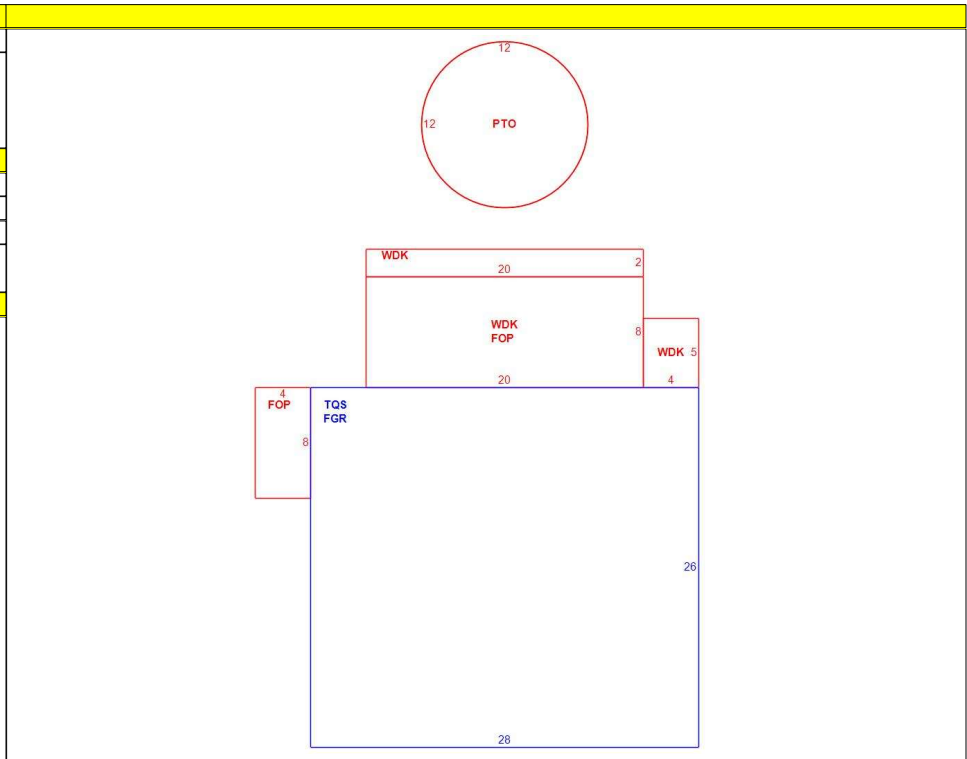

**OB - OUTBUILDING & YARD ITEMS(L) / XF - BUILDING EXTRA FEATURES(B)**

| Code | Description | L/B | Units | Unit Price | Yr Blt | Cond. Cd | % Gd | Grade | Grade Adj. | Appr. Value |
|------|-------------|-----|-------|------------|--------|----------|------|-------|------------|-------------|
| FPL5 | GAS VENTED  | B   | 1     | 2000.00    | 2011   |          | 90   |       | 0.00       | 1,800       |
| ODS  | OUTDOOR S   | L   | 1     | 700.00     | 2018   |          | 100  |       | 0.00       | 700         |

**BUILDING SUB-AREA SUMMARY SECTION**

| Code                       | Description           | Living Area | Floor Area | Eff Area | Unit Cost | Undeprec Value |
|----------------------------|-----------------------|-------------|------------|----------|-----------|----------------|
| FGR                        | Garage                | 0           | 728        | 291      | 148.90    | 108,400        |
| FOP                        | Porch, Open, Finished | 0           | 192        | 38       | 73.73     | 14,155         |
| PTO                        | Patio                 | 0           | 113        | 11       | 36.26     | 4,098          |
| TQS                        | Three Quarter Story   | 546         | 728        | 546      | 279.38    | 203,390        |
| WDK                        | Deck, Wood            | 0           | 220        | 22       | 37.25     | 8,195          |
| Ttl Gross Liv / Lease Area |                       | 546         | 1,981      | 908      |           | 338,238        |

