

| CURRENT OWNER                  |            | TOPO                     | UTILITIES         | STRT / ROAD  | LOCATION    | CURRENT ASSESSMENT |                        |   |            |       |           |                                |                     |                       |            |   |
|--------------------------------|------------|--------------------------|-------------------|--------------|-------------|--------------------|------------------------|---|------------|-------|-----------|--------------------------------|---------------------|-----------------------|------------|---|
| RUSSELL ALICE L                |            |                          |                   |              |             | Description        | Code                   | Appraised   | Assessed   |       |           |                                |                     |                       |            |   |
| PO BOX 445                     |            |                          |                   |              |             | CONDO              | 1020                   | 1,065,400   | 1,065,400  |       |           |                                |                     |                       |            |   |
| EDGARTOWN MA 02539             |            | <b>SUPPLEMENTAL DATA</b> |                   |              |             |                    |                        |   |            |       |           |                                |                     |                       |            |   |
| Alt Prcl ID                    |            | Restriction              |                   | Hist Distrct |             | Other Note         |                        |   |            |       |           |                                |                     |                       |            |   |
| PLN#/Rec                       |            | UC-Misc 1                |                   | UC-Misc 2    |             |                    |                        |   |            |       |           |                                |                     |                       |            |   |
| Lot#                           |            |                          |                   |              |             | Assoc Pid#         |                        |   |            |       |           |                                |                     |                       |            |   |
| Plan Notes                     |            |                          |                   |              |             | Total              |                        | 1,065,400   | 1,065,400  |       |           |                                |                     |                       |            |   |
| Plan Notes                     |            |                          |                   |              |             |                    |                        |   |            |       |           |                                |                     |                       |            |   |
| Plan Notes                     |            |                          |                   |              |             |                    |                        |   |            |       |           |                                |                     |                       |            |   |
| GIS ID M_279573_792721         |            |                          |                   |              |             |                    |                        |   |            |       |           |                                |                     |                       |            |   |
| RECORD OF OWNERSHIP            |            | BK-VOL/PAGE              | SALE DATE         | Q/U          | V/I         | SALE PRICE         | VC                     | PREVIOUS ASSESSMENTS (HISTORY)                                      |            |       |           |                                |                     |                       |            |   |
| RUSSELL ALICE L                |            | 0010                     | 0204              | 11-06-2018   | Q           | I                  | 535,000                | 00  | Year       | Code  | Assessed  | Year                           | Code                | Assessed              |            |   |
| CROFT DENNISE V & BADEY ALAN G |            | 0010                     | 0128              | 01-08-2015   | Q           | I                  | 467,500                | 00  | 2023       | 1020  | 539,900   | 2022                           | 1020                | 526,300               |            |   |
| OCONNELL TIMOTHY F & ELLEN R   |            | 00C6                     | 6252              | 10-01-2010   | Q           | I                  | 445,000                | 00  |            |       |           |                                |                     |                       |            |   |
| RANDOLPH INVESTMENT CO INC     |            | 00C2                     | 0617              | 06-10-1992   | Q           | I                  | 135,000                | 00  |            |       |           |                                |                     |                       |            |   |
|                                |            | 00C2                     | 0600              | 05-01-1987   | U           | I                  | 1,255,000              | 00  |            |       |           |                                |                     |                       |            |   |
|                                |            | Total                    |                   |              |             | 539,900            | Total                  |   | 526,300    |       | Total     |                                | 526,300             |                       |            |   |
| EXEMPTIONS                     |            |                          | OTHER ASSESSMENTS |              |             |                    |                        | This signature acknowledges a visit by a Data Collector or Assessor |            |       |           |                                |                     |                       |            |   |
| Year                           | Code       | Description              | Amount            | Code         | Description | Number             | Amount                 | Comm Int  |            |       |           |                                |                     |                       |            |   |
| Total                          |            | 0.00                     |                   |              |             |                    |                        |   |            |       |           |                                |                     |                       |            |   |
| ASSESSING NEIGHBORHOOD         |            |                          |                   |              |             |                    |                        |   |            |       |           | <b>APPRAISED VALUE SUMMARY</b> |                     |                       |            |   |
| Nbhd                           | Nbhd Name  |                          | B                 | Tracing      |             | Batch              |                        | Appraised Bldg. Value (Card)  |            |       |           |                                | 1,065,400           |                       |            |   |
| 0050                           |            |                          |                   |              |             |                    |                        | Appraised Xf (B) Value (Bldg)                                       |            |       |           |                                | 0                   |                       |            |   |
|                                |            |                          |                   |              |             |                    |                        | Appraised Ob (B) Value (Bldg)                                       |            |       |           |                                | 0                   |                       |            |   |
|                                |            |                          |                   |              |             |                    |                        | Appraised Land Value (Bldg)   |            |       |           |                                | 0                   |                       |            |   |
|                                |            |                          |                   |              |             |                    |                        | Special Land Value  |            |       |           |                                | 0                   |                       |            |   |
|                                |            |                          |                   |              |             |                    |                        | Total Appraised Parcel Value  |            |       |           |                                | 1,065,400           |                       |            |   |
|                                |            |                          |                   |              |             |                    |                        | Valuation Method  |            |       |           |                                | C                   |                       |            |   |
|                                |            |                          |                   |              |             |                    |                        | Total Appraised Parcel Value  |            |       |           |                                | 1,065,400           |                       |            |   |
| BUILDING PERMIT RECORD         |            |                          |                   |              |             |                    |                        |   |            |       |           | VISIT / CHANGE HISTORY         |                     |                       |            |   |
| Permit Id                      | Issue Date | Type                     | Description       | Amount       | Insp Date   | % Comp             | Date Comp              | Comments  | Date       | Id    | Type      | Is                             | Cd                  | Purpost/Result        |            |   |
|                                |            |                          |                   |              |             |                    |                        |   | 10-31-2022 | EH    |           | 6                              | 01                  | Cyclical Reinspection |            |   |
|                                |            |                          |                   |              |             |                    |                        |   | 05-18-2022 | LS    |           |                                | 11                  | Field Review          |            |   |
|                                |            |                          |                   |              |             |                    |                        |   | 05-24-2017 | DM    |           |                                | 11                  | Field Review          |            |   |
|                                |            |                          |                   |              |             |                    |                        |   | 05-17-2011 | EP    |           |                                | 01                  | Cyclical Reinspection |            |   |
|                                |            |                          |                   |              |             |                    |                        |   | 11-16-2010 | EP    |           |                                | 01                  | Cyclical Reinspection |            |   |
| LAND LINE VALUATION SECTION    |            |                          |                   |              |             |                    |                        |   |            |       |           |                                |                     |                       |            |   |
| B                              | Use Code   | Description              | Zone              | Land Type    | Land Units  | Unit Price         | Size Adj               | Site Index  | Cond.      | Nbhd. | Nbhd. Adj | Notes                          | Location Adjustment | Adj Unit P            | Land Value |   |
| 1                              | 1020       | CONDO M-05               | R20               |              | 0 SF        | 1.00               | 1.00000                | 0   | 1.00       |       | 1.000     |                                | 0.0000              | 1                     | 0          |   |
| Total Card Land Units          |            |                          |                   |              | 0.00        | AC                 | Parcel Total Land Area |   |            |       |           | 0.00                           | Total Land Value    |                       |            | 0 |

**VISION**

1302

EDGARTOWN, MA

| CONSTRUCTION DETAIL            |                |                | CONSTRUCTION DETAIL (CONTINUED) |           |             |
|--------------------------------|----------------|----------------|---------------------------------|-----------|-------------|
| Element                        | Cd             | Description    | Element                         | Cd        | Description |
| Style:                         | 55             | Condominium    |                                 |           |             |
| Model                          | 05             | Res Condo      |                                 |           |             |
| Grade                          | 05             | Average +20    |                                 |           |             |
| Stories:                       | 1.5            | 1 1/2 Stories  |                                 |           |             |
| Occupancy                      | 1              |                |                                 |           |             |
| Interior Wall 1:               | 05             | Drywall/Sheet  |                                 |           |             |
| Interior Wall 2:               |                |                |                                 |           |             |
| Interior Floor 1               | 14             | Carpet         |                                 |           |             |
| Interior Floor 2               | 12             | Hardwood       |                                 |           |             |
| Heat Fuel:                     | 02             | Oil            |                                 |           |             |
| Heat Type:                     | 04             | Forced Air-Duc |                                 |           |             |
| AC Type:                       | 02             | Heat Pump      |                                 |           |             |
| Ttl Bedrms:                    | 02             | 2 Bedrooms     |                                 |           |             |
| Ttl Bathrms:                   | 2              | 2 Full         |                                 |           |             |
| Ttl Half Bths:                 | 0              |                |                                 |           |             |
| Xtra Fixtres                   |                |                |                                 |           |             |
| Total Rooms:                   | 4              |                |                                 |           |             |
| Bath Style:                    | 02             | Average        |                                 |           |             |
| Kitchen Style:                 | 02             | Modern         |                                 |           |             |
| <b>CONDO DATA</b>              |                |                |                                 |           |             |
| Parcel Id                      | 101905         | C 17           | Owne                            | 0.0       |             |
|                                | MEETINGHSE VIL | B 1            | S 1                             |           |             |
| Adjust Type                    | Code           | Description    | Factor%                         |           |             |
| Condo Flr                      |                |                | 100                             |           |             |
| Condo Unit                     | 01             | 01             | 228                             |           |             |
| <b>COST / MARKET VALUATION</b> |                |                |                                 |           |             |
| Building Value New             |                |                |                                 | 1,253,386 |             |
| Year Built                     |                |                |                                 | 1987      |             |
| Effective Year Built           |                |                |                                 | 2007      |             |
| Depreciation Code              |                |                |                                 | A         |             |
| Remodel Rating                 |                |                |                                 |           |             |
| Year Remodeled                 |                |                |                                 |           |             |
| Depreciation %                 |                |                |                                 | 15        |             |
| Functional Obsol               |                |                |                                 | 0         |             |
| External Obsol                 |                |                |                                 | 0         |             |
| Trend Factor                   |                |                |                                 | 1         |             |
| Condition                      |                |                |                                 |           |             |
| Condition %                    |                |                |                                 |           |             |
| Percent Good                   |                |                |                                 | 85        |             |
| Cns Sect Rcnld                 |                |                |                                 | 1,065,400 |             |
| Dep % Ovr                      |                |                |                                 |           |             |
| Dep Ovr Comment                |                |                |                                 |           |             |
| Misc Imp Ovr                   |                |                |                                 |           |             |
| Misc Imp Ovr Comment           |                |                |                                 |           |             |
| Cost to Cure Ovr               |                |                |                                 |           |             |
| Cost to Cure Ovr Comment       |                |                |                                 |           |             |

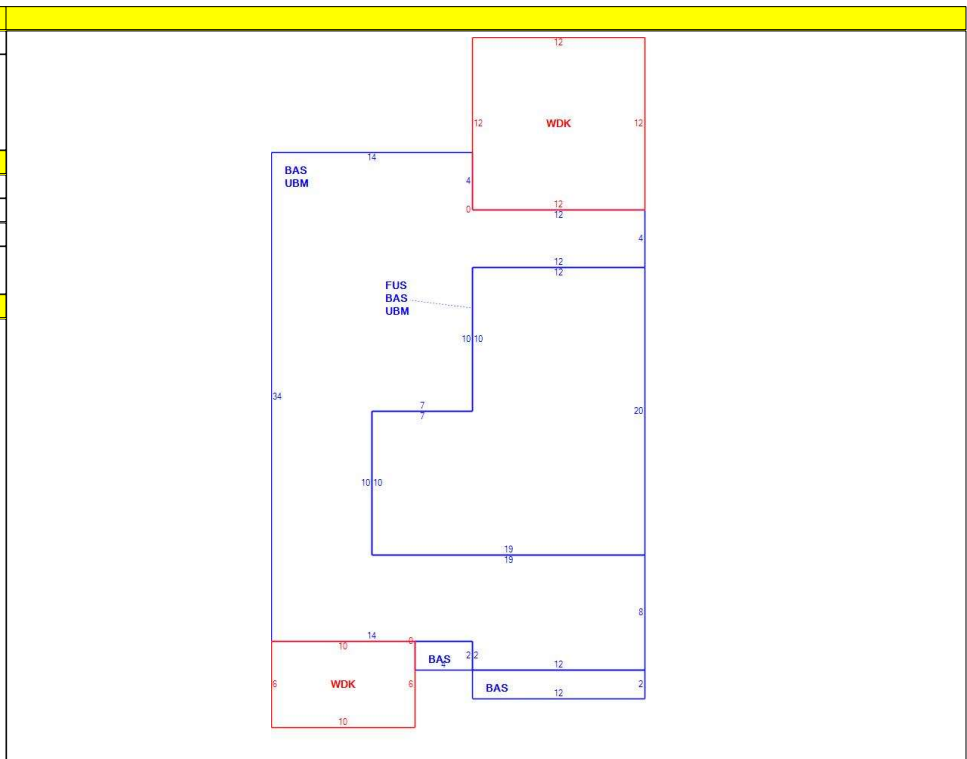

| OB - OUTBUILDING & YARD ITEMS(L) / XF - BUILDING EXTRA FEATURES(B) |             |     |       |            |        |          |      |       |            |             |
|--|-------------|-----|-------|------------|--------|----------|------|-------|------------|-------------|
| Code   | Description | L/B | Units | Unit Price | Yr Blt | Cond. Cd | % Gd | Grade | Grade Adj. | Appr. Value |
|  |             |     |       |            |        |          |      |       |            |             |

| BUILDING SUB-AREA SUMMARY SECTION |                       |             |            |          |           |                |
|-----------------------------------|-----------------------|-------------|------------|----------|-----------|----------------|
| Code                              | Description           | Living Area | Floor Area | Eff Area | Unit Cost | Undeprec Value |
| BAS                               | First Floor           | 892         | 892        | 892      | 894.78    | 798,146        |
| FUS                               | Upper Story, Finished | 310         | 310        | 310      | 894.78    | 277,383        |
| UBM                               | Basement, Unfinished  | 0           | 860        | 172      | 178.96    | 153,903        |
| WDK                               | Deck, Wood            | 0           | 204        | 20       | 87.72     | 17,896         |
| Ttl Gross Liv / Lease Area        |                       | 1,202       | 2,266      | 1,394    |           | 1,247,328      |

