

CURRENT OWNER		TOPO	UTILITIES	STRT / ROAD	LOCATION	CURRENT ASSESSMENT											
DAULA GARY A 198 PARK DR LONGMEADOW MA 01106						Description	Code	Appraised	Assessed								
						CONDO	1020	1,065,400	1,065,400								
SUPPLEMENTAL DATA						1302 EDGARTOWN, MA <h1 style="text-align: center;">VISION</h1>											
Alt Prcl ID PLN#/Rec Lot# Plan Notes Plan Notes Plan Notes GIS ID M_279573_792721			Restriction Hist Distrct Other Note UC-Misc 1 UC-Misc 2 Assoc Pid#														
						Total			1,065,400 1,065,400								
RECORD OF OWNERSHIP		BK-VOL/PAGE	SALE DATE	Q/U	V/I	SALE PRICE	VC	PREVIOUS ASSESSMENTS (HISTORY)									
DAULA GARY A		0011 0003	08-17-2023	Q	I	1,140,000	00	Year	Code	Assessed	Year	Code	Assessed V	Year	Code	Assessed	
BAILEY LAURA K & BAILHOUSE JENISE M--		0010 0206	11-07-2018	Q	I	522,500	00	2023	1020	539,900	2022	1020	526,300	2021	1020	526,300	
GRAF LAURIE A & PAUL D		00C2 620B	03-27-2002	U	I	172,725	1J										
OCONNELL THOMAS P & LAURIE		00C2 620A	03-27-2002	U	I	1	1A										
OCONNELL THOMAS P LAURIE		00C2 620A	09-24-1996	U	I	108,750	1A										
						Total			539,900			Total 526,300			Total 526,300		
EXEMPTIONS			OTHER ASSESSMENTS				This signature acknowledges a visit by a Data Collector or Assessor										
Year	Code	Description	Amount	Code	Description	Number	Amount	Comm Int									
			Total					0.00									
ASSESSING NEIGHBORHOOD						APPRAISED VALUE SUMMARY											
Nbhd	Nbhd Name		B		Tracing		Batch										
0050																	
NOTES																	
BLDG G UNIT 20 1988 SF. MTGHSE COND																	
BUILDING PERMIT RECORD								VISIT / CHANGE HISTORY									
Permit Id	Issue Date	Type	Description	Amount	Insp Date	% Comp	Date Comp	Comments	Date	Id	Type	Is	Cd	Purpost/Result			
2014-102	10-02-2013	RA	Res Add/Alter					MIN ALTS	10-31-2022	EH		6	01	Cyclical Reinspection			
									05-18-2022	LS			11	Field Review			
									05-24-2017	DM			11	Field Review			
									05-17-2011	EP			01	Cyclical Reinspection			
									05-20-2003	WP			11	Field Review			
LAND LINE VALUATION SECTION																	
B	Use Code	Description	Zone	Land Type	Land Units	Unit Price	Size Adj	Site Index	Cond.	Nbhd.	Nbhd. Adj	Notes		Location Adjustment	Adj Unit P	Land Value	
1	1020	CONDO M-05	R20		0 SF	1.00	1.00000	0	1.00		1.000			0.0000	1	0	
Total Card Land Units					0.00	AC	Parcel Total Land Area					0.00	Total Land Value				0

CONSTRUCTION DETAIL			CONSTRUCTION DETAIL (CONTINUED)		
Element	Cd	Description	Element	Cd	Description
Style:	55	Condominium			
Model	05	Res Condo			
Grade	05	Average +20			
Stories:	1.5	1 1/2 Stories			
Occupancy	1				
Interior Wall 1:	05	Drywall/Sheet			
Interior Wall 2:					
Interior Floor 1	14	Carpet			
Interior Floor 2	12	Hardwood			
Heat Fuel:	02	Oil			
Heat Type:	04	Forced Air-Duc			
AC Type:	02	Heat Pump			
Ttl Bedrms:	02	2 Bedrooms			
Ttl Bathrms:	2	2 Full			
Ttl Half Bths:	0				
Xtra Fixtres					
Total Rooms:	4				
Bath Style:	02	Average			
Kitchen Style:	02	Modern			
CONDO DATA					
Parcel Id	101905	C 17	Owne	0.0	
	MEETINGHSE VIL	B 1	S 1		
Adjust Type	Code	Description	Factor%		
Condo Flr			100		
Condo Unit	01	01	228		
COST / MARKET VALUATION					
Building Value New		1,253,386			
Year Built		1987			
Effective Year Built		2007			
Depreciation Code		A			
Remodel Rating					
Year Remodeled					
Depreciation %		15			
Functional Obsol		0			
External Obsol		0			
Trend Factor		1			
Condition					
Condition %					
Percent Good		85			
Cns Sect Rcnld		1,065,400			
Dep % Ovr					
Dep Ovr Comment					
Misc Imp Ovr					
Misc Imp Ovr Comment					
Cost to Cure Ovr					
Cost to Cure Ovr Comment					

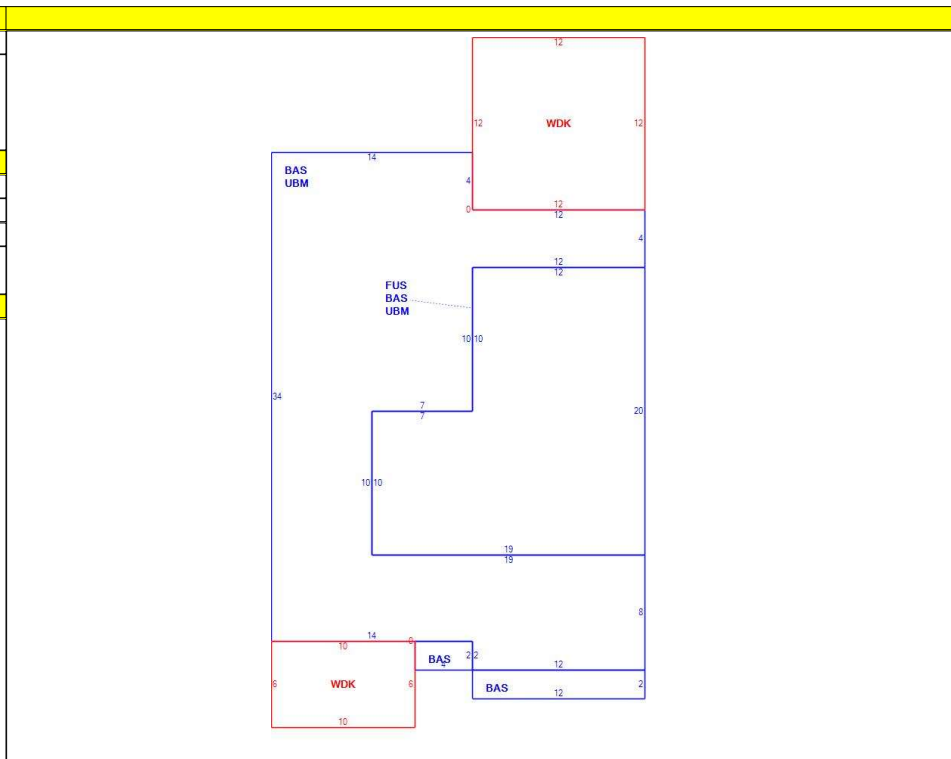

OB - OUTBUILDING & YARD ITEMS(L) / XF - BUILDING EXTRA FEATURES(B)										
Code	Description	L/B	Units	Unit Price	Yr Blt	Cond. Cd	% Gd	Grade	Grade Adj.	Appr. Value

BUILDING SUB-AREA SUMMARY SECTION							
Code	Description	Living Area	Floor Area	Eff Area	Unit Cost	Undeprec Value	
BAS	First Floor	892	892	892	894.78	798,146	
FUS	Upper Story, Finished	310	310	310	894.78	277,383	
UBM	Basement, Unfinished	0	860	172	178.96	153,903	
WDK	Deck, Wood	0	204	20	87.72	17,896	
Ttl Gross Liv / Lease Area		1,202	2,266	1,394		1,247,328	

