

| CURRENT OWNER   |            | TOPO  | UTILITIES             | STRT / ROAD         | LOCATION                               | CURRENT ASSESSMENT      |                        |   |                                | 1302<br>EDGARTOWN, MA<br><br><b>VISION</b> |           |            |                     |                       |            |            |  |            |
|---|------------|---|-----------------------|---------------------|--|-------------------------|------------------------|---|--------------------------------|--|-----------|------------|---------------------|-----------------------|------------|------------|--|------------|
| TOWER HILL MARTHA'S VINEYARD L<br><br>211 MILBANK AVE WEST<br><br>GREENWICH CT 06830                |            |   |                       |                     |  | Description             | Code                   | Appraised   | Assessed                       |  |           |            |                     |                       |            |            |  |            |
|   |            |   |                       |                     |  | RESIDENTL<br>RES LND    | 1010<br>1010           | 2,016,800<br>13,826,900   | 2,016,800<br>13,826,900        |  |           |            |                     |                       |            |            |  |            |
| SUPPLEMENTAL DATA   |            |   |                       |                     |  | Total                   |                        | 15,843,700  | 15,843,700                     |  |           |            |                     |                       |            |            |  |            |
| Alt Prcl ID<br>PLN#/Rec<br>Lot#<br>Plan Notes<br>Plan Notes<br>Plan Notes<br>GIS ID M_282787_792767 |            | Restriction<br>Hist Distrct<br>Other Note<br>UC-Misc 1<br>UC-Misc 2<br><br>Assoc Pid# |                       |                     |  |                         |                        |   |                                |  |           |            |                     |                       |            |            |  |            |
| RECORD OF OWNERSHIP   |            |   | BK-VOL/PAGE           | SALE DATE           | Q/U                                    | V/I                     | SALE PRICE             | VC  | PREVIOUS ASSESSMENTS (HISTORY) |  |           |            |                     |                       |            |            |  |            |
| TOWER HILL MARTHA'S VINEYARD LLC<br>31 TOWER HILL LLC<br>CHAPEDA HILL CORP                          |            |   | 1512<br>1383<br>00352 | 258<br>0378<br>0400 | 11-15-2019<br>08-10-2015<br>12-01-1977 | U<br>Q                  | I<br>I                 | 1<br>12,000,000<br>0  | 1A<br>00                       | Year                                       | Code      | Assessed   | Year                | Code                  | Assessed   |            |  |            |
|   |            |   |                       |                     |  |                         |                        |   |                                | 2023                                       | 1010      | 2,058,100  | 2022                | 1010                  | 1,590,100  |            |  |            |
|   |            |   |                       |                     |  |                         |                        |   |                                |  | 1010      | 13,317,800 | 2021                | 1010                  | 11,450,885 |            |  |            |
|   |            |   |                       |                     |  |                         |                        |   |                                | Total                                      |           | 15,375,900 | Total               |                       | 14,314,258 | Total      |  | 13,040,985 |
| EXEMPTIONS  |            |   |                       | OTHER ASSESSMENTS   |  |                         |                        | This signature acknowledges a visit by a Data Collector or Assessor |                                |  |           |            |                     |                       |            |            |  |            |
| Year  | Code       | Description   | Amount                | Code                | Description                            | Number                  | Amount                 | Comm Int  |                                |  |           |            |                     |                       |            |            |  |            |
| Total   |            |   | 0.00                  |                     |  |                         |                        |   |                                |  |           |            |                     |                       |            |            |  |            |
| ASSESSING NEIGHBORHOOD  |            |   |                       |                     |  | APPRAISED VALUE SUMMARY |                        |   |                                |  |           |            |                     |                       |            |            |  |            |
| Nbhd  | Nbhd Name  |   | B                     | Tracing             |  | Batch                   |                        |   |                                |  |           |            |                     |                       |            |            |  |            |
| 0090  |            |   |                       |                     |  |                         |                        |   |                                |  |           |            |                     |                       |            |            |  |            |
| NOTES   |            |   |                       |                     |  |                         |                        |   |                                |  |           |            |                     |                       |            |            |  |            |
| GREEN HOLLOW<br>REAR DRMR   |            |   |                       |                     |  |                         |                        |   |                                |  |           |            |                     |                       |            |            |  |            |
| Appraised Bldg. Value (Card)  |            |   |                       |                     |  | 1,936,500               |                        |   |                                |  |           |            |                     |                       |            |            |  |            |
| Appraised Xf (B) Value (Bldg)   |            |   |                       |                     |  | 7,500                   |                        |   |                                |  |           |            |                     |                       |            |            |  |            |
| Appraised Ob (B) Value (Bldg)   |            |   |                       |                     |  | 72,800                  |                        |   |                                |  |           |            |                     |                       |            |            |  |            |
| Appraised Land Value (Bldg)   |            |   |                       |                     |  | 13,826,900              |                        |   |                                |  |           |            |                     |                       |            |            |  |            |
| Special Land Value  |            |   |                       |                     |  | 0                       |                        |   |                                |  |           |            |                     |                       |            |            |  |            |
| Total Appraised Parcel Value  |            |   |                       |                     |  | 15,843,700              |                        |   |                                |  |           |            |                     |                       |            |            |  |            |
| Valuation Method  |            |   |                       |                     |  | C                       |                        |   |                                |  |           |            |                     |                       |            |            |  |            |
| Total Appraised Parcel Value  |            |   |                       |                     |  | 15,843,700              |                        |   |                                |  |           |            |                     |                       |            |            |  |            |
| BUILDING PERMIT RECORD  |            |   |                       |                     |  | VISIT / CHANGE HISTORY  |                        |   |                                |  |           |            |                     |                       |            |            |  |            |
| Permit Id   | Issue Date | Type  | Description           | Amount              | Insp Date                              | % Comp                  | Date Comp              | Comments  | Date                           | Id   | Type      | Is         | Cd                  | Purpost/Result        |            |            |  |            |
| 2018-333  | 12-29-2017 | RA  | Res Add/Alter         | 120,000             |  | 0                       |                        | RENO/ADDIT COTTAGE (BLD   | 05-24-2022                     | LS   |           |            | 11                  | Field Review          |            |            |  |            |
|   |            |   |                       |                     |  |                         |                        |   | 05-21-2018                     | EP   |           |            | 01                  | Cyclical Reinspection |            |            |  |            |
|   |            |   |                       |                     |  |                         |                        |   | 05-16-2017                     | MM   |           |            | 11                  | Field Review          |            |            |  |            |
|   |            |   |                       |                     |  |                         |                        |   | 06-24-2014                     | SER  |           |            | 11                  | Field Review          |            |            |  |            |
|   |            |   |                       |                     |  |                         |                        |   | 11-10-2011                     | DM   |           |            | 11                  | Field Review          |            |            |  |            |
|   |            |   |                       |                     |  |                         |                        |   | 09-10-2008                     | JR   |           |            | 11                  | Field Review          |            |            |  |            |
|   |            |   |                       |                     |  |                         |                        |   | 02-05-2004                     | CR   |           |            | 01                  | Cyclical Reinspection |            |            |  |            |
| LAND LINE VALUATION SECTION   |            |   |                       |                     |  |                         |                        |   |                                |  |           |            |                     |                       |            |            |  |            |
| B   | Use Code   | Description   | Zone                  | Land Type           | Land Units                             | Unit Price              | Size Adj               | Site Index  | Cond.                          | Nbhd.                                      | Nbhd. Adj | Notes      | Location Adjustment | Adj Unit P            | Land Value |            |  |            |
| 1   | 1010       | SINGL FAM M-0   | R60                   |                     | 65,340 SF                              | 6.54                    | 1.00000                | 7   | 1.00                           | 0090                                       | 4.900     |            | W65                 | 208.3                 | 13,610,300 |            |  |            |
| 1   | 1010       | SINGL FAM M-0   | R60                   |                     | 115 FF                                 | 0.01                    | 1.00000                | 0   | 1.00                           | 0090                                       | 4.900     |            |                     | 0.05                  | 0          |            |  |            |
| 1   | 1010       | SINGL FAM M-0   | R60                   |                     | 0.200 AC                               | 34,000.00               | 1.00000                | 0   | 1.00                           | 0090                                       | 4.900     |            | W65                 | 1,082,900             | 216,600    |            |  |            |
| Total Card Land Units   |            |   |                       |                     | 1.70                                   | AC                      | Parcel Total Land Area |   |                                |  |           | 1.70       | Total Land Value    |                       |            | 13,826,900 |  |            |

| CONSTRUCTION DETAIL            |      |                | CONSTRUCTION DETAIL (CONTINUED) |     |             |
|--------------------------------|------|----------------|---------------------------------|-----|-------------|
| Element                        | Cd   | Description    | Element                         | Cd  | Description |
| Style:                         | 03   | Colonial       |                                 |     |             |
| Model                          | 01   | Residential    |                                 |     |             |
| Grade:                         | 09   | Custom         |                                 |     |             |
| Stories:                       | 2    | 2 Stories      |                                 |     |             |
| Occupancy                      | 1    |                |                                 |     |             |
| Exterior Wall 1                | 25   | Vinyl Siding   |                                 |     |             |
| Exterior Wall 2                |      |                |                                 |     |             |
| Roof Structure:                | 07   | Gambrel        |                                 |     |             |
| Roof Cover                     | 03   | Asph/F Gls/Cmp |                                 |     |             |
| Interior Wall 1                | 03   | Plastered      |                                 |     |             |
| Interior Wall 2                | 06   | Cust Wd Panel  |                                 |     |             |
| Interior Flr 1                 | 12   | Hardwood       |                                 |     |             |
| Interior Flr 2                 |      |                |                                 |     |             |
| Heat Fuel                      | 02   | Oil            |                                 |     |             |
| Heat Type:                     | 04   | Forced Air-Duc |                                 |     |             |
| AC Type:                       | 02   | Heat Pump      |                                 |     |             |
| Total Bedrooms                 | 08   | 8 Bedrooms     |                                 |     |             |
| Total Bthrms:                  | 5    |                |                                 |     |             |
| Total Half Baths               | 0    |                |                                 |     |             |
| Total Xtra Fixtrs              |      |                |                                 |     |             |
| Total Rooms:                   |      |                |                                 |     |             |
| Bath Style:                    | 02   | Average        |                                 |     |             |
| Kitchen Style:                 | 02   | Modern         |                                 |     |             |
| <b>CONDO DATA</b>              |      |                |                                 |     |             |
| Parcel Id                      |      | C              | Ownr                            | 0.0 |             |
|                                |      |                | B                               | S   |             |
| Adjust Type                    | Code | Description    | Factor%                         |     |             |
| Condo Flr                      |      |                |                                 |     |             |
| Condo Unit                     |      |                |                                 |     |             |
| <b>COST / MARKET VALUATION</b> |      |                |                                 |     |             |
| Building Value New             |      | 2,157,066      |                                 |     |             |
| Year Built                     |      | 1930           |                                 |     |             |
| Effective Year Built           |      | 2007           |                                 |     |             |
| Depreciation Code              |      | VG             |                                 |     |             |
| Remodel Rating                 |      |                |                                 |     |             |
| Year Remodeled                 |      | 15             |                                 |     |             |
| Depreciation %                 |      | 0              |                                 |     |             |
| Functional Obsol               |      | 0              |                                 |     |             |
| External Obsol                 |      | 0              |                                 |     |             |
| Trend Factor                   |      | 1              |                                 |     |             |
| Condition                      |      |                |                                 |     |             |
| Condition %                    |      | 85             |                                 |     |             |
| Percent Good                   |      | 1,833,500      |                                 |     |             |
| Cns Sect Rcnld                 |      |                |                                 |     |             |
| Dep % Ovr                      |      |                |                                 |     |             |
| Dep Ovr Comment                |      |                |                                 |     |             |
| Misc Imp Ovr                   |      |                |                                 |     |             |
| Misc Imp Ovr Comment           |      |                |                                 |     |             |
| Cost to Cure Ovr               |      |                |                                 |     |             |
| Cost to Cure Ovr Comment       |      |                |                                 |     |             |

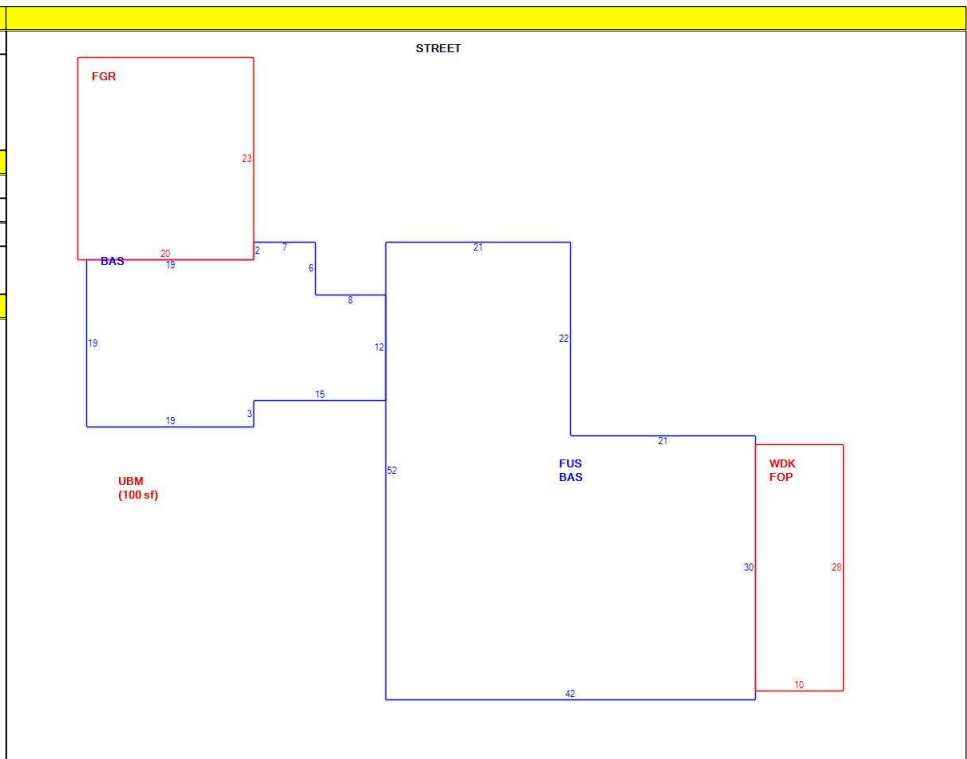

| OB - OUTBUILDING & YARD ITEMS(L) / XF - BUILDING EXTRA FEATURES(B) |             |     |       |            |        |          |      |       |            |             |
|--|-------------|-----|-------|------------|--------|----------|------|-------|------------|-------------|
| Code   | Description | L/B | Units | Unit Price | Yr Blt | Cond. Cd | % Gd | Grade | Grade Adj. | Appr. Value |
| DCK1   | DOCKS-RES   | L   | 1,000 | 95.00      | 1980   |          | 75   |       | 0.00       | 71,300      |
| FPL3   | FPL MSNRY 2 | B   | 2     | 4000.00    | 2001   |          | 85   |       | 0.00       | 6,800       |
| FPO  | EXTRA FPL O | B   | 1     | 800.00     | 2001   |          | 85   |       | 0.00       | 700         |

| BUILDING SUB-AREA SUMMARY SECTION |                       |             |            |          |           |                |
|-----------------------------------|-----------------------|-------------|------------|----------|-----------|----------------|
| Code                              | Description           | Living Area | Floor Area | Eff Area | Unit Cost | Undeprec Value |
| BAS                               | First Floor           | 2,305       | 2,305      | 2,305    | 491.09    | 1,131,969      |
| FGR                               | Garage                | 0           | 460        | 184      | 196.44    | 90,361         |
| FOP                               | Porch, Open, Finished | 0           | 280        | 56       | 98.22     | 27,501         |
| FUS                               | Upper Story, Finished | 1,722       | 1,722      | 1,722    | 491.09    | 845,662        |
| UBM                               | Basement, Unfinished  | 0           | 100        | 20       | 98.22     | 9,822          |
| WDK                               | Deck, Wood            | 0           | 280        | 28       | 49.11     | 13,751         |
| Ttl Gross Liv / Lease Area        |                       | 4,027       | 5,147      | 4,315    |           | 2,119,066      |



| CURRENT OWNER   |            | TOPO               | UTILITIES         | STRT / ROAD   | LOCATION    | CURRENT ASSESSMENT       |   |                                |          | 1302<br>EDGARTOWN, MA<br><br><b>VISION</b> |           |  |            |                     |                |            |            |
|---|------------|--------------------|-------------------|---|-------------|--------------------------|---|--------------------------------|----------|--|-----------|--|------------|---------------------|----------------|------------|------------|
| TOWER HILL MARTHA'S VINEYARD L<br><br>211 MILBANK AVE WEST<br><br>GREENWICH CT 06830                |            |                    |                   |   |             | Description              | Code  | Appraised                      | Assessed |  |           | RESIDENTL 1010 2,016,800 2,016,800<br>RES LND 1010 13,826,900 13,826,900 |            |                     |                |            |            |
|   |            |                    |                   |   |             | <b>SUPPLEMENTAL DATA</b> |   |                                |          |  |           |  |            | Total               |                | 15,843,700 | 15,843,700 |
| Alt Prcl ID<br>PLN#/Rec<br>Lot#<br>Plan Notes<br>Plan Notes<br>Plan Notes<br>GIS ID M_282787_792767 |            |                    |                   | Restriction<br>Hist Distrct<br>Other Note<br>UC-Misc 1<br>UC-Misc 2<br><br>Assoc Pid# |             |                          |   |                                |          |  |           |  |            |                     |                |            |            |
| <b>RECORD OF OWNERSHIP</b>  |            | <b>BK-VOL/PAGE</b> | <b>SALE DATE</b>  | <b>Q/U</b>  | <b>V/I</b>  | <b>SALE PRICE</b>        | <b>VC</b>   | PREVIOUS ASSESSMENTS (HISTORY) |          |  |           |  |            |                     |                |            |            |
| TOWER HILL MARTHA'S VINEYARD LLC  |            | 1512 258           | 11-15-2019        | U   | I           | 12,000,000               | 1A  | Year                           | Code     | Assessed                                   | Year      | Code   | Assessed   | Year                | Code           | Assessed   |            |
| 31 TOWER HILL LLC   |            | 1383 0378          | 08-10-2015        | Q   | I           | 0                        | 00  | 2023                           | 1010     | 2,058,100                                  | 2022      | 1010   | 1,590,100  | 2021                | 1010           | 1,590,100  |            |
| CHAPEDA HILL CORP   |            | 00352 0400         | 12-01-1977        |   |             |                          |   |                                | 1010     | 13,317,800                                 |           | 1010   | 12,724,158 |                     | 1010           | 11,450,885 |            |
| Total   |            |                    |                   |   |             |                          |   | 15,375,900                     |          | Total                                      |           | 14,314,258   |            | Total               |                | 13,040,985 |            |
| EXEMPTIONS  |            |                    | OTHER ASSESSMENTS |   |             |                          | This signature acknowledges a visit by a Data Collector or Assessor |                                |          |  |           |  |            |                     |                |            |            |
| Year  | Code       | Description        | Amount            | Code  | Description | Number                   | Amount  | Comm Int                       |          |  |           |  |            |                     |                |            |            |
| Total   |            |                    | 0.00              |   |             |                          |   |                                |          |  |           |  |            |                     |                |            |            |
| ASSESSING NEIGHBORHOOD  |            |                    |                   |   |             |                          |   |                                |          | APPRAISED VALUE SUMMARY                    |           |  |            |                     |                |            |            |
| Nbhd  | Nbhd Name  |                    | B                 |   | Tracing     |                          | Batch   |                                |          | Appraised Bldg. Value (Card) 1,936,500     |           |  |            |                     |                |            |            |
| 0090  |            |                    |                   |   |             |                          |   |                                |          | Appraised Xf (B) Value (Bldg) 7,500        |           |  |            |                     |                |            |            |
|   |            |                    |                   |   |             |                          |   |                                |          | Appraised Ob (B) Value (Bldg) 72,800       |           |  |            |                     |                |            |            |
|   |            |                    |                   |   |             |                          |   |                                |          | Appraised Land Value (Bldg) 13,826,900     |           |  |            |                     |                |            |            |
|   |            |                    |                   |   |             |                          |   |                                |          | Special Land Value 0                       |           |  |            |                     |                |            |            |
|   |            |                    |                   |   |             |                          |   |                                |          | Total Appraised Parcel Value 15,843,700    |           |  |            |                     |                |            |            |
|   |            |                    |                   |   |             |                          |   |                                |          | Valuation Method C                         |           |  |            |                     |                |            |            |
|   |            |                    |                   |   |             |                          |   |                                |          | Total Appraised Parcel Value 15,843,700    |           |  |            |                     |                |            |            |
| BUILDING PERMIT RECORD  |            |                    |                   |   |             |                          |   |                                |          | VISIT / CHANGE HISTORY                     |           |  |            |                     |                |            |            |
| Permit Id   | Issue Date | Type               | Description       | Amount  | Insp Date   | % Comp                   | Date Comp   | Comments                       |          | Date                                       | Id        | Type   | Is         | Cd                  | Purpost/Result |            |            |
|   |            |                    |                   |   |             |                          |   |                                |          |  |           |  |            |                     |                |            |            |
| LAND LINE VALUATION SECTION   |            |                    |                   |   |             |                          |   |                                |          |  |           |  |            |                     |                |            |            |
| B   | Use Code   | Description        | Zone              | Land Type   | Land Units  | Unit Price               | Size Adj  | Site Index                     | Cond.    | Nbhd.                                      | Nbhd. Adj | Notes  |            | Location Adjustment |                | Adj Unit P | Land Value |
| 2   | 1010       | SINGL FAM M-0      | R60               |   | 0 SF        | 28.56                    | 1.00000   | 6                              | 1.00     | 0090                                       | 4.900     |  |            |                     |                | 139.94     | 0          |
| Total Card Land Units   |            |                    |                   |   | 0.00        | AC                       | Parcel Total Land Area  |                                |          |  | 1.70      | Total Land Value   |            |                     |                |            | 0          |

| CONSTRUCTION DETAIL |    |                | CONSTRUCTION DETAIL (CONTINUED) |      |             |
|---------------------|----|----------------|---------------------------------|------|-------------|
| Element             | Cd | Description    | Element                         | Cd   | Description |
| Style:              | 10 | Standard Basic |                                 |      |             |
| Model               | 01 | Residential    |                                 |      |             |
| Grade:              | 06 | Good           |                                 |      |             |
| Stories:            | 1  | 1 Story        |                                 |      |             |
| Occupancy           | 1  |                |                                 |      |             |
| Exterior Wall 1     | 11 | Clapboard      |                                 |      |             |
| Exterior Wall 2     |    |                |                                 |      |             |
| Roof Structure:     | 03 | Gable/Hip      |                                 |      |             |
| Roof Cover          | 10 | Wood Shingle   |                                 |      |             |
| Interior Wall 1     | 05 | Drywall/Sheet  |                                 |      |             |
| Interior Wall 2     |    |                |                                 |      |             |
| Interior Flr 1      | 12 | Hardwood       |                                 |      |             |
| Interior Flr 2      |    |                |                                 |      |             |
| Heat Fuel           | 01 | Coal or Wood   |                                 |      |             |
| Heat Type:          | 01 | None           |                                 |      |             |
| AC Type:            | 01 | None           |                                 |      |             |
| Total Bedrooms      | 00 |                |                                 |      |             |
| Total Bthrms:       | 0  |                |                                 |      |             |
| Total Half Baths    | 1  |                |                                 |      |             |
| Total Xtra Fixtrs   |    |                |                                 |      |             |
| Total Rooms:        | 2  |                |                                 |      |             |
| Bath Style:         | 03 | Modern         |                                 |      |             |
| Kitchen Style:      |    |                |                                 |      |             |
|                     |    |                | <b>CONDO DATA</b>               |      |             |
|                     |    |                | Parcel Id                       | C    | Ownr 0.0    |
|                     |    |                |                                 | B    | S           |
|                     |    |                | Adjust Type                     | Code | Description |
|                     |    |                | Condo Flr                       |      |             |
|                     |    |                | Condo Unit                      |      |             |
|                     |    |                | <b>COST / MARKET VALUATION</b>  |      |             |
|                     |    |                | Building Value New              |      | 80,634      |
|                     |    |                | Year Built                      |      | 1930        |
|                     |    |                | Effective Year Built            |      | 2017        |
|                     |    |                | Depreciation Code               |      | R           |
|                     |    |                | Remodel Rating                  |      |             |
|                     |    |                | Year Remodeled                  |      |             |
|                     |    |                | Depreciation %                  |      | 5           |
|                     |    |                | Functional Obsol                |      | 0           |
|                     |    |                | External Obsol                  |      | 0           |
|                     |    |                | Trend Factor                    |      | 1           |
|                     |    |                | Condition                       |      |             |
|                     |    |                | Condition %                     |      |             |
|                     |    |                | Percent Good                    |      | 95          |
|                     |    |                | Cns Sect Rcnd                   |      | 76,600      |
|                     |    |                | Dep % Ovr                       |      |             |
|                     |    |                | Dep Ovr Comment                 |      |             |
|                     |    |                | Misc Imp Ovr                    |      |             |
|                     |    |                | Misc Imp Ovr Comment            |      |             |
|                     |    |                | Cost to Cure Ovr                |      |             |
|                     |    |                | Cost to Cure Ovr Comment        |      |             |

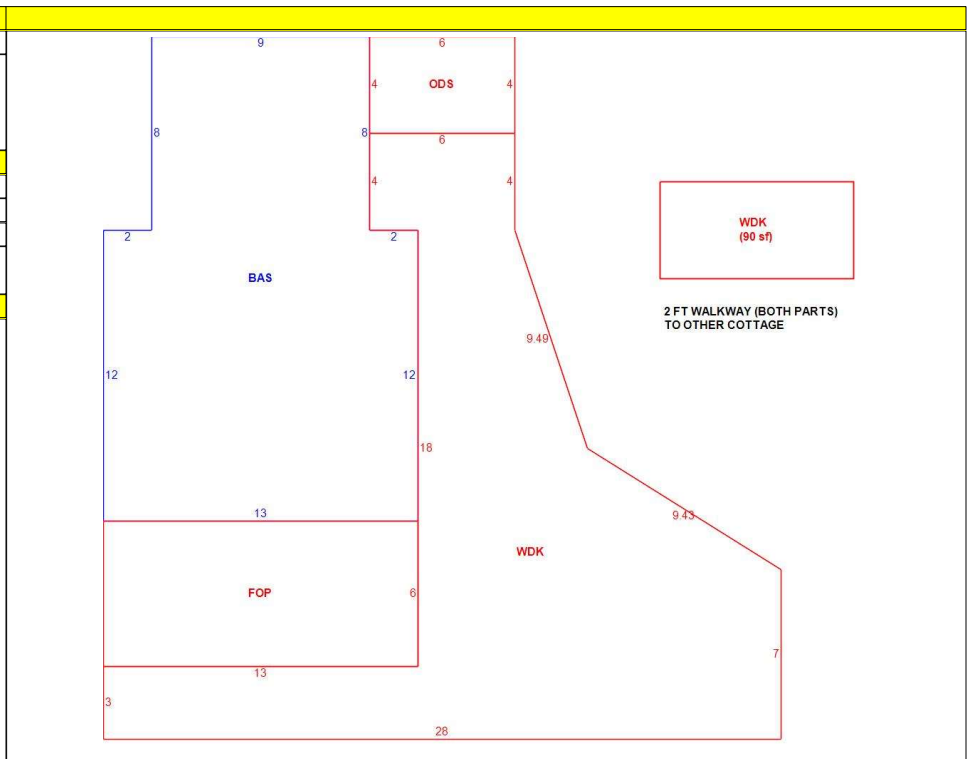

| OB - OUTBUILDING & YARD ITEMS(L) / XF - BUILDING EXTRA FEATURES(B) |             |     |       |            |        |          |      |       |            |             |
|--|-------------|-----|-------|------------|--------|----------|------|-------|------------|-------------|
| Code   | Description | L/B | Units | Unit Price | Yr Blt | Cond. Cd | % Gd | Grade | Grade Adj. | Appr. Value |
| ODP  | OUTDOOR PL  | L   | 1     | 700.00     | 2018   |          | 100  |       | 0.00       | 700         |

| BUILDING SUB-AREA SUMMARY SECTION |                        |             |            |          |           |                |
|-----------------------------------|------------------------|-------------|------------|----------|-----------|----------------|
| Code                              | Description            | Living Area | Floor Area | Eff Area | Unit Cost | Undeprec Value |
| BAS                               | First Floor            | 228         | 228        | 228      | 271.60    | 61,925         |
| FOP                               | Porch, Open, Finished  | 0           | 78         | 16       | 55.71     | 4,346          |
| ODS                               | Outdoor Shwr Enclosure | 0           | 24         | 4        | 45.27     | 1,086          |
| WDK                               | Deck, Wood             | 0           | 363        | 36       | 26.94     | 9,778          |
| Ttl Gross Liv / Lease Area        |                        | 228         | 693        | 284      |           | 77,135         |





| CURRENT OWNER   |            | TOPO  | UTILITIES         | STRT / ROAD | LOCATION    | CURRENT ASSESSMENT   |   |                                |                         | 1302<br>EDGARTOWN, MA<br><br><b>VISION</b> |                  |            |            |                     |                       |            |            |
|---|------------|---|-------------------|-------------|-------------|----------------------|---|--------------------------------|-------------------------|--|------------------|------------|------------|---------------------|-----------------------|------------|------------|
| TOWER HILL MARTHA'S VINEYARD L<br><br>211 MILBANK AVE WEST<br><br>GREENWICH CT 06830                |            |   |                   |             |             | Description          | Code  | Appraised                      | Assessed                |  |                  |            |            |                     |                       |            |            |
|   |            |   |                   |             |             | RESIDENTL<br>RES LND | 1010<br>1010  | 2,016,800<br>13,826,900        | 2,016,800<br>13,826,900 |  |                  |            |            |                     |                       |            |            |
| <b>SUPPLEMENTAL DATA</b>  |            |   |                   |             |             | Total                |   | 15,843,700                     | 15,843,700              |  |                  |            |            |                     |                       |            |            |
| Alt Prcl ID<br>PLN#/Rec<br>Lot#<br>Plan Notes<br>Plan Notes<br>Plan Notes<br>GIS ID M_282787_792767 |            | Restriction<br>Hist Distrct<br>Other Note<br>UC-Misc 1<br>UC-Misc 2<br><br>Assoc Pid# |                   |             |             |                      |   |                                |                         |  |                  |            |            |                     |                       |            |            |
| RECORD OF OWNERSHIP   |            | BK-VOL/PAGE   | SALE DATE         | Q/U         | V/I         | SALE PRICE           | VC  | PREVIOUS ASSESSMENTS (HISTORY) |                         |  |                  |            |            |                     |                       |            |            |
| TOWER HILL MARTHA'S VINEYARD LLC  |            | 1512 258  | 11-15-2019        | U           | I           | 12,000,000           | 1A  | Year                           | Code                    | Assessed                                   | Year             | Code       | Assessed   | Year                | Code                  | Assessed   |            |
| 31 TOWER HILL LLC   |            | 1383 0378   | 08-10-2015        | Q           | I           | 0                    |   | 2023                           | 1010                    | 2,058,100                                  | 2022             | 1010       | 1,590,100  | 2021                | 1010                  | 1,590,100  |            |
| CHAPEDA HILL CORP   |            | 00352 0400  | 12-01-1977        |             |             | 0                    |   |                                | 1010                    | 13,317,800                                 |                  | 1010       | 12,724,158 |                     | 1010                  | 11,450,885 |            |
|   |            |   |                   |             |             | Total                |   | 15,375,900                     | Total                   | 14,314,258                                 | Total            | 13,040,985 |            |                     |                       |            |            |
| EXEMPTIONS  |            |   | OTHER ASSESSMENTS |             |             |                      | This signature acknowledges a visit by a Data Collector or Assessor |                                |                         |  |                  |            |            |                     |                       |            |            |
| Year  | Code       | Description   | Amount            | Code        | Description | Number               | Amount  | Comm Int                       |                         |  |                  |            |            |                     |                       |            |            |
|   |            |   | 0.00              |             |             |                      |   |                                |                         |  |                  |            |            |                     |                       |            |            |
| <b>ASSESSING NEIGHBORHOOD</b>   |            |   |                   |             |             |                      |   |                                |                         | <b>APPRAISED VALUE SUMMARY</b>             |                  |            |            |                     |                       |            |            |
| Nbhd  | Nbhd Name  |   | B                 | Tracing     |             | Batch                |   |                                |                         |  |                  |            |            |                     |                       |            |            |
| 0090  |            |   |                   |             |             |                      |   |                                |                         |  |                  |            |            |                     |                       |            |            |
| <b>NOTES</b>  |            |   |                   |             |             |                      |   |                                |                         |  |                  |            |            |                     |                       |            |            |
| BEACH EQUIP./SMALL BOAT SHED<br>2018-REPL DECKS   |            |   |                   |             |             |                      |   |                                |                         |  |                  |            |            |                     |                       |            |            |
| Appraised Bldg. Value (Card)  |            |   |                   |             |             |                      |   |                                |                         | 1,936,500                                  |                  |            |            |                     |                       |            |            |
| Appraised Xf (B) Value (Bldg)   |            |   |                   |             |             |                      |   |                                |                         | 7,500                                      |                  |            |            |                     |                       |            |            |
| Appraised Ob (B) Value (Bldg)   |            |   |                   |             |             |                      |   |                                |                         | 72,800                                     |                  |            |            |                     |                       |            |            |
| Appraised Land Value (Bldg)   |            |   |                   |             |             |                      |   |                                |                         | 13,826,900                                 |                  |            |            |                     |                       |            |            |
| Special Land Value  |            |   |                   |             |             |                      |   |                                |                         | 0  |                  |            |            |                     |                       |            |            |
| Total Appraised Parcel Value  |            |   |                   |             |             |                      |   |                                |                         | 15,843,700                                 |                  |            |            |                     |                       |            |            |
| Valuation Method  |            |   |                   |             |             |                      |   |                                |                         | C  |                  |            |            |                     |                       |            |            |
| Total Appraised Parcel Value  |            |   |                   |             |             |                      |   |                                |                         | 15,843,700                                 |                  |            |            |                     |                       |            |            |
| BUILDING PERMIT RECORD  |            |   |                   |             |             |                      |   |                                |                         | VISIT / CHANGE HISTORY                     |                  |            |            |                     |                       |            |            |
| Permit Id   | Issue Date | Type  | Description       | Amount      | Insp Date   | % Comp               | Date Comp   | Comments                       |                         | Date                                       | Id               | Type       | Is         | Cd                  | Purpost/Result        |            |            |
|   |            |   |                   |             |             |                      |   |                                |                         | 09-05-2019                                 | EP               |            |            | 01                  | Cyclical Reinspection |            |            |
| <b>LAND LINE VALUATION SECTION</b>  |            |   |                   |             |             |                      |   |                                |                         |  |                  |            |            |                     |                       |            |            |
| B   | Use Code   | Description   | Zone              | Land Type   | Land Units  | Unit Price           | Size Adj  | Site Index                     | Cond.                   | Nbhd.                                      | Nbhd. Adj        | Notes      |            | Location Adjustment |                       | Adj Unit P | Land Value |
| 3   | 1010       | SINGL FAM M-0   | R60               |             | 0 SF        | 28.56                | 1.00000   | 6                              | 1.00                    | 0090                                       | 4.900            |            |            |                     |                       | 139.94     | 0          |
| Total Card Land Units   |            |   |                   |             | 0.00        | AC                   | Parcel Total Land Area  |                                |                         | 1.70                                       | Total Land Value |            |            |                     |                       | 0          |            |

| CONSTRUCTION DETAIL      |      |                | CONSTRUCTION DETAIL (CONTINUED) |        |             |
|--------------------------|------|----------------|---------------------------------|--------|-------------|
| Element                  | Cd   | Description    | Element                         | Cd     | Description |
| Style:                   | 36   | Camp           |                                 |        |             |
| Model                    | 01   | Residential    |                                 |        |             |
| Grade:                   | 03   | Average        |                                 |        |             |
| Stories:                 | 1    | 1 Story        |                                 |        |             |
| Occupancy                | 1    |                |                                 |        |             |
| Exterior Wall 1          | 08   | Wood on Sheath |                                 |        |             |
| Exterior Wall 2          |      |                |                                 |        |             |
| Roof Structure:          | 03   | Gable/Hip      |                                 |        |             |
| Roof Cover               | 10   | Wood Shingle   |                                 |        |             |
| Interior Wall 1          | 01   | Minim/Masonry  |                                 |        |             |
| Interior Wall 2          |      |                |                                 |        |             |
| Interior Flr 1           | 12   | Hardwood       |                                 |        |             |
| Interior Flr 2           |      |                |                                 |        |             |
| Heat Fuel                | 01   | Coal or Wood   |                                 |        |             |
| Heat Type:               | 01   | None           |                                 |        |             |
| AC Type:                 | 01   | None           |                                 |        |             |
| Total Bedrooms           | 00   |                |                                 |        |             |
| Total Bthrms:            | 0    |                |                                 |        |             |
| Total Half Baths         | 0    |                |                                 |        |             |
| Total Xtra Fixtrs        |      |                |                                 |        |             |
| Total Rooms:             |      |                |                                 |        |             |
| Bath Style:              |      |                |                                 |        |             |
| Kitchen Style:           |      |                |                                 |        |             |
|                          |      |                | <b>CONDO DATA</b>               |        |             |
| Parcel Id                |      |                | C                               | Ownr   | 0.0         |
|                          |      |                | B                               | S      |             |
| Adjust Type              | Code | Description    | Factor%                         |        |             |
| Condo Flr                |      |                |                                 |        |             |
| Condo Unit               |      |                |                                 |        |             |
|                          |      |                | <b>COST / MARKET VALUATION</b>  |        |             |
| Building Value New       |      |                |                                 | 37,760 |             |
| Year Built               |      |                |                                 | 1930   |             |
| Effective Year Built     |      |                |                                 | 1992   |             |
| Depreciation Code        |      |                |                                 | A      |             |
| Remodel Rating           |      |                |                                 |        |             |
| Year Remodeled           |      |                |                                 |        |             |
| Depreciation %           |      |                |                                 | 30     |             |
| Functional Obsol         |      |                |                                 | 0      |             |
| External Obsol           |      |                |                                 | 0      |             |
| Trend Factor             |      |                |                                 | 1      |             |
| Condition                |      |                |                                 |        |             |
| Condition %              |      |                |                                 |        |             |
| Percent Good             |      |                |                                 | 70     |             |
| Cns Sect Rcnd            |      |                |                                 | 26,400 |             |
| Dep % Ovr                |      |                |                                 |        |             |
| Dep Ovr Comment          |      |                |                                 |        |             |
| Misc Imp Ovr             |      |                |                                 |        |             |
| Misc Imp Ovr Comment     |      |                |                                 |        |             |
| Cost to Cure Ovr         |      |                |                                 |        |             |
| Cost to Cure Ovr Comment |      |                |                                 |        |             |

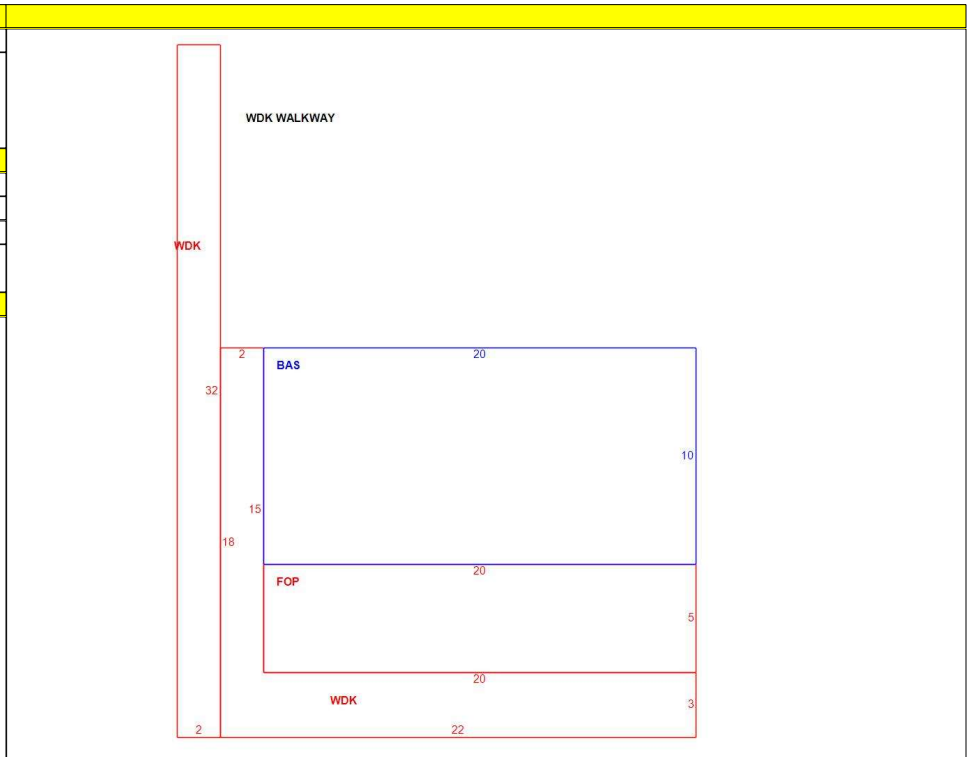

**OB - OUTBUILDING & YARD ITEMS(L) / XF - BUILDING EXTRA FEATURES(B)**

| Code | Description | L/B | Units | Unit Price | Yr Blt | Cond. Cd | % Gd | Grade | Grade Adj. | Appr. Value |
|------|-------------|-----|-------|------------|--------|----------|------|-------|------------|-------------|
| SHD1 | SHED FRAME  | L   | 35    | 16.00      | 2004   |          | 10   |       | 0.00       | 100         |
| ODP  | OUTDOOR PL  | L   | 1     | 700.00     |        |          | 100  |       | 0.00       | 700         |

**BUILDING SUB-AREA SUMMARY SECTION**

| Code                       | Description           | Living Area | Floor Area | Eff Area | Unit Cost | Undeprec Value |
|----------------------------|-----------------------|-------------|------------|----------|-----------|----------------|
| BAS                        | First Floor           | 200         | 200        | 200      | 160.00    | 32,000         |
| FOP                        | Porch, Open, Finished | 0           | 100        | 20       | 32.00     | 3,200          |
| WDK                        | Deck, Wood            | 0           | 160        | 16       | 16.00     | 2,560          |
| Ttl Gross Liv / Lease Area |                       | 200         | 460        | 236      |           | 37,760         |

